

ADDISON ATHLETIC CLUB EXPANSION AND LEISURE POOL
 ADDISON, TEXAS

RON HOBBS ARCHITECTS
 614 W. MAIN ST. SUITE #200 GARLAND, TEXAS 75040
 (972) 494-0174 FAX (972) 494-0722

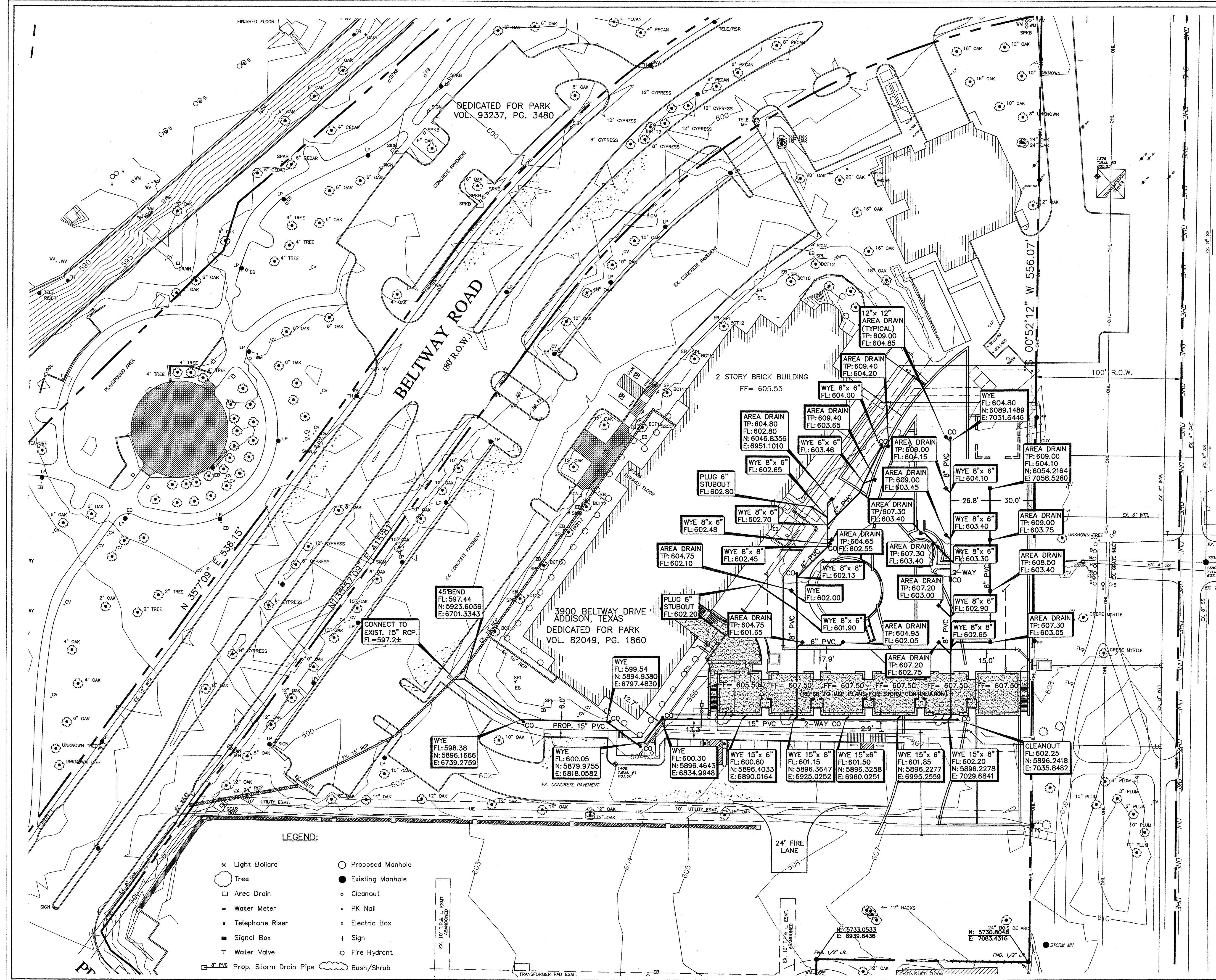

- DRAINAGE NOTES:**
1. ALL MATERIALS AND CONSTRUCTION SHALL CONFORM TO STANDARD CONSTRUCTION SPECIFICATIONS OF N.C.T.C.O.G., LATEST EDITION & THE TOWN OF ADDISON STANDARDS AND SPECIFICATIONS; EXCEPT AS NOTED HEREIN.
 2. ALL STORM SEWER PIPE 18" AND LARGER SHALL BE GLASS III RCP. ALL STORM SEWER PIPE 15" AND SMALLER SHALL BE SDR-35 PVC. ADS N-12 PIPE OR APPROVED EQUAL.
 3. CONTRACTOR SHALL BE RESPONSIBLE FOR MAINTAINING TRENCH SAFETY REQUIREMENTS IN ACCORDANCE WITH TOWN STANDARDS, TEXAS STATE LAW, AND O.S.H.A. STANDARDS FOR ALL EXCAVATION IN EXCESS OF FIVE FEET IN DEPTH.
 4. CONCRETE FOR INLETS AND DRAINAGE STRUCTURES SHALL BE 3600 PSI AT 28 DAYS.
 5. CONSTRUCTION SHALL BEGIN AT DOWNSTREAM END OF PROJECT AND CONTINUE UPSTREAM WITH PIPE GROOVES FACING UPSTREAM.
 6. CONTRACTOR SHALL PROTECT ALL PUBLIC UTILITIES IN THE CONSTRUCTION OF THIS PROJECT.
 7. THE LOCATION OF ALL UTILITIES INDICATED ON THESE PLANS ARE TAKEN FROM EXISTING PUBLIC RECORDS. THE EXACT LOCATION AND ELEVATION OF ALL PUBLIC UTILITIES MUST BE DETERMINED BY THE CONTRACTOR. IT SHALL BE THE DUTY OF THE CONTRACTOR TO ASCERTAIN WHETHER ANY ADDITIONAL UTILITIES OTHER THAN THOSE SHOWN ON THE PLANS MAY BE PRESENT.
 8. IF ROCK IS ENCOUNTERED IN THE TRENCH, ROCK SPOIL SHALL NOT BE USED IN THE UPPER 1.5 FEET FOOT OF TRENCH. THE UPPER 1.5 FEET OF THE TRENCH IS TO BE FILLED WITH BACKFILLED MATERIAL PER GEOTECHNICAL REPORT RECOMMENDATIONS.
 9. SEE UTILITY PLAN FOR ADDITIONAL INFORMATION RELATED TO OTHER UTILITY CONSTRUCTION.
 10. ALL TRENCH BACKFILL FOR STORM SEWER SHALL BE COMPACTED AS REQUIRED BY THE TOWN OF ADDISON CONSTRUCTION STANDARDS AND SPECIFICATIONS & N.C.T.C.O.G.
 11. REFER TO LANDSCAPE PLAN FOR AREA DRAINAGE MANUFACTURE & DETAILS.

- BENCH MARKS:**
- T.B.M. #1
 SQUARE CUT IN THE NORTH CURB, 34'± SOUTH OF THE SOUTHEAST CORNER OF THE EXISTING BUILDING.
 ELEVATION..... 603.50
 N: 5865.8274
 E: 6803.4747
 - T.B.M. #2
 SQUARE CUT ON THE SOUTH 10' CURB INLET OF MORMAN LANE, 125'± WEST OF THE CENTERLINE OF SOPRAS CIRCLE AND MORMAN LANE.
 ELEVATION..... 607.84
 N: 5990.4968
 E: 7215.4678
 - T.B.M. #3
 SQUARE CUT ON THE NORTHWEST CORNER OF TXU ELECTRIC TOWER ON ON THE PARKING LOT AND 35'± EAST OF THE EXISTING FIRE STATION
 ELEVATION..... 605.23
 N: 6266.8442
 E: 7132.0533

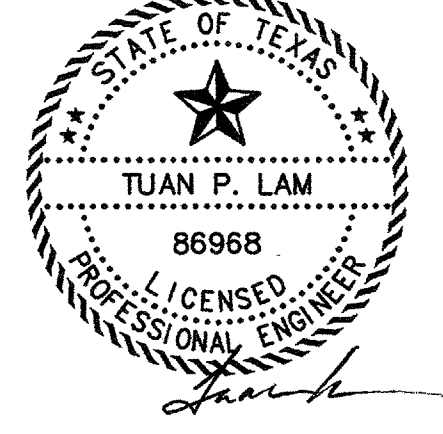

THE SEAL APPEARING ON THIS DOCUMENT WAS AUTHORIZED BY TUAN P. LAM, P.E. 86968 ON 02-05-02. ALTERATION OF A SEALED DOCUMENT WITHOUT THE PROPER NOTIFICATION TO THE RESPONSIBLE ENGINEER IS AN OFFENSE UNDER THE TEXAS ENGINEERING PRACTICE ACT.

STORM SEWER PLAN
ADDISON ATHLETIC CLUB
EXPANSION & LEISURE POOL
 ADDISON, TEXAS

R-DELTA ENGINEERS, INC.
 618 MAIN STREET GARLAND, TEXAS 75040
 Phone (972) 494-5031 www.rdelta.com

DESIGN: CTL	CHECK: JRP	SCALE: 1"=30'	5 of 11
DRAWN: CEM	DATE: FEBRUARY, 2002	PROJECT: 982-01	

- LEGEND:**
- * Light Bollard
 - Tree
 - Area Drain
 - Water Meter
 - ⊕ Telephone Riser
 - Signal Box
 - T Water Valve
 - ▬ 8" Prop. Storm Drain Pipe
 - Proposed Manhole
 - Existing Manhole
 - Cleanout
 - PK Nail
 - Electric Box
 - Sign
 - Fire Hydrant
 - Bush/Shrub

0012

SHEET NAME
 STORM SEWER PLAN

SHEET NUMBER
 C105