

PAVING NOTES

1. ALL MATERIALS AND WORKMANSHIP SHALL CONFORM TO THE STANDARD SPECIFICATIONS FOR PUBLIC WORKS CONSTRUCTION AND N.C.T.C.O.G. LATEST EDITION, AND THE TOWN OF ADDISON STANDARDS AND SPECIFICATIONS.
2. IT SHALL BE THE RESPONSIBILITY OF THE CONTRACTOR TO PROTECT ALL PUBLIC UTILITIES IN THE CONSTRUCTION OF THIS PROJECT. ALL MANHOLES, CLEANOUTS, VALVE BOXES, FIRE HYDRANTS, ETC. MUST BE ADJUSTED TO PROPER LINE AND GRADE BY THE CONTRACTOR PRIOR TO AND AFTER THE PLACING OF PERMANENT PAVING. UTILITIES MUST BE MAINTAINED TO PROPER LINE AND GRADE DURING CONSTRUCTION OF THIS PROJECT.
3. THE CONTRACTOR SHALL BE RESPONSIBLE FOR COORDINATING WITH ALL THE APPROPRIATE UTILITY COMPANIES FOR THE LOCATION OF ALL UTILITIES WITHIN THE CONSTRUCTION AREA.
4. THE PAVING CONTRACTOR SHALL COORDINATE WITH THE UTILITY CONTRACTOR TO INSURE ALL CONDUIT FOR IRRIGATION, ELECTRICAL WATER AND SEWER HAS BEEN INSTALLED PRIOR TO PLACEMENT OF PERMANENT PAVEMENT. REFER TO LANDSCAPE AND MEP PLANS FOR LOCATION AND SIZE.
5. ALL PAVING AND EARTHWORK OPERATIONS SHALL COMPLY WITH THE RECOMMENDATIONS PER THE GEOTECHNICAL REPORT, PREPARED BY FUGRO SOUTH INC. REPORT #0701-1049 DATED 4-26-01.
6. TRAFFIC BARRICADES WILL BE REQUIRED FOR PAVING AND STORM SEWER CONSTRUCTION WITHIN THE PUBLIC RIGHT-OF-WAY. BARRICADES SHALL CONFORM TO THE INSTALLATION SHOWN IN THE "1980 TEXAS MANUAL OF UNIFORM TRAFFIC CONTROL DEVICES," AS CURRENTLY AMENDED, TEXAS DEPARTMENT OF TRANSPORTATION.
7. CONCRETE SHALL HAVE A MINIMUM COMPRESSIVE STRENGTH OF 3600 PSI FOR PAVEMENT, CURBS AND SIDEWALK IN 28 DAYS.
8. CONCRETE PAVING SHALL HAVE A CONSTRUCTION JOINT OR SAWED CONTROL JOINT EVERY 15 FEET TRANSVERSELY AND LONGITUDINALLY WITH EXPANSION JOINTS AS SHOWN IN THE DRAWINGS. JOINTS SHALL INTERSECT ALL PAVEMENT EDGES AT 90° INCLUDING RADIUS RETURNS.

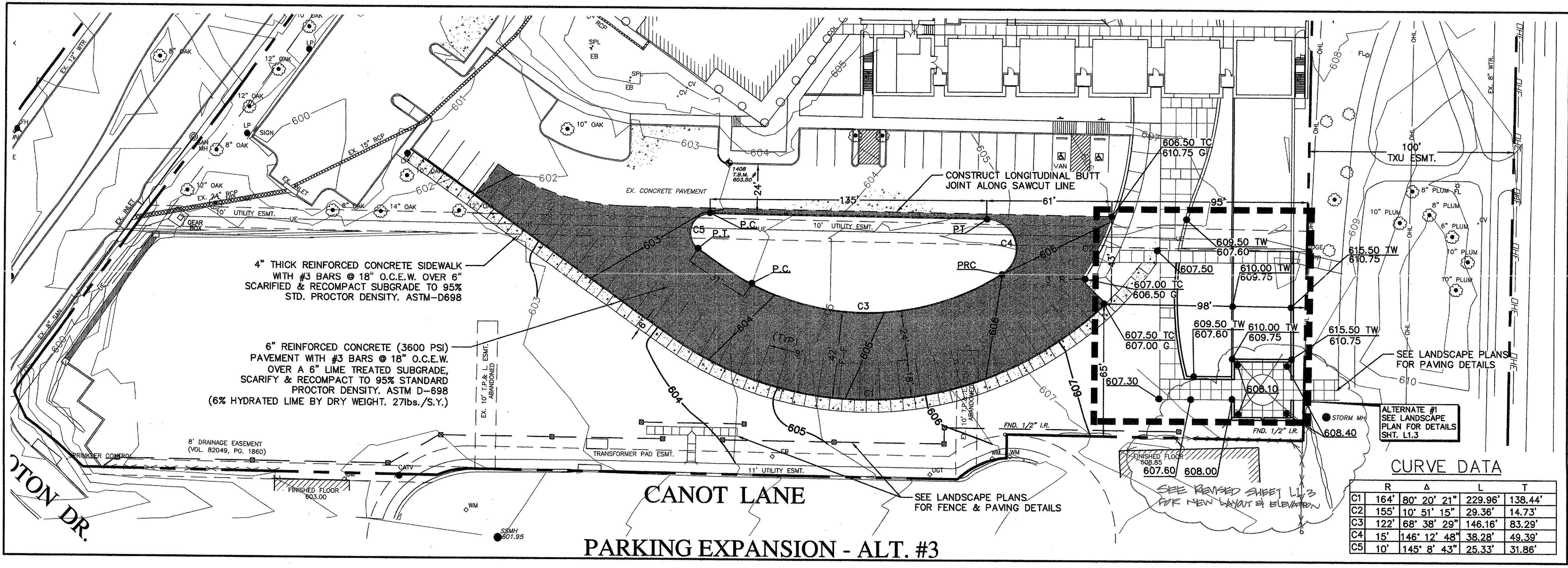
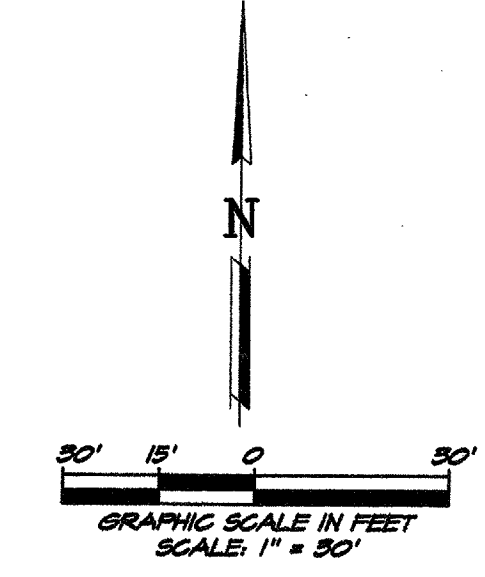

LEGEND:

- | | |
|---|------------------------|
| 609.50 TW TOP OF WALL | ○ Proposed Manhole |
| 609.50 TC TOP CURB | ● Existing Manhole |
| 609.50 G GUTTER | ○ Cleanout |
| 609.50 TOP PAVEMENT | ○ PK Nail |
| ○ Light Bollard | ○ Electric Box |
| ○ Tree | ○ Sign |
| ○ Fire Hydrant | ○ Bush/Shrub |
| ○ Water Meter | ○ Telephone Riser |
| ○ Signal Box | ○ Water Valve |
| ○ Sanitary Sewer Line | ○ WTR Water Line |
| ○ PVC Storm Drain Pipe | ○ Underground Electric |
| ○ Ex. Tree To Be Removed Or Relocated By Others | |

BENCH MARKS:

- T.B.M. #1**
 SQUARE CUT IN THE NORTH CURB, 34'± SOUTH OF THE SOUTHEAST CORNER OF THE EXISTING BUILDING.
 ELEVATION..... 603.50
 N: 5865.8609
 E: 6716.7591
- T.B.M. #2**
 SQUARE CUT ON THE SOUTH 10' CURB INLET OF MORMAN LANE, 125'± WEST OF THE CENTERLINE OF SOPRAS CIRCLE AND MORMON LANE.
 ELEVATION..... 607.84
 N: 5990.5190
 E: 7128.7696
- T.B.M. #3**
 SQUARE CUT ON THE NORTHWEST CORNER OF TXU ELECTRIC TOWER, ON ON THE PARKING LOT AND 35'± EAST OF THE EXISTING FIRE STATION.
 ELEVATION..... 605.23
 N: 6266.8409
 E: 7045.2937

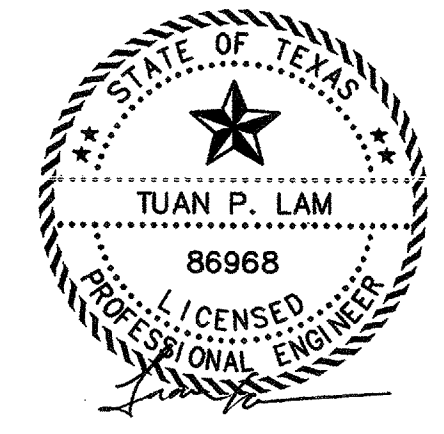

THE SEAL APPEARING ON THIS DOCUMENT WAS AUTHORIZED BY TUAN P. LAM, P.E. 86968 ON 02-22-02. ALTERATION OF A SEALED DOCUMENT WITHOUT THE PROPER NOTIFICATION TO THE RESPONSIBLE ENGINEER IS AN OFFENSE UNDER THE TEXAS ENGINEERING PRACTICE ACT.

PARKING EXPANSION ALT. # 3
ADDISON ATHLETIC CLUB
EXPANSION & LEISURE POOL
 ADDISON, TEXAS

R-DELTA ENGINEERS, INC.
 618 MAIN STREET GARLAND, TEXAS 75040
 Phone (972) 494-5031 www.rdelta.com

DESIGN: CTL	CHECK: JRP	SCALE: 1"=30'	10 of 11
DRAWN: CEM	DATE: FEBRUARY, 2002	PROJECT: 982-01	

CURVE DATA

C	R	Δ	L	T
C1	164'	80° 20' 21"	229.96'	138.44'
C2	155'	10° 51' 15"	29.36'	14.73'
C3	122'	68° 38' 29"	146.16'	83.29'
C4	15'	146° 12' 48"	38.28'	49.39'
C5	10'	145° 8' 43"	25.33'	31.86'