

NOTES:

- #1 GASOLINE DISPENSER TO BE KEYOPERATED UNIT EQUAL TO "GASBOY" MODEL 53 RDX, 1/3 HP AS MANUFACTURED BY W.M. WILSON'S SONS, INC.
- #2 DIESEL DISPENSER SAME AS ITEM #1 ABOVE.
- #3 REMOTE CONTROL 2 PUMP CONSOLE FOR MONITORING FUEL PUMP OPERATION LOCATED IN COMMUN./DISPATCH AREA. EQUAL TO "GASBOY" MODEL RCC-2
- #4 AIR & WATER DISPENSER - EACH W/3/4" HOSE UNDERGROUND BOX TO HAVE ELECTRIC HEATER UNIT EQUAL TO DUROMODEL 1004H
- #5 ALL UTILITIES TO BE CARRIED 5'-0" FROM BUILDING LINE.

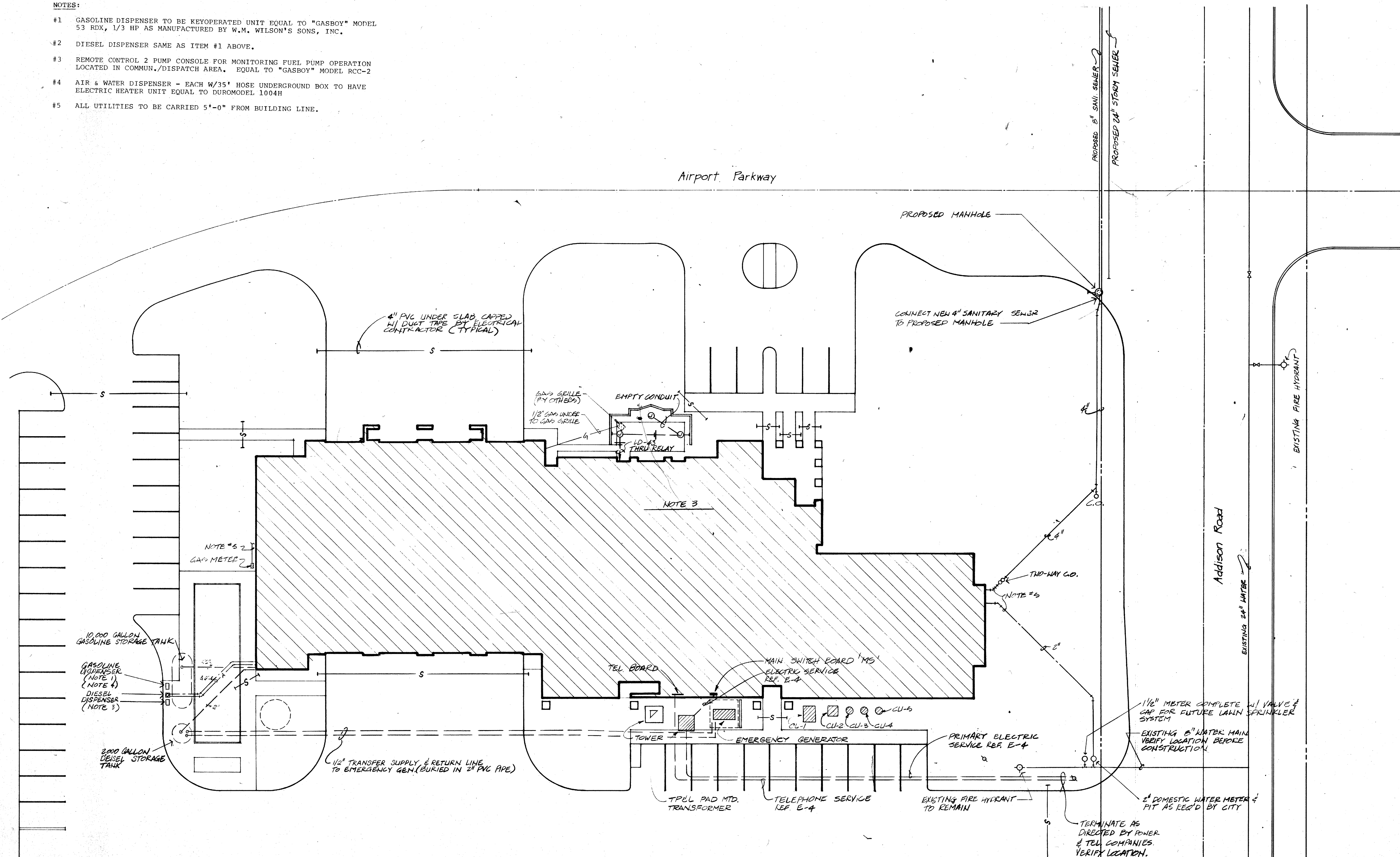

SITE PLAN
SCALE: 1/16" = 1'-0"

S. TOUB & ASSOC.
CONSULTING ENGINEERS
DALLAS TEXAS

[Signature]

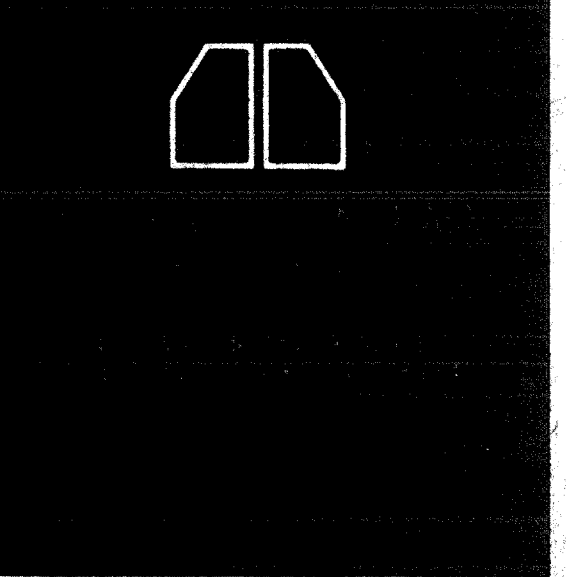

CITY OF ADDISON
FIRE DEPARTMENT
CENTRAL OFFICES #
FIRE STATION NO. 1
AIRPORT PARKWAY &
ADDISON ROAD, ADDISON, TX.

SITE PLAN

PROJECT NO. SHEET NO.
82.00
DATE
6/23/82
MEP 1