

REVISIONS
 NO. DATE REVISION APPROV.
 1
 2
 3
 4

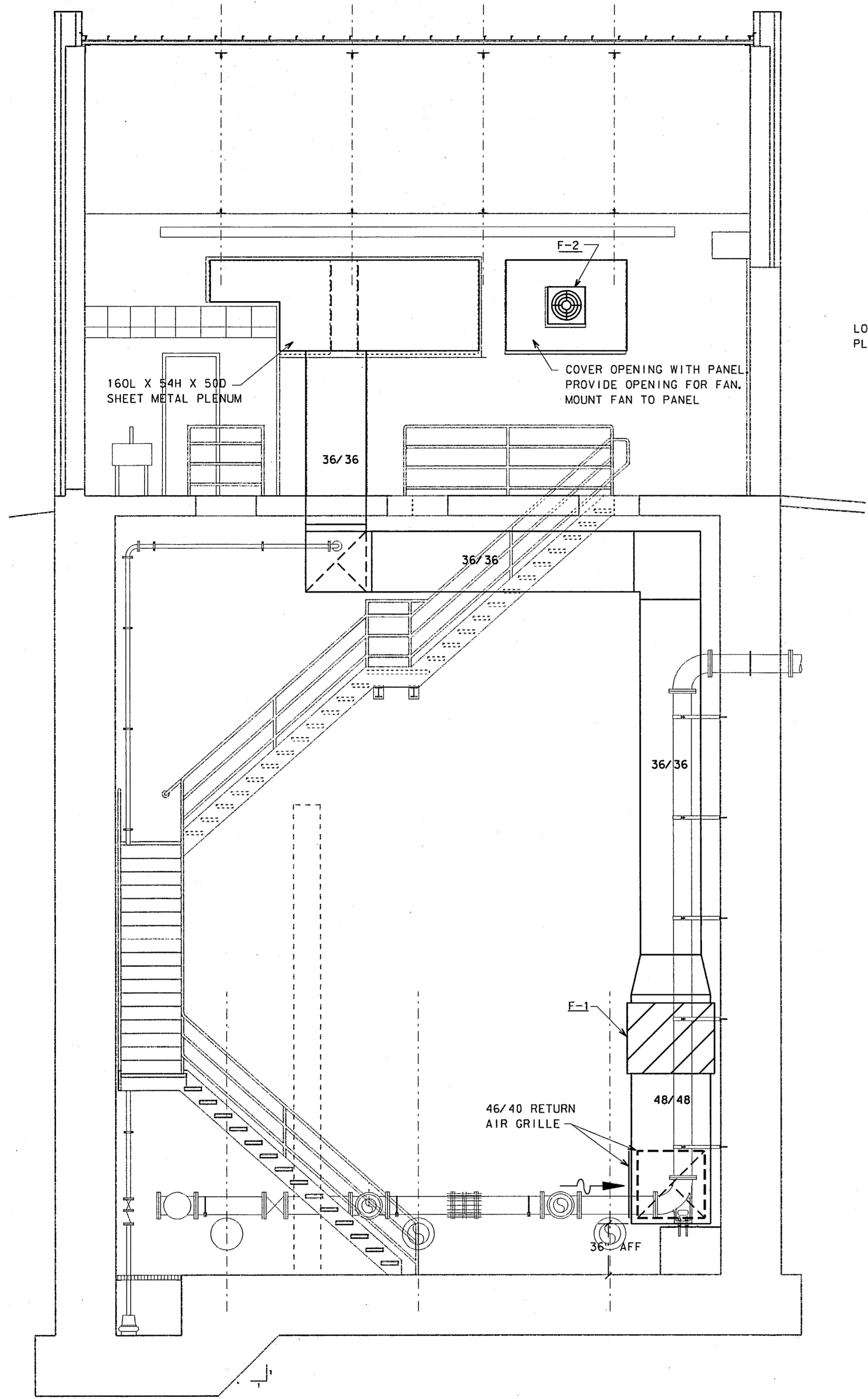

SECTION A
1/4" = 1'-0"

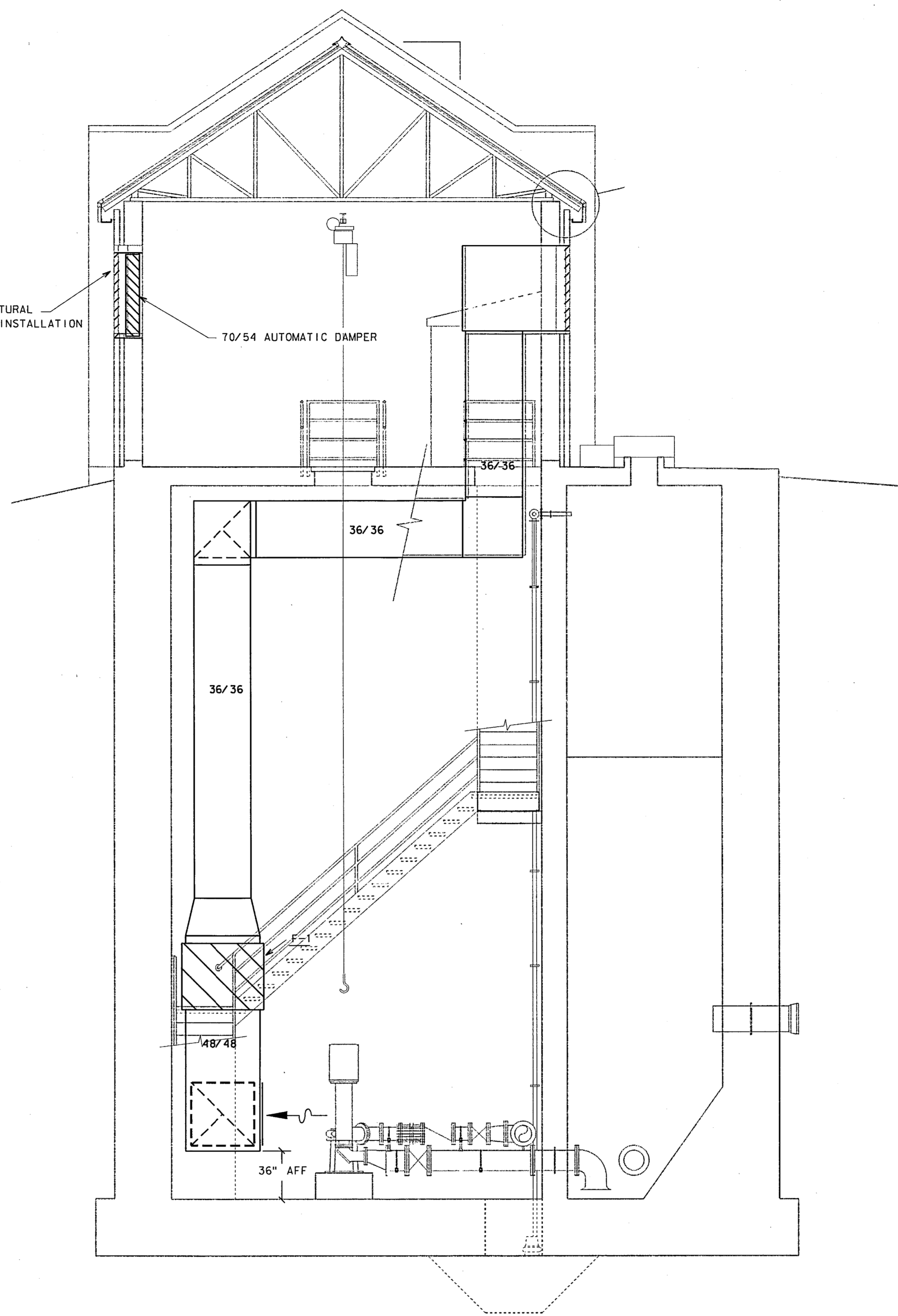

SECTION B
1/4" = 1'-0"

4		
3		
2		
1		
NO.	DATE	REVISION

TOWN OF ADDISON, TEXAS
 MIDWAY/BELTLINE SANITARY SEWER
 PHASE II
 LIFT STATION - HVAC SECTIONS

Carter Burgess
 Consultants in Engineering, Architecture,
 Planning and the Environment
 CARTER & BURGESS, INC.
 7950 ELMBROOK DRIVE, SUITE 250
 DALLAS, TX 75247-4961

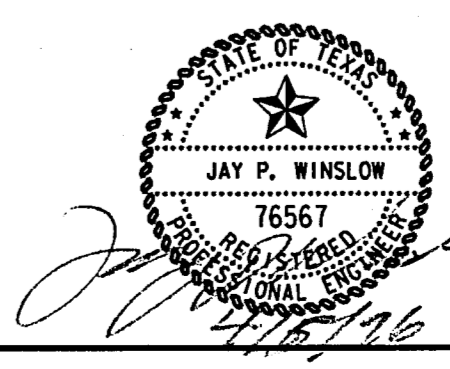

Unit	Scale	1/4" = 1'-0"	Date	04-05-96
Designed	J. Grzelakowski	Checked	J. Lindner	Job No. 93327601D
Drawn	J. Grzelakowski	Approved	J. Lindner	Sheet 53 of 63