

**GLASS TYPE SCHEDULE**

**Type GL-1: (Not Used)**

**Type GL-2:**

- Type: Milky White Insulated Glass.
- Nominal thickness: 1 inch.
- Outboard lite: 3/8 inch thick (nominal) Clear Laminated Glass with white interlayer (2) layers 3/16 inch clear glass layers laminated around .030 inch white PVB interlayer.
- Airspace: 3/8 inch.
- Inboard lite: 1/2 inch thick, Clear, uncoated, heat strengthened or tempered as required by Code.

**Type GL-3:**

- Type: Milky White Insulated Spandrel Glass.
- Nominal thickness: 1 inch.
- Outboard lite: 3/8 inch thick (nominal) Clear Laminated Glass with white interlayer (2) layers 3/16 inch clear glass layers laminated around .030 inch white PVB interlayer with white ceramic frit opaque paint on No. 4 surface.
- Airspace: 3/8 inch.
- Inboard lite: 1/2 inch thick, Clear, uncoated, heat strengthened or tempered as required by Code.

**Type GL-4:**

- Type: Non-Insulated Spandrel Glass.
- Nominal thickness: 3/8 inch.
- Outboard lite: 3/8 inch thick (nominal) Clear Glass with white ceramic frit opaque paint on No. 4 surface.
- Airspace: None.

**Type GL-5:**

- Type: Milky White Non-Insulated Glass.
- Nominal thickness: 3/8 inch.
- Outboard lite: 3/8 inch thick (nominal) Clear Laminated Glass with white interlayer (2) layers 3/16 inch clear glass layers laminated around .030 inch white PVB interlayer, heat strengthened.
- Airspace: None.

**Type GL-6:**

- Type: Metal Spandrel Panel.
- Nominal thickness: 1 inch.
- Description: Reference Division 8 Sections "Aluminum Entrances and Storefronts."

**Spandrel Glass - Ceramic Frit Opaque Paint on Spandrel Glass:**

- Color: Clear with White ceramic frit paint.
- Basic-of-Design Product:
  - "Vraspan" Viracon High Opacity White #V175, by Viracon Industries.
  - Other manufacturers providing products meeting the above requirements, subject to provisions of Section 01600.

**Milky White Glass - Clear Laminated Glass with white Polyvinyl butyral sheet interlayer:**

- Basic-of-Design Product:
  - "Vrapan" architectural laminated glass with 4 ply opti color.
  - Other manufacturers providing products meeting the above requirements, subject to provisions of Section 01600.

**GLASS LOCATION SCHEDULE**

1. Reference Elevations for all Glass and Spandrel Types.

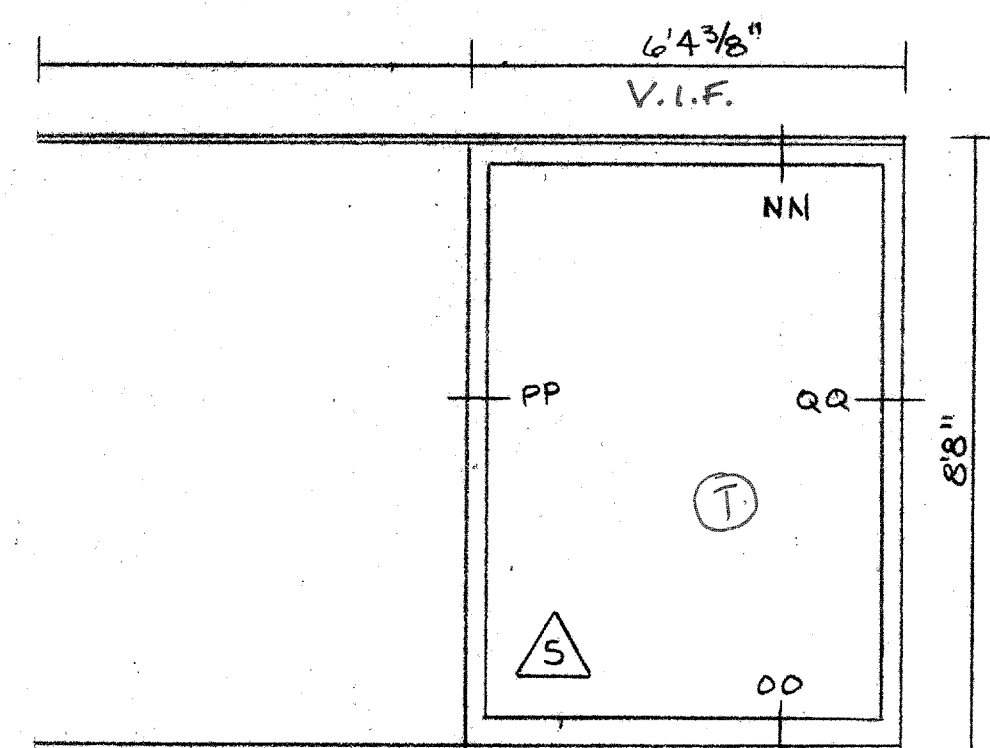
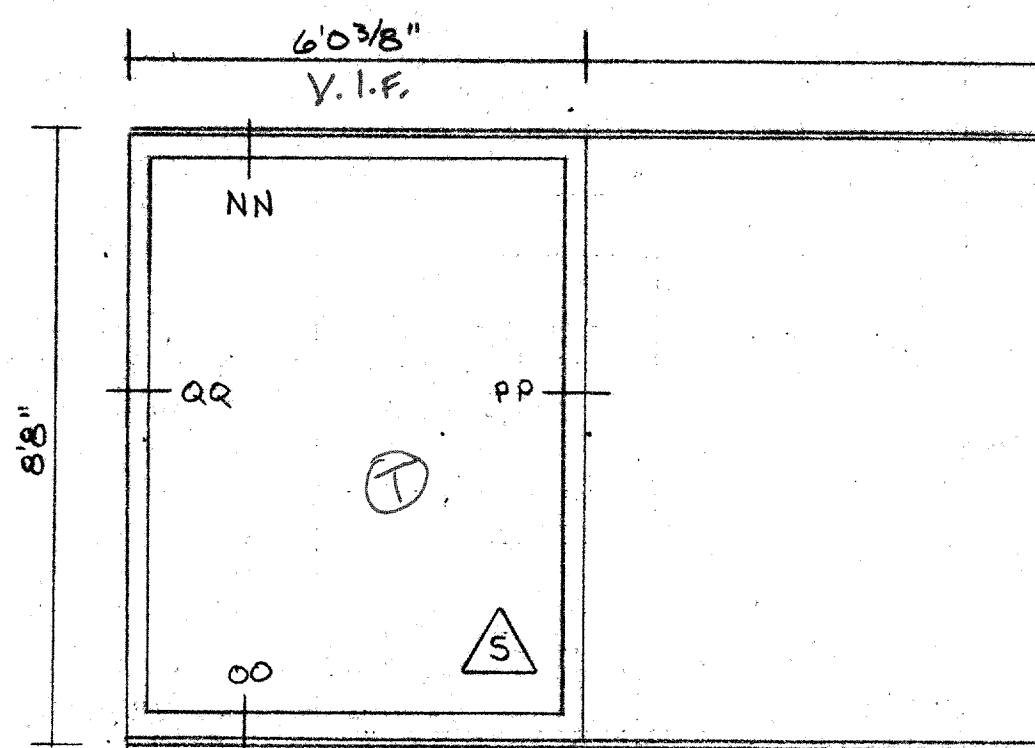

ALUMINUM TO BE CLEAR ANODIZED

**Door Hardware Set No. 1**

Double Door Nos. 1 & 2; each to have the following:

2sets	Hanging Devices	Top & Bottom Pivots, Double-Acting	Vistawall Double-Acting Pivots	US32D
2	Securing Devices (inactive leaf)	Flush Bolts	Adams-Rite Model 4085	US32D
1	Securing Devices (active leaf)	Heavy-Duty Mortise Deadbolt with Header and Threshold Bolts	Adams-Rite Models MS1850S, 4016 & 4015	US32D
4	Operating Trim	Push Bars	Vistawall Model PB-11	Clear Anodized Aluminum
[R]	Accessories for Pairs of Doors	Continuous Weatherstrip between leaves	Vistawall	
2	Closing Devices	Overhead, Double-Acting, Concealed Closers	LCN Model 6030	
6 ea.	Accessories	Silencers	Quality Model 1337A	
1 Set	Accessories	Continuous Weatherstrip	Vistawall	
1 ea.	Miscellaneous Items	Threshold, continuous across both leaves	Vistawall	Clear Anodized Aluminum

**Door Hardware Set No. 2**

Single Doors Nos. 3, 4, 5 & 6; each to have the following:

1 1/2 pairs	Hanging Devices	5-Knuckle, Heavy-Weight, Butt Hinges, 4 1/2" x 4 1/2"	Stanley Model FBB 193	US32D
1 ea.	Securing Devices (active leaf)	Heavy-Duty Small Case Mortise Deadbolt Lock with matching strike	Adams-Rite Model MS 1850S	US32D
1 set	Operating Trim	Pull Handle / Push Bar	Vistawall Models PH-10 & PB-11	Clear Anodized Aluminum
1 ea.	Closing Devices	Overhead, Single-Acting, Surface Mounted Closer	LCN Model 4040 CUSH	689 (Aluminum)
3 Set	Accessories	Continuous Weatherstrip	Vistawall	
1 ea.	Stops and Holders	Floor mounted Dome Stop	Ives Model FS 436	US32D
3 ea.	Accessories	Silencers	Quality Model 1337A	
1 ea.	Miscellaneous Items	Threshold	Vistawall	Clear Anodized Aluminum

**Door Hardware Set No. 6**

Sliding Pocket Doors Nos. 11 & 12; each to have the following:

1	Hanging Devices	Overhead Aluminum Track with Spring Loaded Guides	Vistawall PW 180 Sliding Mail Front System	Clear Anodized Aluminum
1	Floor Devices	Floor Track with 2 Sets of Rollers	Vistawall PW 180 Sliding Mail Front System	Clear Anodized Aluminum
1	Securing Devices	Cylinder Operated Floor Lock w/ 2 Floor Strikes	Adams-Rite Series 1850	US32D
4	Stops and Holders	Wall-Mounted Bumpers	Ives Model WS400 Series	US32D

ADDISON ART AND EVENT PAVILION  
ADDISON, TEXAS

CUNNINGHAM ARCHITECT DALLAS, TEXAS		
SCALE: 3/8" = 1'-0"	APPROVED BY	DRAWN BY
DATE:		P. POTAMUS
BIG SKY CONSTRUCTION COMPANY, INC. SUNNYVALE, TEXAS		
INDUSTRIAL GLASS, INC. FORT WORTH, TEXAS		DRAWING NUMBER 3 of 17