

ELECTRICAL SYMBOLS	
NOTE: ALL SYMBOLS MAY NOT APPEAR ON DRAWING	
SYMBOL	DESCRIPTION
○	INCANDESCENT FIXTURE (FIXTURE TYPE A, CIRCUIT NO. 3)
○	INCANDESCENT FIXTURE WITH PULL CHAIN SWITCH
○	FLUORESCENT FIXTURE (FIXTURE TYPE C, CIRCUIT NO. 2)
○	FIXTURE ON NIGHT LIGHT OR EMERGENCY CIRCUIT
○	EXIT SIGN (TYPE "X")
○	JUNCTION BOX, CONNECT NOTED EQUIPMENT
○	DUPLEX RECEPTACLE, 15A, 125VOLT, GROUNDING
○	DUPLEX RECEPTACLE, 15A, 125VOLT, GROUNDING, 1/2 SWITCHED
○	POWER RECEPTACLE, 250VOLT, SINGLE PHASE, AMPS NOTED (30)
○	POWER RECEPTACLE THREE PHASE, AMPS NOTED (50)
○	SPEAKER OR OUTLET
○	MICROPHONE OR OUTLET
○	TELEPHONE OUTLET
○	INTERCOM OUTLET
○	SINGLE POLE SWITCH
○	TWO POLE SWITCH
○	THREE WAY SWITCH
○	FOUR WAY SWITCH
○	DIMMER SWITCH
○	SWITCH WITH PILOT LIGHT
○	SINGLE THROW THERMAL SWITCH
○	MANUAL MOTOR STARTER
○	MAGNETIC MOTOR STARTER
○	COMBINATION MOTOR STARTER AND DISCONNECT
○	UNFUSED DISCONNECT SWITCH
○	FUSED DISCONNECT SWITCH
○	MOTOR, 1/2 HORSEPOWER
○	THERMOSTAT
○	HUMIDISTAT
○	FLOOR BOX FOR TELEPHONE
○	FLOOR BOX INTERCOM OUTLET
○	FLOOR BOX WITH DUPLEX RECEPTACLE (INDICATES FLUSH DUPLEX)
○	VOLUME CONTROL OUTLET
○	WALL MOUNTED SOUND SYSTEM JACK
○	CHIME
○	FIRE ALARM MANUAL STATION
○	FIRE ALARM BELL
○	BELL
○	BUZZER
○	PUSHBUTTON
○	T.V. OUTLET
○	CLOOT HANGER OUTLET
○	UNDER FLOOR DUCT SYSTEM
○	MULTIOUTLET ASSEMBLY
○	CONDUIT CONCEALED ABOVE CEILING
○	CONDUIT CONCEALED IN OR BELOW FLOOR
○	EXPOSED CONDUIT
○	CROSS MARKS INDICATE WIRES (+ SWITCH, + HOT, - NEUTRAL)
○	PANELBOARD (250 VOLT AND BELOW)
○	PANELBOARD (480 OR 600 VOLT)
○	DRY-TYPE TRANSFORMER
○	TELEPHONE CABINET OR BACKBOARD

H.V.A.C. & PLUMBING, VALVE & FITTINGS SYMBOLS	
NOTE: ALL SYMBOLS MAY NOT APPEAR ON DRAWING	
SYMBOL	DESCRIPTION
○	SOIL OR WASTE
○	STORM
○	VENT
○	COLD WATER
○	HOT WATER
○	HOT WATER RECIRCULATION
○	GAS
○	GATE VALVE
○	BALANCING VALVE
○	LEAN OUT
○	FIRE LINE
○	SPRINKLER MAIN
○	BRANCH LINE WITH SPRINKLER HEADS
○	FLOOR DRAIN
○	HUB DRAIN
○	DOWN SPOUT
○	FIRE HOSE CABINET
○	VENT THRU ROOF
○	ROOF DRAIN
○	CHECK VALVE
○	O.S. & Y. VALVE
○	GLOBE VALVE
○	BUTTERFLY VALVE
○	BALL VALVE
○	SOLENOID VALVE
○	PRESSURE REDUCING VALVE
○	PRESSURE RELIEF VALVE
○	CONTROL 2 WAY VALVE
○	CONTROL 3 WAY VALVE
○	STRAINER, BLOW OFF
○	PRESSURE GAUGE & COCK
○	UNION OR COMPANION FLANGES
○	PLUG VALVE
○	THERMOMETER
○	COMBINATION PRESSURE & TEMPERATURE TAP
○	THERMOSTAT
○	FLOW METER
○	ANCHOR (PIPE)
○	EXPANSION JOINT
○	MANUAL AIR VENT
○	HOSE END DRIAN
○	HOSE BIBB
○	PETES PLUG
○	FLEXIBLE DUCT RUNOUT
○	FLEXIBLE DUCT CONNECTION
○	MANUAL VOLUME DAMPER
○	DUCTWORK (SHEETMETAL)
○	LINING (INSULATION) DUCTWORK
○	FIRE DAMPER & SLEEVE
○	ELBOW WITH TURNING VANES

NOTES:
 1. 3/4" EMPTY CONDUIT FROM PNL. 1A STUBBED OUT 2'-0" FROM BUILDING & STUBBED UP 12" ABOVE GRADE.

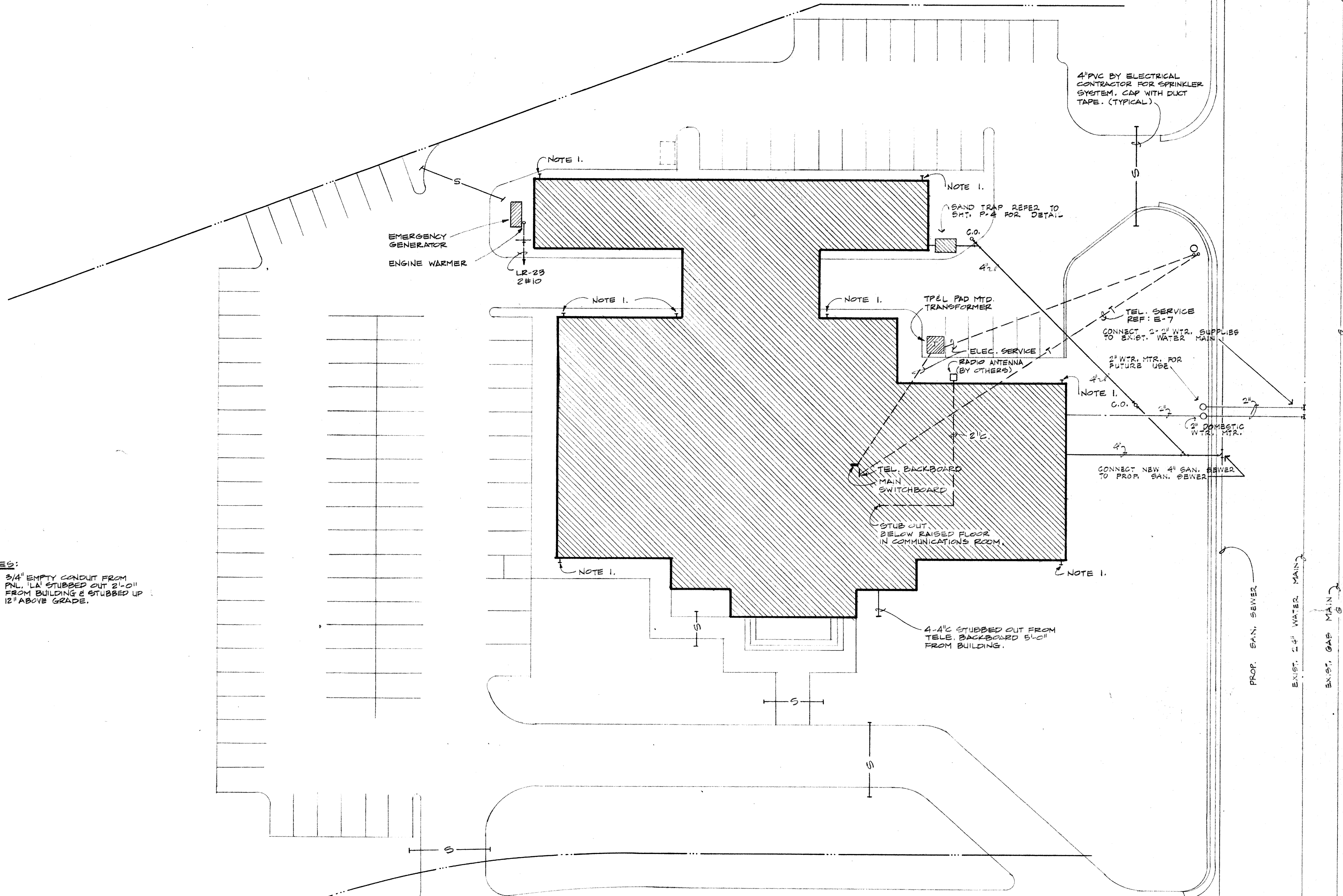

UTILITY SITE PLAN
 SCALE 1"=20'-0"

SHEPHERD + BOYD
 ARCHITECTS/PLANNERS & INTERIORS
 8225 COUGLAS AVENUE
 SUITE 1000
 DALLAS, TEXAS 75201
 TELEPHONE 214/891-8000

A NEW POLICE FACILITY FOR THE
TOWN OF ADDISON
 4799 AIRPORT PARKWAY
 ADDISON, TEXAS 75248



REVISIONS	
NO.	DATE

DATE: 7-12-82

SHEET
MEP-1

S. TOUB & ASSOC.
 CONSULTING ENGINEERS
 DALLAS, TEXAS