

36 Elevation
1/2" = 1'-0"

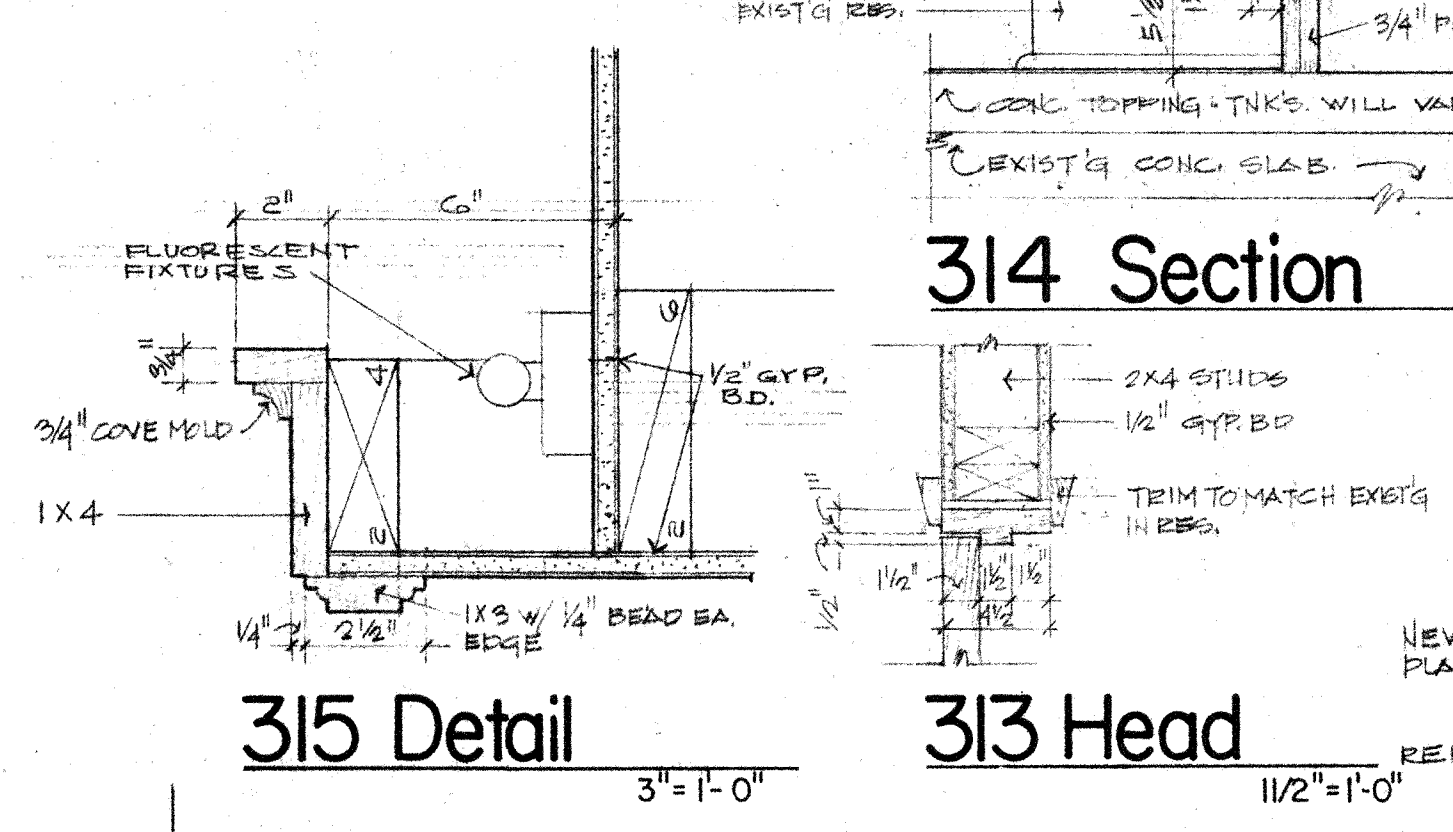

314 Section
1 1/2" = 1'-0"

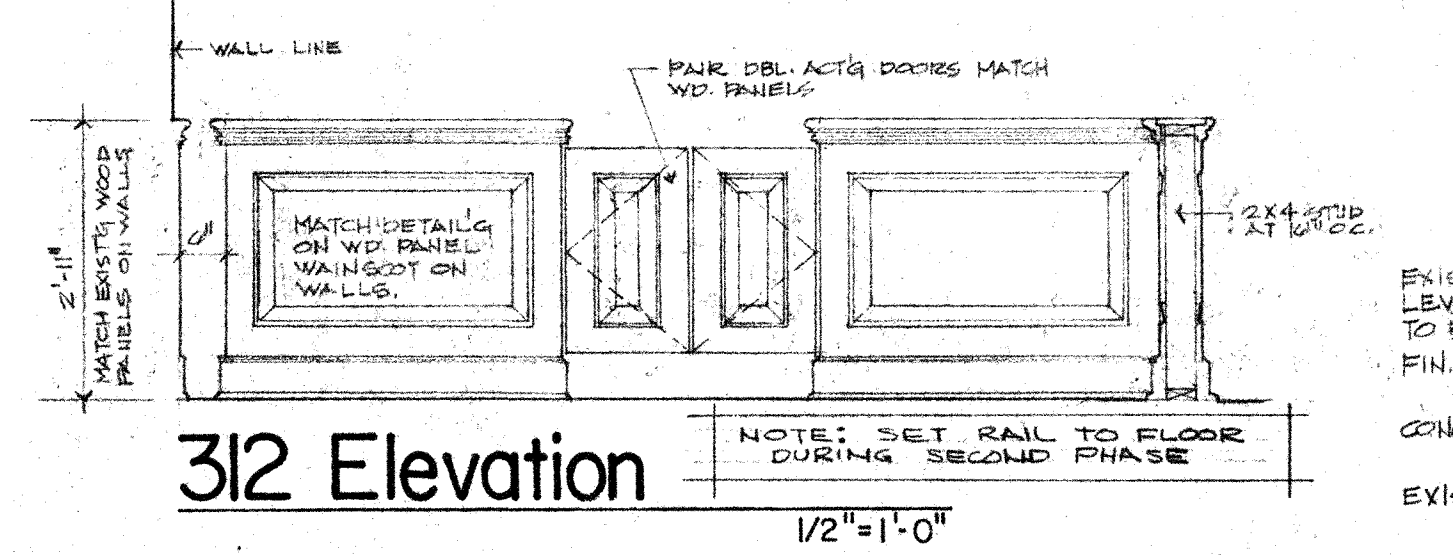

315 Detail
3' = 1'-0"

313 Head
1 1/2" = 1'-0"

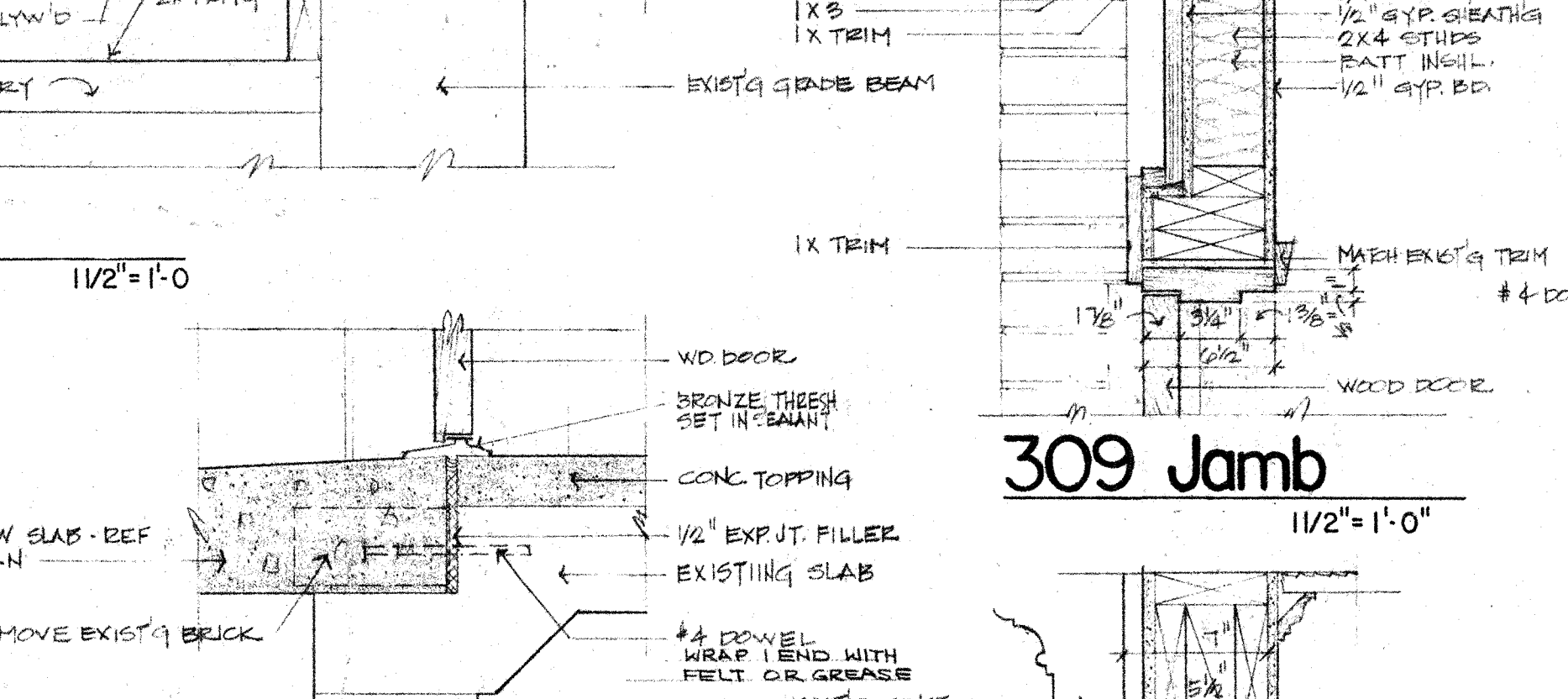

309 Jamb
1 1/2" = 1'-0"

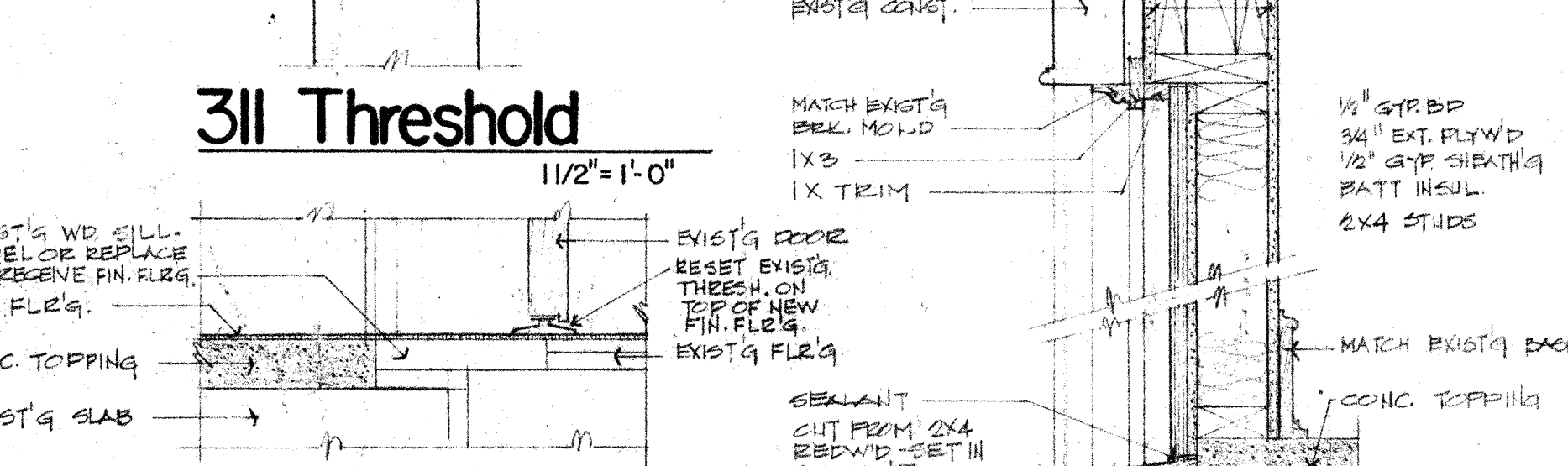

311 Threshold
1 1/2" = 1'-0"

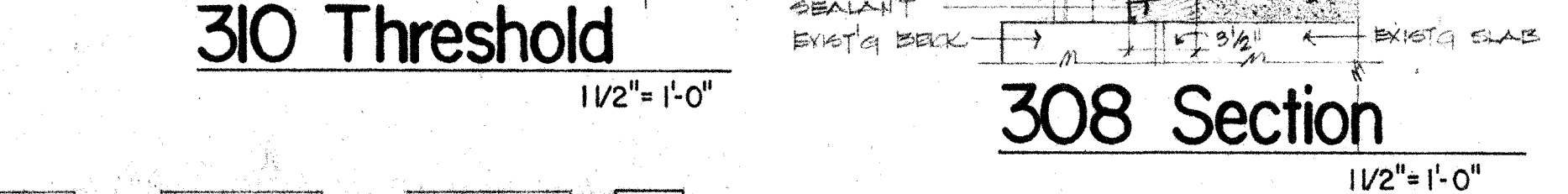

310 Threshold
1 1/2" = 1'-0"

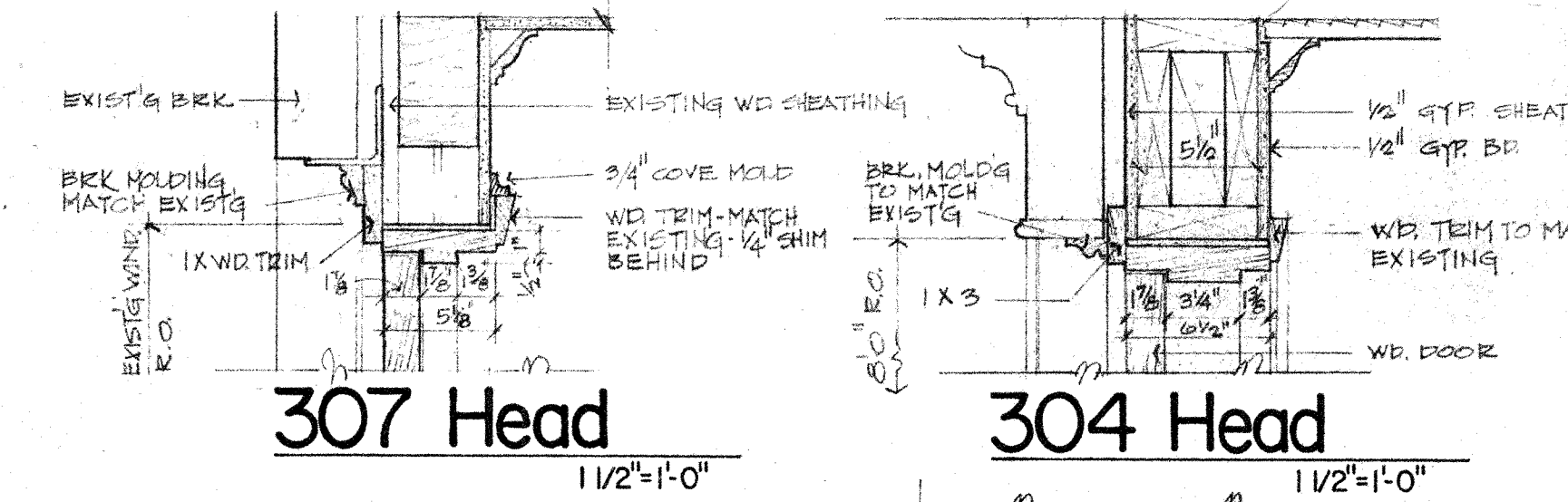

307 Head
1 1/2" = 1'-0"

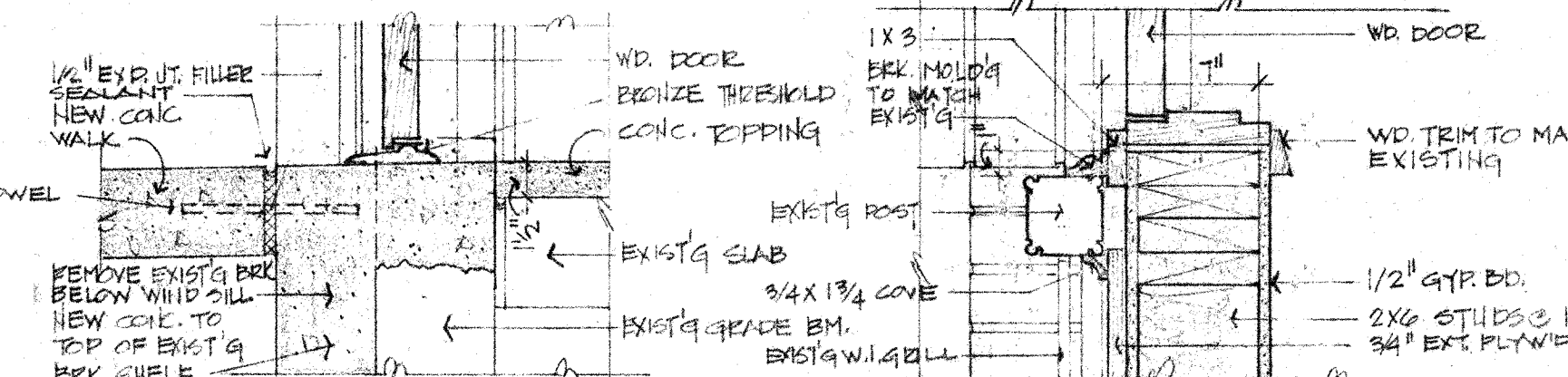

306 Threshold
1 1/2" = 1'-0"

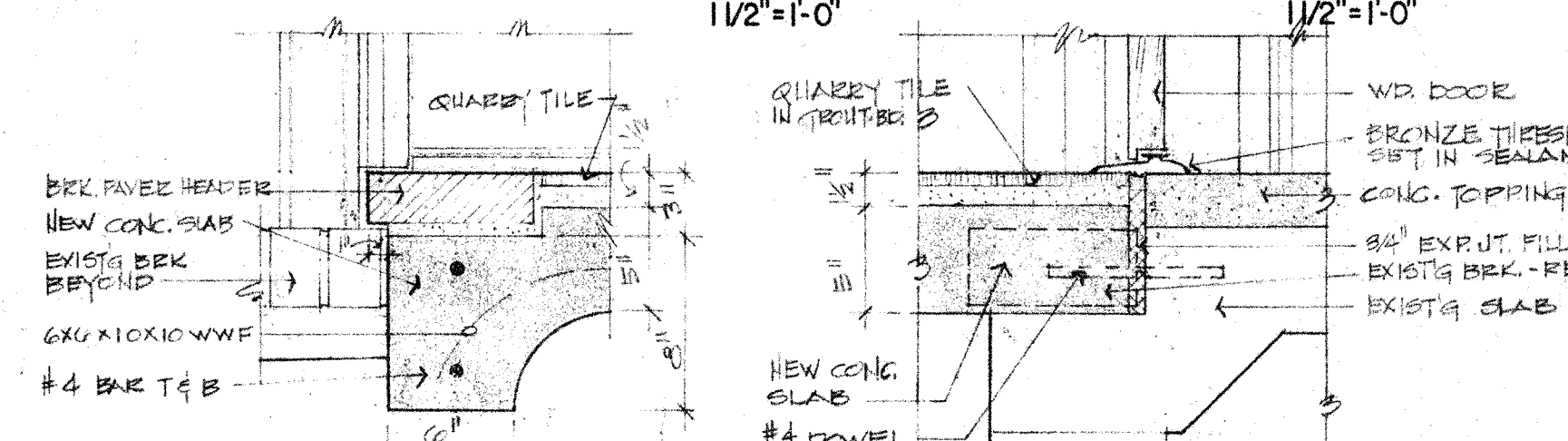

305 Detail
1 1/2" = 1'-0"

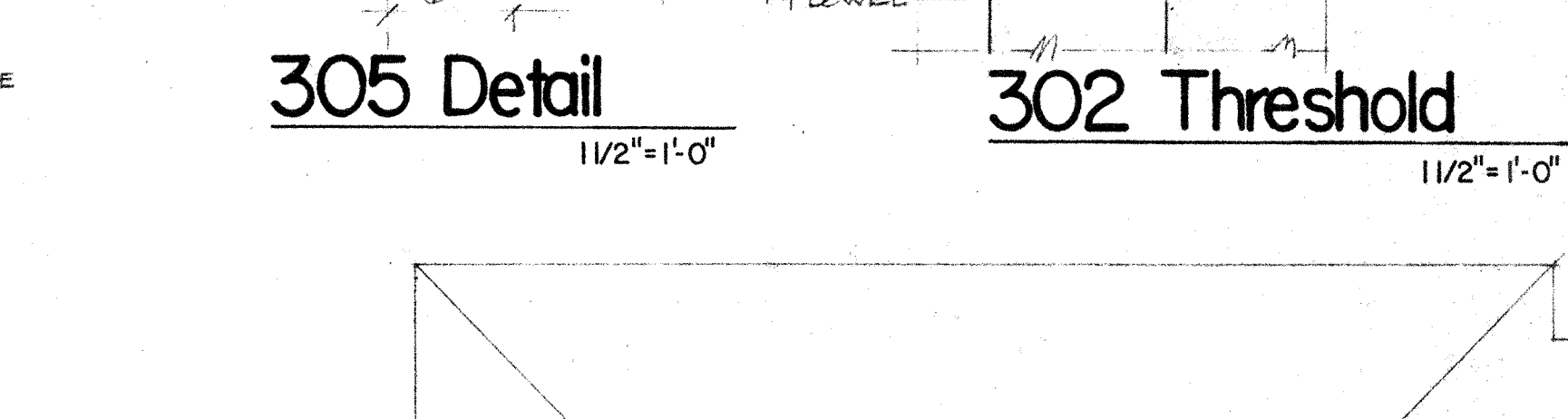

303 Jamb
1 1/2" = 1'-0"

302 Threshold
1 1/2" = 1'-0"

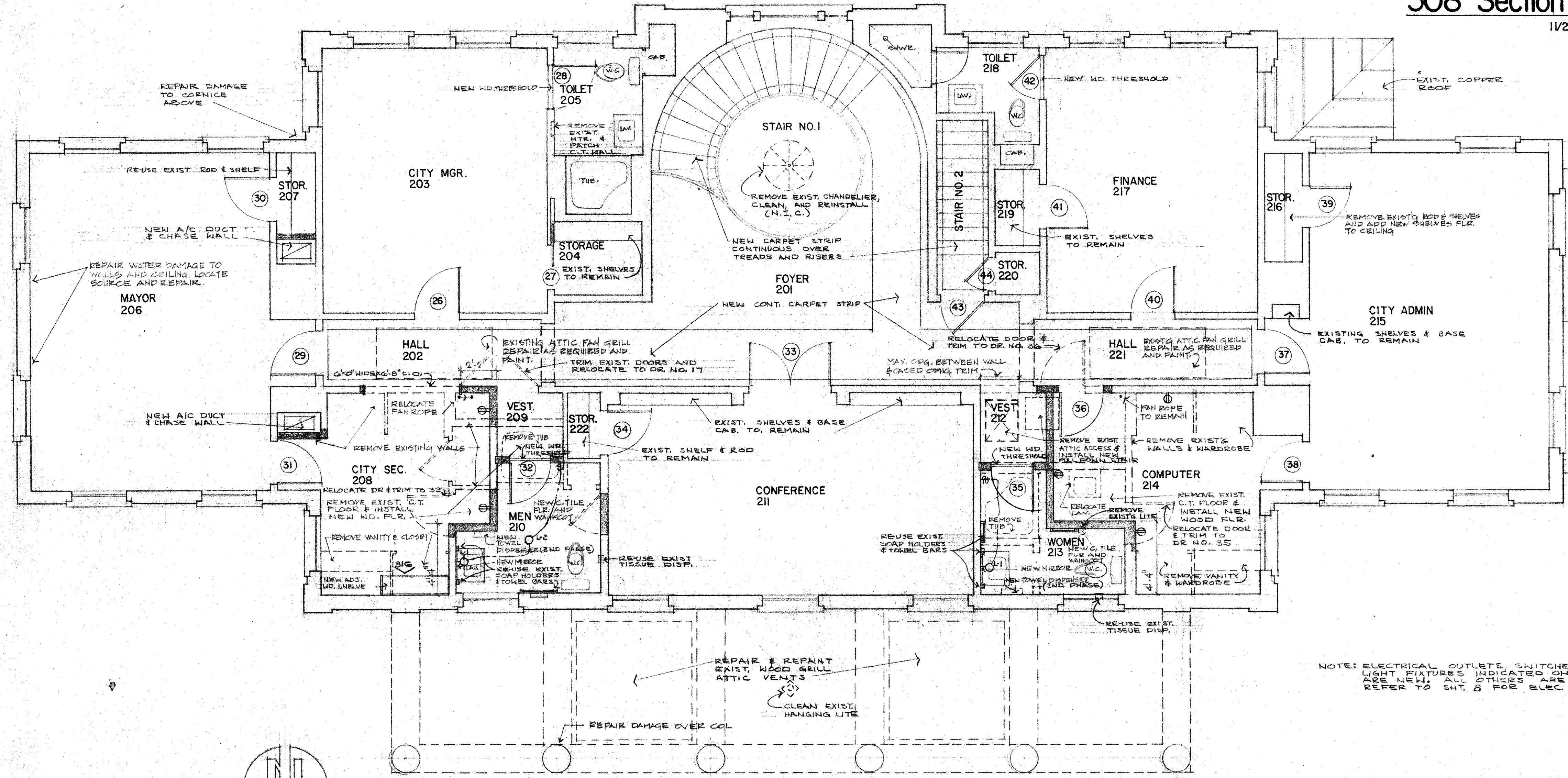

301 Second Floor Plan
2836 SQ. FT.
1/4" = 1'-0"

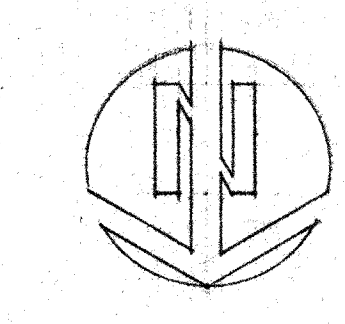

Addison Town Hall
ADDISON, TEXAS

The O'Brien Corporation
ARCHITECTURE + PLANNING

THREE NORTH PARK EAST SUITE 910
DALLAS, TEXAS 75231
214 696 1997

1 MAY, 1979

7833

Sheet
3
of 9