

**TYPICAL PLAN VITRUVIAN WAY STREETScape**  
 SCALE: 1"=5'

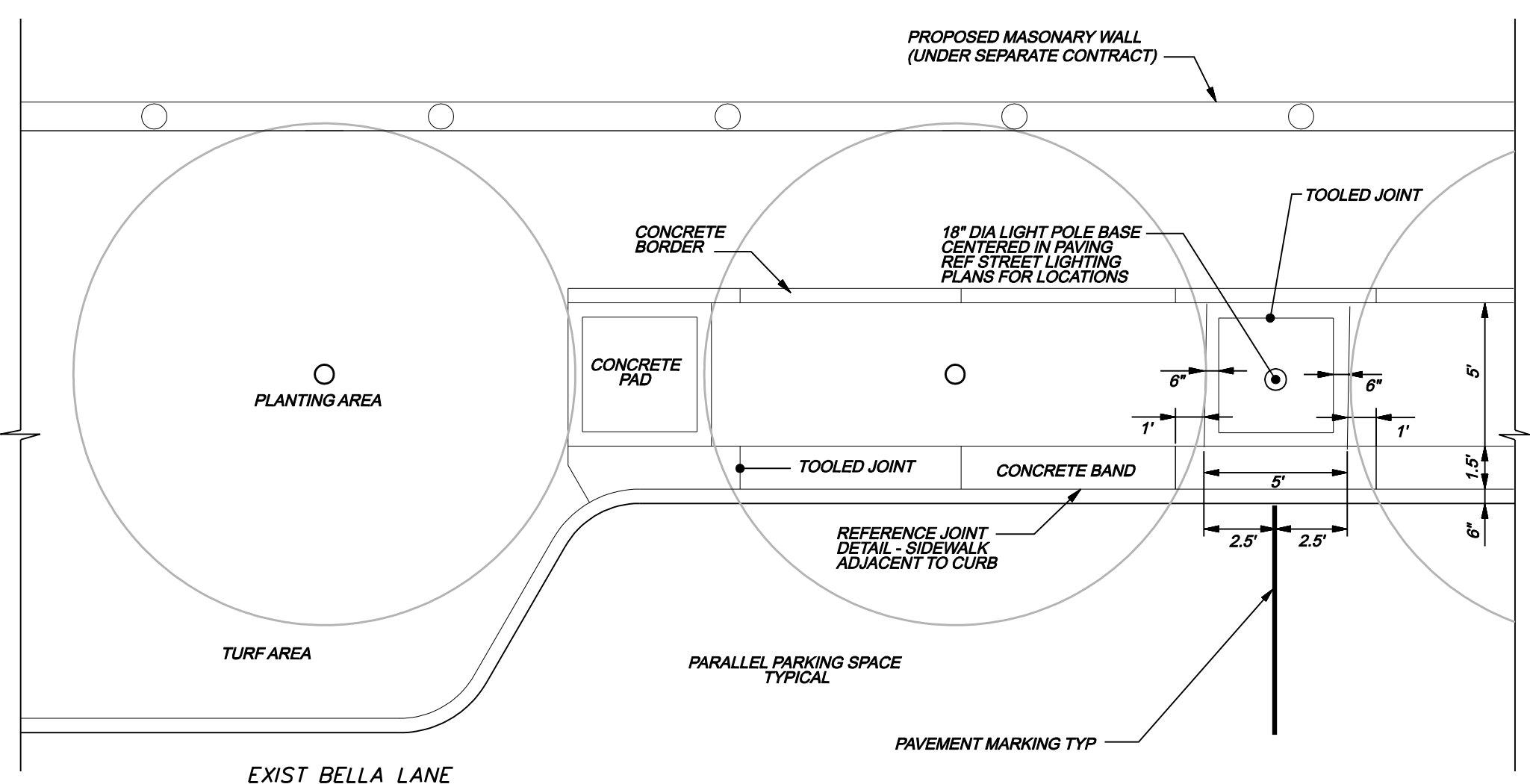

**TYPICAL PLAN BELLA LANE EAST**  
 SCALE: 1"=5'

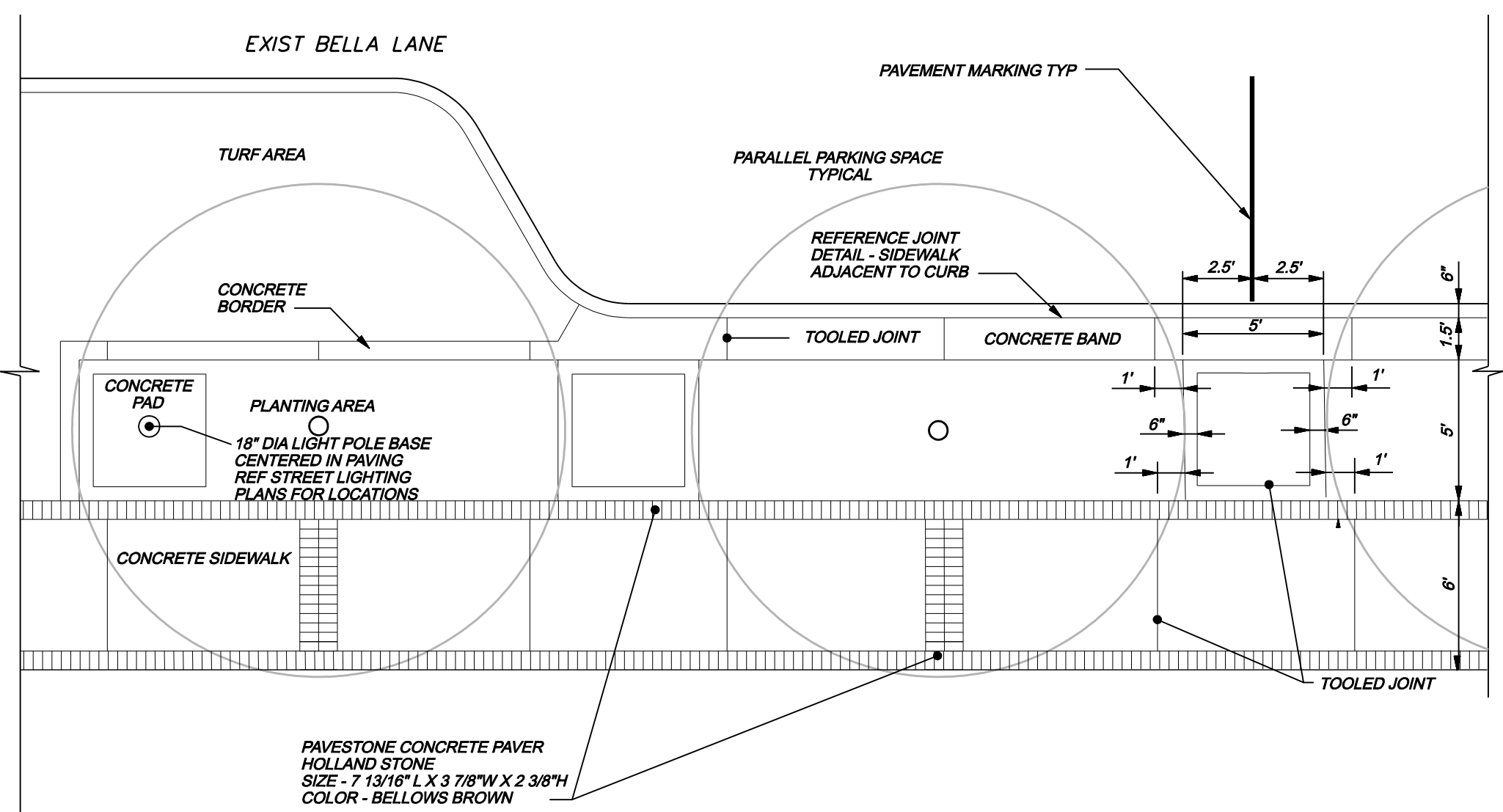

**TYPICAL PLAN BELLA LANE (SOUTH & WEST)**  
 SCALE: 1"=5'

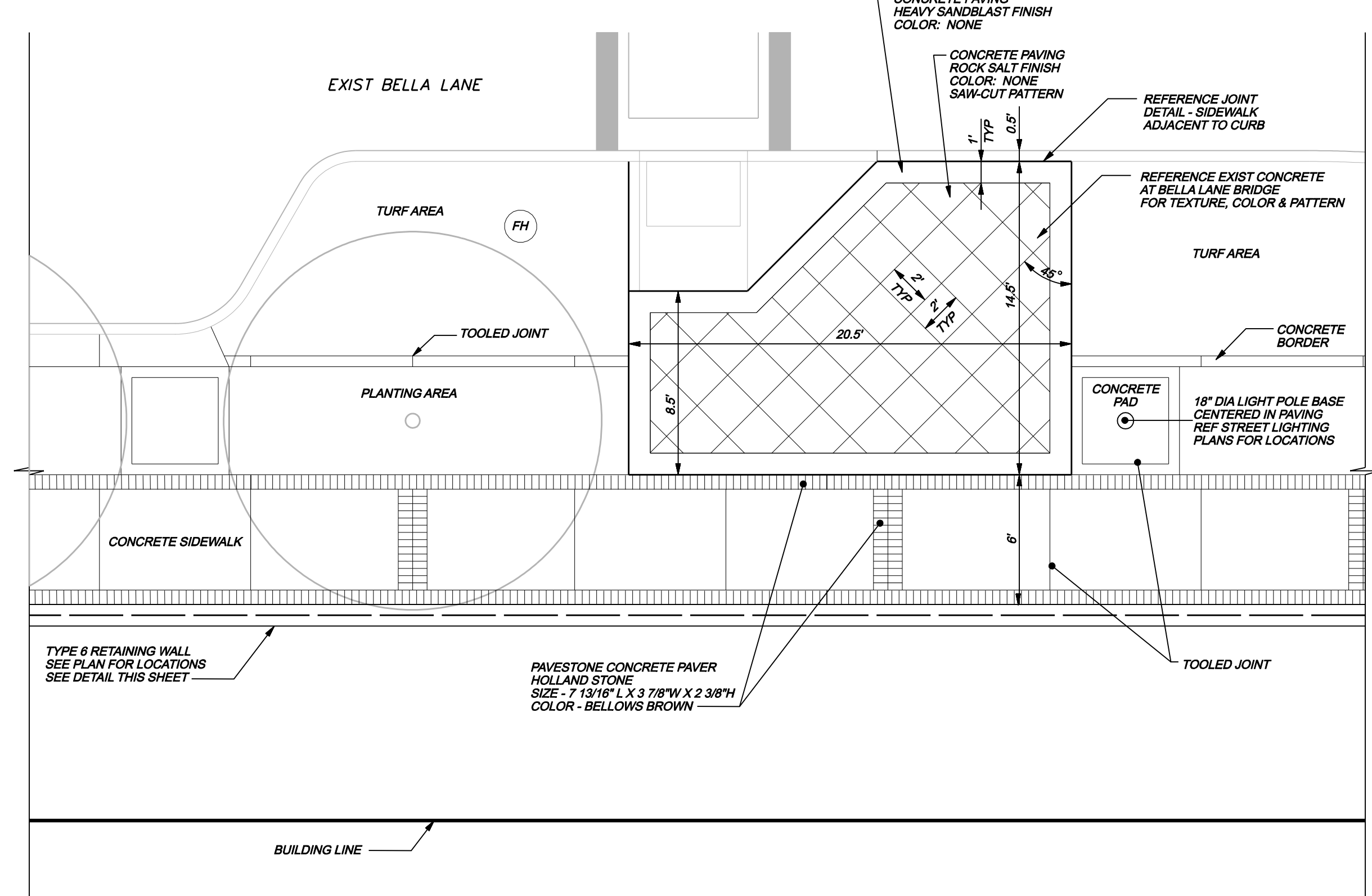

**NORTHEAST LANDING BELLA LANE**  
 SCALE: 1"=5'

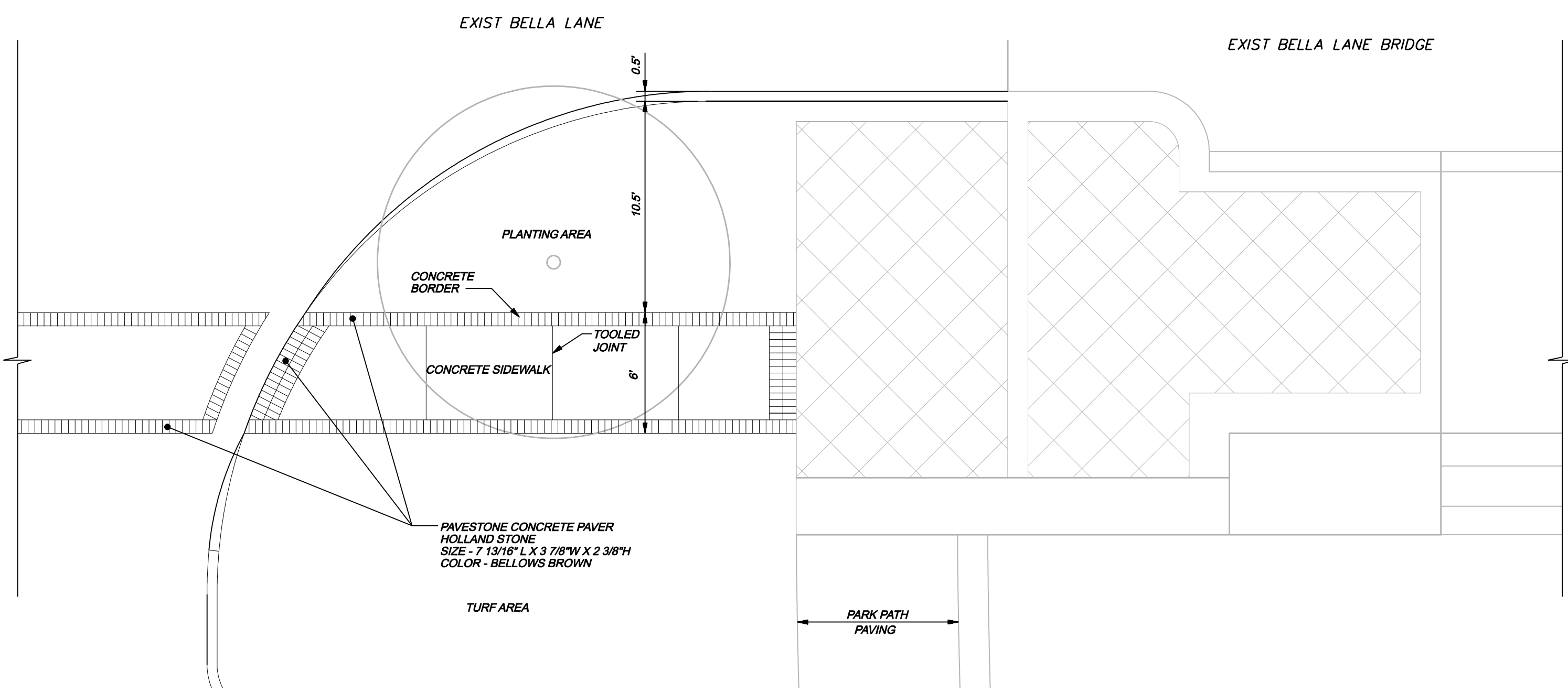

**SOUTHEAST LANDING BELLA LANE**  
 SCALE: 1"=5'

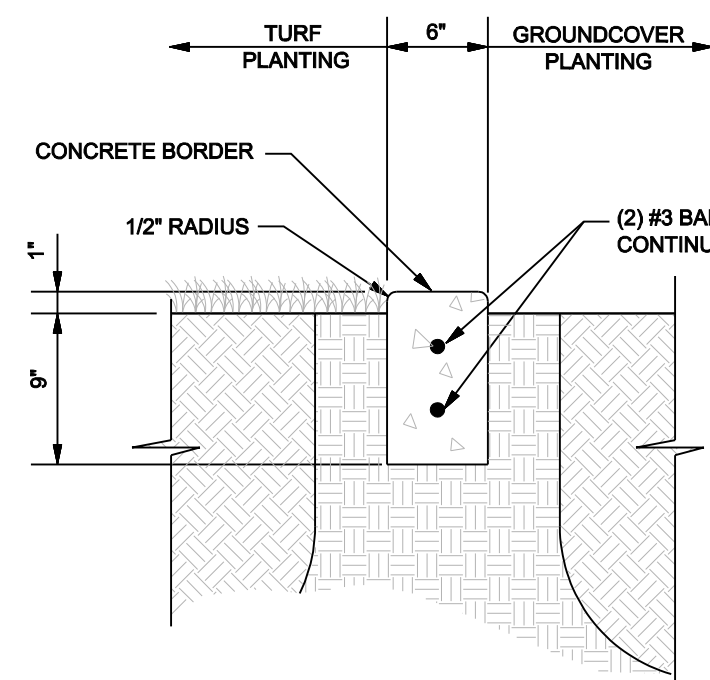

**CONCRETE BORDER**  
 NOT TO SCALE

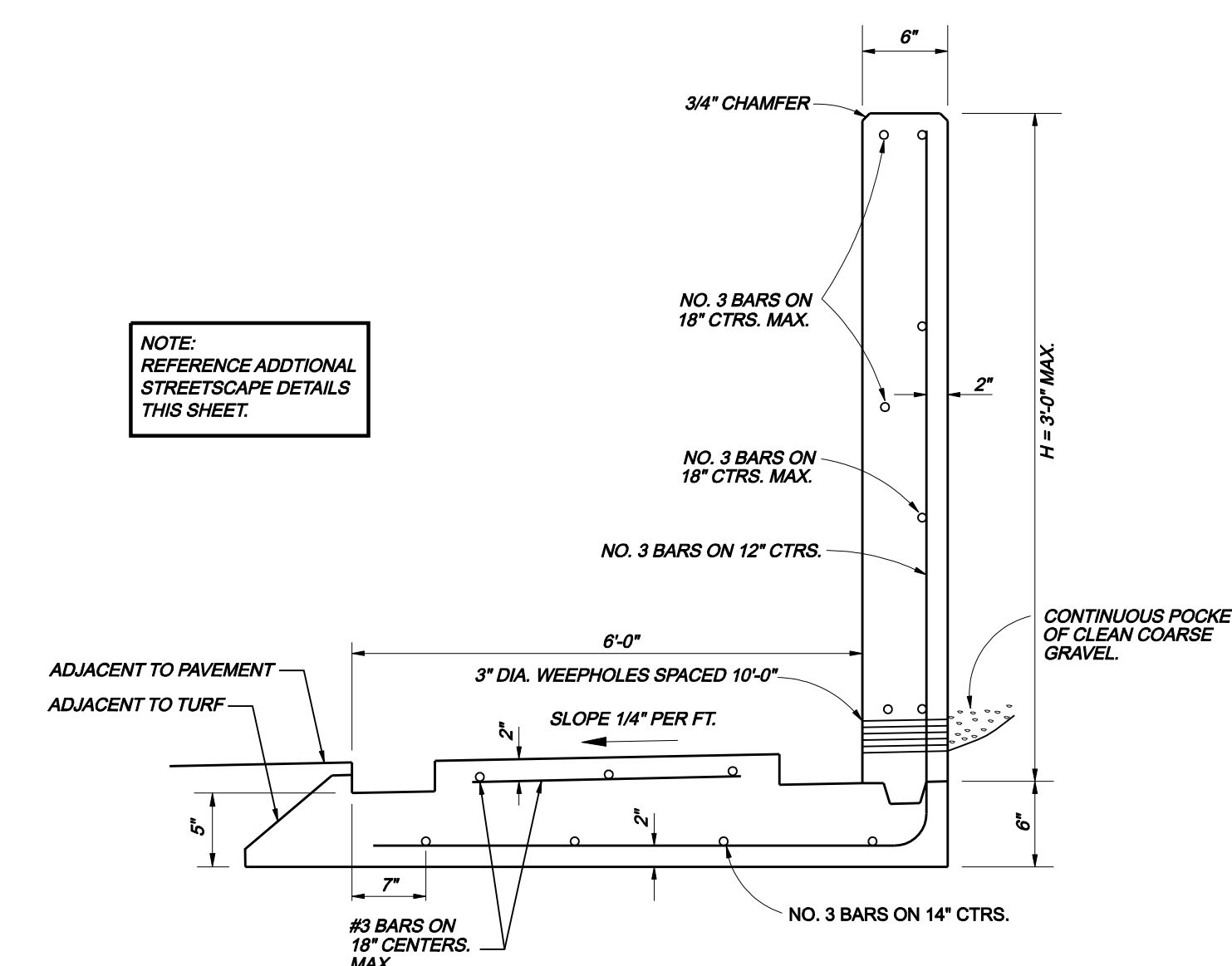

**TYPE 6 RETAINING WALL COMBINATION CANTILEVER & WALK**  
 NOT TO SCALE  
 (WALL GREATER THAN H=5'-0" REQUIRES SPECIAL ENGINEERING ANALYSIS)

**GENERAL NOTES FOR RETAINING WALLS, ALL TYPES (U.N.O.)**

- RETAINING WALLS SHALL BE BUILT WITH PERFORATED DRAIN SYSTEM INSTEAD OF WEEP HOLES WHENEVER FEASIBLE.
- BARS SHALL CONFORM TO ITEM 2.2.6 OF MTCOG SPECIFICATIONS.
- BAR LAPS SHALL BE 30 DIAMETERS.
- ALL EXPOSED SURFACES EXCEPT WALK, SHALL RECEIVE A HEAVY SANDBLAST FINISH.
- DRIVEWAY AND WALK SHALL RECEIVE A NON-SKID WOOD FLOAT FINISH.
- EXPOSED EDGES AND CORNERS TO BE ROUNDED OR CHAMFERED AS INDICATED HEREIN.
- WEEP HOLES SHALL BE FORMED BY 3" PVC.
- FOR WALL TYPES 6 & 7, THE WALKWAY WIDTH MAY BE INCREASED WHEN SPECIFIED ON THE PLANS, BUT SHALL NOT BE DECREASED UNLESS A SPECIAL DETAILED DESIGN IS PROVIDED IN THE PLANS AND SPECIFICATIONS.

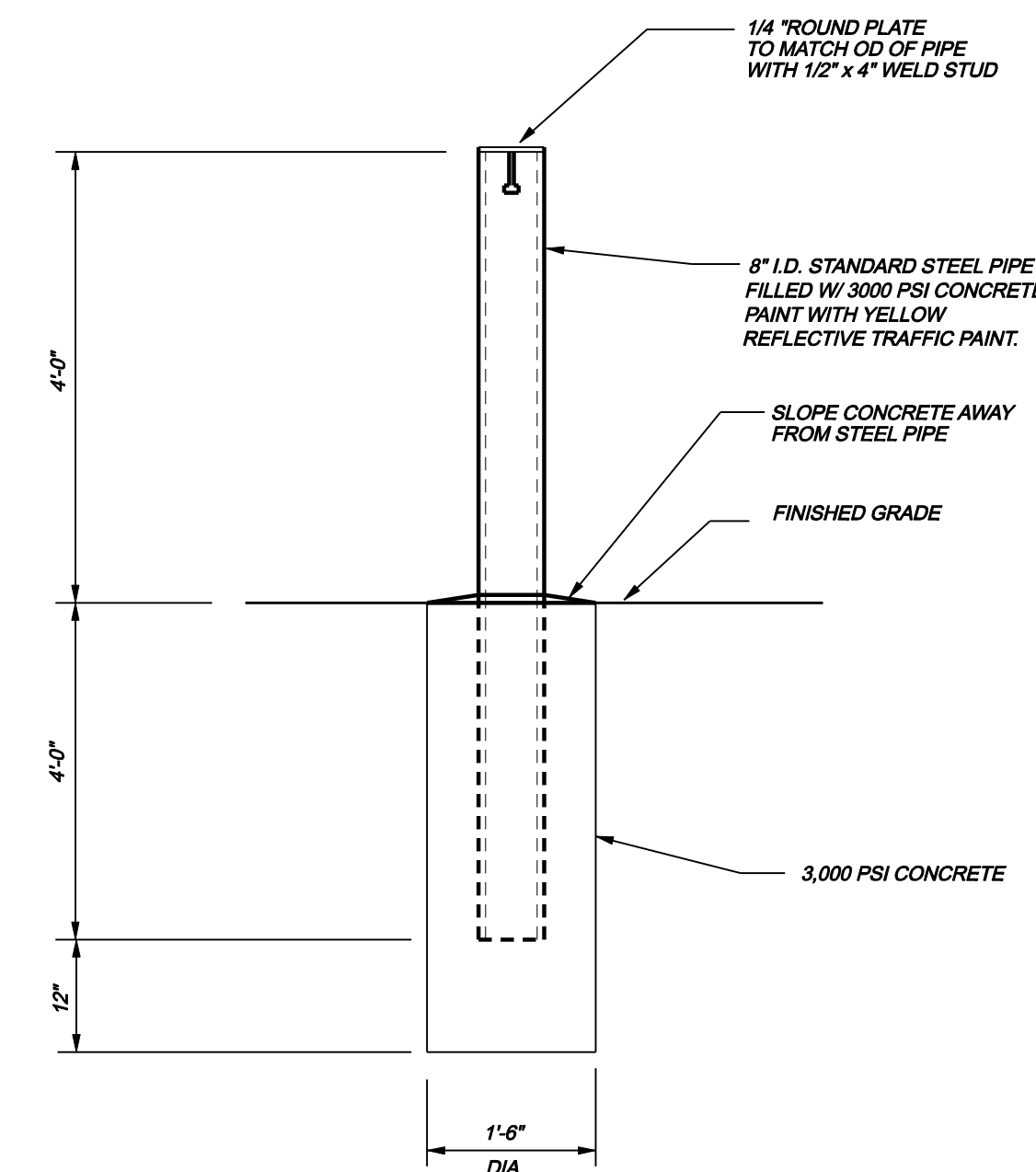

**BOLLARD DETAIL**  
 NOT TO SCALE

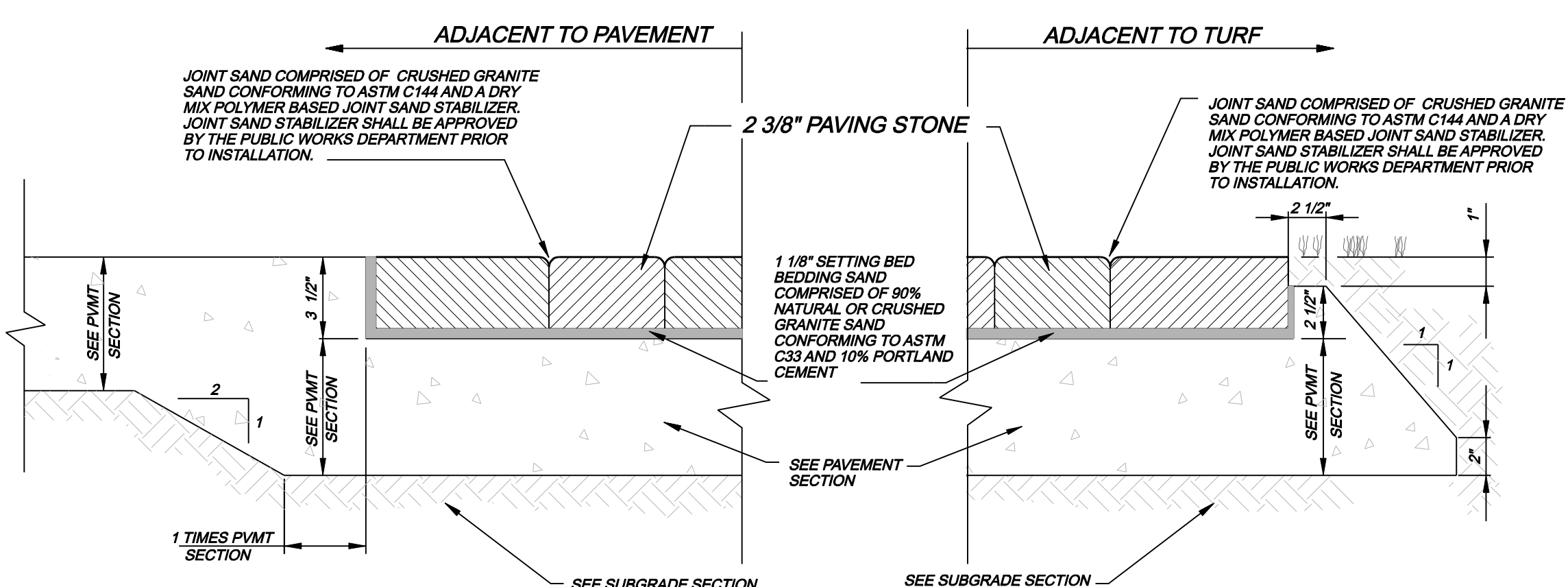

**STREETScape PAVEMENT PAVERS ON CONCRETE DROP SLAB**  
 NOT TO SCALE

NOTE: CONTRACTOR SHALL CONFIRM THICKNESS OF FINAL PAVEMENT SELECTION PRIOR TO POURING DROP SLABS IN THE SIDEWALKS

**NOTE:**  
 THESE DETAILS ARE INCLUDED FOR REFERENCE ONLY. STREETScape WORK UNDER SEPARATE CONTRACT

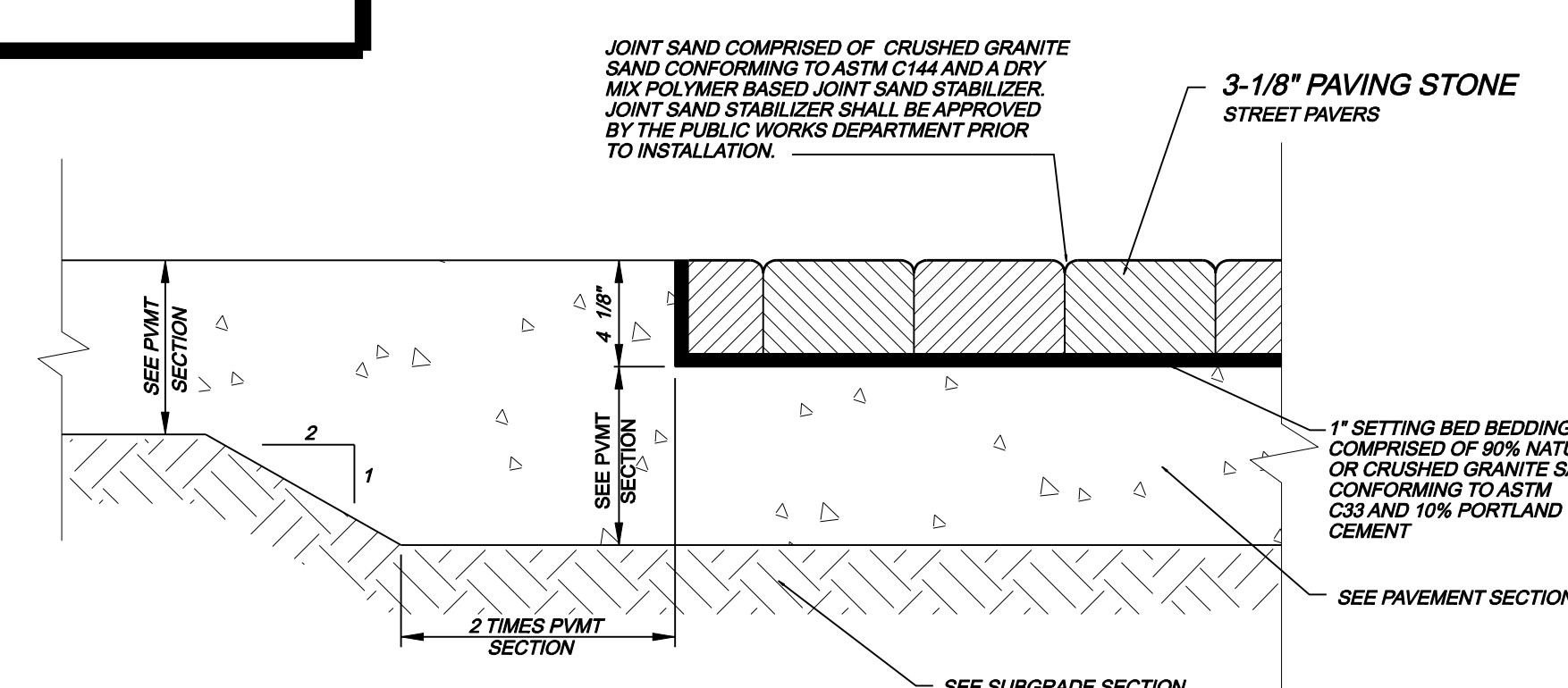

NOTE: CONTRACTOR SHALL CONFIRM THICKNESS OF FINAL PAVEMENT SELECTION PRIOR TO POURING DROP SLABS IN THE SIDEWALKS OR STREETS

**VEHICULAR PAVEMENT PAVERS ON CONCRETE DROP SLAB**  
 NOT TO SCALE

**Good Fulton & Farrell Architects**  
 214.303.1500/Tel  
 214.303.1512/Fax  
 www.gfa.com  
 2808 Fairmount Street  
 Suite 300  
 Dallas, Texas 75201

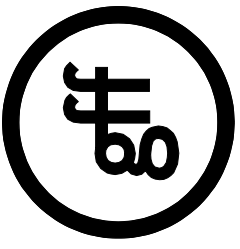

**icon**  
 Consulting Engineers, Inc.  
 Civil Engineers - Designers - Planners  
 Bicentennial Financial Center  
 250 W. Southlake Blvd., Suite 117  
 Southlake, TX 76092  
 Phone: (817) 552-8210  
 Fax: (817) 552-3128



**VITRUVIAN PARK RESTROOM**  
 VITRUVIAN WAY  
 ADDISON, TX 75001

No. Date Item REVISIONS

ICE Drawn  
 JAM Checked  
 BFD Approved

PAVING DETAILS

Project No. 10061.10  
 Date 06.28.12  
 Last Revision

C6.03