

# 4300 Westgrove Dr. Million Air Building # 1 Ground Floor

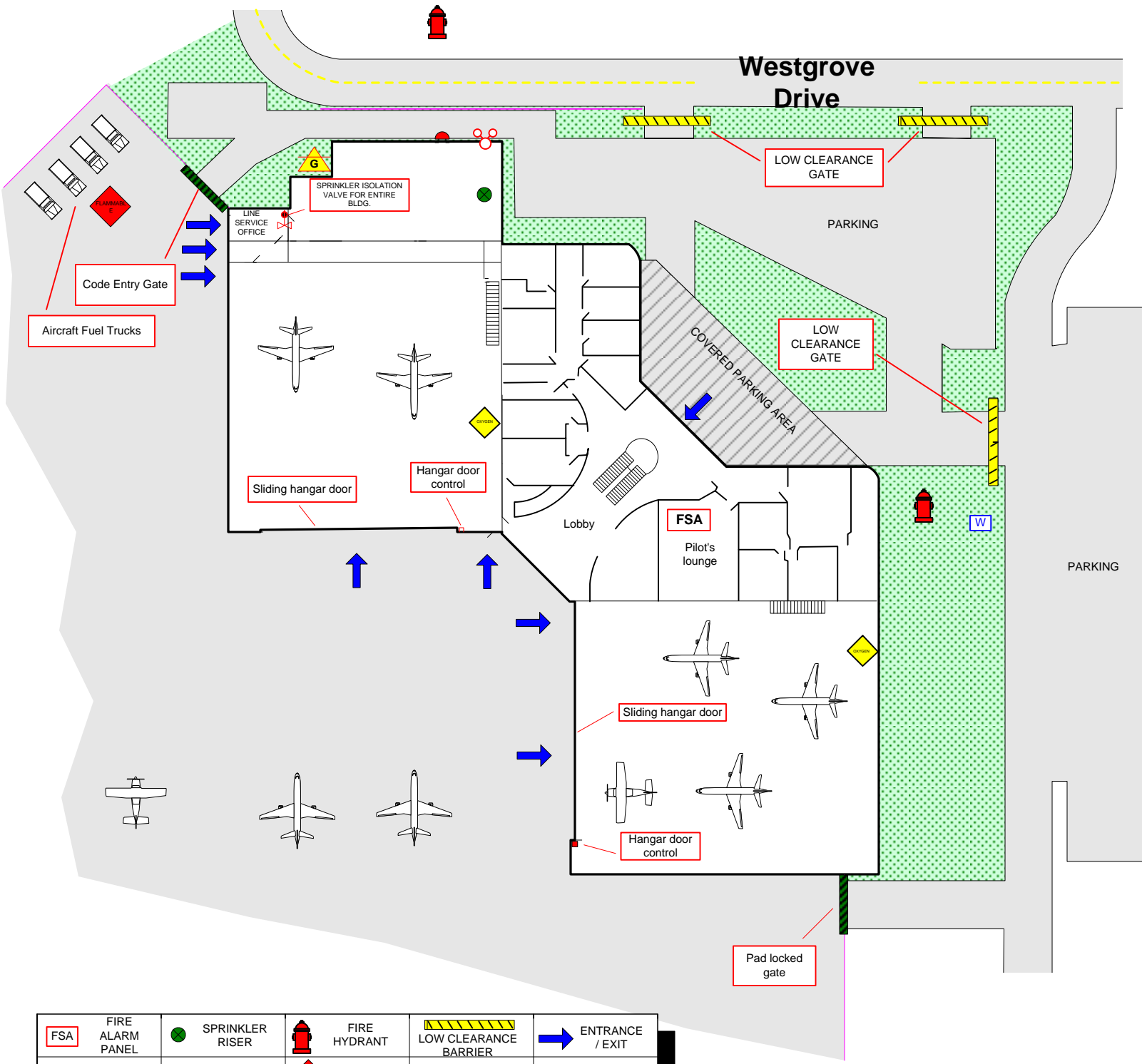

FSA	FIRE ALARM PANEL	SPRINKLER RISER	FIRE HYDRANT	LOW CLEARANCE BARRIER	ENTRANCE / EXIT
FIRE DEPT. CONNECTION	MAIN WATER SHUTOFF	FLAMMABLE GAS	GATE		
SPRINKLER ISOLATION VALVE	ELECTRICAL MAIN	FLAMMABLE	FENCE		
ALARM BELL	GAS SHUTOFF VALVE	OXYGEN	STAIRS		

