

ORDINANCE NO. 088-053

AN ORDINANCE OF THE TOWN OF ADDISON, TEXAS, AMENDING THE COMPREHENSIVE ZONING ORDINANCE OF THE TOWN OF ADDISON, TEXAS, SO AS TO GRANT A SPECIAL USE PERMIT FOR A SATELLITE DISH ANTENNA ON APPLICATION WITH HAMPTON INN, LOCATED AT 4555 BELTWAY DRIVE; PROVIDING FOR SPECIAL CONDITIONS; PROVIDING FOR A REPEAL CLAUSE; PROVIDING FOR A PENALTY CLAUSE; AND PROVIDING FOR A SEVERABILITY CLAUSE.

WHEREAS, application was made to amend the Comprehensive Zoning Ordinance of the Town of Addison, Texas, by making application for the same with the Planning and Zoning Commission of the Town of Addison, Texas, as required by State Statutes and the zoning ordinance of the Town of Addison, Texas, and all the legal requirements, conditions and prerequisites having been complied with, the case having come before the City Council of Addison, Texas, after all legal notices, requirements, conditions and prerequisites having been complied with; and

WHEREAS, the City Council of the Town of Addison, Texas, does find that there is a public necessity for the zoning change, that the public demands it, that the public interest clearly requires the amendment, and it is in the best interest of the public at large, the citizens of the Town of Addison, and helps promote the general welfare and safety of this community; now, therefore,

BE IT ORDAINED BY THE CITY COUNCIL OF THE TOWN OF ADDISON, TEXAS:

SECTION 1. That Comprehensive Zoning Ordinance of the Town of Addison, Texas, as heretofore amended, is hereby amended so as to grant a special use permit to Hampton Inn in accordance with the drawings attached hereto and made a part hereof for all purposes. Said amendment shall be noted on the official zoning map of the Town of Addison, Texas, and is situated on the following described land:

Being a tract of parcel of land situated in the City of Addison, Dallas County, Texas; and being part of Elisha Fike Survey, Abstract 478; and also being part of Beltway Office Park, Tract III, an addition to the City of Addison as recorded in Volume 77086, Page 0026 of the Deed Records of Dallas County, Texas; and being more particularly described as follows:

BEGINNING at an iron rod for corner in the north line of Beltway Drive (60 feet wide), said point being due west along the north line of Beltway Drive a distance of 169.05 feet from its intersection with the westerly line of Beltway Drive (60 feet wide);

THENCE due West along the northerly line of Beltway Drive a distance of 280.11 feet to an iron rod and the beginning of a curve to the left;

THENCE in a westerly direction continuing along the northerly line of Beltway Drive and along the said curve to the left, having a radius of 602.96 feet, a central angle of 13°58'23" and an arc length of 147.05 feet to an iron rod and the end of said curve to the left;

THENCE due North a distance of 207.84 feet to an iron rod for corner in the centerline of a 20.00 foot wide Utility Easement as recorded in Volume 77086, Page 0026 of the Deed Records of Dallas County, Texas;

THENCE due East along the centerline of said 20.00 foot wide Utility Easement a distance of 145.50 feet to an iron rod for corner;

THENCE North 0°01'24" West continuing along said centerline a distance of 111.33 feet to an iron rod for corner;

THENCE North 89°58'36" East continuing along said centerline a distance of 279.99 feet to an iron rod for corner;

THENCE South 0°03'00" East a distance of 301.44 feet to the POINT OF BEGINNING and containing 112.917 square feet, or 2.5922 acres, more or less.

SECTION 2. That the Special Use Permit for a satellite dish antenna is granted subject to the following condition:

- That a 4" caliper live oak tree which is missing on the site be replaced.

SECTION 3. That all ordinances of the City in conflict with the provisions of this ordinance be, and the same are hereby repealed and all other ordinances of the City not in conflict with the provisions of this ordinance shall remain in full force and effect.

SECTION 4. That any person, firm, or corporation violating any of the provisions or terms of this ordinance shall be subject to the same penalty as provided for in the Comprehensive Zoning Ordinance of the city, as heretofore amended, and upon conviction shall be punished by a fine not to exceed the sum of Two Thousand Dollars (\$2,000.00) and not less than Five Hundred Dollars (\$500.00) for each offense and that each day such violation shall continue to exist shall constitute a separate offense.

SECTION 5. That should any paragraph, sentence, subdivision, clause, phrase or section of this ordinance be adjudged or held to be unconstitutional, illegal or invalid, the same shall not affect the validity of this ordinance as a whole or any part or provisions thereof other than the part so decided to be invalid, illegal or unconstitutional, and shall not affect the validity of this ordinance as a whole.

DULY PASSED BY THE CITY COUNCIL OF THE TOWN OF ADDISON, TEXAS, on this the 13th day of December, 1988.

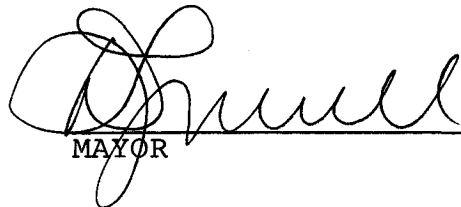
  
MAYOR

ATTEST:

  
CITY SECRETARY

CASE NO. 1024-SUP

APPROVED AS TO FORM:

  
\_\_\_\_\_

Published 12/29/88

HOTEL  
4 STORY

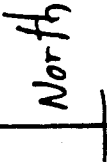

POOL  
AREA

PARKING

39'±

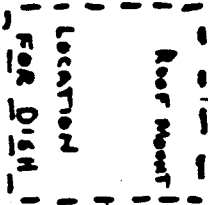

HOTEL  
4 STORY

35'±

EQUIPMENT LOCATION

6 2 - 2020

CASE FILE NO. 1074-54P  
RECEIVED. 11-1-88

APPROVED

SD [redacted] 11:20'

Note: Forces Listed Are Forces on Foundation at Respective Feet;  
Forces Are Positive In the Positive Directions of the Global  
X, Y, & Z Axes.

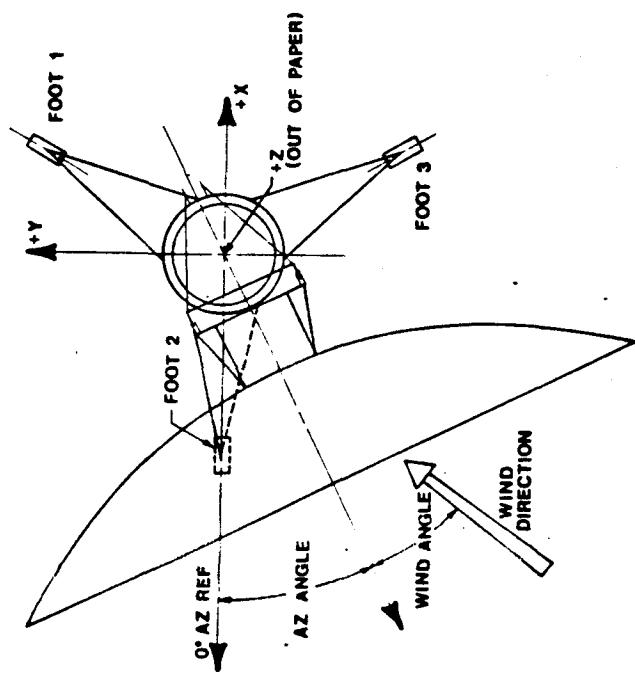

**FOUNDATION LOADING REFERENCE DIAGRAM**

Foundation Loads for a 110 MPH Steady Wind, No Ice, Reflector Weight Only

AZIMUTH ANGLE = 33

WIND ANGLE	EL ANGLE	FORCE COMPONENT	1	2	3
0	5	X	2785	2246	2317
0	5	Y	-2781	-563	-3025
0	5	Z	-1072	-9295	-8181
5	5	X	1167	1249	1257
5	5	Y	-1167	-1249	-1257
5	5	Z	-552	-2772	-1872
5	5	X	1151	1215	1215
5	5	Y	-1151	-1215	-1215
5	5	Z	-2082	-1041	-1041
10	5	X	1180	1215	1215
10	5	Y	-1180	-1215	-1215
10	5	Z	-1741	-1018	-1017
10	5	X	1156	1201	1202
10	5	Y	-1156	-1201	-1202
10	5	Z	-1989	-1084	-1084
10	5	X	1188	1215	1215
10	5	Y	-1188	-1215	-1215
10	5	Z	-1717	-1017	-1017
10	5	X	1193	1215	1215
10	5	Y	-1193	-1215	-1215
10	5	Z	-1655	-1017	-1017

AZIMUTH ANGLE = 33

WIND ANGLE	EL ANGLE	FORCE COMPONENT	1	2	3
60	5	X	3195	2517	2764
60	5	Y	-3195	-2517	-2764
60	5	Z	-1078	-9298	-8172
120	5	X	2710	2322	2489
120	5	Y	-2710	-2322	-2489
120	5	Z	-1178	-1007	-1007
0	5	X	4410	185	-115
0	5	Y	-4410	-185	115
0	5	Z	-1327	-1077	-1124
0	60	X	2819	259	-2808
0	60	Y	-2819	-259	2808
0	60	Z	-1551	-1075	-1075
0	90	X	4029	175	-475
0	90	Y	-4029	-175	475
0	90	Z	-1772	-1075	-1075
180	60	X	2011	280	-2577
180	60	Y	-2011	-280	2577
180	60	Z	-1717	-1017	-1017
180	60	X	1943	311	-2708
180	60	Y	-1943	-311	2708
180	60	Z	-1692	-1017	-1017

AZIMUTH ANGLE = 60

WIND ANGLE	EL ANGLE	FORCE COMPONENT	1	2	3
60	5	X	3853	3728	4087
60	5	Y	-3853	-3728	-4087
60	5	Z	-1078	-9298	-8172
120	5	X	2710	2322	2489
120	5	Y	-2710	-2322	-2489
120	5	Z	-1178	-1007	-1007
0	5	X	4410	185	-115
0	5	Y	-4410	-185	115
0	5	Z	-1327	-1077	-1124
0	60	X	2819	259	-2808
0	60	Y	-2819	-259	2808
0	60	Z	-1551	-1075	-1075
0	90	X	4029	175	-475
0	90	Y	-4029	-175	475
0	90	Z	-1772	-1075	-1075
180	60	X	2011	280	-2577
180	60	Y	-2011	-280	2577
180	60	Z	-1717	-1017	-1017
180	60	X	1943	311	-2708
180	60	Y	-1943	-311	2708
180	60	Z	-1692	-1017	-1017

**MAXIMUM LOADS**

- Maximum upward force on a single foot - 9299 lbs.
- Maximum tensile force on a single (anchor) bolt - 6966 lbs.
- Maximum downward force on a single foot - 9778 lbs.
- Maximum shear force on a single foot - 6809 lbs.
- Maximum lateral force on a single foot - 6183 lbs.
- Maximum longitudinal force on a single foot - 4287 lbs.
- Maximum total upward force on foundation - 8947 lbs.
- Maximum total downward force on foundation - 1392 lbs.
- Maximum torque on foundation about vertical axis - 8712 lbs. ft.
- Maximum overturning moment at azimuth axis at top of foundation - 68804 ft.-lbs.

Note: Total antenna wt. approx. 1660 lbs.  
Reflector wt. only approx. 1100 lbs.

A model BMS earth station will withstand 175 mph wind (10/30 lb/ft. per ANSI A58.1) with a load safety factor of 1.5. The antenna components and will not exceed the worst case loading conditions provided that the antenna is positioned in an 85 degree elevation angle, i.e., reflector pointed toward zenith.

APPLICABLE	UNIT	REVISION

Scientific-Atlanta  
FOUNDATION LOAD DATA  
4.5 METER ANTENNA

DATE: 10/10  
DRAWN BY: [Signature]  
CHECKED BY: [Signature]

ALL DIMENSIONS ARE IN INCHES  
UNLESS OTHERWISE SPECIFIED  
PARALLEL AND ALL DIMENSIONS ARE  
TO CENTER UNLESS OTHERWISE SPECIFIED

SCALE: 1/4" = 1'-0"

FRACCTIONS: ANGLES: 1/16" = 1'-0"  
1/32" = 1'-0"  
1/64" = 1'-0"

WEAR SURFACE DIMENSIONS IN INCHES  
RECEPTS AS NOTED

WEAR SURFACE DIMENSIONS IN INCHES  
AND CORNERS 90 DEGREE

DATE: 10/10  
DRAWN BY: [Signature]  
CHECKED BY: [Signature]

301758



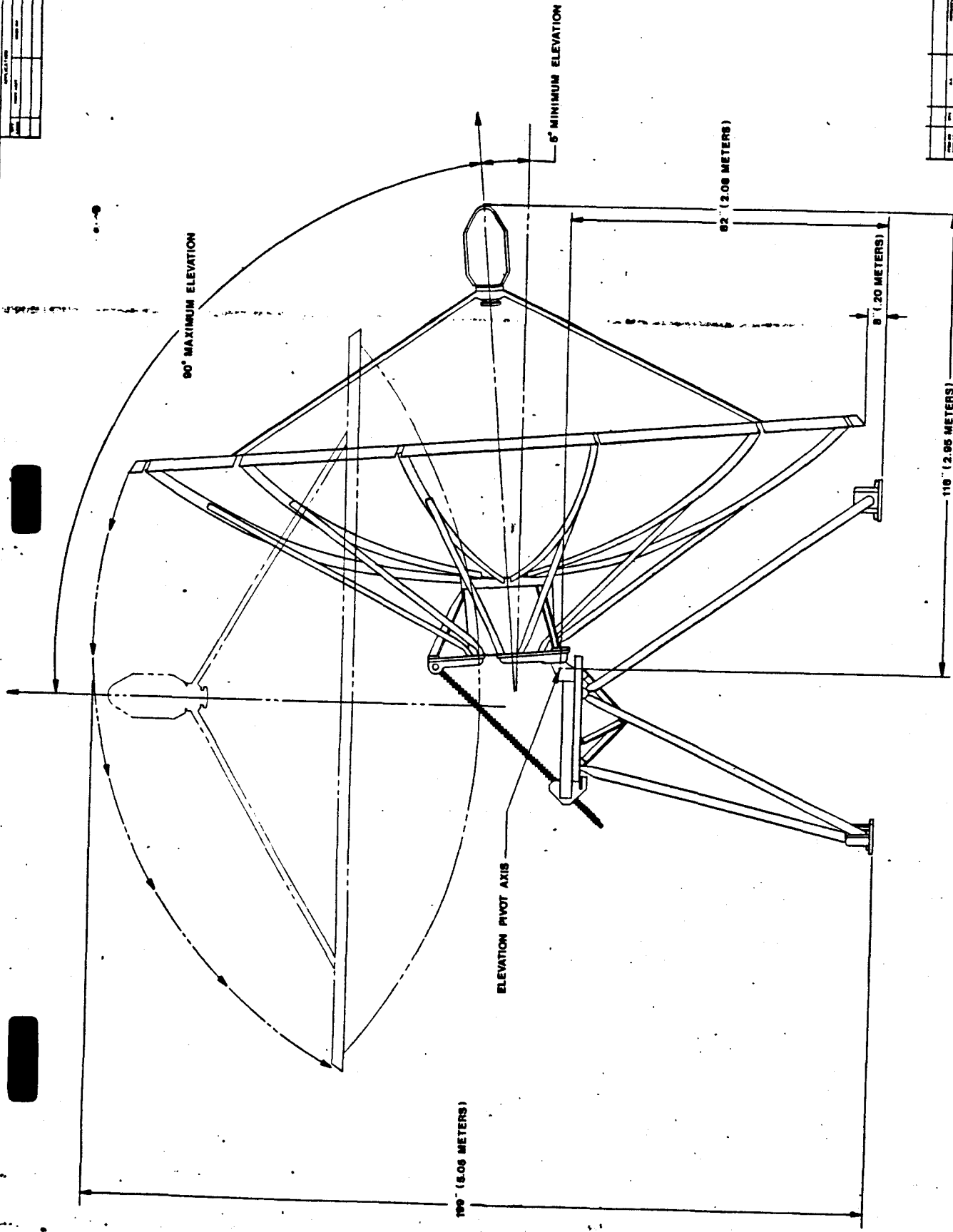

Scientific Atlanta		2000 Progress Road Atlanta, Georgia 30308	
4.5 METER ELAZ ANTENNA		OUTLINE DIMENSIONS	
Project No.	301749	Rev.	1
Drawn by	J. J. Jones	Checked by	J. J. Jones
Scale	1:1	Date	10/10/67
ALL DIMENSIONS ARE IN METERS UNLESS OTHERWISE SPECIFIED. DIMENSIONS ARE TO CENTER UNLESS OTHERWISE SPECIFIED. DIMENSIONS ARE TO CENTER UNLESS OTHERWISE SPECIFIED. DIMENSIONS ARE TO CENTER UNLESS OTHERWISE SPECIFIED.			



4.5 Meter Satellite TVRO Antenna  
ADDISON, TX

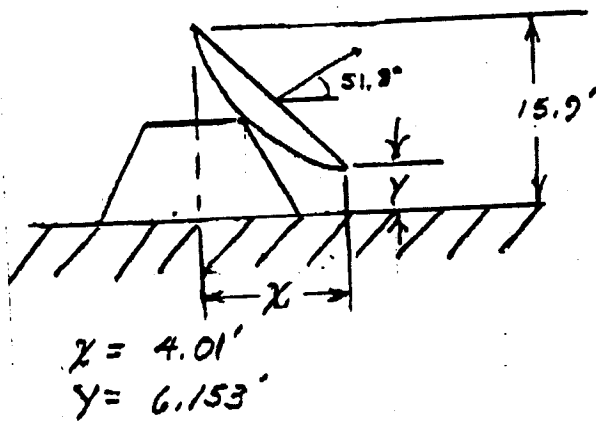

3) Distance to 15.9' fence

$$D = \frac{15.9'}{\tan 51.8^\circ} = 12.51'$$

9/16/88  
H. Siveman  
Sheet 1 of 1