

ORDINANCE NO. 090-053

AN ORDINANCE OF THE TOWN OF ADDISON, TEXAS, AMENDING THE COMPREHENSIVE ZONING ORDINANCE OF THE TOWN OF ADDISON, TEXAS, SO AS TO GRANT A SPECIAL USE PERMIT FOR A CHRISTMAS TREE LOT ON APPLICATION WITH TROW TREE FARMS, LOCATED AT THE NORTHEAST CORNER OF THE INTERSECTION OF MARSH LANE AND BELT LINE ROAD; PROVIDING FOR A REPEAL CLAUSE; PROVIDING FOR A PENALTY CLAUSE; AND PROVIDING FOR A SEVERABILITY CLAUSE.

WHEREAS, application was made to amend the Comprehensive Zoning Ordinance of the Town of Addison, Texas, by making application for the same with the Planning and Zoning Commission of the Town of Addison, Texas, as required by State Statutes and the zoning ordinance of the Town of Addison, Texas, and all the legal requirements, conditions and prerequisites having been complied with, the case having come before the City Council of Addison, Texas, after all legal notices, requirements, conditions and prerequisites having been complied with; and

WHEREAS, the City Council of the Town of Addison, Texas, does find that there is a public necessity for the zoning change, that the public demands it, that the public interest clearly requires the amendment, and it is in the best interest of the public at large, the citizens of the Town of Addison, and helps promote the general welfare and safety of this community, now, therefore,

BE IT ORDAINED BY THE CITY COUNCIL OF THE TOWN OF ADDISON, TEXAS:

SECTION 1. That Comprehensive Zoning Ordinance of the Town of Addison, Texas, as heretofore amended, is hereby amended so as to grant a special use permit to Trow Tree Farms. Said zoning amendment shall be noted on the official zoning map of the Town of Addison, Texas, and is situated on the following described land:

East side of Marsh Lane about 200 feet north of its intersection with Marsh Lane.

SECTION 2. That all ordinances of the City in conflict with the provisions of this ordinance be, and the same are hereby repealed and all other ordinances of the City not in conflict with the provisions of this ordinance shall remain in full force and effect.

SECTION 3. That any person, firm, or corporation violating any of the provisions or terms of this ordinance shall be subject to the same penalty as provided for in the Comprehensive Zoning Ordinance of the city, as heretofore amended, and upon conviction shall be punished by a fine not to exceed the sum of Two Thousand Dollars (\$2,000.00) and not less than Five Hundred Dollars (\$500.00) for each offense and that each day such violation shall continue to exist shall constitute a separate offense.

SECTION 4. That should any paragraph, sentence, subdivision, clause, phrase or section of this ordinance be adjudged or held to be unconstitutional, illegal or invalid, the same shall not affect the validity of this ordinance as a whole or any part or provisions thereof other than the part so decided to be invalid, illegal or unconstitutional, and shall not affect the validity of this ordinance as a whole.

DULY PASSED BY THE CITY COUNCIL OF THE TOWN OF ADDISON,
TEXAS, on this the 13th day of November, 1990.

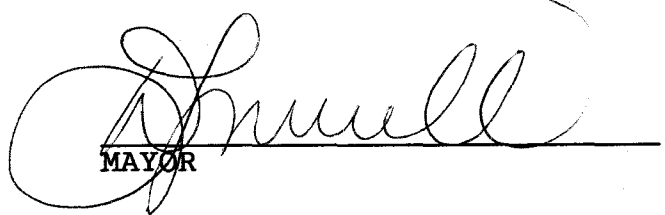
MAYOR

ATTEST:

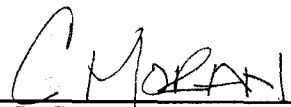
CITY SECRETARY

CASE NO. 1049-SUP

APPROVED AS TO FORM:

CITY SECRETARY

CHRISTMAS
TREE
LOT

MARSH LANE

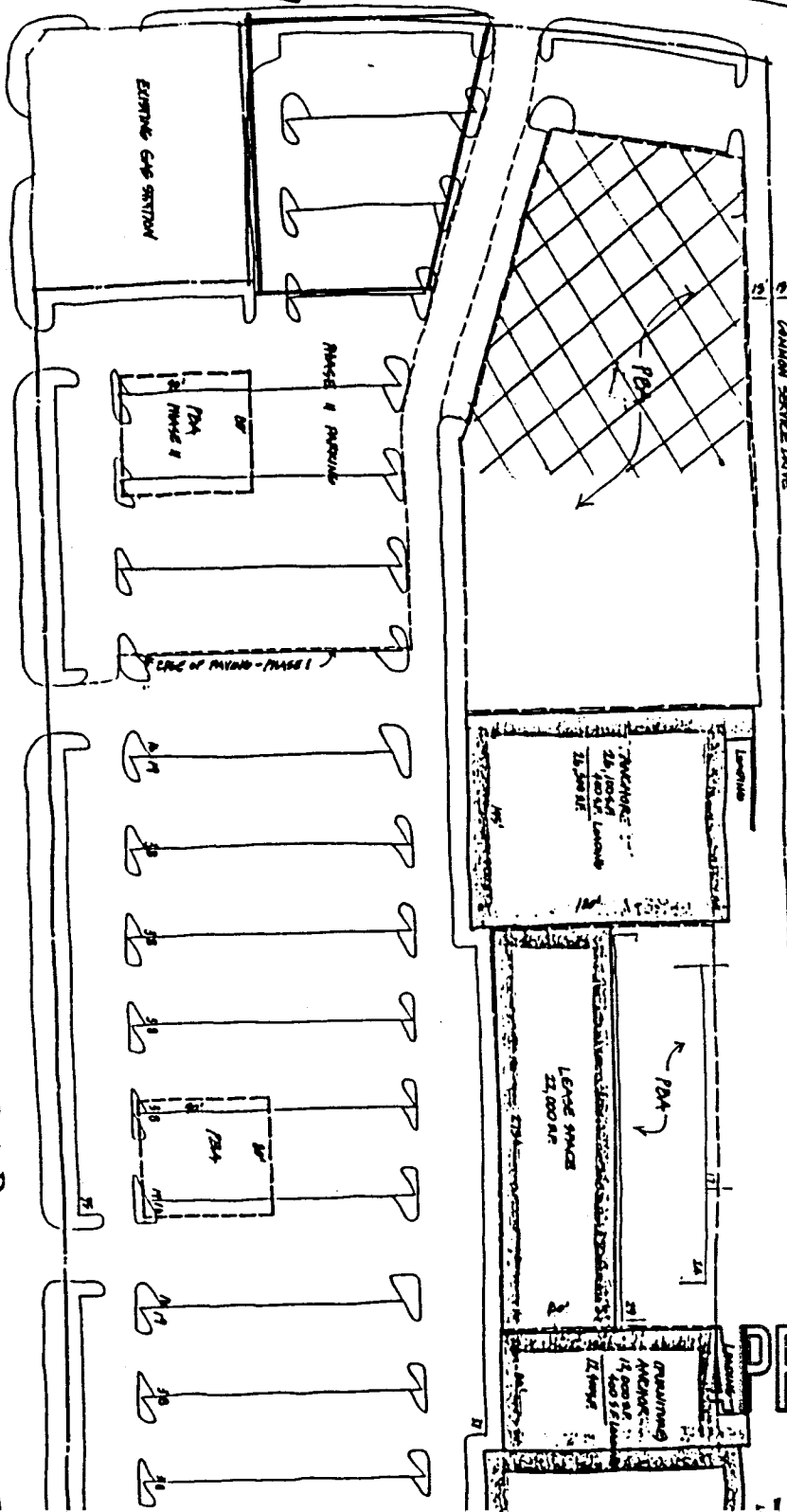

LAND AREA: 18,925 AC. (2,500 AC. NET)
 BUILDING AREA: 72,500 SQ. FEET
 TRUCKING AREA: 78,000 SQ. FEET
 TRUCKING AREA: 679 CARS
 TRUCKING AREA: 644 CARS

BELL LINE ROAD

THESE PLANS ARE REDUCTIONS OF THE ACTUAL
 SECOND SETS OF PLANS WHICH ARE FILED IN
 ZONING CASE FILE 1049-54P

APPROVED