

**ORDINANCE NO. 000- 018**

AN ORDINANCE OF THE TOWN OF ADDISON, TEXAS, AMENDING CHAPTER 14, SIGNS, OF THE CODE OF ORDINANCES, SO AS TO GRANT A MERITORIOUS EXCEPTION TO THE CITY'S SIGN ORDINANCE TO ALLOW A MONUMENT SIGN WITH A SETBACK OF LESS THAN 20 FEET, ON APPLICATION WITH E.E. REALTY, LOCATED AT 4949 KELLER SPRINGS ROAD, PROVIDING FOR A REPEAL CLAUSE; PROVIDING FOR A PENALTY CLAUSE; AND PROVIDING FOR A SEVERABILITY CLAUSE.

BE IT ORDAINED BY THE CITY COUNCIL OF THE TOWN OF ADDISON, TEXAS:

SECTION 1. In accordance with Chapter 62, Section 62-184 of the Sign Ordinance a meritorious exception is hereby granted to located at 4949 Keller Springs Road, to allow a monument sign with a setback of less than twenty (20) feet, in accordance with the drawings attached hereto and made a part hereof for all purposes.

SECTION 2. That all ordinances of the City in conflict with the provisions of this ordinance be, and the same are hereby repealed and all other ordinances of the City not in conflict with the provisions of this ordinance shall remain in full force and effect.

SECTION 3. That any person, firm, or corporation violating any of the provisions or terms of this ordinance shall be subject to a fine not to exceed the sum of Two Hundred Dollars (\$200.00) for each offense and that each day such violation shall continue to exist shall constitute a separate offense.

SECTION 4. That should any paragraph, sentence, subdivision, clause, phrase or section of this ordinance be adjudged or held to be unconstitutional, illegal or invalid, the same shall not affect the validity of this ordinance as a whole or any part or provisions thereof other than the part so decided to be invalid, illegal or unconstitutional, and shall not affect the validity of this ordinance as a whole.

DULY PASSED BY THE CITY COUNCIL OF THE TOWN OF ADDISON,  
TEXAS, on this the 23rd day of May, 2000.

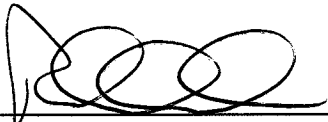
  
\_\_\_\_\_  
MAYOR

ATTEST:

  
\_\_\_\_\_  
CITY SECRETARY

CASE NO. ME2000-04

APPROVED AS TO FORM:

  
\_\_\_\_\_  
BUILDING OFFICIAL

PUBLISHED ON: \_\_\_\_\_

NOTE: THE SIGNAGE IS TO BE LOCATED AS SHOWN. THE SIGNAGE IS TO BE LOCATED AS SHOWN. THE SIGNAGE IS TO BE LOCATED AS SHOWN.

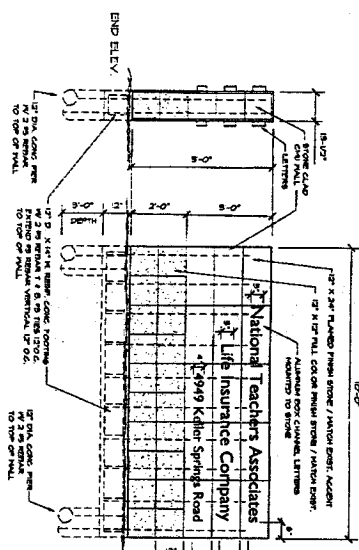

(B) ELEVATION: MONUMENT SIGN  
SCALE: 1/2" = 1'-0"

PLANT LIST

QUANTITY	SYMBOL	COMMON NAME	RECOMMENDED SPECIES	RECOMMENDED SIZE	RECOMMENDED PLACEMENT
1	(Symbol)	Large Tree	Live Oak	12" DBH	Front of building
2	(Symbol)	Medium Tree	Live Oak	8" DBH	Along driveway
3	(Symbol)	Small Tree	Live Oak	4" DBH	Along sidewalk
4	(Symbol)	Shrub	Yucca	4" DBH	Along driveway
5	(Symbol)	Shrub	Yucca	4" DBH	Along sidewalk
6	(Symbol)	Shrub	Yucca	4" DBH	Along driveway
7	(Symbol)	Shrub	Yucca	4" DBH	Along sidewalk
8	(Symbol)	Shrub	Yucca	4" DBH	Along driveway
9	(Symbol)	Shrub	Yucca	4" DBH	Along sidewalk
10	(Symbol)	Shrub	Yucca	4" DBH	Along driveway
11	(Symbol)	Shrub	Yucca	4" DBH	Along sidewalk
12	(Symbol)	Shrub	Yucca	4" DBH	Along driveway
13	(Symbol)	Shrub	Yucca	4" DBH	Along sidewalk
14	(Symbol)	Shrub	Yucca	4" DBH	Along driveway
15	(Symbol)	Shrub	Yucca	4" DBH	Along sidewalk
16	(Symbol)	Shrub	Yucca	4" DBH	Along driveway
17	(Symbol)	Shrub	Yucca	4" DBH	Along sidewalk
18	(Symbol)	Shrub	Yucca	4" DBH	Along driveway
19	(Symbol)	Shrub	Yucca	4" DBH	Along sidewalk
20	(Symbol)	Shrub	Yucca	4" DBH	Along driveway



(A) SECTION: BERM AND SHRUB SCREENING  
HORIZ. SCALE: 1/8" = 1'-0"  
VERT. SCALE: 1/4" = 1'-0"

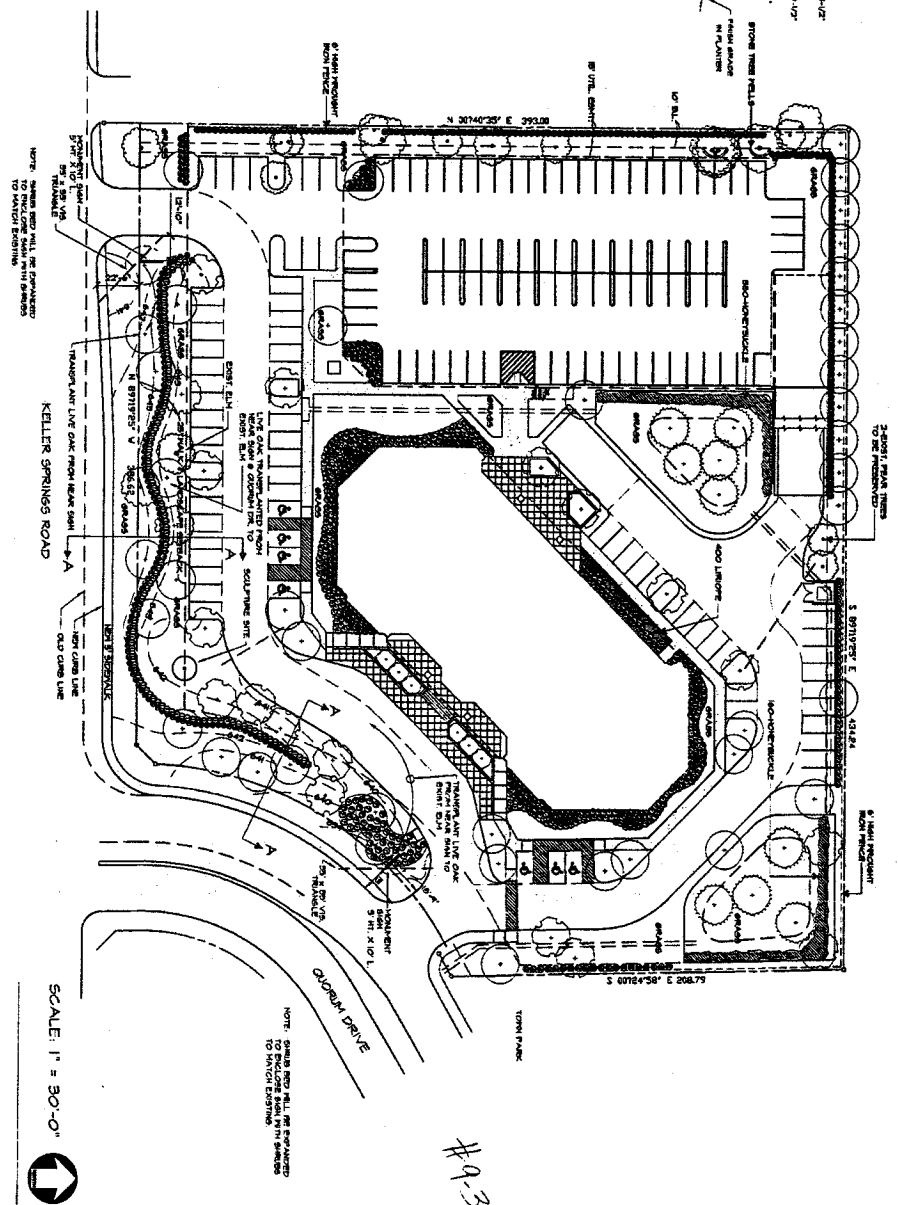

SCALE: 1" = 30'-0"

PROPERTY OWNER  
E.E. REALTY, INC.  
5220 SPRING VALLEY RD.  
DALLAS, TEXAS 75240  
PHONE (714) 950-1051

OFFICE OF THE CITY SECRETARY

REVISIONS  
DATE  
DRAWN BY  
CHECKED BY  
DATE

A NEW OFFICE BUILDING FOR  
NATIONAL TEACHERS ASSOC., INC.  
4849 KELLER SPRINGS ROAD  
ADDISON, TEXAS TRACT 20

MONUMENT SIGNS  
LANDSCAPE PLAN

BRUCE SMITH & ASSOCIATES  
PLANNING • LANDSCAPE ARCHITECTURE  
690 LBJ Freeway, Suite 200, Dallas, Texas 75240  
ORDINANCE NO. 000-018