

TOWN OF ADDISON, TEXAS
ORDINANCE NO. 008-005

AN ORDINANCE OF THE TOWN OF ADDISON, TEXAS, AMENDING THE COMPREHENSIVE ZONING ORDINANCE OF THE TOWN OF ADDISON, TEXAS, BY AMENDING ORDINANCE 601, SECTION 3, PARAGRAPH 3, TO PROVIDE FOR REVISED BUILDING HEIGHTS, AND SECTION 6 TO PROVIDE FOR A REVISED PARKING REQUIREMENT, ON APPLICATION FROM SUNSHINE HOLDINGS I CORP. (DBA HOTEL INTERCONTINENTAL, LOCATED AT 15201 DALLAS PARKWAY, PROVIDING FOR A PENALTY CLAUSE; PROVIDING FOR A SEVERABILITY CLAUSE; AND PROVIDING FOR A REPEAL CLAUSE.

WHEREAS, application was made to amend the Comprehensive Zoning Ordinance of the Town of Addison, Texas, by making application for the same with the Planning and Zoning Commission of the Town of Addison, Texas, as required by State Statutes and the zoning ordinance of the Town of Addison, Texas, and all the legal requirements, conditions and prerequisites having been complied with, the case having come before the City Council of Addison, Texas, after all legal notices, requirements, conditions and prerequisites having been complied with; and

WHEREAS, the City Council of the Town of Addison, Texas, does find that there is a public necessity for the zoning change, that the public demands it, that the public interest clearly requires the amendment, and it is in the best interest of the public at large, the citizens of the Town of Addison, Texas, and helps promote the general welfare and safety of this community, now, therefore,

BE IT ORDAINED BY THE CITY COUNCIL OF THE TOWN OF ADDISON, TEXAS:

SECTION 1. That Ordinance 601, duly passed by the Addison City Council on July 15, 1980, is hereby amended by amending **Section 3, Paragraph 3**, to read as follows:

No structure shall exceed a height of 790 feet above mean sea level.

SECTION 2. That Ordinance 601, duly passed by the Addison City Council on July 15, 1980, is hereby amended by amending **Section 6**, to read as follows:

All hotel or motel facilities shall provide off-street parking at the following ratios:

- a. One space per each guest room.
- b. One space per each 300 square feet of floor area of banquet and meeting space.
- c. No spaces required for malls, atriums, patios, lobbies, circulation areas, incidental retail establishments, bars or restaurants.

SECTION 3. That any person, firm, or corporation violating any of the provisions or terms of this ordinance shall be subject to the same penalty as provided for in the Comprehensive Zoning Ordinance of the city, as heretofore amended, and upon conviction shall be punished by a fine set in accordance with Chapter 1, General Provisions, Section 1.10, General penalty for violations of Code; continuing violations, of the Code of Ordinances for the Town of Addison.

SECTION 4. That should any paragraph, sentence, subdivision, clause, phrase or section of this ordinance be adjudged or held to be unconstitutional, illegal or invalid, the same shall not affect the validity of this ordinance as a whole or any part or provisions thereof other than the part so decided to be invalid, illegal or unconstitutional, and shall not affect the validity of this ordinance as a whole.

SECTION 5. That all ordinances of the City in conflict with the provisions of this ordinance be, and the same are hereby repealed and all other ordinances of the City not in conflict with the provisions of this ordinance shall remain in full force and effect.

DULY PASSED BY THE CITY COUNCIL OF THE TOWN OF ADDISON, TEXAS, on this the 11th day of March, 2008.

MAYOR-Joe Chow

ATTEST:



CITY SECRETARY-Mario Canizares

CASE NO.: 1553-Z/Hotel Intercontinental

APPROVED AS TO FORM:

DIRECTOR OF DEVELOPMENT SERVICES-
Carmen Moran

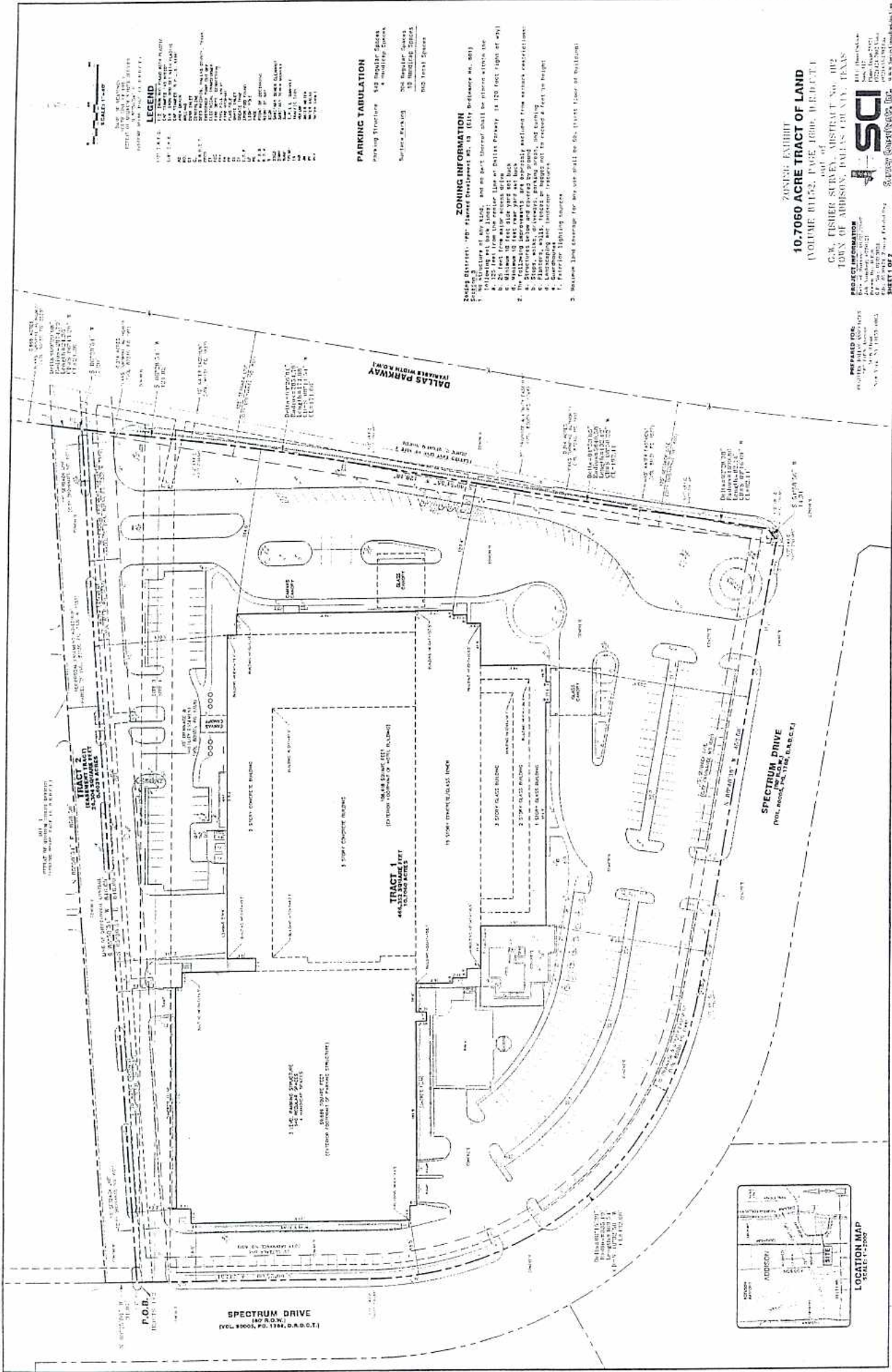
PUBLISHED ON: 5/11/2008



LEGEND

1. 1.5" = 1' SCALE

2. 1.5" = 1' SCALE

3. 1.5" = 1' SCALE

4. 1.5" = 1' SCALE

5. 1.5" = 1' SCALE

6. 1.5" = 1' SCALE

7. 1.5" = 1' SCALE

8. 1.5" = 1' SCALE

9. 1.5" = 1' SCALE

10. 1.5" = 1' SCALE

11. 1.5" = 1' SCALE

12. 1.5" = 1' SCALE

13. 1.5" = 1' SCALE

14. 1.5" = 1' SCALE

15. 1.5" = 1' SCALE

16. 1.5" = 1' SCALE

17. 1.5" = 1' SCALE

18. 1.5" = 1' SCALE

19. 1.5" = 1' SCALE

20. 1.5" = 1' SCALE

21. 1.5" = 1' SCALE

22. 1.5" = 1' SCALE

23. 1.5" = 1' SCALE

24. 1.5" = 1' SCALE

25. 1.5" = 1' SCALE

26. 1.5" = 1' SCALE

27. 1.5" = 1' SCALE

28. 1.5" = 1' SCALE

29. 1.5" = 1' SCALE

30. 1.5" = 1' SCALE

31. 1.5" = 1' SCALE

32. 1.5" = 1' SCALE

33. 1.5" = 1' SCALE

34. 1.5" = 1' SCALE

35. 1.5" = 1' SCALE

36. 1.5" = 1' SCALE

37. 1.5" = 1' SCALE

38. 1.5" = 1' SCALE

39. 1.5" = 1' SCALE

40. 1.5" = 1' SCALE

41. 1.5" = 1' SCALE

42. 1.5" = 1' SCALE

43. 1.5" = 1' SCALE

44. 1.5" = 1' SCALE

45. 1.5" = 1' SCALE

46. 1.5" = 1' SCALE

47. 1.5" = 1' SCALE

48. 1.5" = 1' SCALE

49. 1.5" = 1' SCALE

50. 1.5" = 1' SCALE

51. 1.5" = 1' SCALE

52. 1.5" = 1' SCALE

53. 1.5" = 1' SCALE

54. 1.5" = 1' SCALE

55. 1.5" = 1' SCALE

56. 1.5" = 1' SCALE

57. 1.5" = 1' SCALE

58. 1.5" = 1' SCALE

59. 1.5" = 1' SCALE

60. 1.5" = 1' SCALE

61. 1.5" = 1' SCALE

62. 1.5" = 1' SCALE

63. 1.5" = 1' SCALE

64. 1.5" = 1' SCALE

65. 1.5" = 1' SCALE

66. 1.5" = 1' SCALE

67. 1.5" = 1' SCALE

68. 1.5" = 1' SCALE

69. 1.5" = 1' SCALE

70. 1.5" = 1' SCALE

71. 1.5" = 1' SCALE

72. 1.5" = 1' SCALE

73. 1.5" = 1' SCALE

74. 1.5" = 1' SCALE

75. 1.5" = 1' SCALE

76. 1.5" = 1' SCALE

77. 1.5" = 1' SCALE

78. 1.5" = 1' SCALE

79. 1.5" = 1' SCALE

80. 1.5" = 1' SCALE

81. 1.5" = 1' SCALE

82. 1.5" = 1' SCALE

83. 1.5" = 1' SCALE

84. 1.5" = 1' SCALE

85. 1.5" = 1' SCALE

86. 1.5" = 1' SCALE

87. 1.5" = 1' SCALE

88. 1.5" = 1' SCALE

89. 1.5" = 1' SCALE

90. 1.5" = 1' SCALE

91. 1.5" = 1' SCALE

92. 1.5" = 1' SCALE

93. 1.5" = 1' SCALE

94. 1.5" = 1' SCALE

95. 1.5" = 1' SCALE

96. 1.5" = 1' SCALE

97. 1.5" = 1' SCALE

98. 1.5" = 1' SCALE

99. 1.5" = 1' SCALE

100. 1.5" = 1' SCALE

PARKING TABULATION

Playing Structure 140 Regular Spaces
4 Multiple Spaces

Surface Parking 100 Regular Spaces
10 Multiple Spaces
100 Total Spaces

ZONING INFORMATION

2004 Ordinance, "P" Planned Development, is (City Ordinance No. 201)

1. The minimum lot area shall be 10,000 square feet.

2. The minimum lot width shall be 100 feet.

3. The minimum lot depth shall be 100 feet.

4. The minimum lot area shall be 10,000 square feet.

5. The minimum lot width shall be 100 feet.

6. The minimum lot depth shall be 100 feet.

7. The minimum lot area shall be 10,000 square feet.

8. The minimum lot width shall be 100 feet.

9. The minimum lot depth shall be 100 feet.

10. The minimum lot area shall be 10,000 square feet.

11. The minimum lot width shall be 100 feet.

12. The minimum lot depth shall be 100 feet.

13. The minimum lot area shall be 10,000 square feet.

14. The minimum lot width shall be 100 feet.

15. The minimum lot depth shall be 100 feet.

16. The minimum lot area shall be 10,000 square feet.

17. The minimum lot width shall be 100 feet.

18. The minimum lot depth shall be 100 feet.

19. The minimum lot area shall be 10,000 square feet.

20. The minimum lot width shall be 100 feet.

21. The minimum lot depth shall be 100 feet.

22. The minimum lot area shall be 10,000 square feet.

23. The minimum lot width shall be 100 feet.

24. The minimum lot depth shall be 100 feet.

25. The minimum lot area shall be 10,000 square feet.

26. The minimum lot width shall be 100 feet.

27. The minimum lot depth shall be 100 feet.

28. The minimum lot area shall be 10,000 square feet.

29. The minimum lot width shall be 100 feet.

30. The minimum lot depth shall be 100 feet.

31. The minimum lot area shall be 10,000 square feet.

32. The minimum lot width shall be 100 feet.

33. The minimum lot depth shall be 100 feet.

34. The minimum lot area shall be 10,000 square feet.

35. The minimum lot width shall be 100 feet.

36. The minimum lot depth shall be 100 feet.

37. The minimum lot area shall be 10,000 square feet.

38. The minimum lot width shall be 100 feet.

39. The minimum lot depth shall be 100 feet.

40. The minimum lot area shall be 10,000 square feet.

41. The minimum lot width shall be 100 feet.

42. The minimum lot depth shall be 100 feet.

43. The minimum lot area shall be 10,000 square feet.

44. The minimum lot width shall be 100 feet.

45. The minimum lot depth shall be 100 feet.

46. The minimum lot area shall be 10,000 square feet.

47. The minimum lot width shall be 100 feet.

48. The minimum lot depth shall be 100 feet.

49. The minimum lot area shall be 10,000 square feet.

50. The minimum lot width shall be 100 feet.

51. The minimum lot depth shall be 100 feet.

52. The minimum lot area shall be 10,000 square feet.

53. The minimum lot width shall be 100 feet.

54. The minimum lot depth shall be 100 feet.

55. The minimum lot area shall be 10,000 square feet.

56. The minimum lot width shall be 100 feet.

57. The minimum lot depth shall be 100 feet.

58. The minimum lot area shall be 10,000 square feet.

59. The minimum lot width shall be 100 feet.

60. The minimum lot depth shall be 100 feet.

61. The minimum lot area shall be 10,000 square feet.

62. The minimum lot width shall be 100 feet.

63. The minimum lot depth shall be 100 feet.

64. The minimum lot area shall be 10,000 square feet.

65. The minimum lot width shall be 100 feet.

66. The minimum lot depth shall be 100 feet.

67. The minimum lot area shall be 10,000 square feet.

68. The minimum lot width shall be 100 feet.

69. The minimum lot depth shall be 100 feet.

70. The minimum lot area shall be 10,000 square feet.

71. The minimum lot width shall be 100 feet.

72. The minimum lot depth shall be 100 feet.

73. The minimum lot area shall be 10,000 square feet.

74. The minimum lot width shall be 100 feet.

75. The minimum lot depth shall be 100 feet.

76. The minimum lot area shall be 10,000 square feet.

77. The minimum lot width shall be 100 feet.

78. The minimum lot depth shall be 100 feet.

79. The minimum lot area shall be 10,000 square feet.

80. The minimum lot width shall be 100 feet.

81. The minimum lot depth shall be 100 feet.

82. The minimum lot area shall be 10,000 square feet.

83. The minimum lot width shall be 100 feet.

84. The minimum lot depth shall be 100 feet.

85. The minimum lot area shall be 10,000 square feet.

86. The minimum lot width shall be 100 feet.

87. The minimum lot depth shall be 100 feet.

88. The minimum lot area shall be 10,000 square feet.

89. The minimum lot width shall be 100 feet.

90. The minimum lot depth shall be 100 feet.

91. The minimum lot area shall be 10,000 square feet.

92. The minimum lot width shall be 100 feet.

93. The minimum lot depth shall be 100 feet.

94. The minimum lot area shall be 10,000 square feet.

95. The minimum lot width shall be 100 feet.

96. The minimum lot depth shall be 100 feet.

97. The minimum lot area shall be 10,000 square feet.

98. The minimum lot width shall be 100 feet.

99. The minimum lot depth shall be 100 feet.

100. The minimum lot area shall be 10,000 square feet.

ZONING EXHIBIT

10.7060 ACRE TRACT OF LAND

VOLUME 01152, PAGE 1899, DEBET 1

OUT OF

G.M. FISHER SURVEY, ABSTRACT No. 402

TOWN OF ADDISON, DALLAS COUNTY, TEXAS

PSD

Professional Seal of a Professional Surveyor

State of Texas

Surveyor's License No. 12345

Surveyor: Robert G. Baker, Inc.

DATE: 10/15/2007

SHEET 1 OF 2



