

ADJUST EX. MH
RIM TO PROP.
ELEV. PER
SHEET C-3
RIM=650.66

STA 1+00.00
CONNECT TO
EXISTING 10" WATER
W/10"x8" TSV

STA. 1+1.31
PROP. 8" WL
CROSSING
PROPERTY LINE
N=5356.31
E=5197.51

SOJOURN DRIVE
(60' R.O.W.)

ALT PAVING

WL/SEWER CROSSING
REFER TO NOTE 22
THIS SHEET

STA. 2+95.33
INSTALL:
1-8"x6" TEE
1-8" GV

WL/SEWER CROSSING
REFER TO NOTE 22
THIS SHEET

CONNECT TO
EXISTING 8" SS
CONSTRUCT
1-4' SSMH PER TOWN
OF ADDISON DETAILS
RIM=648.65
FL= 640.06
N=5095.98
E=5209.01

ADJUST EX. MH
RIM TO PROP.
ELEV. PER
SHEET C-3
RIM=647.53

STA: 6+30.58, 8.00' R.
INSTALL:
1-FH ASSEMBLY

STA: 6+15.66
INSTALL:
1-8"x8" TEE
1-8" GV

EXISTING SS
EASEMENT

15' UTILITY
EASEMENT

8" WATER - LINE "A"

24' FIRELANE/UTILITY/NON-EXCLUSIVE INGRESS & EGRESS EASEMENT

15' UTILITY
EASEMENT

INSTALL:
1-2" WM
N=5302.32
E=5181.12

STA 1+64.49
INSTALL:
1-8"x2" TEE
1-2" GV
1-8" GV

STA: 2+95.33, 8.00' RT
INSTALL:
1-FH ASSEMBLY

STA 6+15.66, 14' RT
INSTALL:
1-8"x2" TEE
1-2" GV

SD LINE "B"

EXISTING
SS EASEMENT

6" SS LINE "A"
@ 2.6%

STA 6+15.66, 74.40' RT
INSTALL:
1-DOUBLE CHECK DETECTOR
FIRE SERVICE ASSEMBLY
N=4851.16
E=5123.12

INSTALL:
1-CLEANOUT
FL=645.00
N=5095.99
E=5016.12

9'x8' TRANSFORM
PAD. REFER TO
MEP PLANS
FOR DETAILS.

5.00'

5.00'



FRESHE & NICHOLS
1541 W. Meacham Lane, Suite 250
Dallas, Texas 75247
214-620-0200

OMNIPLAN ARCHITECTS
SOJOURN OFFICE CENTER
ADDISON, TEXAS
SITWORK PLANS
UTILITY PLAN

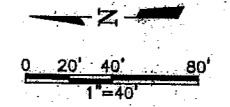

BENCHMARK:
SQUARE CUT ON INLET AT S.W. CORNER OF SOJOURN DR. AND ADDISON RD. ELEV. 641.95

LEGEND:

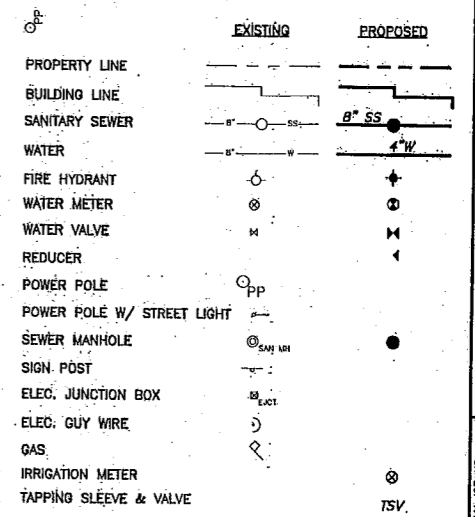

UTILITY PLAN NOTES:

- HORIZONTAL AND VERTICAL LOCATIONS OF EXISTING SUBSURFACE UTILITIES HAVE BEEN DETERMINED FROM DATA RECORDED BY OTHERS. CONTRACTOR SHALL VERIFY THE LOCATIONS PRIOR TO CONSTRUCTION. NEITHER THE OWNER NOR ENGINEER ASSUMES RESPONSIBILITY FOR THE POSSIBILITY THAT UTILITIES OTHER THAN THOSE SHOWN EXIST.
- THE CONTRACTOR SHALL BE RESPONSIBLE FOR NOTIFYING UTILITY COMPANIES HAVING PROPERTY IN THE AREA OF CONSTRUCTION A MINIMUM OF 48 HOURS PRIOR TO ANY EXCAVATION. THE CONTRACTOR SHALL CONTACT THE PROPER UTILITY REPRESENTATIVE AS FOLLOWS FOR QUESTIONS OR COORDINATION OF CONSTRUCTION RELATED TO EXISTING UTILITIES.

SW BELL	1-800-395-0440
GTE	1-800-344-8377
TU ELECTRIC	1-800-233-2133
LONG STAR GAS	1-800-344-8377
TCL CABLE	1-800-344-8377
- ALL WATER, SEWER AND DRAINAGE MATERIALS AND CONSTRUCTION SHALL COMPLY TO THE TOWN OF ADDISON REQUIREMENTS AND NORTH CENTRAL TEXAS COUNCIL OF GOVERNMENTS STANDARDS.
- INSPECTION OF WATER AND SEWER UTILITIES, CLEANING, TESTING, AND CHLORINATION SHALL BE APPROVED BY THE TOWN OF ADDISON.
- FIRE WATER PIPE SHALL BE AWWA PVC C-900, DR-14, CLASS 200. WATERLINES A & B SHALL BE AWWA PVC C-900, DR-18, CLASS 150.
- SEWER PIPE SHALL BE PVC, SDR-35, CONFORMING TO ASTM D-3034.
- THE CONTRACTOR, AT THEIR EXPENSE, SHALL REPAIR ALL NEW DAMAGE TO EXISTING UTILITIES ROADWAYS, OR SIDEWALKS, CAUSED BY HIS EQUIPMENT OR NEGLIGENCE.
- THE CONTRACTOR SHALL COORDINATE CONNECTION OF ALL UTILITIES TO BLDG. WITH MECHANICAL ELECTRICAL AND PLUMBING SHEETS.
- TRAFFIC BARRICADES WILL BE REQUIRED FOR ALL UTILITY CONSTRUCTION IN THE RIGHT-OF-WAY. BARRICADES SHALL CONFORM TO THE INSTALLATION SHOWN IN THE 1980 TEXAS MANUAL OF UNIFORM TRAFFIC CONTROL DEVICES, AS CURRENTLY AMENDED, TEXAS DEPARTMENT OF TRANSPORTATION.
- ALL TRENCH EXCAVATION SHALL BE IN ACCORDANCE WITH THE U.S. DEPARTMENT OF LABOR OCCUPATIONAL SAFETY AND HEALTH ADMINISTRATORS STANDARDS (OSHA). THE UTILITY CONTRACTOR SHALL SUBMIT TO THE CITY OF ADDISON, AN APPROVED TRENCH SAFETY PLAN, SEALED BY A PROFESSIONAL ENGINEER REGISTERED IN THE STATE OF TEXAS, FOR THE INSTALLATION OF UTILITIES GREATER THAN 6' IN DEPTH.
- ALL VALVE BOXES, MANHOLES, FIRE HYDRANTS AND WATER METERS SHALL BE SET TO MATCH FINISHED GRADE. ALL VALVES IN THE ROW SHALL BE MARKED PER THE CITY OF ADDISON REQUIREMENTS.
- ALL 6" (AND SMALLER) WATER LINES SHALL HAVE 42" MINIMUM COVER BELOW THE GRADE OF ALL STRUCTURES AND PAVING. ALL 8" WATER LINES SHALL HAVE 48" MINIMUM COVER.
- THE CONTRACTOR SHALL COORDINATE WATER SERVICE LINES AND METER TRANSFERS WITH THE OWNER. THE CONTRACTOR WILL BE RESPONSIBLE FOR MATERIAL AND LABOR OF ALL RELATED WORK AND TRANSFERS OF SERVICE.
- THE CONTRACTOR WILL BE RESPONSIBLE FOR KEEPING EXISTING WATER MAINS IN SERVICE DURING CONSTRUCTION.
- FIRE LINE AND FIRE DEPARTMENT CONNECTION SHALL BE CONSTRUCTED BY A CERTIFIED FIRE PROTECTION CONTRACTOR.
- THE CONTRACTOR SHALL LOCATE THE HORIZONTAL AND VERTICAL LOCATION OF ALL EXISTING UTILITY LINES REQUIRING A CONNECTION OR TIE IN. THE GRADE OF THE PROPOSED LINES SHALL BE ADJUSTED ACCORDINGLY, BASED ON ACTUAL FIELD CONDITIONS.
- TRENCH BACK FILL IN UNPAVED AREAS SHALL BE FOUR INCHES OF TOPSOIL PLUS SEEDING AND SHALL ACCOUNT FOR SETTLEMENT WHEN ESTABLISHING FINISHED GRADE.
- THE CONTRACTOR SHALL INSTALL STANDARD BENDS AT LOCATIONS SHOWN. ALL NON-STANDARD VERTICAL AND HORIZONTAL BENDS SHALL BE INSTALLED USING STANDARD BENDS AND 75% OF THE MAX. ALLOWABLE JOINT DEFLECTIONS AND MIN. RADIUS AS RECOMMENDED BY THE PIPE MANUFACTURER.
- THE CONTRACTOR SHALL PROVIDE ALL THRUST BLOCKING AT ALL FITTINGS AS RECOMMENDED BY THE PIPE MANUFACTURER.
- ALL WATER LINES SHALL BE HYDROSTATICALLY TESTED AND STERILIZED PER CITY OF ADDISON STANDARDS AND SPECIFICATIONS.
- UTILITY TRENCHES SHALL BE BACK FILLED WITH MATERIAL, PER DETAILS ON C-11.
- AT SANITARY SEWER AND WATER LINE CROSSINGS, WATER LINES SHALL CROSS ABOVE SANITARY SEWER LINES WITH A 2" MINIMUM CLEARANCE AND A 1'-20" JOINT, ON THE SEWER LINE, CENTERED BELOW THE CROSSING. CONCRETE ENCASUREMENT SHALL BE USED, AS DIRECTED BY ENGINEER IF ABOVE CRITERIA CANNOT BE SATISFIED.
- WATER LINE ADJUSTMENTS REQUIRED TO CLEAR UTILITIES SHALL BE CONSTRUCTED WITH STANDARD BENDS, CONCRETE BLOCKING, AND MAINTAINING A MINIMUM 2" VERTICAL CLEARANCE AS SHOWN IN THE DETAILS ON SHEET C-11.
- SEE MEP SHEETS FOR UTILITY CONTINUATION INTO BUILDING, TRANSFORMER YARD LAYOUT, DETAILS, CONDUIT FOR PRIMARY SERVICE TO BUILDING, PARKING LOT LIGHTING, FIRE DEPARTMENT CONNECTION, AND GAS LAYOUT.
- DOMESTIC WATER METERS SHALL COMPLY WITH THE TOWN OF ADDISON SPECIFICATION # 6-95.
- FH ASSEMBLIES SHALL CONSIST OF VARYING LENGTHS OF 6" W LEAD, 1-6" GATE VALVE, AND 1-FIRE HYDRANT. ALL MJ CONNECTIONS TO BE SECURED WITH "MEGALUG" OR APPROVED EQUAL, 6" MAX. BURY DEPTH TO SIDE (MAIN VALVE).
- THE CONTRACTOR SHALL STAMP A 2" "W" AND A 2" "S" IN THE CURB AT THE LOCATION OF THE WATER AND SEWER SERVICE LINES, RESPECTFULLY.
- SANITARY SEWER MANHOLES, AND CLEANOUTS SHALL BE PER THE TOWN OF ADDISON STANDARD SPECIFICATIONS AND DETAILS.
- REFER TO SHEET C-3 (GRADING PLAN) FOR ALL VALVE, AND MANHOLE RIM ELEVATIONS.
- WATER VALVES TO MEET ADDISON SPEC. GV85-1, RESILIENT WEDGE GATE VALVES.

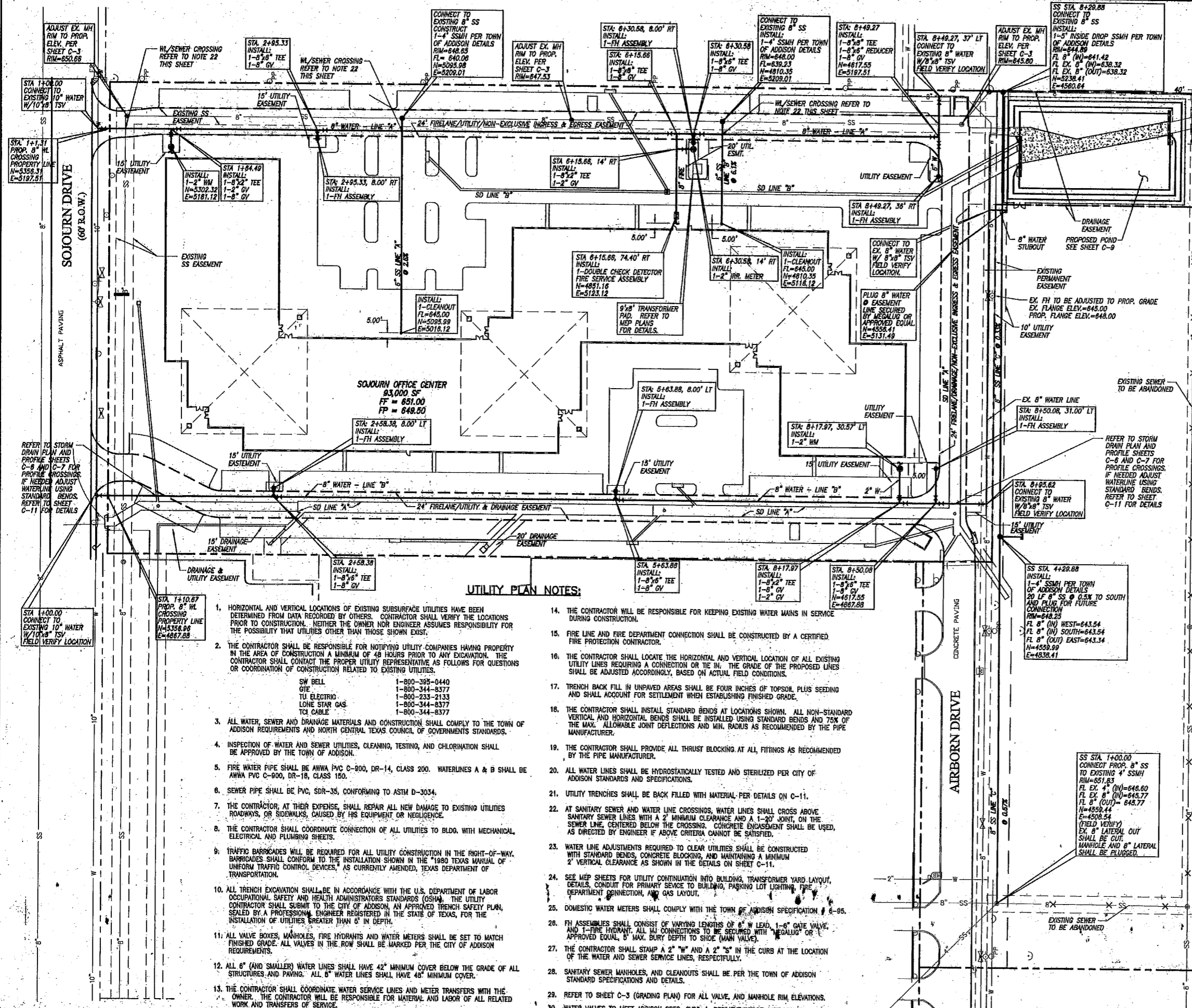

NO.	REVISION	DATE	BY	DATE	FILE	DATE	DESIGNED	DRAWN	CHECKED	TITLE
1	PER CONTRACTOR SET 'T' AND 'S'	4/25/99	WPH	6/2/99	2060UTL	7-28-99				
2	REVISED PER MEETING FF. 1 FOOT									
3	REVISIONS PER CITY COMMENTS									
4	PER NORTH PL. WORKING & SOUTH									

Bar is one inch on original drawing. If not one inch on this sheet, adjust scale.

SCALE: 1" = 40'

SHEET **C-10**

SEQ. 13 OF 16

"AS-BUILTS"