

LEVINOBLE SURVEY
ABSTRACT NO. 1098

POINT OF BEGINNING

POINT OF COMMENCING

SOJOURN DRIVE
(60' R.O.W.)

S89°53'14"E 866.42'

S89°53'14"E 423.55'

BLOCK A
13.865 ACRES
603,946 S.F.

BLOCK "A"
CARROLL ESTATES
VOL. 10, PG. 473,
D.R.D.C.T.

CALLED 6,984 ACRES
YAAKOV KAUSHER AND
WENDY L. KAUSHER
VOL. 93228, PG. 5470,
D.R.D.C.T.

REMAINDER OF
CALLED 18,258 ACRES
VOL. 69216, PG. 1560,
D.R.D.C.T.

CALLED 13,860 ACRES
PALMETTO CORNERS, LTD.
VOL. 97248, PG. 523,
D.R.D.C.T.

BENT TREE GARDENS,
PHASE II
VOL. 7993, PG. 2282,
D.R.D.C.T.

WESTGROVE DRIVE
(60' R.O.W.)

AIRBORN DRIVE

CALLED 13,860 ACRES
PALMETTO CORNERS, LTD.
VOL. 97248, PG. 523,
D.R.D.C.T.

WILLIAM LOMAX SURVEY
ABSTRACT NO. 792

CALLED 18,742 ACRES
EXCEL MANAGEMENT SERVICE, INC.
VOL. 96107, PG. 454,
D.R.D.C.T.

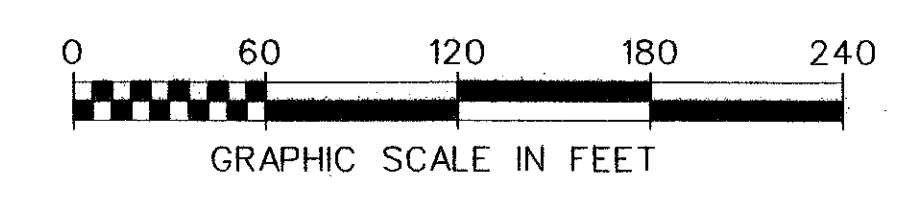

ABBREVIATIONS

- R.O.W. = RIGHT-OF-WAY
- W/CAP = WITH CAP
- IRS = IRON ROD SET
- IRF = IRON ROD FOUND
- DRDCT = DEED RECORDS DALLAS COUNTY, TEXAS
- S.F. = SQUARE FEET
- VOL. = VOLUME
- PG. = PAGE

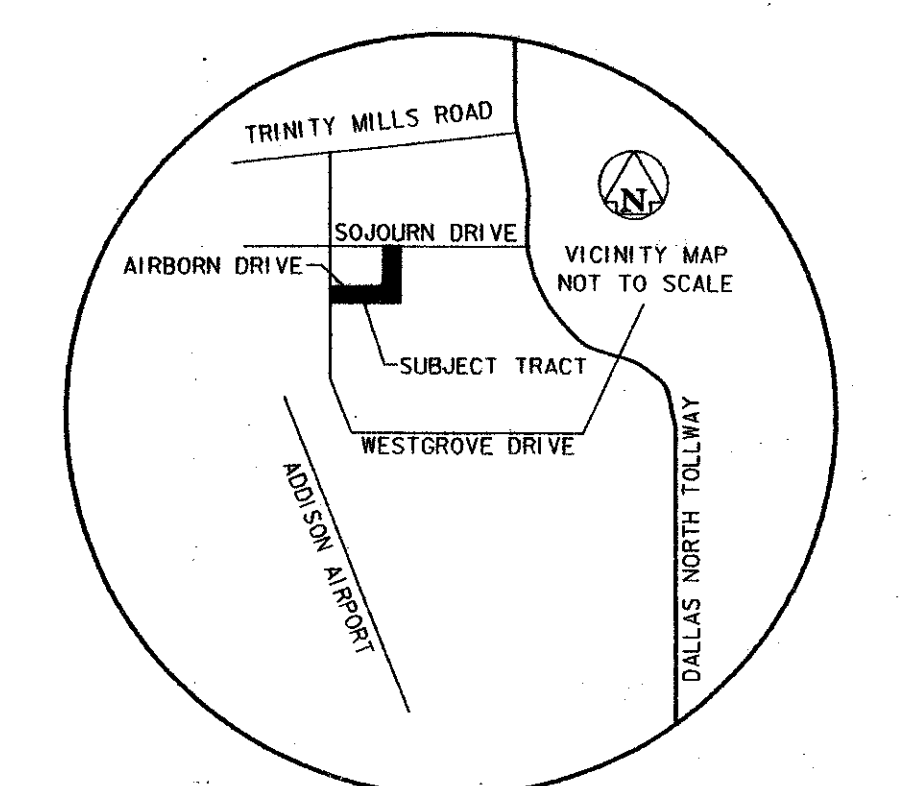

FILED FOR RECORD IN
VOLUME 99116, PAGE, 00068

FINAL PLAT
LOTS 1, 2, & 3, BLOCK A
SOJOURN PLAZA ADDITION

AN ADDITION TO THE TOWN OF ADDISON, TEXAS
AND BEING SITUATED IN THE
LEVI NOBLES SURVEY, ABST. NO. 1098
AND THE
WILLIAM LOMAX SURVEY, ABST. NO. 792
DALLAS COUNTY, TEXAS

Garcia & Associates Engineering, Inc.
4809 HAWTHORN BLVD. SUITE 300
FORT WORTH, TEXAS 76133
817-484-1993

TRANSPORTATION • TRAFFIC • SURVEYING
WATER/WASTEWATER • ENVIRONMENTAL

OWNER:
WILCOX INTERESTS, INC.
5420 LBJ FREEWAY, STE. 740
DALLAS, TEXAS 75240
(972)770-2111

ENGINEER:
FREESE AND NICHOLS, INC.
1341 W. MOCKINGBIRD LANE, STE. 230-E
DALLAS, TEXAS 75247
(214)920-2500

MAY 24, 1999

○ = 1/2" IRON RODS SET AT LOT CORNERS

FILED
99 JUN 15 PM 2:41
EARL BULLOCK
COUNTY CLERK
DALLAS COUNTY