

DEMOTLITION PLAN

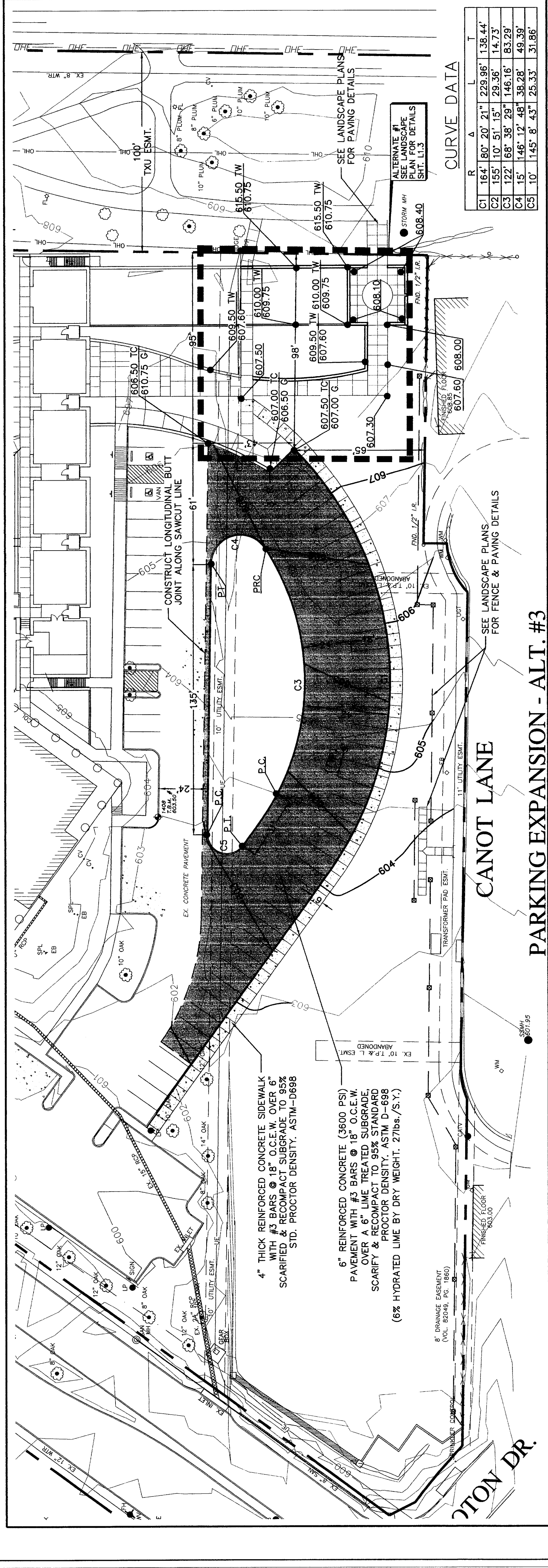

PARKING EXPANSION - ALT. #3

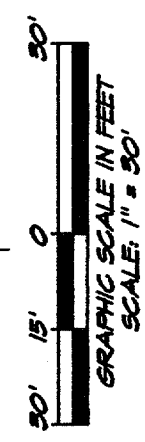

PAVING NOTES

1. ALL MATERIALS AND WORKMANSHIP SHALL CONFORM TO THE STANDARD SPECIFICATIONS FOR PUBLIC WORKS CONSTRUCTION AND N.C.C.O.C. LATEST EDITION, AND THE TOWN OF ADDISON STANDARDS AND SPECIFICATIONS.
2. IT SHALL BE THE RESPONSIBILITY OF THE CONTRACTOR TO PROTECT ALL EXISTING UTILITIES AND STRUCTURES. ALL UTILITIES SHALL BE MANHOLES CLEANED, VALVE BOXES, FIRE HYDRANTS, ETC. MUST BE ADJUSTED TO PROPER LINE AND GRADE BY THE CONTRACTOR PRIOR TO AND AFTER THE PLACING OF PERMANENT PAVING. THE CONTRACTOR SHALL BE RESPONSIBLE FOR PROPER LINE AND GRADE DURING CONSTRUCTION OF THIS PROJECT.
3. THE CONTRACTOR SHALL BE RESPONSIBLE FOR COORDINATING WITH ALL UTILITIES TO LOCATE ALL UTILITIES WITHIN THE CONSTRUCTION AREA.
4. THE PAVING CONTRACTORS SHALL COOPERATE WITH THE UTILITY CONTRACTORS TO INSURE ALL CONDUIT FOR IRRIGATION, ELECTRICAL, WATER AND SEWER HAS BEEN INSTALLED PRIOR TO PLACEMENT OF PERMANENT PAVING. REFER TO LANDSCAPE AND MEP PLANS FOR LOCATION AND SIZE.
5. ALL PAVING AND EARTHWORK OPERATIONS SHALL COMPLY WITH THE RECOMMENDATIONS PER THE GEOTECHNICAL REPORT, PREPARED BY FUGRO SOUTH INC. REPORT #0701-1049 DATED 4-29-01.
6. TRAFFIC BARRICADES WILL BE REQUIRED FOR PAVING AND STORM SEWER CONSTRUCTION WITHIN THE PUBLIC RIGHT-OF-WAY. BARRICADES SHALL BE CONSTRUCTED WITHIN THE PUBLIC RIGHT-OF-WAY. BARRICADES SHALL BE UNIFORM "TRAFFIC CONTROL DEVICES" AS CURRENTLY ADOPTED, TEXAS DEPARTMENT OF TRANSPORTATION.
7. CONCRETE SHALL HAVE A MINIMUM COMPRESSIVE STRENGTH OF 3600 PSI FOR PAVEMENT, CURBS AND SIDEWALK IN 28 DAYS.
8. CONCRETE PAVING SHALL HAVE A CONSTRUCTION JOINT OR SAVED CENTER JOINT. CONSTRUCTION JOINTS SHALL BE CONSTRUCTED AT 90' INTERVALS, AS SHOWN IN THE DRAWINGS. JOINTS SHALL INTERSECT ALL PAVEMENT EDGES AT 90' INCLUDING RADIUS RETURNS.

LEGEND:

- 609.50 TW TOP OF WALL
- 608.50 TC TOP CURB
- 609.50 G OUTER
- 609.50 TOP PAVEMENT
- Light Ballard
- Tree
- Area Drain
- Water Meter
- Telephone Riser
- Signal Box
- Water Valve
- 8" SS Sanitary Sewer Line
- 6" WTR Water Line
- 8" PVC Storm Drain Pipe
- Underground Electric
- Ex. Tree To Be Relocated
- Or Relocated By Others

BENCH MARKS:

- T.B.M. #1 SQUARE CUT IN THE NORTH CURB, CORNER OF EXISTING BUILDING. ELEVATION..... 603.50
- E: 6716.7591
- T.B.M. #2 SQUARE CUT ON THE SOUTH 10' CURB INLET OF NORMAN LANE, 125 ± WEST OF THE CENTERLINE LANE. TOPAS CIRCLE AND NORMON LANE. ELEVATION..... 607.84
- N: 8990.9190
- E: 7128.7696
- T.B.M. #3 SQUARE CUT ON THE NORTHWEST CORNER OF TXU ELECTRIC TOWER, 35 ± EAST OF THE EXISTING FIRE STATION. ELEVATION..... 605.23
- N: 8286.8409
- E: 7046.8597

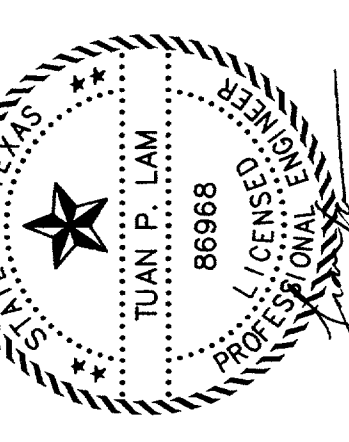

THE SEAL APPEARING ON THIS DOCUMENT WAS AUTHORIZED BY TUAN P. LAM, P.E. #86968 ON 02-22-02. ALTERATION OF A SEALED DOCUMENT WITHOUT THE PROPER NOTIFICATION TO THE RESPONSIBLE ENGINEER IS AN OFFENSE UNDER THE TEXAS ENGINEERING PRACTICE ACT.

**PARKING EXPANSION ALT. #3
 ADDISON ATHLETIC CLUB
 EXPANSION & LEISURE POOL
 ADDISON, TEXAS**

R-DELTA ENGINEERS, INC.
 618 MAIN STREET GARLAND, TEXAS 75040
 Phone (972) 494-5051 www.rdelta.com

DESIGN: CTL CHECK: JRP SCALE: 1"=30'
 DRAWN: CEW DATE: FEBRUARY, 2002 PROJECT: 982-01 10 of 11

CURVE DATA

STATION	PC	PT	PI	TS	TL	STATION	PC	PT	PI	TS	TL
01	142	807.21	211	225.08	138.44	1	142	807.21	211	225.08	138.44
2	155	807.51	151	225.38	142.73	2	155	807.51	151	225.38	142.73
3	222	687.39	297	146.16	83.29	3	222	687.39	297	146.16	83.29
4	15	146.17	461	38.28	49.59	4	15	146.17	461	38.28	49.59
5	10	1457	8.43	25.33	31.86	5	10	1457	8.43	25.33	31.86

4" THICK REINFORCED CONCRETE SIDEWALK WITH #3 BARS @ 18" O.C.E.W. OVER 6" SCARIFIED & RECOMPACT SUBGRADE TO 95% STD. PROCTOR DENSITY. ASTM-D998

6" REINFORCED CONCRETE (3600 PSI) PAVEMENT WITH #3 BARS @ 18" O.C.E.W. OVER A 6" LIME TREATED SUBGRADE SCARIFIED & RECOMPACT TO 95% STD. PROCTOR DENSITY. ASTM-D998 (6% HYDRATED LIME BY DRY WEIGHT, 27lbs/S.Y.)

8" DRAINAGE CEMENT (MIL. B2048, PC 1800)