

THIS PLAN ILLUSTRATES THE TOTAL AREA OF EXISTING PAVEMENT AND THE LOCATIONS OF EXISTING STORM DRAINAGE FACILITIES TO BE REMOVED. THESE ELEMENTS WILL REQUIRE REMOVAL INCREMENTALLY AS NECESSARY FOR PROPER STAGING AND SEQUENCING OF CONSTRUCTION AND MAY THEREFORE REQUIRE ADDITIONAL SAW CUTTING THAN WHAT IS INDICATED.

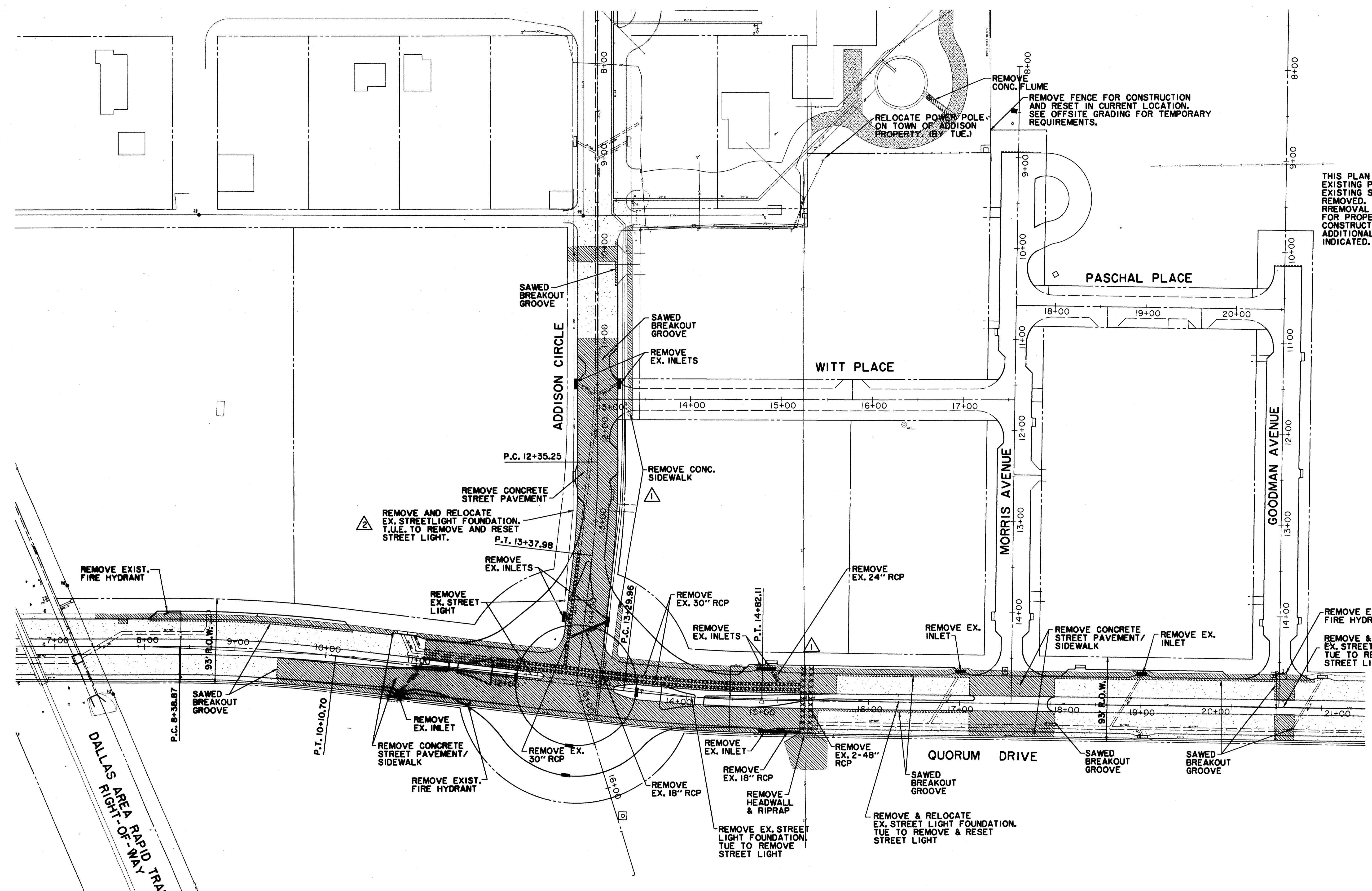

DALLAS AREA RAPID TRANSIT

RECORD DRAWING 5/1/98

ISSUED FOR CONSTRUCTION  
MARCH 28, 1996

THE SEAL APPEARING ON THIS DOCUMENT WAS AUTHORIZED BY  
KENNETH A. ROBERTS, P.E. 55446  
ON MARCH 28, 1996.

5-28-96

**LEGEND**

	CONCRETE REMOVAL
	PIPE REMOVAL
	INLET REMOVAL

ISSUED FOR CONSTRUCTION 3/28/96  
ADDENDUM #4 2/16/96

<b>DEMOLITION PLAN</b>							
<b>ADDISON CIRCLE</b>							
<b>PHASE I PUBLIC INFRASTRUCTURE</b>							
<b>TOWN OF ADDISON, TEXAS</b>							
Huitt-Zollars, Inc./Engineering/Architecture Dallas, Fort Worth, Houston, El Paso, Phoenix, Tustin, Ontario, San Clemente							
DESIGN	DRAWN	APPR.	SCALE	DATE	PROJECT NO.	NO.	
HZI	HZI	KAR	1"=50'	JAN 96	1822-04	18	137