

SIGNAL INTERCONNECT NOTES: 3

INFORMATION PROVIDED BY THE TOWN OF ADDISON

1. PULL BOX SPECIFICATIONS

- A. OUTER DIMENSION 25" L X 15" W X 12" H
- B. CAST IRON LID 21 1/2" L X 11 1/2" X 2" H CLEARLY MARKED "TRAFFIC SIGNAL"
- C. REINFORCED CONCRETE WITH 9 GA. WELDED WIRE FABRIC
- D. CONSTRUCT 3" THICK X 18" WIDE REINFORCED CONCRETE STRIP AT THE SURFACE AROUND THE PERIMETER OF THE PULL BOX.

2. CONDUIT

- A. 3" DIA. SCHEDULE 40 PVC GRAY CONDUIT OR MATCH EXISTING CONDUIT.

3. CABLE

- A. CONDUCTORS: SOLID BARE COPPER
- B. INSULATION: POLYETHYLENE, 300 VOLT RATING COLOR CODED
- C. CONDUCTOR CONFIGURATION: TWISTED PAIRS (8 PAIR NO. 16 AWG)
- D. SHIELD: COPPER TAPE UNDER JACKET
- E. JACKET: IMSA SPEC. 39-2-1984 POLYVINYL CHLORIDE (PVC)

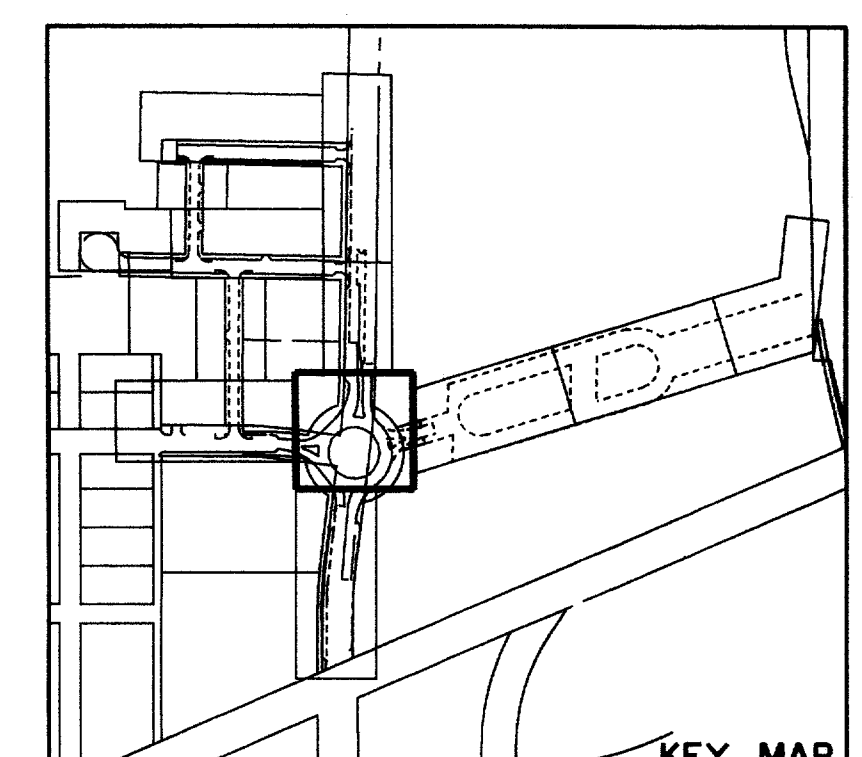
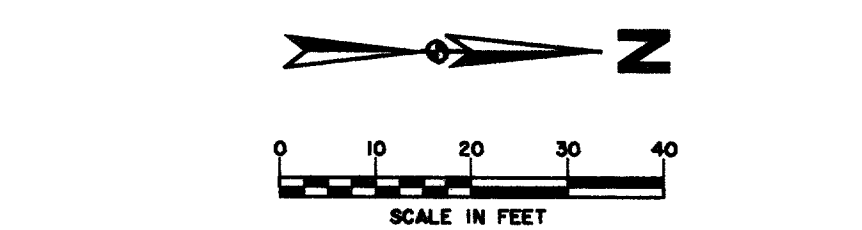
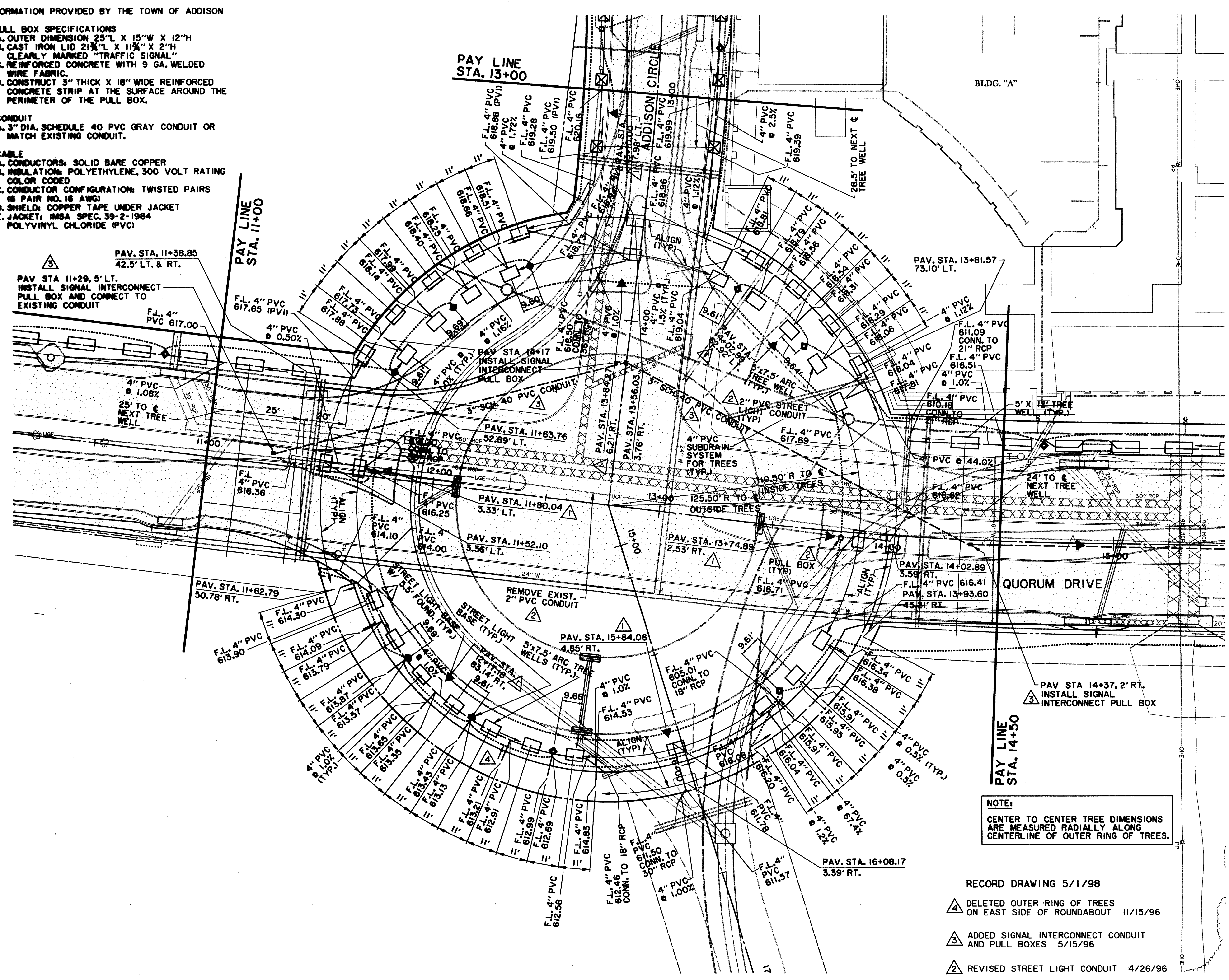

LEGEND

	ELECTRIC - ONE		MISC.
	LIGHT POLE		EX. STORM SEWER
	POWER POLE		CHAIN LINK FENCE
	GUY WIRE		WOOD FENCE
	TELEPHONE - T		EXISTING ASPHALT
	TELEPHONE MANHOLE		EXISTING DIRT OR GRAVEL
	TELEPHONE PEDESTAL		EX. CONCRETE
	TELEPHONE SIGN		TREE/TREE LINE
	GAS - G		EXISTING CURB
	GAS METER		PROP. CURB
	GAS SIGN		PROP. EDGE OF PAVEMENT NO CURB
	LAND USE		EX. PROPERTY LINE
	RAILROAD SIGN		PROP. CENTERLINE
	SIGN		PROP. R.O.W.
	SURVEY		PROP. INLET
	FOUND IRON ROD		TOP OF PAVEMENT
	TEMP BENCHMARK		TOP OF CURB
	WASTEWATER - WW		CURB RETURN
	WASTEWATER MANHOLE		EXISTING GUTTER
	CLEANOUT		BORING LOCATION
	WATER - W		B-20
	FIRE HYDRANT		
	METER		
	WATER VALVE		

BENCHMARKS:

BM#1
"I" CUT AT CENTER BACK OF CURB OF INLET, 190 FEET SOUTH FROM THE CENTERLINE INTERSECTION OF ADDISON CIRCLE, WEST SIDE OF QUORUM DRIVE. ELEV. 621.89

BM#2
"I" CUT AT CENTER BACK OF CURB OF INLET, 200 FEET NORTH FROM THE CENTERLINE INTERSECTION OF ADDISON CIRCLE, WEST SIDE OF QUORUM DRIVE. ELEV. 621.68

ISSUED FOR CONSTRUCTION
MARCH 28, 1996

THE SEAL APPEARING ON THIS DOCUMENT WAS AUTHORIZED BY
KENNETH A. ROBERTS, P.E. 55446
ON MARCH 28, 1996.

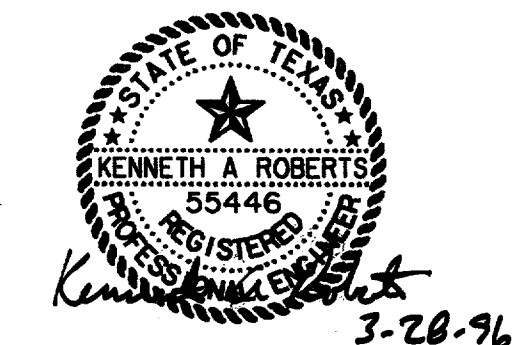

NOTE:
CENTER TO CENTER TREE DIMENSIONS ARE MEASURED RADIALLY ALONG CENTERLINE OF OUTER RING OF TREES.

- RECORD DRAWING 5/1/98
- A DELETED OUTER RING OF TREES ON EAST SIDE OF ROUNDABOUT 11/15/96
 - A ADDED SIGNAL INTERCONNECT CONDUIT AND PULL BOXES 5/15/96
 - A REVISED STREET LIGHT CONDUIT 4/26/96
 - A ISSUED FOR CONSTRUCTION 3/28/96

STREETSCAPE PLAN						
QUORUM DRIVE & ADDISON CIRCLE						
ADDISON CIRCLE						
PHASE I PUBLIC INFRASTRUCTURE						
TOWN OF ADDISON, TEXAS						
Huitt-Zollars, Inc./Engineering/Architecture Dallas, Fort Worth, Houston, El Paso, Phoenix, Tucson, Ontario, San Clemente						
DESIGN	DRAWN	APPR.	SCALE	DATE	PROJECT NO.	NO.
HZI	HZI	KAR	1"=20'	JAN 96	1822-04	50
						137