

H:\PROJ\01182230\DWG\AC2PDP02.DWG
 DATE: 07/15/97 10:45:30 AM
 USER: HZ1
 PLOT: 07/15/97 10:45:30 AM
 PLOTTER: HPGLASER
 PLOT SCALE: 1"=20'
 PLOT SHEET: 1 OF 1
 PLOT STATUS: OK
 PLOT MESSAGE:

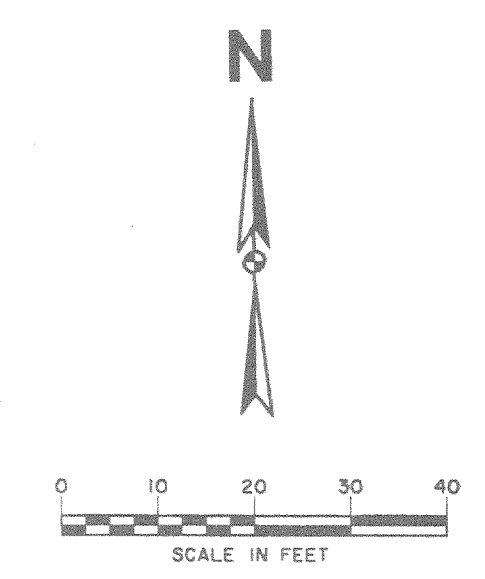
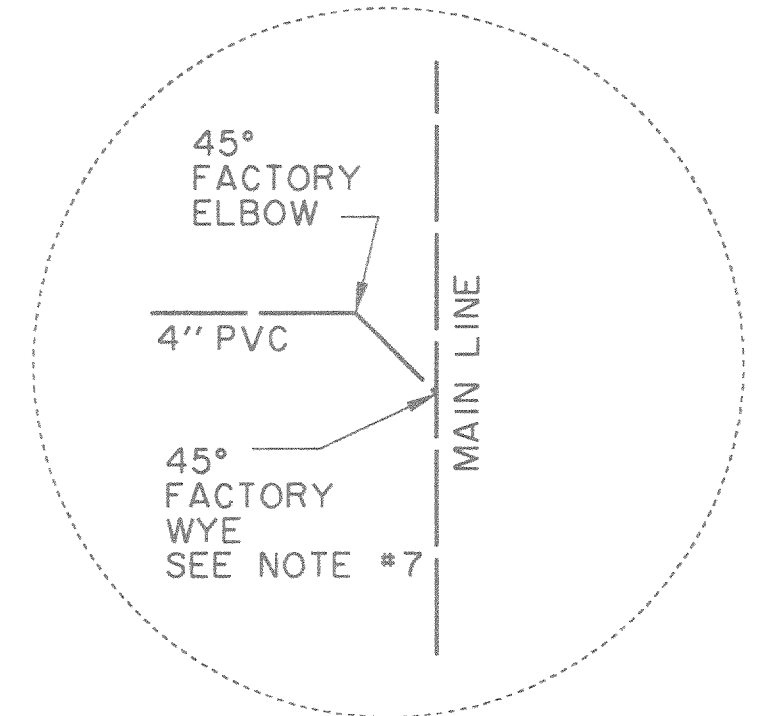
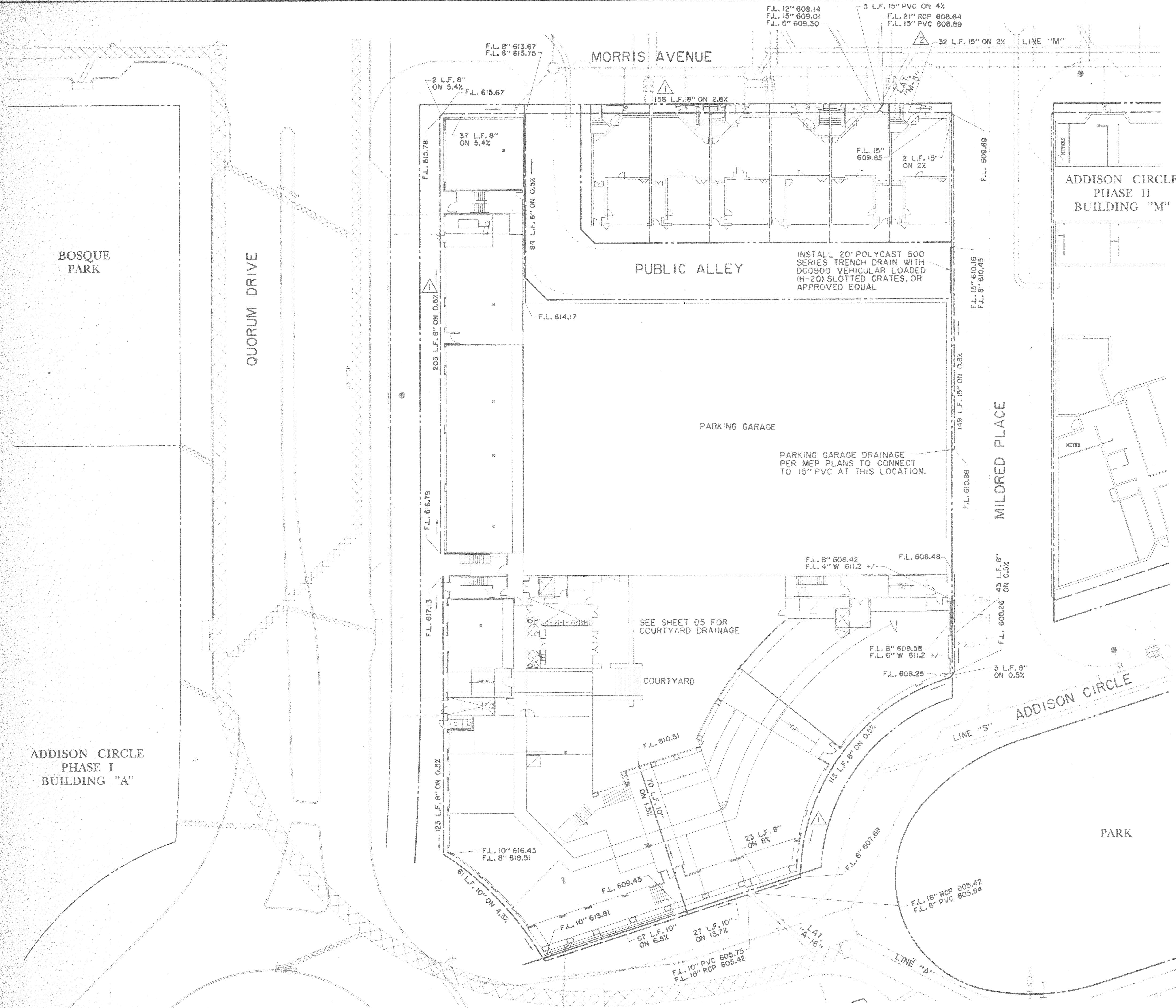

- NOTES:**
1. PRIVATE DRAINS ARE TO BE LOCATED BETWEEN THE PROPERTY LINE AND THE BUILDING AS SHOWN IN TYPICAL SECTIONS. THE HORIZONTAL LOCATION SHOWN IS A GUIDE AND MAY BE ADJUSTED ON PRIVATE PROPERTY AS NEEDED TO AVOID CONFLICTS.
 2. SEE ADDISON CIRCLE PHASE II PUBLIC INFRASTRUCTURE PLANS FOR PUBLIC STORM DRAINAGE SYSTEM.
 3. SEE LANDSCAPE AND ARCHITECTURAL PLANS FOR DETAILED LOCATIONS OF PRIVATE DRAIN INLETS AND ROOF DOWNSPOUTS. INSTALL WYES AND RISERS FOR DOWNSPOUTS AT THE TIME THE MAIN IS INSTALLED.
 4. ALL PRIVATE DRAINS UNDER BUILDINGS SHALL CONFORM TO THE REQUIREMENTS OF THE LOCALLY RECOGNIZED BUILDING CODE. ALTERNATE MATERIALS MAY BE REQUIRED.
 5. SPECIFIC ROUTING OF DRAINS MAY BE MODIFIED IN THE FIELD AT THE DIRECTION OF THE OWNER OR LANDSCAPE ARCHITECT AS LONG AS THE INDICATED SIZES AND SLOPES ARE MAINTAINED.
 6. CLEANOUTS SHALL BE INSTALLED AT APPROXIMATELY 100' INTERVALS AND AT ALL CHANGES IN ALIGNMENT. LOCATE CLEANOUTS IN PLANTING AREAS TO THE EXTENT POSSIBLE.
 7. ALL CONNECTIONS BETWEEN DRAINS SHALL BE FACTORY WYES. ALL BENDS SHALL BE 45 DEGREE FACTORY ELBOWS.
 8. PRIVATE DRAINS IN THE MEWS TO BE TESTED PER NCTCOG STANDARD SPECIFICATIONS.

BENCHMARKS:

BM#1
 "□" CUT AT CENTER BACK OF CURB OF INLET, 190 FEET SOUTH FROM THE CENTERLINE INTERSECTION OF ADDISON CIRCLE, WEST SIDE OF QUORUM DRIVE. ELEV. 621.89

BM#4
 "□" CUT AT CENTER OF CURB INLET, 1015 FEET NORTH FROM THE CENTERLINE INTERSECTION OF ADDISON CIRCLE, WEST SIDE OF QUORUM DRIVE. ELEV. 629.36

THE SEAL APPEARING ON THIS DOCUMENT WAS AUTHORIZED BY DAVID E. MEYERS, P.E. 61512 ON 7/10/93

DATE	DESCRIPTION	REF. NO.
3/16/98	DELETED REFERENCE TO POLY	2
12/23/97	CHANGED POLY TO PVC; REVISED GRADES	1
7/15/97	ISSUED FOR CONSTRUCTION	N/A
6/4/97	CITY SUBMITTAL	N/A

DRAINAGE PLAN - BUILDING "N"

ADDISON CIRCLE APARTMENTS

PHASE II PRIVATE
 TOWN OF ADDISON, TEXAS

Huiitt-Zollars, Inc./Engineering/Architecture
 Dallas, Fort Worth, Houston, El Paso, Phoenix, Tustin, Ontario

DESIGN	DRAWN	APPR.	SCALE	DATE	PROJECT NO.	NO.
HZ1	HZ1	DEM	1"=20'	JULY 97	1822-30	D4