

QUORUM DRIVE
(LOOKING NORTH)

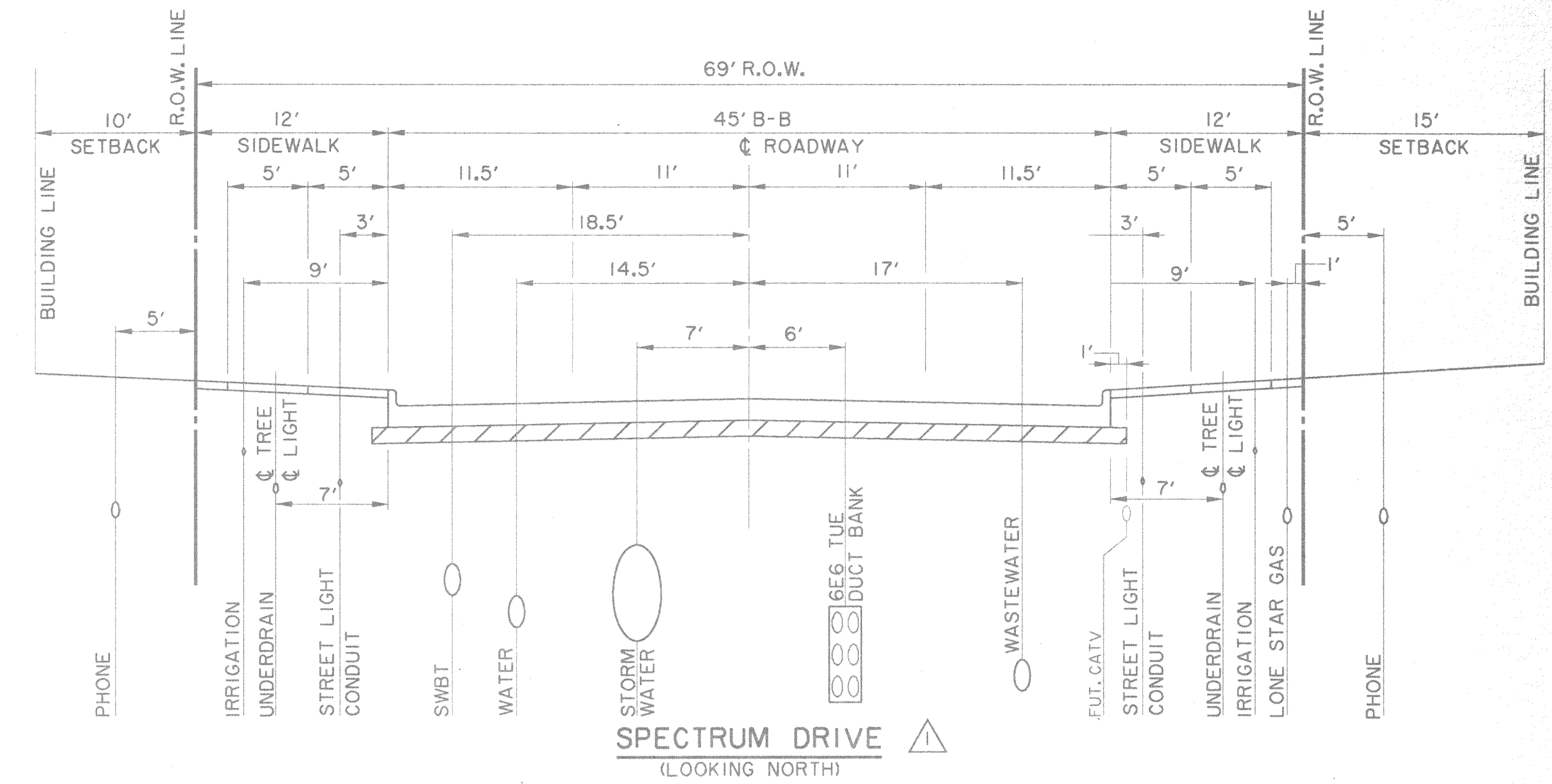

SPECTRUM DRIVE
(LOOKING NORTH)

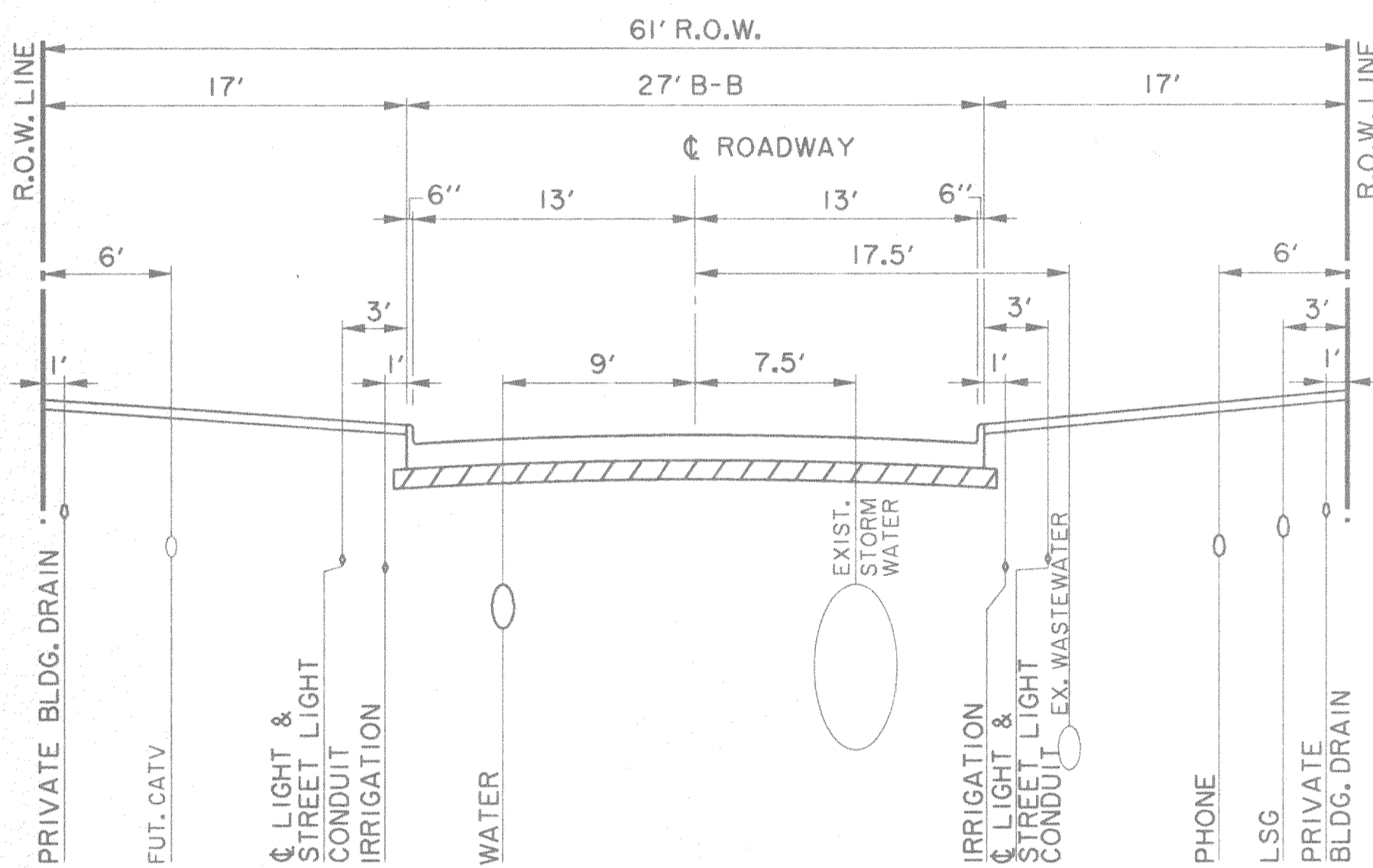

ADDISON CIRCLE FROM QUORUM TO ±170' EAST OF QUORUM
(SEE PLAN VIEW FOR PAVEMENT WIDTH VARIATIONS NEAR ROUNDABOUT)

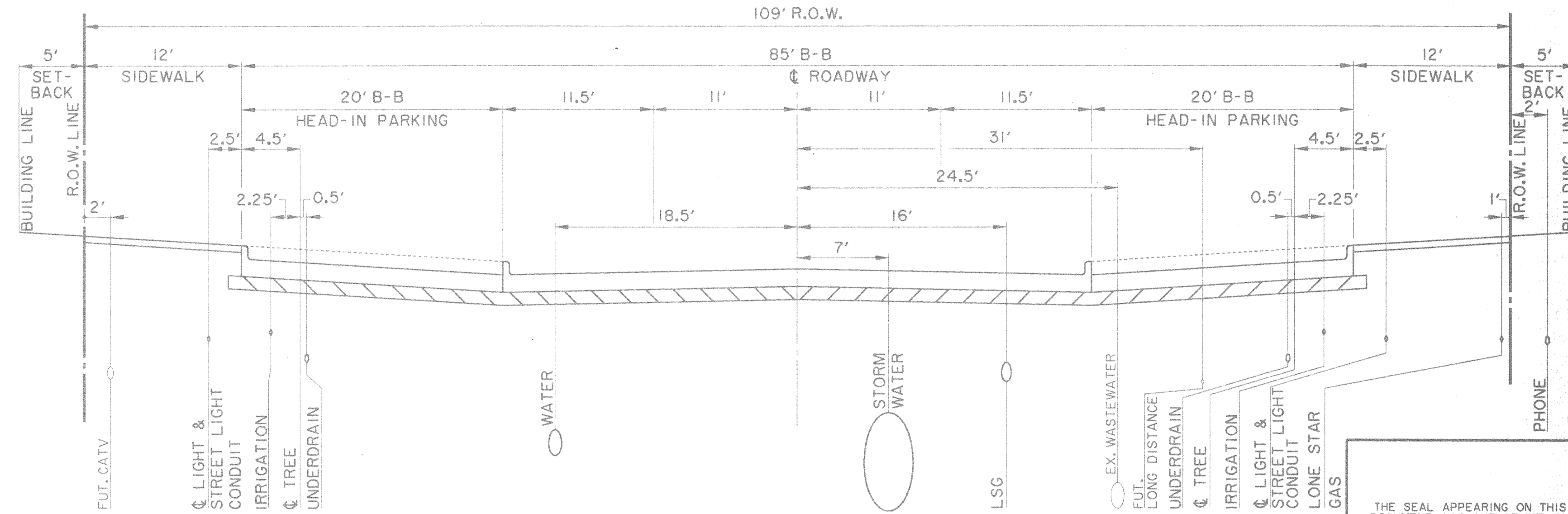

ADDISON CIRCLE FROM ±240' EAST OF SPECTRUM TO DALLAS PARKWAY
(LOOKING EAST)

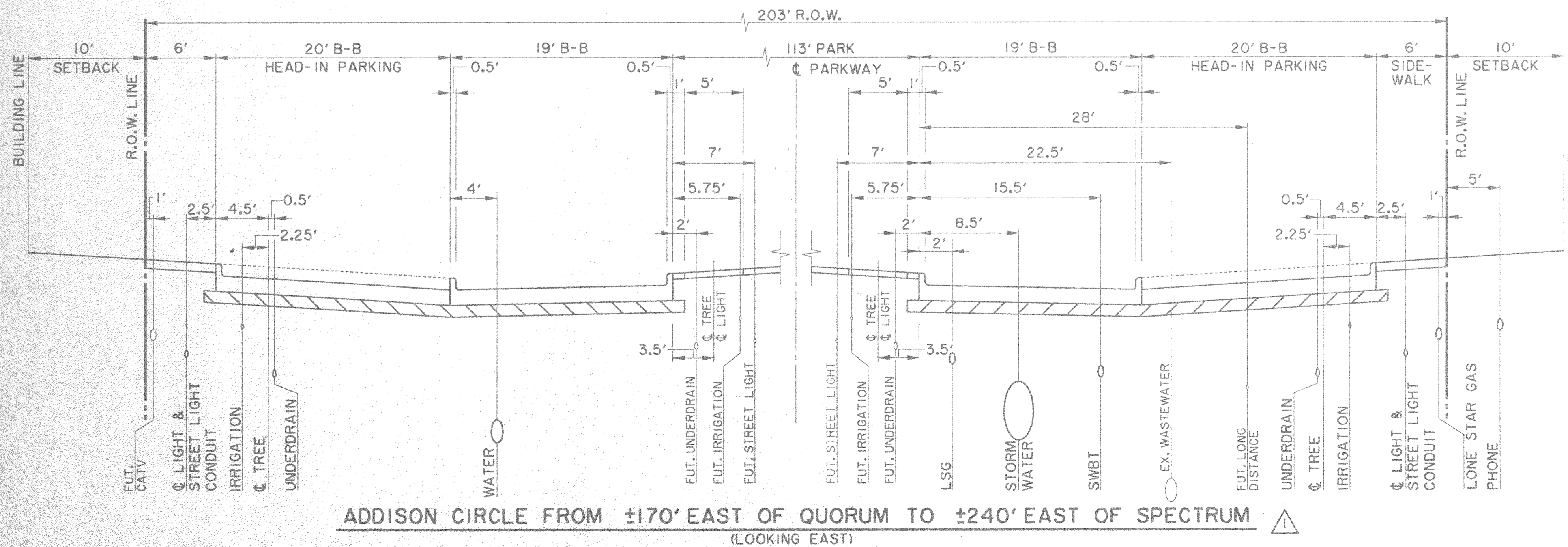

ADDISON CIRCLE FROM ±170' EAST OF QUORUM TO ±240' EAST OF SPECTRUM
(LOOKING EAST)

NOTE:

THE PRECISE FINAL LOCATIONS OF ALL UTILITIES ARE ESTABLISHED IN PLAN VIEW. LOCATIONS ON THIS PLAN ARE GIVEN AS A GUIDE AND TO INDICATE ALLOCATION OF SPACE.

PHONE TO BE INSTALLED BY ADDISON CIRCLE ACCESS LTD.

THE SEAL APPEARING ON THIS DOCUMENT WAS AUTHORIZED BY DAVID E. MEYERS, P.E. 81512 ON 2/19/98

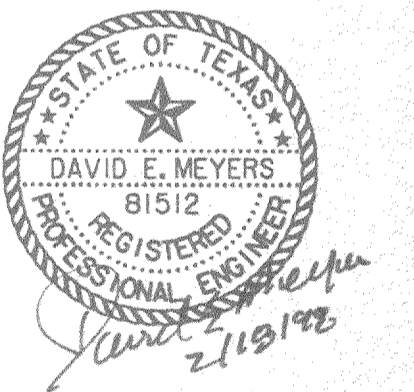

DATE	DESCRIPTION	REF. NO.
2/19/98	REVISED GAS AND PHONE	1
7/15/97	ISSUED FOR CONSTRUCTION	N/A
6/4/97	CITY SUBMITTAL	N/A

TYPICAL UTILITY LOCATIONS						
ADDISON CIRCLE APARTMENTS						
PHASE II PRIVATE						
TOWN OF ADDISON, TEXAS						
Hull-T-Zollars, Inc./Engineering/Architecture Dallas, Fort Worth, Houston, El Paso, Phoenix, Tustin, Ontario						
DESIGN	DRAWN	APPR.	SCALE	DATE	PROJECT NO.	NO.
HZI	HZI	DEM	N.T.S.	JULY 97	1822-30	M2