

A SPECIAL DETAIL
SEE SHEET SP9

RECORD DRAWING

LEGEND

ELECTRIC — OE —	48" RCP	MISC.
○ LIGHT POLE	— EX. STORM SEWER	— CHAIN LINK FENCE
pp POWER POLE	— WOOD FENCE	— EXISTING ASPHALT
— GUY WIRE	— EXISTING DIRT OR GRAVEL	— EX. CONCRETE
TELEPHONE — T —	— TELEPHONE PEDESTAL	— TREE/TREE LINE
TELE MH ● TELEPHONE MANHOLE	— EXISTING CURB	— EXISTING CURB
TS ● TELEPHONE SIGN	— PROP. CURB	— PROP. EDGE OF PAVEMENT NO CURB
GM ● GAS METER	— EX. PROPERTY LINE	— PROP. CENTERLINE
GS ● GAS SIGN	— PROP. R.O.W.	— PROP. INLET
LAND USE	— T.P. TOP OF PAVEMENT	— T.C. TOP OF CURB
R/S RAILROAD SIGN	— CR CURB RETURN	— EX. G. EXISTING GUTTER
△ SIGN	— EX. T.C. EXISTING TOP OF CURB	— EX. T.C. BORING LOCATION
SURVEY	— PROP. R.O.W.	— EX. T.C. BORING LOCATION
IR. ● FOUND IRON ROD	— T.P. TOP OF PAVEMENT	— T.C. TOP OF CURB
BM BENCHMARK	— CR CURB RETURN	— EX. G. EXISTING GUTTER
WASTEWATER — WW —	— EX. T.C. EXISTING TOP OF CURB	— EX. T.C. BORING LOCATION
WM ● WASTEWATER MANHOLE	— EX. T.C. BORING LOCATION	— EX. T.C. BORING LOCATION
CO ● CLEANOUT	— EX. T.C. BORING LOCATION	— EX. T.C. BORING LOCATION
WATER — W —	— EX. T.C. BORING LOCATION	— EX. T.C. BORING LOCATION
FH ● FIRE HYDRANT	— EX. T.C. BORING LOCATION	— EX. T.C. BORING LOCATION
WM ● METER	— EX. T.C. BORING LOCATION	— EX. T.C. BORING LOCATION
T ● WATER VALVE	— EX. T.C. BORING LOCATION	— EX. T.C. BORING LOCATION
	— EX. T.C. BORING LOCATION	— EX. T.C. BORING LOCATION

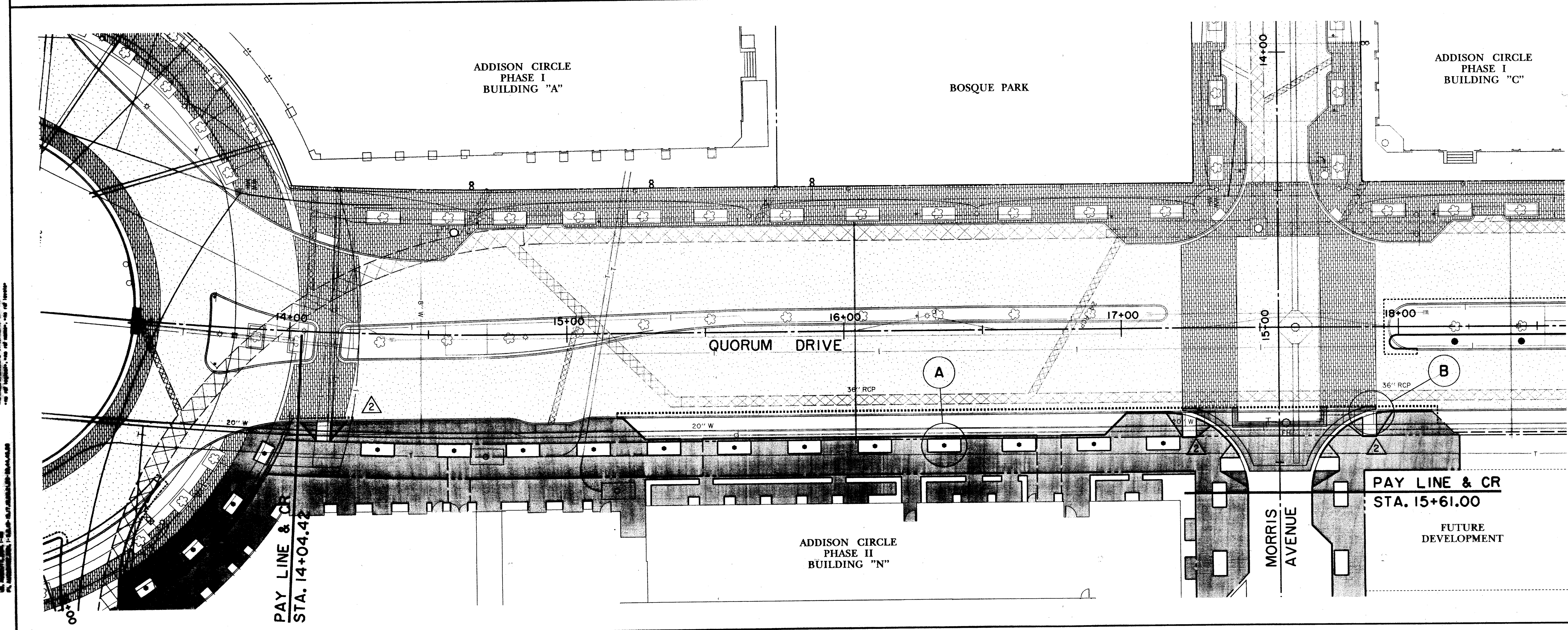

BENCHMARKS:

BM#1
CUT AT CENTER BACK OF CURB OF INLET, 190 FEET SOUTH FROM THE CENTERLINE INTERSECTION OF ADDISON CIRCLE, WEST SIDE OF QUORUM DRIVE. ELEV. 621.89

BM#4
CUT AT CENTER OF CURB INLET, 1015 FEET NORTH FROM THE CENTERLINE INTERSECTION OF ADDISON CIRCLE, WEST SIDE OF QUORUM DRIVE. ELEV. 629.36

THE SEAL APPEARING ON THIS DOCUMENT WAS AUTHORIZED BY DAVID E. MEYERS, P.E. 81512

DATE	DESCRIPTION	REF. NO.
2/13/98	REVISED PATTERNING AT SHIFTED RAMPS	2
10/3/97	ISSUED FOR CONSTRUCTION	N/A
8/4/97	REVISED RADIUS AT SW CORNER	1
	M-3/QUORUM DR.	
7/14/97	ISSUED FOR BID	N/A

SURFACE PATTERNING PLAN						
QUORUM DRIVE						
ADDISON CIRCLE						
PHASE II PUBLIC INFRASTRUCTURE						
TOWN OF ADDISON, TEXAS						
Hutt- Zollers, Inc./Engineering/Architecture Dallas, Fort Worth, Houston, El Paso, Phoenix, Tustin, Ontario						
DESIGN	DRAWN	APPR.	SCALE	DATE	PROJECT NO.	NO.
HZI	HZI	DEM	1"=20'	OCT. 97	01-1822-21	SPI

Hutt- Zollers, Inc. is an Equal Opportunity Employer. Minorities and women are encouraged to apply.