

RECORD DRAWING

LEGEND

	ELECTRIC — ONE		MISC.
	○ LIGHT POLE		EX. STORM SEWER
	PP POWER POLE		CHAIN LINK FENCE
	— GUY WIRE		WOOD FENCE
	TELEPHONE — T		EXISTING ASPHALT
	● TELEPHONE MANHOLE		EXISTING DIRT OR GRAVEL
	□ TELEPHONE PEDESTAL		EX. CONCRETE
	TS TELEPHONE SIGN		TREE/TREE LINE
	GAS — G		EXISTING CURB
	GM GAS METER		PROP. CURB
	GS GAS SIGN		PROP. EDGE OF PAVEMENT NO CURB
	LAND USE		EX. PROPERTY LINE
	RR RAILROAD SIGN		PROP. CENTERLINE
	□ SIGN		PROP. R.O.W.
	SURVEY		PROP. INLET
	IR FOUND IRON ROD		TOP OF PAVEMENT
	BM BENCHMARK		TOP OF CURB
	WASTEWATER — W		CURB RETURN
	WM WASTEWATER MANHOLE		EXISTING GUTTER
	CO CLEANOUT		EXISTING TOP OF CURB
	WATER — W		BORING LOCATION
	FH FIRE HYDRANT		EXISTING BRICKS
	WM METER		PAVEMENT REMOVAL
	T WATER VALVE		

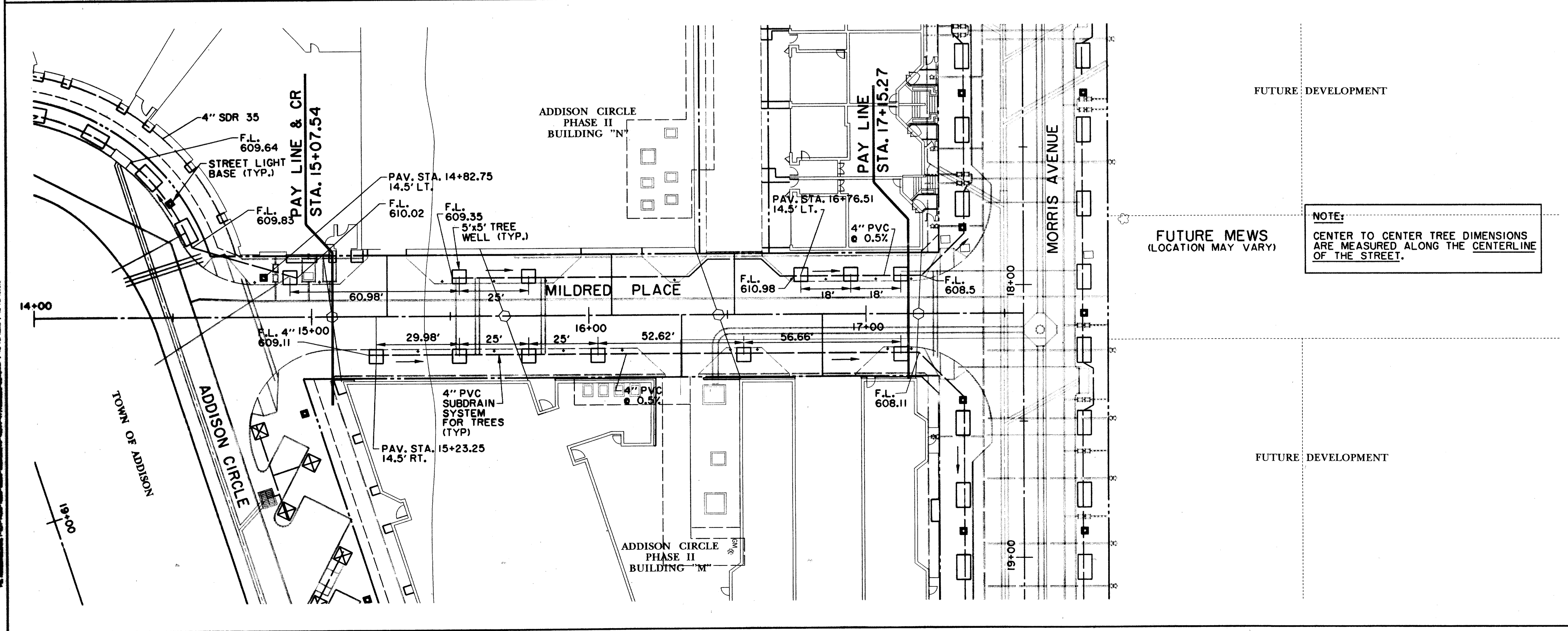

FUTURE DEVELOPMENT

FUTURE MEWS (LOCATION MAY VARY)

FUTURE DEVELOPMENT

BENCHMARKS:
BM#1
"□" CUT AT CENTER BACK OF CURB OF INLET, 190 FEET SOUTH FROM THE CENTERLINE INTERSECTION OF ADDISON CIRCLE, WEST SIDE OF QUORUM DRIVE. ELEV. 621.89
BM#5
"□" CUT AT NORTHWEST CORNER OF NORTH HDWL. OF 7'X7' BOX CULVERT UNDER RAILROAD, 180' WEST OF DALLAS PARKWAY SOUTHBOUND. ELEV. 610.49

THE SEAL APPEARING ON THIS DOCUMENT WAS AUTHORIZED BY DAVID E. MEYERS, P.E. 81512



DATE	DESCRIPTION	REF NO.
3/19/98	REVISED PAV. STA. FOR TREE (LEWIS PLACE)	▲
10/3/97	ISSUED FOR CONSTRUCTION	N/A
7/14/97	ISSUED FOR BID	N/A

STREETSCAPE PLAN				
LEWIS PLACE AND MILDRED PLACE				
ADDISON CIRCLE				
PHASE II PUBLIC INFRASTRUCTURE				
TOWN OF ADDISON, TEXAS				
<small>Huitt-Zollars, Inc./Engineering/Architecture Dallas, Fort Worth, Houston, El Paso, Phoenix, Tustin, Ontario</small>				
DESIGN	DRAWN	APPR.	SCALE	DATE
HZI	HZI	DEM	1"=20'	OCT. 97
				PROJECT NO.
				01-1822-21
				NO.
				ST8