

LINE 'A' LATERAL CONNECTIONS AND
 LATERALS AND JUNCTION BOX
 CONSTRUCTED WITH THE ADDISON
 CIRCLE PHASE II MASS GRADING
 PROJECT UNDER A SEPARATE CONTRACT.

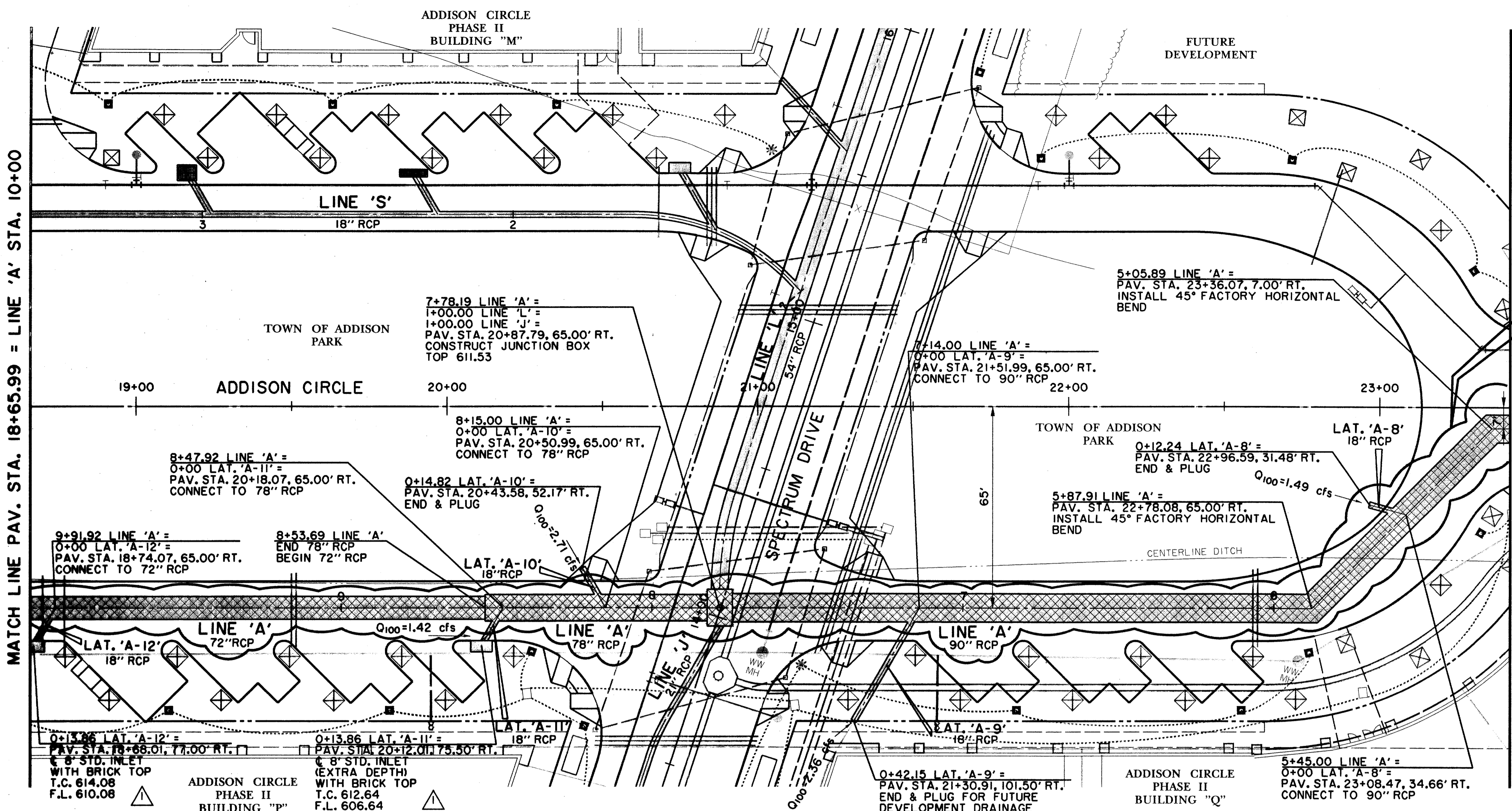

RECORD
 DRAWING

LEGEND

	ELECTRIC		MISC.
	○ LIGHT POLE		48" RCP
	□ POWER POLE		EX. STORM SEWER
	— GUY WIRE		CHAIN LINK FENCE
	○ TELEPHONE MANHOLE		WOOD FENCE
	□ TELEPHONE PEDESTAL		EXISTING ASPHALT
	□ TELEPHONE SIGN		EXISTING DIRT OR GRAVEL
	— GAS		EX. CONCRETE
	○ GAS METER		TREE/TREE LINE
	□ GAS SIGN		EXISTING CURB
	— LAND USE		PROP. CURB
	□ RAILROAD SIGN		PROP. EDGE OF PAVEMENT NO CURB
	□ SIGN		PROP. CENTERLINE
	— SURVEY		PROP. R.O.W.
	○ FOUND IRON ROD		PROP. INLET
	□ BENCHMARK		T.P.
	○ WASTEWATER MANHOLE		T.C.
	○ CLEANOUT		CR
	— WATER		EX. G
	○ FIRE HYDRANT		EX. T.C.
	○ METER		B-20 BORING LOCATION
	○ WATER VALVE		EXISTING BRICKS
			PAVEMENT REMOVAL

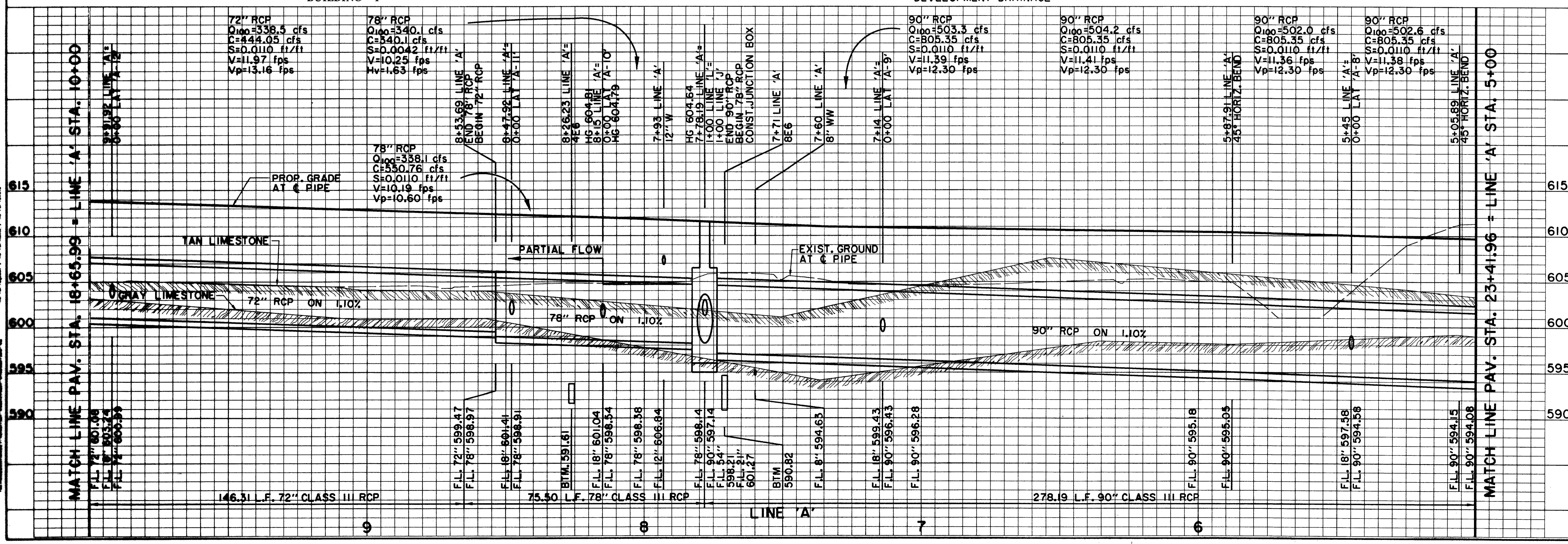

BENCHMARKS:

BM#5
 "C" CUT AT NORTHWEST CORNER OF NORTH HDWL. OF 7x7' BOX CULVERT UNDER RAILROAD, ±180' WEST OF DALLAS PARKWAY SOUTHBOUND, ELEV. 610.49

BM#6
 "C" CUT AT CENTER FRONT OF 18" REC. INLET, SECOND INLET NORTH OF RAILROAD TRACKS ON THE WEST SIDE OF DALLAS PARKWAY SOUTHBOUND, ELEV. 605.67

THE SEAL APPEARING ON THIS DOCUMENT WAS AUTHORIZED BY DAVID E. MEYERS, P.E. 81512

DATE	DESCRIPTION	REF. NO.
2/18/98	REVISED OFFSETS AND SHIFTED INLETS	▲
10/3/97	ISSUED FOR CONSTRUCTION	N/A
10/3/97	ISSUED FOR CONSTRUCTION	N/A
7/14/97	ISSUED FOR BID	N/A

STORM WATER PLAN & PROFILE
 LINE 'A' STA. 5+00 TO STA. 10+00

ADDISON CIRCLE
 PHASE II PUBLIC INFRASTRUCTURE
 TOWN OF ADDISON, TEXAS

Huitt-Zollars, Inc./Engineering/Architecture
 Dallas, Fort Worth, Houston, El Paso, Phoenix, Tustin, Ontario

DESIGN	DRAWN	APPR.	SCALE	DATE	PROJECT NO.	NO.
H21	H21	DEM	H ₁ 1"=20' V ₁ 1"=6'	OCT. 97	01-1822-21	SW12

FOR INFORMATION PURPOSES ONLY
 THIS DRAWING IS NOT TO BE USED FOR CONSTRUCTION
 WITHOUT THE WRITTEN APPROVAL OF THE ENGINEER OF RECORD
 DAVID E. MEYERS, P.E. 81512
 12/18/00