

RECORD DRAWING

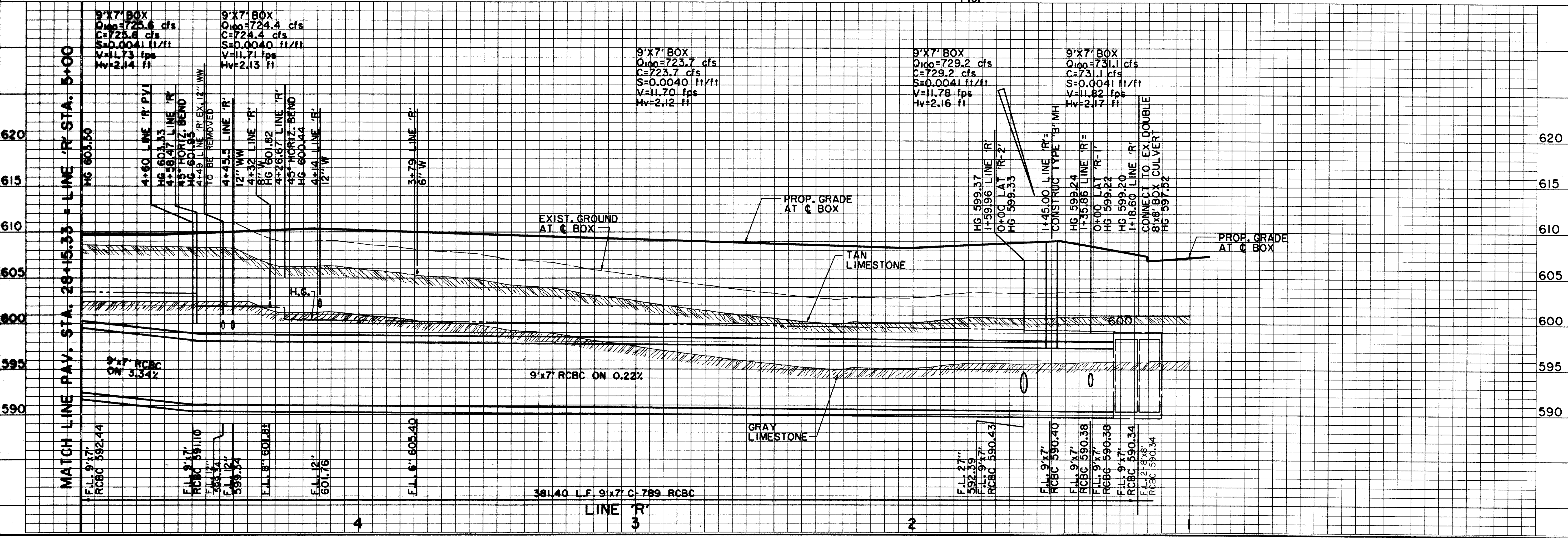

BENCHMARKS:

BM#5
"C" CUT AT NORTHWEST CORNER OF NORTH HDWL. OF 7'x7' BOX CULVERT UNDER RAILROAD, 1180' WEST OF DALLAS PARKWAY SOUTHBOUND, ELEV. 610.49

BM#6
"C" CUT AT CENTER FRONT OF 18" REC. INLET, SECOND INLET NORTH OF RAILROAD TRACKS ON THE WEST SIDE OF DALLAS PARKWAY SOUTHBOUND, ELEV. 605.67

THE SEAL APPEARING ON THIS DOCUMENT WAS AUTHORIZED BY DAVID E. MEYERS, P.E. 81512

DATE	DESCRIPTION	REF. NO.
1/28/98	REVISED INLET R-1	▲
10/3/97	ISSUED FOR CONSTRUCTION	N/A
7/14/97	ISSUED FOR BID	N/A

STORM WATER PLAN & PROFILE
LINE 'R' STA. 1+13.02 TO STA. 5+00
ADDISON CIRCLE
PHASE II PUBLIC INFRASTRUCTURE
TOWN OF ADDISON, TEXAS

Hull- Zollers, Inc./Engineering/Architecture
Dallas, Fort Worth, Houston, El Paso, Phoenix, Tulsa, Ontario

DESIGN	DRAWN	APPR.	SCALE	DATE	PROJECT NO.	NO.
HZI	HZI	DEM	H ₁ :1"=20' V ₁ :1"=6'	OCT. 97	01-1822-21	SW18

14/2001/01182221.dgn/AUC2D011.DGN