

MATCH LINE PAV. STA. 23+15.33 = LINE 'R' STA. 10+00

MATCH LINE PAV. STA. 28+15.33 = LINE 'R' STA. 5+00

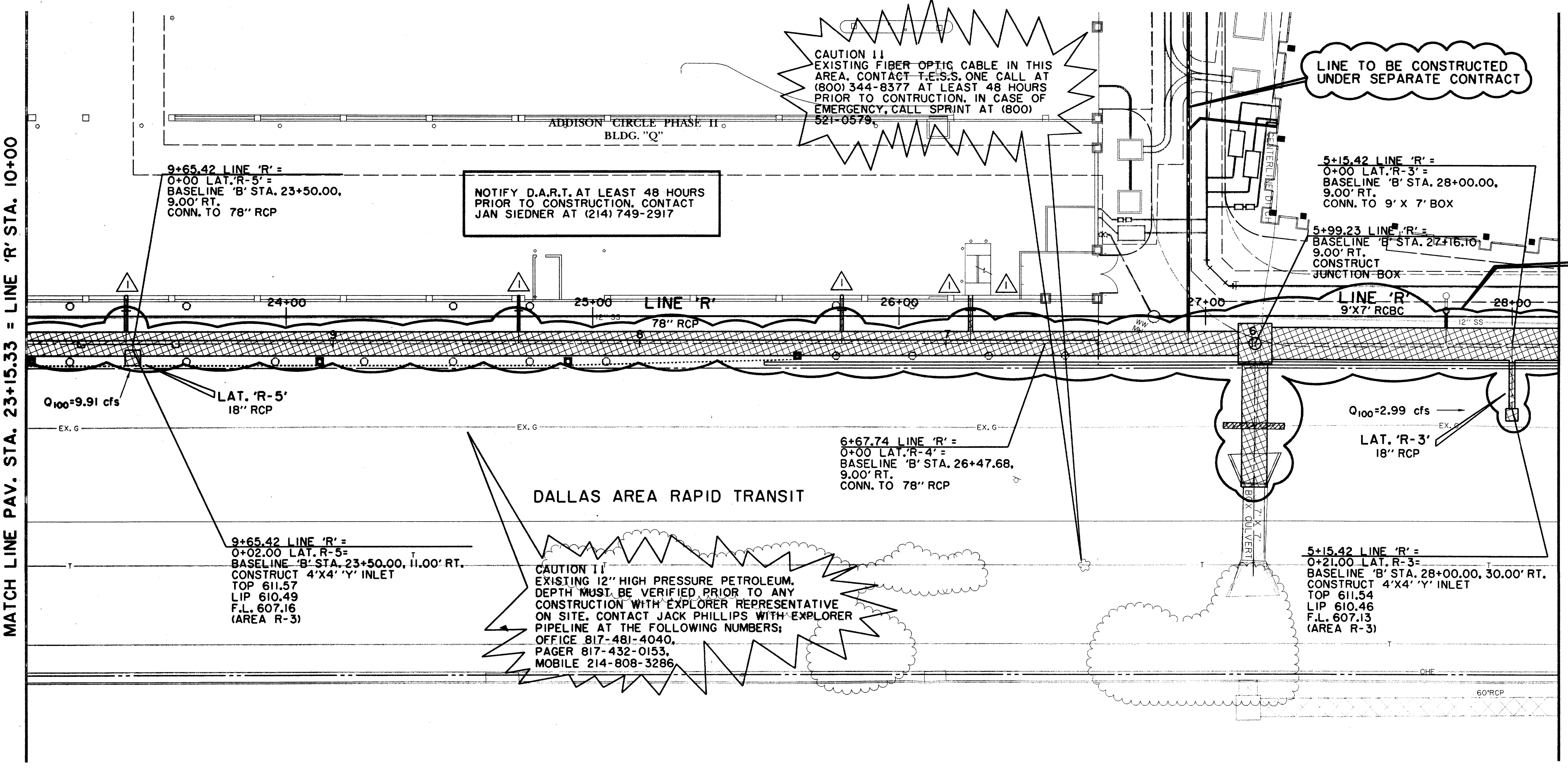

NOTIFY D.A.R.T. AT LEAST 48 HOURS PRIOR TO CONSTRUCTION. CONTACT JAN SIEDNER AT (214) 749-2917

CAUTION !! EXISTING FIBER OPTIC CABLE IN THIS AREA. CONTACT T.E.S.S. ONE CALL AT (800) 344-8377 AT LEAST 48 HOURS PRIOR TO CONSTRUCTION. IN CASE OF EMERGENCY, CALL SPRINT AT (800) 521-0579.

LINE TO BE CONSTRUCTED UNDER SEPARATE CONTRACT

TRUNK LINE "R", 7' X 7' RCBC CONNECTION TO RAILROAD CULVERT. FIELD CONNECTION OF LATERALS, LATERAL PIPE AS DENOTED, DROP INLETS AND PLUG FOR FUTURE CONNECTION WERE CONSTRUCTED WITH THE ADDISON CIRCLE PHASE II MASS GRADING PROJECT UNDER A SEPARATE CONTRACT.

DALLAS AREA RAPID TRANSIT

CAUTION !! EXISTING 12" HIGH PRESSURE PETROLEUM. DEPTH MUST BE VERIFIED PRIOR TO ANY CONSTRUCTION WITH EXPLORER REPRESENTATIVE ON SITE. CONTACT JACK PHILLIPS WITH EXPLORER PIPELINE AT THE FOLLOWING NUMBERS; OFFICE 817-481-4040, PAGER 817-432-0153, MOBILE 214-808-3286.

LEGEND	
ELECTRIC — OHE —	MISC.
⊙ LIGHT POLE	48" RCP EX. STORM SEWER
PP POWER POLE	CHAIN LINK FENCE
— GUY WIRE	WOOD FENCE
TELEPHONE — T —	EXISTING ASPHALT
TELEPHONE MANHOLE	EXISTING DIRT OR GRAVEL
TELEPHONE PEDESTAL	EX. CONCRETE
TELEPHONE SIGN	TREE/TREE LINE
GAS — G —	EXISTING CURB
GAS METER	PROP. CURB
GAS SIGN	PROP. EDGE OF PAVEMENT NO CURB
LAND USE	EX. PROPERTY LINE
RAILROAD SIGN	PROP. CENTERLINE
SIGN	PROP. R.O.W.
SURVEY	PROP. INLET
FOUND IRON ROD	T.P. TOP OF PAVEMENT
BENCHMARK	T.C. TOP OF CURB
WASTEWATER — WW —	CR CURB RETURN
WASTEWATER MANHOLE	EX. G. EXISTING GUTTER
CLEANOUT	EX. T.C. EXISTING TOP OF CURB
WATER — W —	B-20 BORING LOCATION
FIRE HYDRANT	EXISTING BRICKS
METER	PAVEMENT REMOVAL
WATER VALVE	

RECORD DRAWING

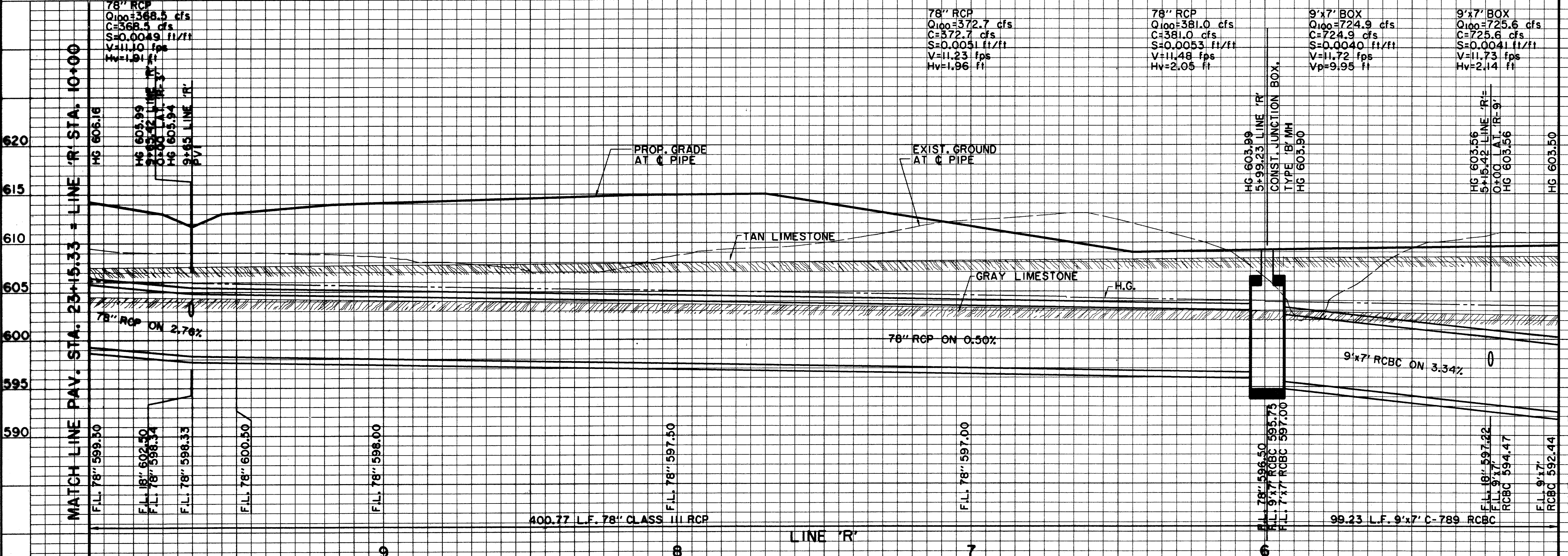

BENCHMARKS:

BM#5
1' CUT AT NORTHWEST CORNER OF NORTH HDWL. OF 7'X7' BOX CULVERT UNDER RAILROAD, ±180' WEST OF DALLAS PARKWAY SOUTHBOUND. ELEV. 610.49

BM#6
1' CUT AT CENTER FRONT OF 18" REC. INLET, SECOND INLET NORTH OF RAILROAD TRACKS ON THE WEST SIDE OF DALLAS PARKWAY SOUTHBOUND. ELEV. 605.67

THE SEAL APPEARING ON THIS DOCUMENT WAS AUTHORIZED BY DAVID E. MEYERS, P.E. 81512

DATE	DESCRIPTION	REF NO.
10/3/97	ISSUED FOR CONSTRUCTION	N/A
9/8/97	ADDED PVC. STUB-OUTS; DELETED R-4 (SEPARATE CONTRACT)	△
7/14/97	ISSUED FOR BID	N/A

STORM WATER PLAN & PROFILE
LINE 'R' STA. 5+00 TO STA. 10+00

ADDISON CIRCLE
PHASE II PUBLIC INFRASTRUCTURE
TOWN OF ADDISON, TEXAS

Huitt-Zollars, Inc./Engineering/Architecture
Dallas, Fort Worth, Houston, El Paso, Phoenix, Tustin, Ontario

DESIGN	DRAWN	APPR.	SCALE	DATE	PROJECT NO.	NO.
HZ1	HZ1	DEM	H: 1"=20' V: 1"=6'	OCT. 97	01-1822-21	SW19

Vertical text on the left margin containing project information and contact details.