

ADDISON CIRCLE PHASE II
BLDG. "N"

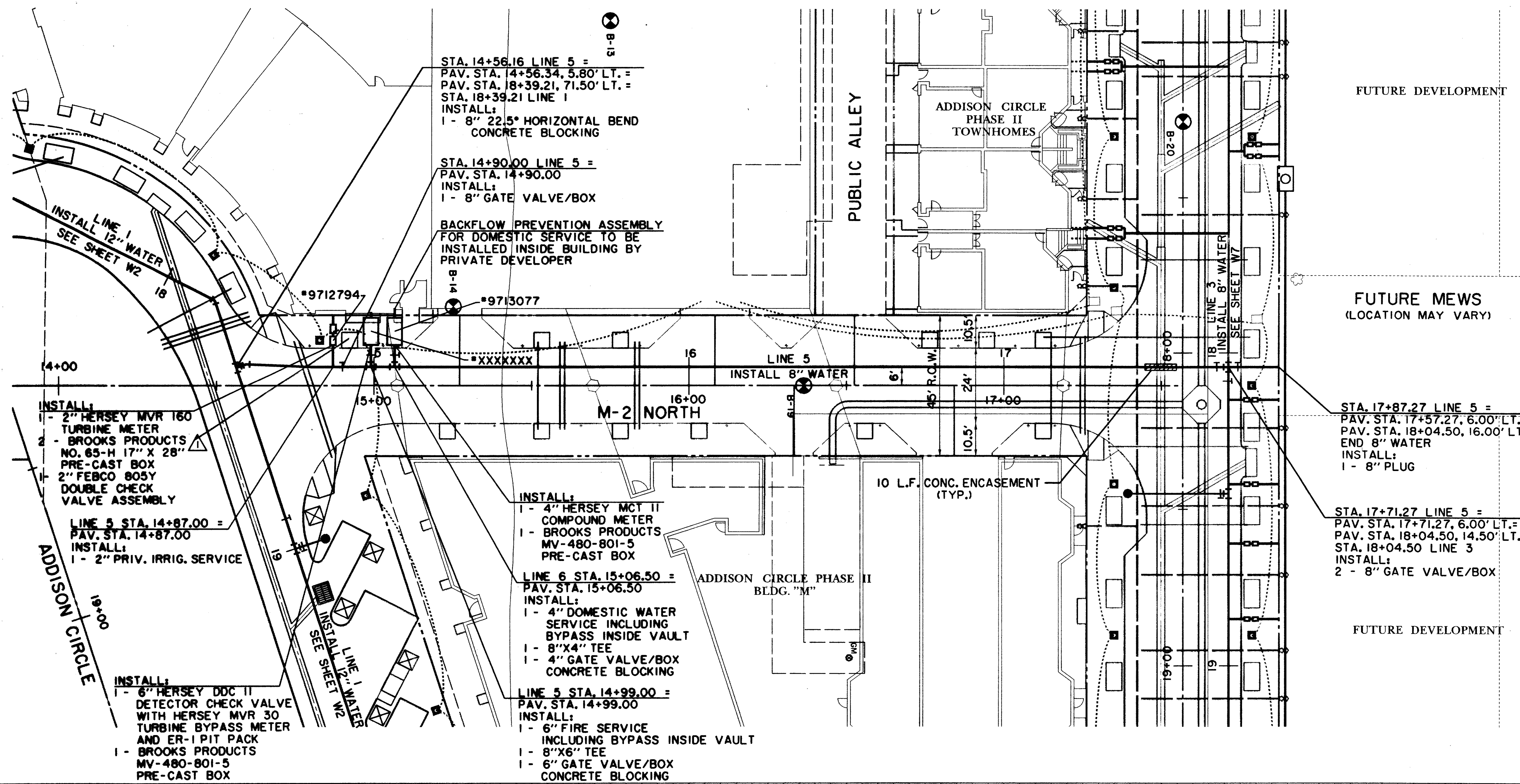
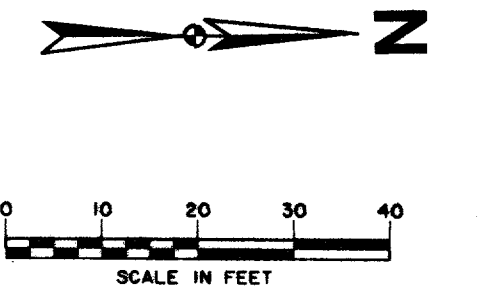

NOTE:
METERS, METER CANS, VAULTS AND BACKFLOW PREVENTION ASSEMBLIES TO BE INSTALLED AND TESTED PER TOWN OF ADDISON GENERAL REQUIREMENTS.

LEGEND

ELECTRIC — OE —	MISC.
○ LIGHT POLE	48" RCP
PPR POWER POLE	EX. STORM SEWER
— GUY WIRE	CHAIN LINK FENCE
TELEPHONE — T —	WOOD FENCE
TELEPHONE MANHOLE	EXISTING ASPHALT
TELEPHONE PEDESTAL	EXISTING DIRT OR GRAVEL
TELEPHONE SIGN	EX. CONCRETE
GAS — G —	TREE/TREE LINE
GAS METER	EXISTING CURB
GAS SIGN	PROP. CURB
LAND USE	PROP. EDGE OF PAVEMENT NO CURB
RAILROAD SIGN	EX. PROPERTY LINE
SIGN	PROP. CENTERLINE
SURVEY	PROP. R.O.W.
FOUND IRON ROD	PROP. INLET
BENCHMARK	T.P. TOP OF PAVEMENT
WASTEWATER — WW —	T.C. TOP OF CURB
WASTEWATER MANHOLE	CR CURB RETURN
CLEANOUT	EX. G EXISTING GUTTER
WATER — W —	EX. T.C. EXISTING TOP OF CURB
FIRE HYDRANT	B-20 BORING LOCATION
METER	EXISTING BRICKS
WATER VALVE	PAVEMENT REMOVAL

RECORD DRAWING

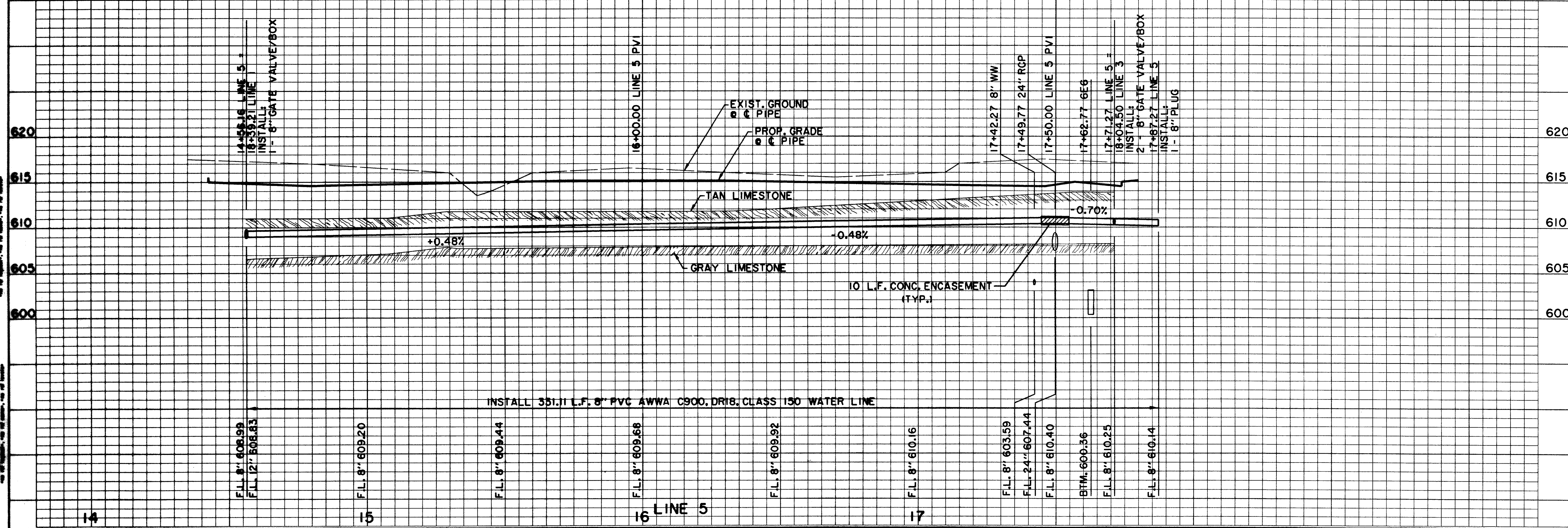

BENCHMARKS:

BM#1
"C" CUT AT CENTER BACK OF CURB OF INLET, 190 FEET SOUTH FROM THE CENTERLINE INTERSECTION OF MILDRED STREET, WEST SIDE OF QUORUM DRIVE.
ELEV. 621.89

BM#4
"C" CUT AT CENTER OF CURB INLET, 1015 FEET NORTH FROM THE CENTERLINE INTERSECTION OF MILDRED STREET, WEST SIDE OF QUORUM DRIVE.
ELEV. 629.36

THE SEAL APPEARING ON THIS DOCUMENT WAS AUTHORIZED BY DAVID E. MEYERS, P.E. 81512

DATE	DESCRIPTION	REF NO.
10/3/97	ISSUED FOR CONSTRUCTION	N/A
8/4/97	ADDENDUM NO. 1	△
7/14/97	ISSUED FOR BID	N/A

WATER PLAN & PROFILE
LINE 5 - M-2 NORTH
ADDISON CIRCLE
PHASE II PUBLIC INFRASTRUCTURE
TOWN OF ADDISON, TEXAS
 Huitt-Zollars, Inc./Engineering/Architecture
 Dallas, Fort Worth, Houston, El Paso, Phoenix, Tustin, Ontario

DESIGN	DRAWN	APPR.	SCALE	DATE	PROJECT NO.	NO.
HZ1	HZ1	DEM	H: 1"=20' V: 1"=6'	OCT. 97	01-1822-21	W11