

FUTURE DEVELOPMENT  
 WASTEWATER LATERALS ON 2% GRADE TO CLEAR UTILITIES

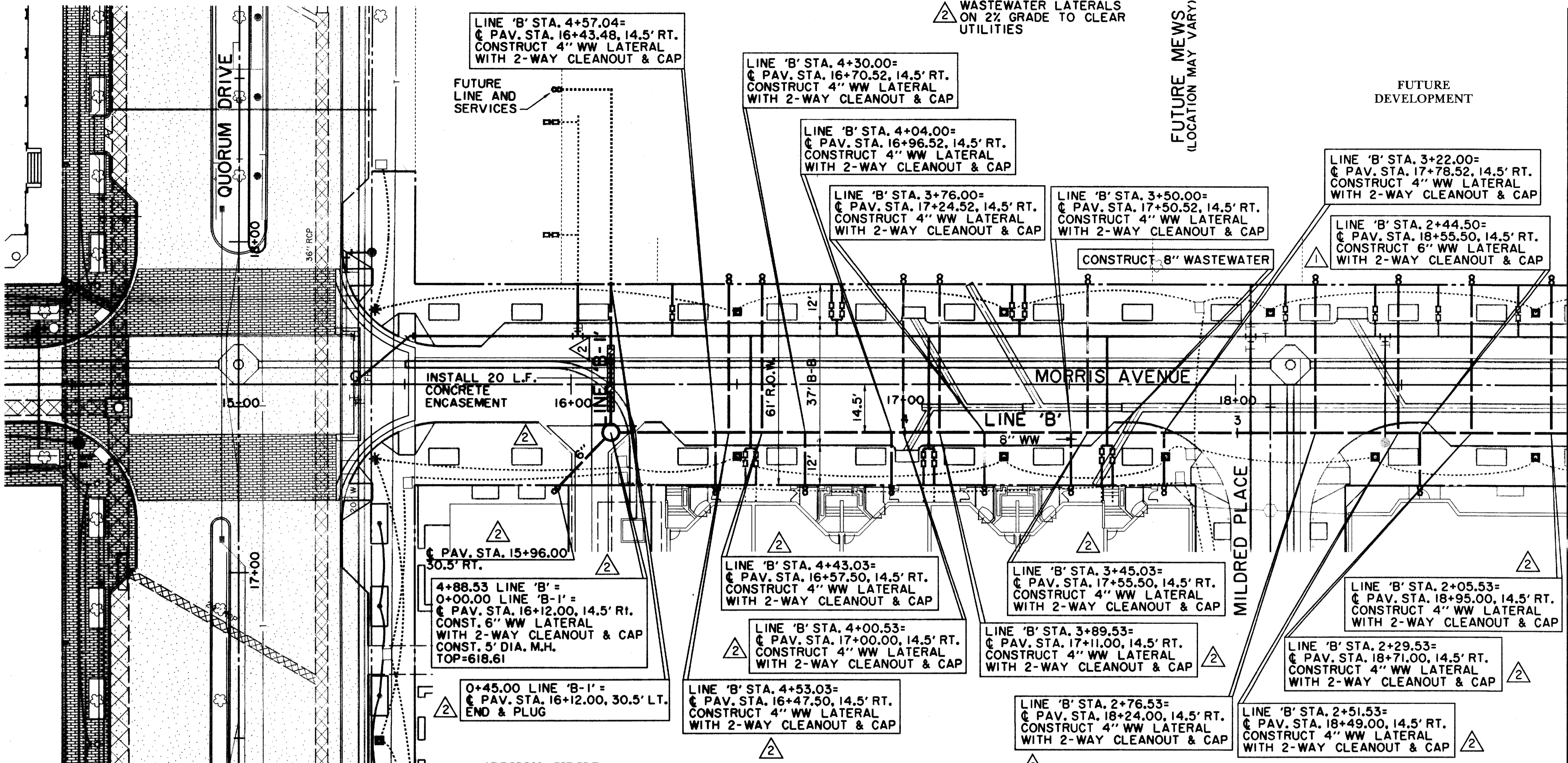
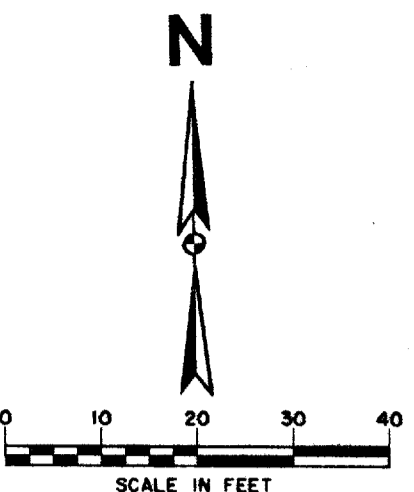

# RECORD DRAWING

## LEGEND

	ELECTRIC — ONE		MISC.
	LIGHT POLE		EX. STORM SEWER
	POWER POLE		CHAIN LINK FENCE
	GUY WIRE		WOOD FENCE
	TELEPHONE — T		EXISTING ASPHALT
	TELEPHONE MANHOLE		EXISTING DIRT OR GRAVEL
	TELEPHONE PEDESTAL		EX. CONCRETE
	TELEPHONE SIGN		TREE/TREE LINE
	GAS — G		EXISTING CURB
	GAS METER		PROP. CURB
	GAS SIGN		PROP. EDGE OF PAVEMENT NO CURB
	LAND USE		EX. PROPERTY LINE
	RAILROAD SIGN		PROP. CENTERLINE
	SIGN		PROP. R.O.W.
	SURVEY		PROP. INLET
	FOUND IRON ROD		TOP OF PAVEMENT
	BENCHMARK		TOP OF CURB
	WASTEWATER — W		CURB RETURN
	WASTEWATER MANHOLE		EXISTING GUTTER
	CLEANOUT		EXISTING TOP OF CURB
	WATER — W		BORING LOCATION
	FIRE HYDRANT		EXISTING BRICKS
	METER		PAVEMENT REMOVAL
	WATER VALVE		

THE SEAL APPEARING ON THIS DOCUMENT WAS AUTHORIZED BY DAVID E. MEYERS, P.E. 81512

THE SEAL APPEARING ON THIS DOCUMENT WAS AUTHORIZED BY DAVID E. MEYERS, P.E. 81512

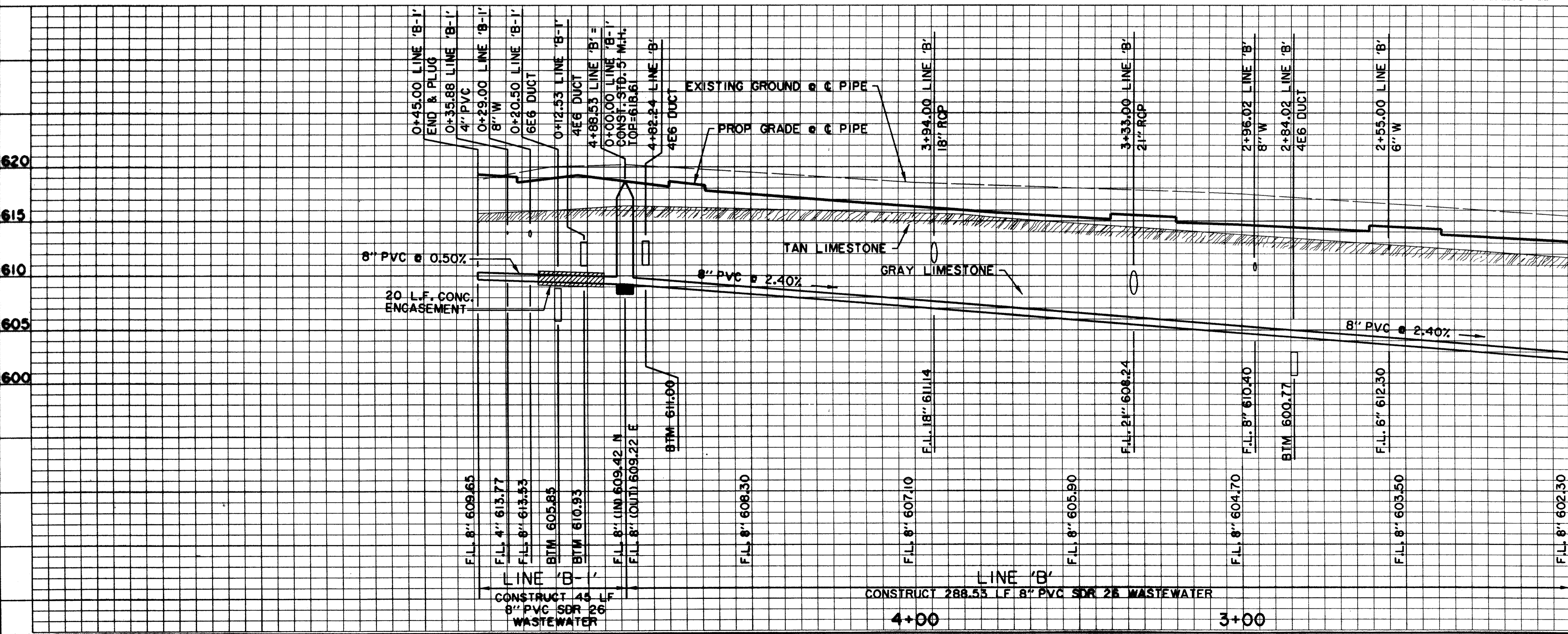

**BENCHMARKS:**

BM#1  
 "C" CUT AT CENTER BACK OF CURB OF INLET, 190 FEET SOUTH FROM THE CENTERLINE INTERSECTION OF MILDRED STREET, WEST SIDE OF QUORUM DRIVE. ELEV. 621.89

BM#4  
 "C" CUT AT CENTER OF CURB INLET, 1015 FEET NORTH FROM THE CENTERLINE INTERSECTION OF MILDRED STREET, WEST SIDE OF QUORUM DRIVE. ELEV. 629.36

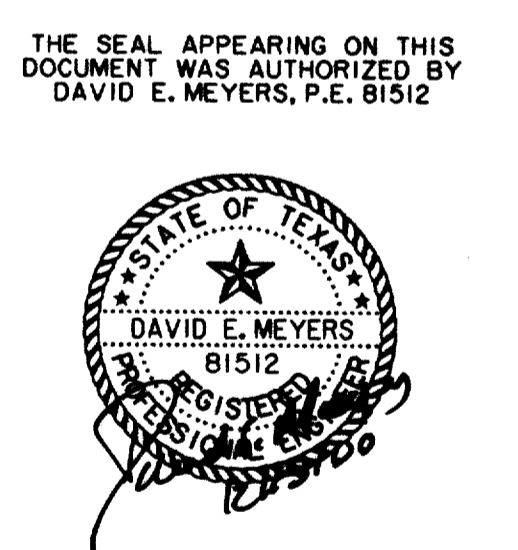

DATE	DESCRIPTION	REF. NO.
1/12/98	ADDED SERVICES FOR FUTURE TOWNHOMES;	2
11/15/97	SHORTENED LINE 'B'; ADDED LINE 'B-1'	1
	REVISED SIZE OF LATERAL STA. 5+04.52	
	REVISED 6" LATERAL LOCATION	
10/3/97	ISSUED FOR CONSTRUCTION	N/A
7/14/97	ISSUED FOR BID	N/A

**WASTEWATER PLAN & PROFILE**  
 LINE 'B' - STA. 2+00 TO STA. 5+25

**ADDISON CIRCLE**  
 PHASE II PUBLIC INFRASTRUCTURE  
 TOWN OF ADDISON, TEXAS

Hull-Tollars, Inc./Engineering/Architecture  
 Dallas, Fort Worth, Houston, El Paso, Phoenix, Tustin, Ontario

DESIGN	DRAWN	APPR.	SCALE	DATE	PROJECT NO.	NO.
HZI	HZI	DEM	H <sub>v</sub> 1"=20' V <sub>h</sub> 1"=6'	OCT. 97	01-1822-21	WW3