

MATCH LINE STA. 20+00

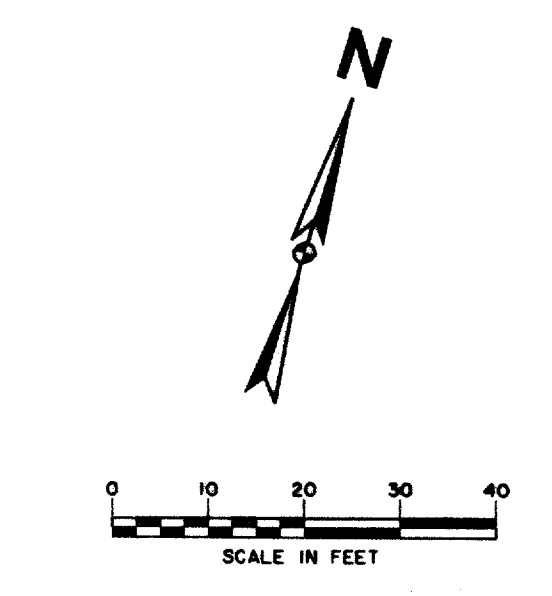

RECORD DRAWING

LEGEND

ELECTRIC — ONE —	48" RCP	MISC.
○ LIGHT POLE	EX. STORM SEWER	
PP POWER POLE	CHAIN LINK FENCE	
← GUY WIRE	WOOD FENCE	
TELEPHONE — T —	EXISTING ASPHALT	
TELEPHONE MANHOLE	EXISTING DIRT OR GRAVEL	
TELEPHONE PEDestal	EX. CONCRETE	
TELEPHONE SIGN	TREE/TREE LINE	
GAS — G —	EXISTING CURB	
GAS METER	PROP. CURB	
GAS SIGN	PROP. EDGE OF PAVEMENT NO CURB	
LAND USE	PROP. CENTERLINE	
R/R RAILROAD SIGN	PROP. R.O.W.	
⊕ SIGN	PROP. INLET	
SURVEY	T.P. TOP OF PAVEMENT	
I.R. FOUND IRON ROD	T.C. TOP OF CURB	
BENCHMARK	CR CURB RETURN	
WASTEWATER — WW —	EX. G EXISTING GUTTER	
WM WASTEWATER MANHOLE	EX. T.C. EXISTING TOP OF CURB	
CO CLEANOUT	B-20 BORING LOCATION	
WATER — W —	EXISTING BRICKS	
FH FIRE HYDRANT	PAVEMENT REMOVAL	
WM METER		
T WATER VALVE		

BENCHMARKS:

BM#1
"I" CUT AT CENTER BACK OF CURB OF INLET, 190 FEET SOUTH FROM THE CENTERLINE INTERSECTION OF ADDISON CIRCLE, WEST SIDE OF QUORUM DRIVE, ELEV. 621.89

BM#5
"I" CUT AT NORTHWEST CORNER OF NORTH HDWL. OF 7'x7' BOX CULVERT UNDER RAILROAD, 180' WEST OF DALLAS PARKWAY SOUTHBOUND, ELEV. 610.49

THE SEAL APPEARING ON THIS DOCUMENT WAS AUTHORIZED BY DAVID E. MEYERS, P.E. 81512

DATE	DESCRIPTION	REF NO.
12/1/97	ADDED PAV. STA. AND OFFSETS	
11/15/97	REVISED BLDG. "O" LATERAL, DELETED 8" AND ADDED 2-6" LATERALS BLDG. "Q"	
10/3/97	ISSUED FOR CONSTRUCTION	N/A
7/14/97	ISSUED FOR BID	N/A

WASTEWATER PLAN
ADDISON CIRCLE
ADDISON CIRCLE
PHASE II PUBLIC INFRASTRUCTURE
TOWN OF ADDISON, TEXAS

Huitt-Zollars, Inc./Engineering/Architecture
Dallas, Fort Worth, Houston, El Paso, Phoenix, Tustin, Ontario

DESIGN	DRAWN	APPR.	SCALE	DATE	PROJECT NO.	NO.
HZI	HZI	DEM	1"=20'	OCT. 97	01-1822-21	WW5

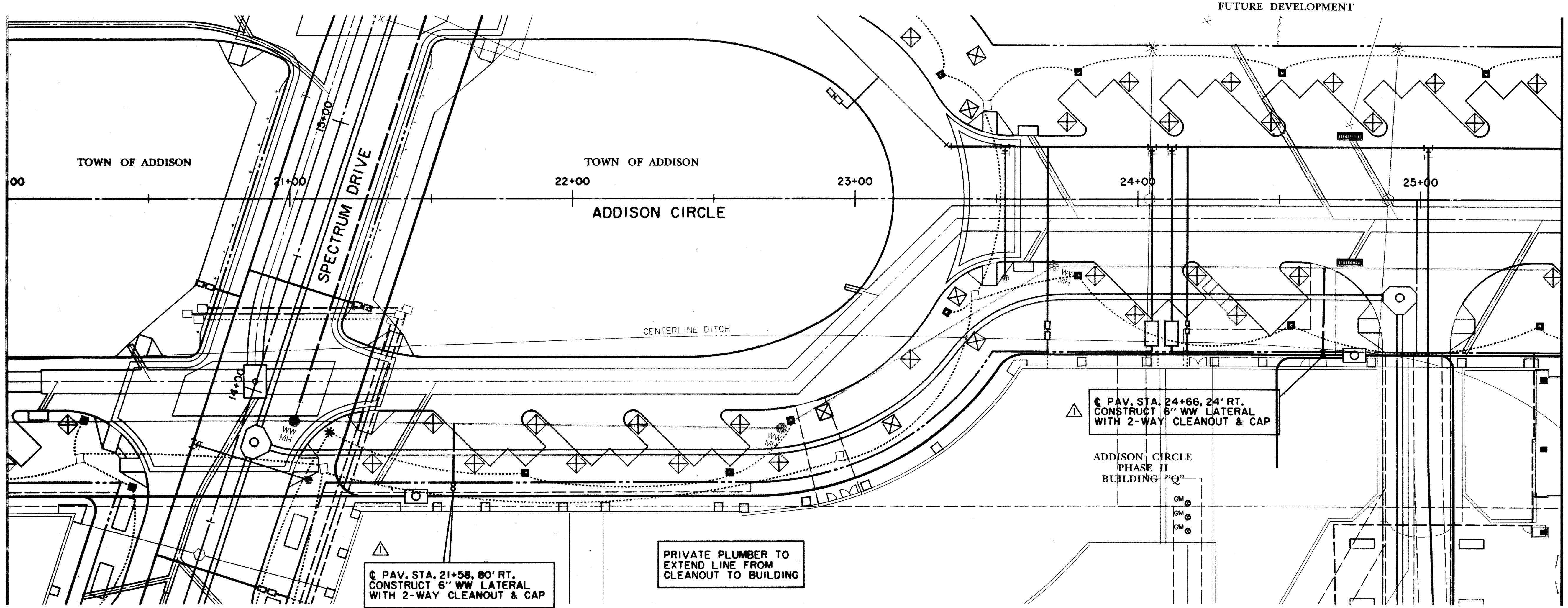

MATCH LINE STA. 20+00

MATCH LINE STA. 25+00

ALL DIMENSIONS UNLESS OTHERWISE NOTED ARE IN FEET AND DECIMALS THEREOF.
 ALL CONSTRUCTION SHALL BE IN ACCORDANCE WITH THE LATEST EDITIONS OF THE STANDARD SPECIFICATIONS FOR PUBLIC WORKS OF THE STATE OF TEXAS AND THE LATEST EDITIONS OF THE STANDARD SPECIFICATIONS FOR HIGHWAY CONSTRUCTION OF THE TEXAS DEPARTMENT OF TRANSPORTATION.
 THE CONTRACTOR SHALL BE RESPONSIBLE FOR OBTAINING ALL NECESSARY PERMITS AND APPROVALS FROM THE APPROPRIATE AGENCIES.
 THE CONTRACTOR SHALL MAINTAIN ACCESS TO ALL ADJACENT PROPERTIES AND UTILITIES AT ALL TIMES.
 THE CONTRACTOR SHALL BE RESPONSIBLE FOR PROTECTING ALL EXISTING UTILITIES AND STRUCTURES.
 THE CONTRACTOR SHALL MAINTAIN ADEQUATE RECORD DRAWINGS THROUGHOUT THE PROJECT.
 THE CONTRACTOR SHALL BE RESPONSIBLE FOR OBTAINING ALL NECESSARY PERMITS AND APPROVALS FROM THE APPROPRIATE AGENCIES.
 THE CONTRACTOR SHALL MAINTAIN ACCESS TO ALL ADJACENT PROPERTIES AND UTILITIES AT ALL TIMES.
 THE CONTRACTOR SHALL BE RESPONSIBLE FOR PROTECTING ALL EXISTING UTILITIES AND STRUCTURES.
 THE CONTRACTOR SHALL MAINTAIN ADEQUATE RECORD DRAWINGS THROUGHOUT THE PROJECT.