

**LEGEND**

	<b>ELECTRIC — ONE —</b>		
	LIGHT POLE		EX. STORM SEWER
	POWER POLE		CHAIN LINK FENCE
	GUY WIRE		WOOD FENCE
	<b>TELEPHONE — T —</b>		EXISTING ASPHALT
	TELEPHONE MANHOLE		EXISTING DIRT OR GRAVEL
	TELEPHONE PEDESTAL		EX. CONCRETE
	TELEPHONE SIGN		TREE/TREE LINE
	<b>GAS — G —</b>		EXISTING CURB
	GAS METER		PROP. CURB
	GAS SIGN		PROP. EDGE OF PAVEMENT NO CURB
	<b>LAND USE</b>		EX. PROPERTY LINE
	RAILROAD SIGN		PROP. CENTERLINE
	SIGN		PROP. R.O.W.
	<b>SURVEY</b>		PROP. INLET
	FOUND IRON ROD		TOP OF PAVEMENT
	BENCHMARK		TOP OF CURB
	<b>WASTEWATER — WW —</b>		CURB RETURN
	WASTEWATER MANHOLE		EXISTING GUTTER
	CLEANOUT		EXISTING TOP OF CURB
	<b>WATER — W —</b>		BORING LOCATION
	FIRE HYDRANT		EXISTING BRICKS
	METER		PAVEMENT REMOVAL
	WATER VALVE		

**RECORD DRAWING**

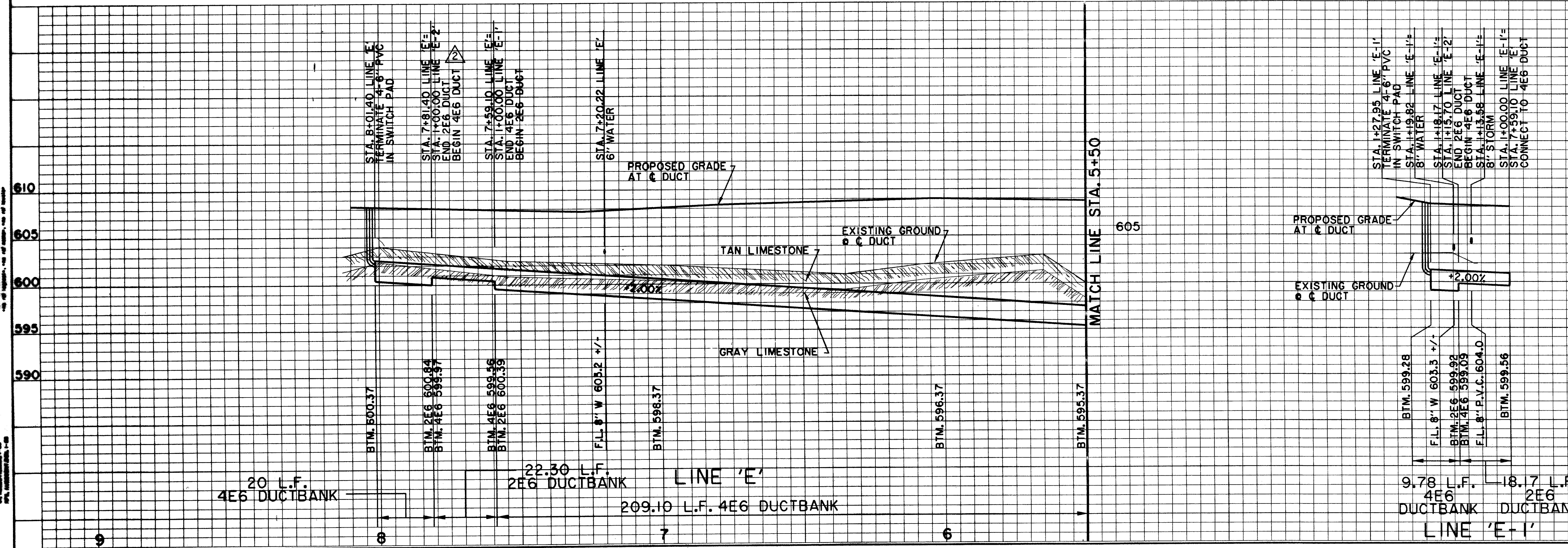

**BENCHMARKS:**

BM#1 'I' CUT AT CENTER BACK OF CURB OF INLET, 190 FEET SOUTH FROM THE CENTERLINE INTERSECTION OF ADDISON CIRCLE, WEST SIDE OF QUORUM DRIVE. ELEV. 621.89

BM#5 'I' CUT AT NORTHWEST CORNER OF NORTH HDWL. OF 7'X7' BOX CULVERT UNDER RAILROAD, 180' WEST OF DALLAS PARKWAY SOUTHBOUND. ELEV. 610.49

THE SEAL APPEARING ON THIS DOCUMENT WAS AUTHORIZED BY DAVID E. MEYERS, P.E. 81512

DATE	DESCRIPTION	REF NO.
10/30/97	MISC. STATION & OFFSET REVISIONS	2
10/3/97	ISSUED FOR CONSTRUCTION	N/A
9/29/97	REVISED SWITCH PAD LOCATION	1
7/14/97	ISSUED FOR BID	N/A

**ELECTRICAL DUCTBANK PLAN & PROFILE**  
**LINE 'E'**

**ADDISON CIRCLE**  
**PHASE II PUBLIC INFRASTRUCTURE**  
**TOWN OF ADDISON, TEXAS**

Hui11-Zollars, Inc./Engineering/Architecture  
 Dallas, Fort Worth, Houston, El Paso, Phoenix, Tustin, Ontario

DESIGN	DRAWN	APPR.	SCALE	DATE	PROJECT NO.	NO.
HZ1	HZ1	DEM	H: 1"=20' V: 1"=6'	OCT. 97	01-1822-21	E10