

FUTURE DEVELOPMENT

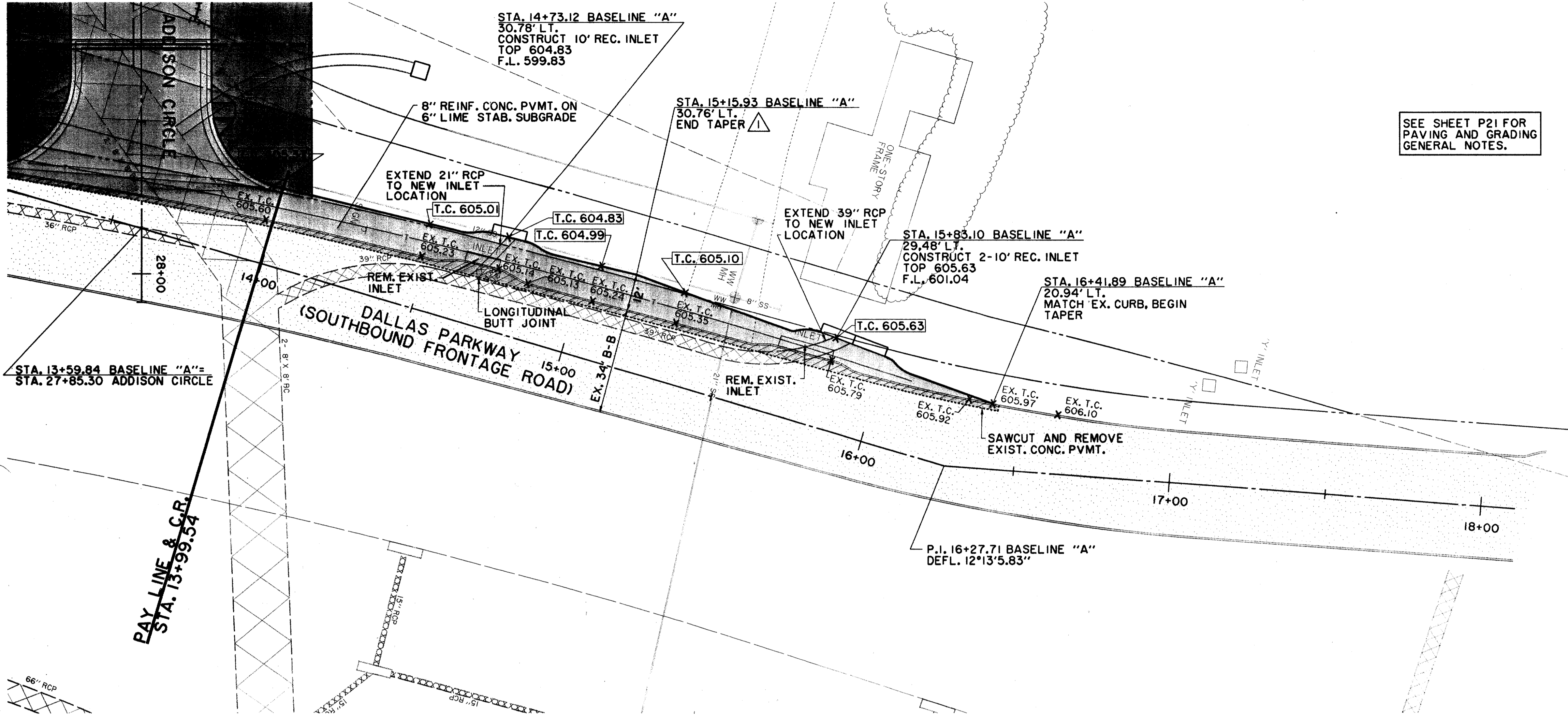

SEE SHEET P21 FOR PAVING AND GRADING GENERAL NOTES.

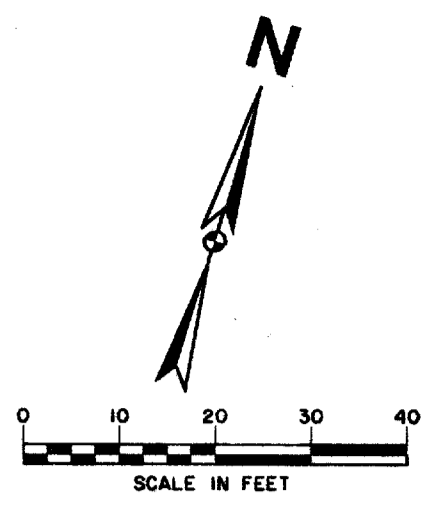

LEGEND

	ELECTRIC — OHE —		
	⊙ LIGHT POLE		EX. STORM SEWER
	pp POWER POLE		CHAIN LINK FENCE
	— GUY WIRE		WOOD FENCE
	TELEPHONE — T —		EXISTING ASPHALT
	⊙ TELEPHONE MANHOLE		EXISTING DIRT OR GRAVEL
	⊙ TELEPHONE PEDESTAL		EX. CONCRETE
	⊙ TELEPHONE SIGN		TREE/TREE LINE
	GAS — G —		EXISTING CURB
	GM ⊙ GAS METER		PROP. CURB
	GS ⊙ GAS SIGN		PROP. EDGE OF PAVEMENT NO CURB
	R-R RAILROAD SIGN		EX. PROPERTY LINE
	⊙ SIGN		PROP. CENTERLINE
	SURVEY		PROP. R.O.W.
	I.R. FOUND IRON ROD		PROP. INLET
	BM BENCHMARK		T.P. TOP OF PAVEMENT
	WW ⊙ WASTEWATER MANHOLE		T.C. TOP OF CURB
	CO CLEANOUT		CR CURB RETURN
	WATER — W —		EX. G. EXISTING GUTTER
	FH ⊙ FIRE HYDRANT		EX. T.C. EXISTING TOP OF CURB
	WM ⊙ METER		B-20 BORING LOCATION
	T WATER VALVE		EXISTING BRICKS
			PAVEMENT REMOVAL

RECORD DRAWING

BENCHMARKS:
 BM#5
 '1' CUT AT NORTHWEST CORNER OF NORTH HDWL. OF 7'X7' BOX CULVERT UNDER RAILROAD, 180' WEST OF DALLAS PARKWAY SOUTHBOUND. ELEV. 610.49
 BM#6
 '1' CUT AT CENTER FRONT OF 18' REC. INLET, SECOND INLET NORTH OF RAILROAD TRACKS ON THE WEST SIDE OF DALLAS PARKWAY SOUTHBOUND. ELEV. 605.67

THE SEAL APPEARING ON THIS DOCUMENT WAS AUTHORIZED BY DAVID E. MEYERS, P.E. 81512

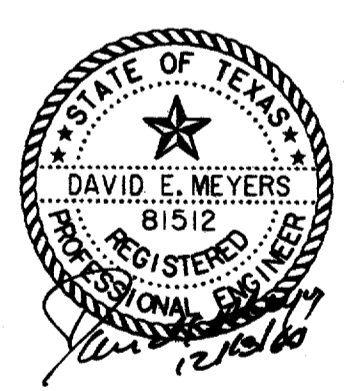

DATE	DESCRIPTION	REF NO.
5/21/98	REVISED DECEL. LANE TAPER	△
10/3/97	ISSUED FOR CONSTRUCTION	N/A
7/14/97	ISSUED FOR BID	N/A

PAVING PLAN & PROFILE
DALLAS PARKWAY DECELERATION LANE
ADDISON CIRCLE
PHASE II PUBLIC INFRASTRUCTURE
TOWN OF ADDISON, TEXAS
Huitt-Zollars, Inc./Engineering/Architecture
Dallas, Fort Worth, Houston, El Paso, Phoenix, Tustin, Ontario

DESIGN	DRAWN	APPR.	SCALE	DATE	PROJECT NO.	NO.
HZI	HZI	DEM	H _v 1"=20' V _h 1"=8'	OCT. 97	01-1822-21	P12

HUIIT-ZOLLARS, INC. ENGINEERING/ARCHITECTURE
 11111 W. HUNTERS TRAIL, SUITE 100, DALLAS, TEXAS 75244
 TEL: 972-242-1111 FAX: 972-242-1112
 WWW.HUIITZOLLARS.COM
 PROJECT NO. 01-1822-21-012
 DATE: 10/3/97
 DRAWN BY: HZI
 CHECKED BY: DEM
 SCALE: H_v 1"=20', V_h 1"=8'
 SHEET NO. P12 OF P12