

LEGEND

| | | | | | |
|--|--------------------|--|--------------------------------|--|-------------------------------|
| | ELECTRIC — ONE | | 48" RCP | | MISC. EX. STORM SEWER |
| | LIGHT POLE | | CHAIN LINK FENCE | | EXISTING ASPHALT |
| | POWER POLE | | WOOD FENCE | | EXISTING DIRT OR GRAVEL |
| | GUY WIRE | | EX. CONCRETE | | TREE/TREE LINE |
| | TELEPHONE | | EXISTING CURB | | PROP. CURB |
| | TELEPHONE MANHOLE | | PROP. EDGE OF PAVEMENT NO CURB | | EX. PROPERTY LINE |
| | TELEPHONE PEDESTAL | | PROP. CENTERLINE | | PROP. R.O.W. |
| | TELEPHONE SIGN | | PROP. INLET | | T.P. TOP OF PAVEMENT |
| | GAS | | T.C. TOP OF CURB | | CR CURB RETURN |
| | GAS METER | | EX. G EXISTING GUTTER | | EX. T.C. EXISTING TOP OF CURB |
| | GAS SIGN | | B-20 BORING LOCATION | | EXISTING BRICKS |
| | LAND USE | | PAVEMENT REMOVAL | | |
| | RAILROAD SIGN | | | | |
| | SIGN | | | | |
| | SURVEY | | | | |
| | FOUND IRON ROD | | | | |
| | BENCHMARK | | | | |
| | WASTEWATER | | | | |
| | WASTEWATER MANHOLE | | | | |
| | CLEANOUT | | | | |
| | WATER | | | | |
| | FIRE HYDRANT | | | | |
| | METER | | | | |
| | WATER VALVE | | | | |

RECORD DRAWING

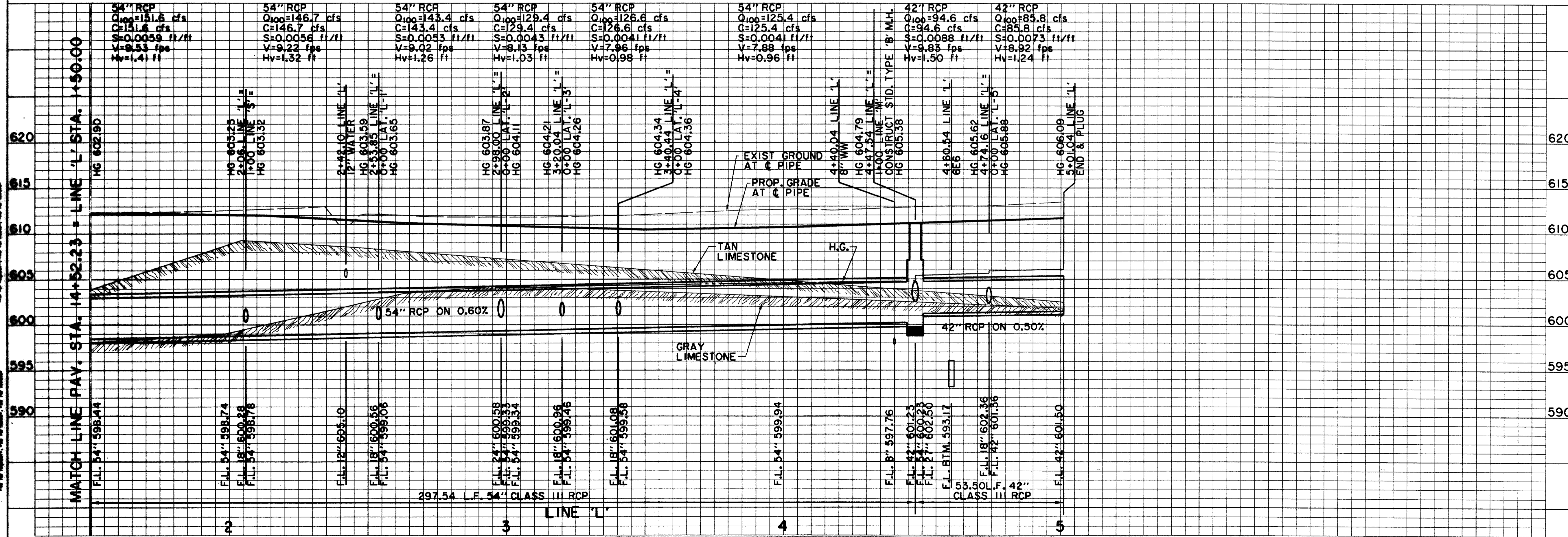

BENCHMARKS:

BM#5
"C" CUT AT NORTHWEST CORNER OF NORTH HDWL. OF 7'X7' BOX CULVERT UNDER RAILROAD, ±180' WEST OF DALLAS PARKWAY SOUTHBOUND, ELEV. 610.49

BM#6
"C" CUT AT CENTER FRONT OF 18" REC. INLET, SECOND INLET NORTH OF RAILROAD TRACKS ON THE WEST SIDE OF DALLAS PARKWAY SOUTHBOUND, ELEV. 605.67

THE SEAL APPEARING ON THIS DOCUMENT WAS AUTHORIZED BY DAVID E. MEYERS, P.E. 81512

| DATE | DESCRIPTION | REF. NO. |
|---------|-------------------------------|----------|
| 2/18/98 | REVISED LAT. 'L-2' STATIONING | |
| 10/3/97 | ISSUED FOR CONSTRUCTION | N/A |
| 7/14/97 | ISSUED FOR BID | N/A |

STORM WATER PLAN & PROFILE
LINE 'L' STA. 1+50 TO STA. 5+01.04

ADDISON CIRCLE
PHASE II PUBLIC INFRASTRUCTURE
TOWN OF ADDISON, TEXAS

Huitt-Zollers, Inc./Engineering/Architecture
Dallas, Fort Worth, Houston, El Paso, Phoenix, Tustin, Ontario

| DESIGN | DRAWN | APPR. | SCALE | DATE | PROJECT NO. | NO. |
|--------|-------|-------|---|---------|-------------|------|
| HZI | HZI | DEM | H ₁ 1"=20' V ₁ 1"=6' | OCT. 97 | 01-1822-21 | SWIG |

PROJECT NO. 01-1822-21
 DATE: 10/3/97
 DRAWN BY: HZI
 CHECKED BY: DEM
 PROJECT: ADDISON CIRCLE PHASE II PUBLIC INFRASTRUCTURE
 TOWN OF ADDISON, TEXAS

HUIIT-ZOLLERS, INC./ENGINEERING/ARCHITECTURE
 1100 WEST WILSON AVENUE, SUITE 100
 DALLAS, TEXAS 75201
 TEL: 214-343-8800
 FAX: 214-343-8801
 WWW: WWW.HUIIT-ZOLLERS.COM