

1+00 LINE 'M' =
4+47.54 LINE 'L' =
PAV. STA. 17+49.77,
7.00' RT.
CONSTRUCT STD. TYPE 'B' M.H.
TOP: 611.14
F.L. 602.30

LEGEND

ELECTRIC — ONE	48" RCP	MISC.
○ LIGHT POLE	EX. STORM SEWER	CHAIN LINK FENCE
PP POWER POLE	EXISTING ASPHALT	WOOD FENCE
← GUY WIRE	EXISTING DIRT OR GRAVEL	EX. CONCRETE
TELEPHONE — T	EXISTING CURB	TREE/TREE LINE
● TELEPHONE MANHOLE	PROP. CURB	EXISTING CURB
TS TELEPHONE PEDESTAL	PROP. EDGE OF PAVEMENT NO CURB	PROP. CENTERLINE
TS TELEPHONE SIGN	EX. PROPERTY LINE	PROP. R.O.W.
GM GAS METER	PROP. INLET	T.P. TOP OF PAVEMENT
GS GAS SIGN	PROP. CENTERLINE	T.C. TOP OF CURB
LAND USE	PROP. R.O.W.	CR CURB RETURN
R/R RAILROAD SIGN	PROP. INLET	EX. G. EXISTING GUTTER
TS SIGN	T.P. TOP OF PAVEMENT	EX. T.C. EXISTING TOP OF CURB
I.R. FOUND IRON ROD	T.C. TOP OF CURB	B-20 BORING LOCATION
WASTEWATER — WW	CR CURB RETURN	EXISTING BRICKS
WM WASTEWATER MANHOLE	EX. G. EXISTING GUTTER	PAVEMENT REMOVAL
CO CLEANOUT	B-20 BORING LOCATION	
WATER — W	EXISTING BRICKS	
FH FIRE HYDRANT	PAVEMENT REMOVAL	
WM METER		
T WATER VALVE		

RECORD DRAWING

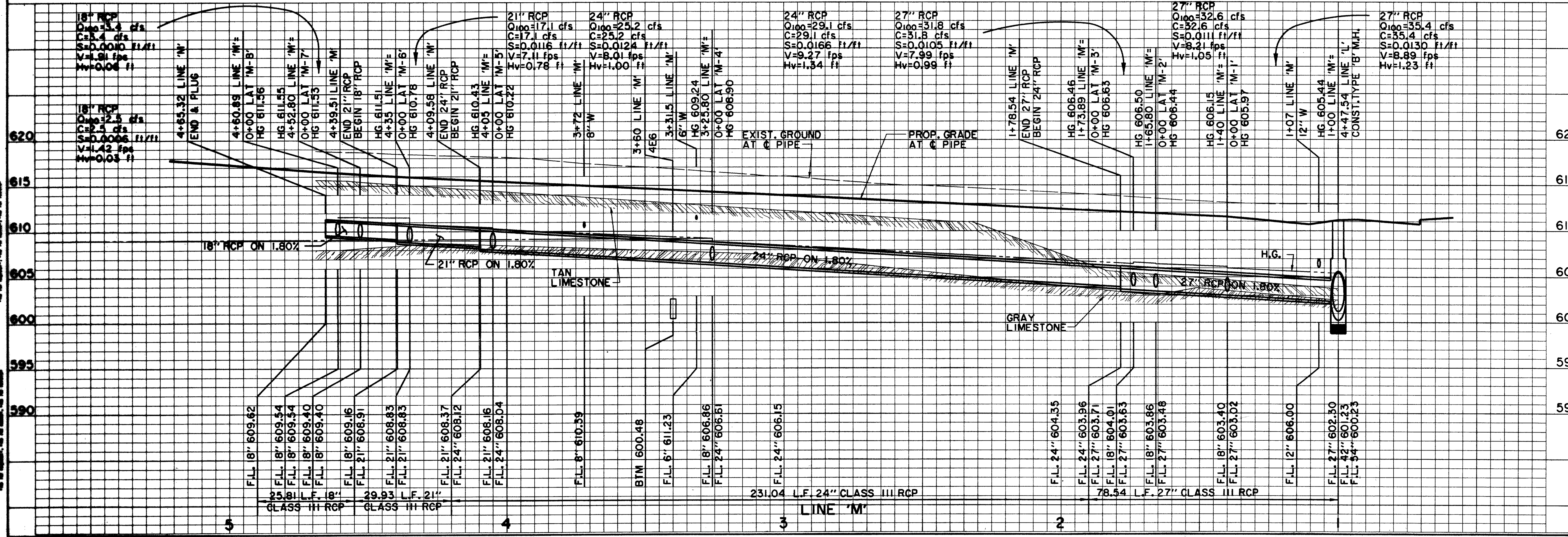

BENCHMARKS:

BM#4
"D" CUT AT CENTER OF CURB INLET, 1015 FEET NORTH FROM THE CENTERLINE INTERSECTION OF MILDRED STREET, WEST SIDE OF QUORUM DRIVE. ELEV. 629.36

BM#5
"T" CUT AT NORTHWEST CORNER OF NORTH HWY. OF 7'X7' BOX CULVERT UNDER RAILROAD, ±180' WEST OF DALLAS PARKWAY SOUTHBOUND. ELEV. 610.49

THE SEAL APPEARING ON THIS DOCUMENT WAS AUTHORIZED BY DAVID E. MEYERS, P.E. 81512

DATE	DESCRIPTION	REF. NO.
3/11/98	REVISED INLET OFFSETS	
10/3/97	ISSUED FOR CONSTRUCTION	N/A
7/14/97	ISSUED FOR BID	N/A

STORM WATER PLAN & PROFILE
LINE 'M' STA. 1+00 TO STA. 4+63.89

ADDISON CIRCLE
PHASE II PUBLIC INFRASTRUCTURE
TOWN OF ADDISON, TEXAS

Huitt-Zollars, Inc./Engineering/Architecture
Dallas, Fort Worth, Houston, El Paso, Phoenix, Tustin, Ontario

DESIGN	DRAWN	APPR.	SCALE	DATE	PROJECT NO.	NO.
HZI	HZI	DEM	H ₁ 1"=20' V ₁ 1"=6'	OCT. 97	01-1822-21	SW17

ALL DIMENSIONS UNLESS OTHERWISE NOTED ARE IN FEET AND DECIMALS THEREOF.
 ALL CONSTRUCTION SHALL BE IN ACCORDANCE WITH THE LATEST EDITIONS OF THE TEXAS DEPARTMENT OF TRANSPORTATION STANDARD SPECIFICATIONS FOR ROAD AND BRIDGE CONSTRUCTION AND THE LATEST EDITIONS OF THE TEXAS DEPARTMENT OF TRANSPORTATION STANDARD SPECIFICATIONS FOR WATERWAY CONSTRUCTION.
 ALL MATERIALS SHALL BE OF THE BEST QUALITY AVAILABLE AND SHALL BE SUBJECT TO INSPECTION AND TESTING BY THE ENGINEER.
 THE CONTRACTOR SHALL BE RESPONSIBLE FOR OBTAINING ALL NECESSARY PERMITS AND FOR PROTECTING ALL UTILITIES AND ADJACENT PROPERTIES.
 THE CONTRACTOR SHALL MAINTAIN ACCESS TO ALL ADJACENT PROPERTIES AND SHALL BE RESPONSIBLE FOR RESTORING ALL ADJACENT PROPERTIES TO ORIGINAL OR BETTER CONDITION.
 THE CONTRACTOR SHALL MAINTAIN ADEQUATE DRAINAGE AND EROSION CONTROL MEASURES THROUGHOUT THE CONSTRUCTION PERIOD.
 THE CONTRACTOR SHALL MAINTAIN ADEQUATE SAFETY MEASURES THROUGHOUT THE CONSTRUCTION PERIOD.
 THE CONTRACTOR SHALL MAINTAIN ADEQUATE RECORDS OF ALL CONSTRUCTION ACTIVITIES.
 THE CONTRACTOR SHALL BE RESPONSIBLE FOR OBTAINING ALL NECESSARY PERMITS AND FOR PROTECTING ALL UTILITIES AND ADJACENT PROPERTIES.
 THE CONTRACTOR SHALL MAINTAIN ACCESS TO ALL ADJACENT PROPERTIES AND SHALL BE RESPONSIBLE FOR RESTORING ALL ADJACENT PROPERTIES TO ORIGINAL OR BETTER CONDITION.
 THE CONTRACTOR SHALL MAINTAIN ADEQUATE DRAINAGE AND EROSION CONTROL MEASURES THROUGHOUT THE CONSTRUCTION PERIOD.
 THE CONTRACTOR SHALL MAINTAIN ADEQUATE SAFETY MEASURES THROUGHOUT THE CONSTRUCTION PERIOD.
 THE CONTRACTOR SHALL MAINTAIN ADEQUATE RECORDS OF ALL CONSTRUCTION ACTIVITIES.