

NOTE:
CENTER TO CENTER TREE DIMENSIONS
ARE MEASURED ALONG THE CENTERLINE
OF THE STREET.

LEGEND

ELECTRIC	— OHE —	MISC.	48" RCP	EX. STORM SEWER
⊕	LIGHT POLE	—	CHAIN LINK FENCE	WOOD FENCE
pp	POWER POLE	—	EXISTING ASPHALT	EXISTING DIRT OR GRAVEL
—	GUY WIRE	—	EX. CONCRETE	TREE/TREE LINE
TELE	TELEPHONE	— T —	EXISTING CURB	PROP. CURB
MH	TELEPHONE MANHOLE	—	PROP. EDGE OF PAVEMENT NO CURB	EX. PROPERTY LINE
⊕	TELEPHONE PEDESTAL	—	PROP. CENTERLINE	PROP. R.O.W.
TS	TELEPHONE SIGN	—	PROP. R.O.W.	PROP. INLET
G	GAS	— G —	T.P.	TOP OF PAVEMENT
GM	GAS METER	—	T.C.	TOP OF CURB
GS	GAS SIGN	—	CR	CURB RETURN
R.R.	RAILROAD SIGN	—	EX. G	EXISTING GUTTER
⊕	SIGN	—	EX. T.C.	EXISTING TOP OF CURB
I.R.	FOUND IRON ROD	—	B-20	BORING LOCATION
⊕	BENCHMARK	—	EXISTING BRICKS	PAVEMENT REMOVAL
WW	WASTEWATER	— WW —		
MH	WASTEWATER MANHOLE	—		
CO	CLEANOUT	—		
FH	FIRE HYDRANT	— W —		
M	METER	—		
T	WATER VALVE	—		

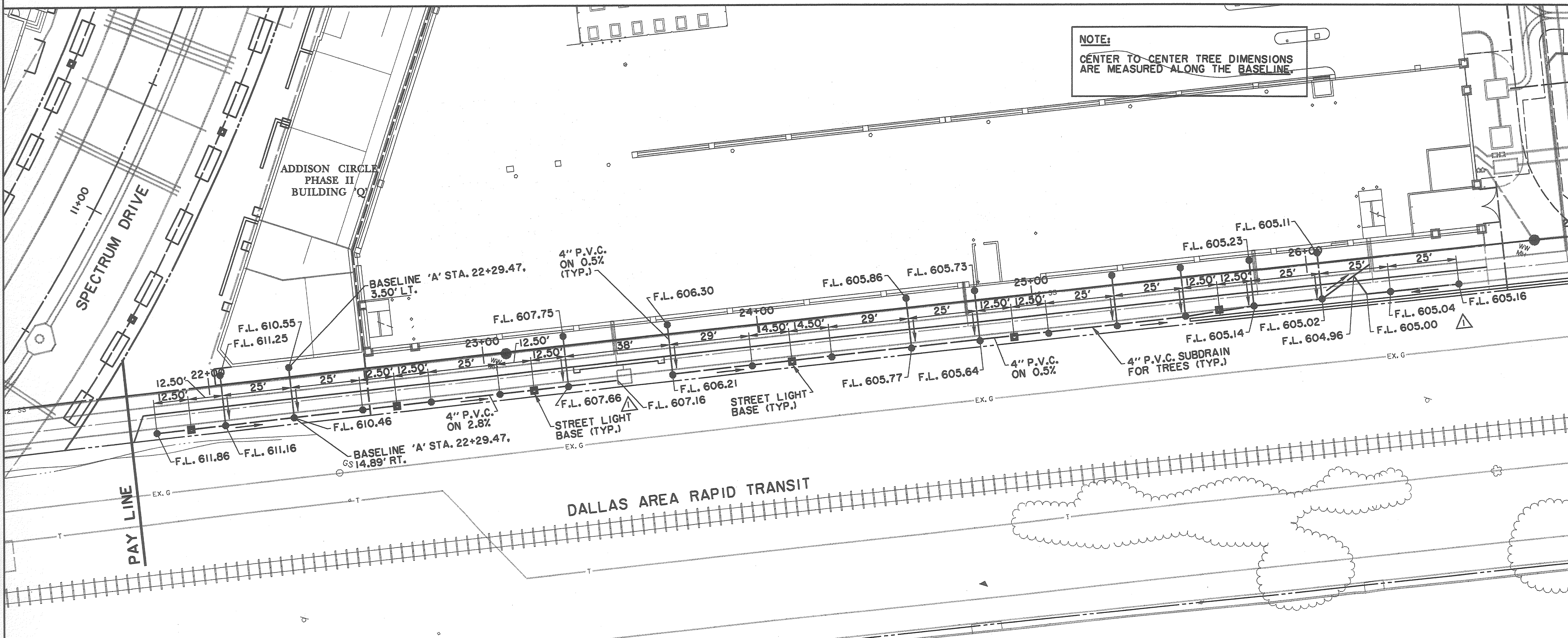

NOTE:
CENTER TO CENTER TREE DIMENSIONS
ARE MEASURED ALONG THE BASELINE.

BENCHMARKS:
BM#5
1" CUT AT NORTHWEST CORNER OF NORTH HDWL. OF 7x7" BOX CULVERT UNDER RAILROAD, ±180' WEST OF DALLAS PARKWAY SOUTHBOUND, ELEV. 610.49
BM#6
1" CUT AT CENTER FRONT OF 18" REC. INLET, SECOND INLET NORTH OF RAILROAD TRACKS ON THE WEST SIDE OF DALLAS PARKWAY SOUTHBOUND, ELEV. 605.67

THE SEAL APPEARING ON THIS DOCUMENT WAS AUTHORIZED BY DAVID E. MEYERS, P.E. 81512 ON 11/21/98

DATE	DESCRIPTION	REF. NO.
1/12/98	REVISED FLOWLINES, TREE AND LIGHT SPACING REMOVED TREE	▲
10/3/97	ISSUED FOR CONSTRUCTION	N/A
7/14/97	ISSUED FOR BID	N/A

STREETSCAPE PLAN
ADDISON CIRCLE / HIKE & BIKE
ADDISON CIRCLE
PHASE II PUBLIC INFRASTRUCTURE
TOWN OF ADDISON, TEXAS
Huitt-Zollars, Inc./Engineering/Architecture
Dallas, Fort Worth, Houston, El Paso, Phoenix, Austin, Ontario

DESIGN	DRAWN	APPR.	SCALE	DATE	PROJECT NO.	NO.
HZI	HZI	DEM	1"=20'	00R. 97	01-1822-21	ST5

18-AUG-2001 10:18:32 AM C:\P1\ADDISON\ADDISON\ADDISON.dwg
 P1: AUC2L203.DWG
 P2: AUC2L203.DWG
 P3: AUC2L203.DWG
 P4: AUC2L203.DWG
 P5: AUC2L203.DWG
 P6: AUC2L203.DWG
 P7: AUC2L203.DWG
 P8: AUC2L203.DWG
 P9: AUC2L203.DWG
 P10: AUC2L203.DWG
 P11: AUC2L203.DWG
 P12: AUC2L203.DWG
 P13: AUC2L203.DWG
 P14: AUC2L203.DWG
 P15: AUC2L203.DWG
 P16: AUC2L203.DWG
 P17: AUC2L203.DWG
 P18: AUC2L203.DWG
 P19: AUC2L203.DWG
 P20: AUC2L203.DWG
 P21: AUC2L203.DWG
 P22: AUC2L203.DWG
 P23: AUC2L203.DWG
 P24: AUC2L203.DWG
 P25: AUC2L203.DWG
 P26: AUC2L203.DWG
 P27: AUC2L203.DWG
 P28: AUC2L203.DWG
 P29: AUC2L203.DWG
 P30: AUC2L203.DWG
 P31: AUC2L203.DWG
 P32: AUC2L203.DWG
 P33: AUC2L203.DWG
 P34: AUC2L203.DWG
 P35: AUC2L203.DWG
 P36: AUC2L203.DWG
 P37: AUC2L203.DWG
 P38: AUC2L203.DWG
 P39: AUC2L203.DWG
 P40: AUC2L203.DWG
 P41: AUC2L203.DWG
 P42: AUC2L203.DWG
 P43: AUC2L203.DWG
 P44: AUC2L203.DWG
 P45: AUC2L203.DWG
 P46: AUC2L203.DWG
 P47: AUC2L203.DWG
 P48: AUC2L203.DWG
 P49: AUC2L203.DWG
 P50: AUC2L203.DWG
 P51: AUC2L203.DWG
 P52: AUC2L203.DWG
 P53: AUC2L203.DWG
 P54: AUC2L203.DWG
 P55: AUC2L203.DWG
 P56: AUC2L203.DWG
 P57: AUC2L203.DWG
 P58: AUC2L203.DWG
 P59: AUC2L203.DWG
 P60: AUC2L203.DWG
 P61: AUC2L203.DWG
 P62: AUC2L203.DWG
 P63: AUC2L203.DWG
 P64: AUC2L203.DWG
 P65: AUC2L203.DWG
 P66: AUC2L203.DWG
 P67: AUC2L203.DWG
 P68: AUC2L203.DWG
 P69: AUC2L203.DWG
 P70: AUC2L203.DWG
 P71: AUC2L203.DWG
 P72: AUC2L203.DWG
 P73: AUC2L203.DWG
 P74: AUC2L203.DWG
 P75: AUC2L203.DWG
 P76: AUC2L203.DWG
 P77: AUC2L203.DWG
 P78: AUC2L203.DWG
 P79: AUC2L203.DWG
 P80: AUC2L203.DWG
 P81: AUC2L203.DWG
 P82: AUC2L203.DWG
 P83: AUC2L203.DWG
 P84: AUC2L203.DWG
 P85: AUC2L203.DWG
 P86: AUC2L203.DWG
 P87: AUC2L203.DWG
 P88: AUC2L203.DWG
 P89: AUC2L203.DWG
 P90: AUC2L203.DWG
 P91: AUC2L203.DWG
 P92: AUC2L203.DWG
 P93: AUC2L203.DWG
 P94: AUC2L203.DWG
 P95: AUC2L203.DWG
 P96: AUC2L203.DWG
 P97: AUC2L203.DWG
 P98: AUC2L203.DWG
 P99: AUC2L203.DWG
 P100: AUC2L203.DWG