

CONTRACTOR TO CONSTRUCT LINE "D".

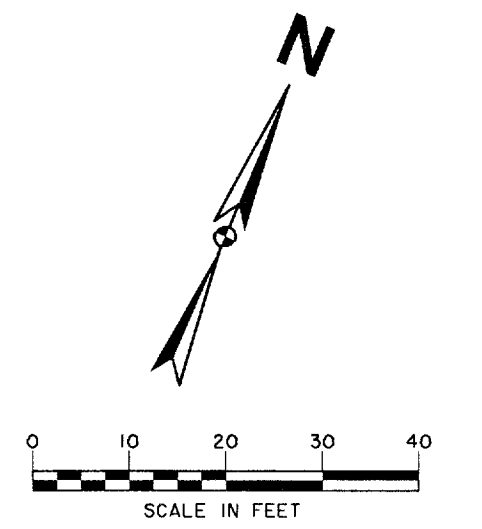

RECORD DRAWING:
 THIS DRAWING HAS BEEN MODIFIED FROM THE ORIGINAL DESIGN DRAWINGS TO REFLECT THE FIELD CHANGES THAT OCCURRED DURING CONSTRUCTION WHICH WERE DOCUMENTED AND FURNISHED TO THE ENGINEER BY THE CONTRACTOR. BASED ON THIS INFORMATION AND THE ENGINEER'S OBSERVATION OF CERTAIN CONSTRUCTION ACTIVITIES, TO THE BEST OF THE ENGINEER'S KNOWLEDGE AND BELIEF, THE PROJECT IS CONSTRUCTED IN CONFORMANCE WITH THE PLANS AND SPECIFICATIONS AND WILL FUNCTION AS DESIGNED.

CAUTION!!
 EXISTING 12" HIGH PRESSURE PETROLEUM. DEPTH MUST BE VERIFIED PRIOR TO ANY CONSTRUCTION WITH EXPLORER REPRESENTATIVE ON SITE. CONTACT JACK PHILLIPS WITH EXPLORER PIPELINE AT THE FOLLOING NUMBERS:
 OFFICE 817-481-4040,
 PAGER 817-432-0153,
 MOBILE 214-808-3286

LEGEND

ELECTRIC - OHE	48" RCP	MISC.
○ LIGHT POLE	EX. STORM SEWER	---
PP POWER POLE	CHAIN LINK FENCE	---
— GUY WIRE	WOOD FENCE	---
TELEPHONE	EXISTING ASPHALT	---
MH TELEPHONE MANHOLE	EXISTING DIRT OR GRAVEL	---
TELEPHONE PEDESTAL	EX. CONCRETE	---
TS TELEPHONE SIGN	TREE/TREE LINE	---
GM GAS METER	EXISTING CURB	---
GS GAS SIGN	PROP. CURB	---
LAND USE	PROP. EDGE OF PAVEMENT NO CURB	---
RR RAILROAD SIGN	EX. PROPERTY LINE	---
SIGN	PROP. CENTERLINE	---
SURVEY	PROP. R.O.W.	---
LR. FOUND IRON ROD	PROP. INLET	---
BENCHMARK	T.P. TOP OF PAVEMENT	---
WASTEWATER	T.C. TOP OF CURB	---
MH WASTEWATER MANHOLE	CR CURB RETURN	---
CO CLEANOUT	EX. G EXISTING GUTTER	---
WATER	EX. T.C. EXISTING TOP OF CURB	---
FH FIRE HYDRANT	B-20 BORING LOCATION	---
WM METER	EXISTING BRICKS	---
T WATER VALVE	PAVEMENT REMOVAL	---

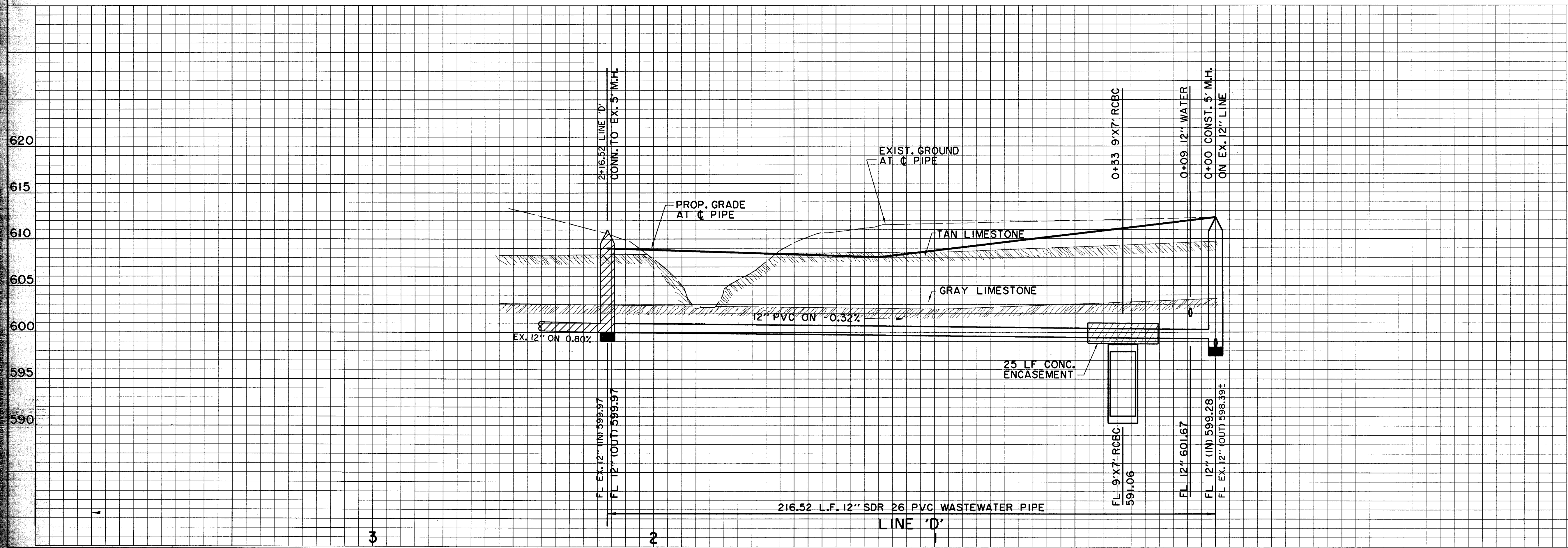

BENCHMARKS:
 BM#5
 'C' CUT AT NORTHWEST CORNER OF NORTH HDWL. OF 7'X7' BOX CULVERT UNDER RAILROAD, ±180' WEST OF DALLAS PARKWAY SOUTHBOUND. ELEV. 610.49
 BM#6
 'C' CUT AT CENTER FRONT OF 18" REC. INLET, SECOND INLET NORTH OF RAILROAD TRACKS ON THE WEST SIDE OF DALLAS PARKWAY SOUTHBOUND. ELEV. 605.67

THE SEAL APPEARING ON THIS DOCUMENT WAS AUTHORIZED BY DAVID E. MEYERS, P.E. 81512 ON 10/23/97

DATE	DESCRIPTION	REF. NO.
10/27/97	RECORD DRAWING	3
8/4/97	REVISED ELEVATION ON BENCHMARK #5	2
6/16/97	ISSUED FOR CONSTRUCTION	N/A
6/10/97	ADDENDUM NO. 1	N/A
6/2/97	ISSUED FOR BID	N/A

WASTEWATER PLAN & PROFILE
LINE 'D'
ADDISON CIRCLE
PHASE II MASS GRADING
TOWN OF ADDISON, TEXAS
 Huitt-Zollars, Inc./Engineering/Architecture
 Dallas, Fort Worth, Houston, El Paso, Phoenix, Tustin, Ontario

DESIGN	DRAWN	APPR.	SCALE	DATE	PROJECT NO.	NO.
HZI	HZI	DEM	H ₁ 1"=20' V ₁ 1"=6'	OCT. 97	01-1822-34	W3