

THIS PLAN IS FOR SIDEWALK AND FIRE LANE SITE GRADING ONLY. BUILDING ROUGH GRADING IS SHOWN FOR INFORMATIONAL PURPOSES ONLY. SEE ARCHITECT'S PLANS FOR BUILDING FOUNDATION, DETAILED FINISHED FLOOR ELEVATIONS AND DIMENSIONS.

**GRADING NOTES**

1. PLAN ELEVATIONS ARE TO FINISHED BUILDING SLAB, PAVEMENT OR PLANTING AREA. ADJUSTMENTS FOR SLAB, PAVEMENT AND PLANTING BED THICKNESS MUST BE MADE FOR THE PURPOSES OF EARTHWORK. REFER TO ARCHITECTURAL AND LANDSCAPE PLANS FOR ELEMENTS NOT DETAILED IN THESE PLANS.
2. ROUGH GRADING SHALL BE ACCOMPLISHED TO WITHIN +0.10 FEET OF PLAN ELEVATION (AFTER ADJUSTMENT FOR FINISH THICKNESS).
3. ALL TRAFFIC CONTROL NECESSARY FOR THE WORK SHALL BE PROVIDED BY THE AFFECTED CONTRACTOR. ALL BARRICADES, WARNING SIGNS, LIGHTS, DEVICES, ETC. FOR THE GUIDANCE AND PROTECTION OF TRAFFIC AND PEDESTRIANS MUST CONFORM TO THE INSTALLATIONS SHOWN IN THE LATEST EDITION OF THE TEXAS MANUAL ON UNIFORM TRAFFIC CONTROL DEVICES, AS CURRENTLY AMENDED, TEXAS DEPARTMENT OF TRANSPORTATION.
4. ALL FILL IN PUBLIC RIGHT-OF-WAY SHALL BE PLACED IN 6-INCH TO 8-INCH LOOSE LIFTS COMPACTED TO BETWEEN 95% AND 100% OF ITS MAXIMUM DRY DENSITY BETWEEN 0% AND +3% OF OPTIMUM MOISTURE CONTENT. ALL WORK SHALL BE IN ACCORDANCE WITH THE GEOTECHNICAL REPORT BY OTHERS.
5. ALL TREES, STUMPS, BRUSH, GRASSES AND SURFACE ORGANICS ARE TO BE REMOVED AND PROPERLY DISPOSED OF OFF-SITE. TREE REMOVAL PERMITS, IF REQUIRED, WILL BE OBTAINED BY THE OWNER.
6. EXISTING UTILITY POLES WILL BE REMOVED OR RELOCATED BY THE UTILITY COMPANIES THROUGH COORDINATION BY THE OWNER. CONTRACTOR SHALL BRING TO THE OWNER'S ATTENTION ANY FACILITIES THAT APPEAR TO BE IN CONFLICT SO THAT THE OWNER HAS SUFFICIENT TIME TO ACCOMPLISH THE NECESSARY RELOCATIONS.
7. THE CONTRACTOR SHALL INSTALL EROSION CONTROL MEASURES PER THE PLANS AND MAINTAIN STREETS FREE OF MUD, DIRT AND DEBRIS FOR THE DURATION OF THIS WORK.
8. CONTRACTOR SHALL ASSUME MAINTENANCE OF EROSION CONTROL MEASURES UPON THE DEPARTURE OF THE UTILITY CONTRACTOR OR THE COMMENCEMENT OF PAVING, WHICHEVER IS LATER. OWNER WILL MAINTAIN EROSION CONTROL MEASURES WHEN NO CONTRACTORS ARE ACTIVE ON THE SITE (UNLESS OTHERWISE INDICATED IN CONTRACT DOCUMENTS).
9. SPOT GRADES AT R.O.W. ARE BASED ON 1/4" / FT. CROSS SLOPE UNLESS OTHERWISE NOTED. THIS CROSS SLOPE MAY BE VARIED FROM 1% TO 5% TO MAXIMIZE ACCESSIBILITY WITHIN THE BUILDING.
10. NO PRIVATE ENCROACHMENTS INTO PUBLIC RIGHT-OF-WAY SHALL BE ALLOWED EXCEPT AS FOLLOWS: 0' - 10' HEIGHT, NONE; 10' - 20' HEIGHT, ONE FOOT; 20' PLUS, EIGHT FEET UNLESS SPECIFICALLY PRE-APPROVED. THIS INCLUDES ALL WINDOWS, DOORS, HANDRAILS, BALCONIES, LIGHTS, GUTTERS ETC.

**RECORD DRAWING**

- LEGEND:**
- TP - TOP OF FINISHED PAVEMENT; (CONCRETE OR BRICK)
  - TC - TOP OF CURB
  - TW - TOP OF WALL
  - BW - BOTTOM OF WALL
  - FF - FINISH FLOOR
  - EP - EDGE OF PAVEMENT
  - 3A-2 BORE HOLE LOCATIONS

**BENCHMARKS:**

BM#5  
"I" CUT ON 8" INLET ON NORTH CURB LINE OF GOODMAN AVE. 175' EAST OF PASCHAL PLACE. ELEV. 629.98

BM#6  
"I" CUT AT C/E OF 8" INLET AT THE SOUTHWEST CORNER OF MORRIS AVE. AND WITT PLACE. ELEV. 627.29

BM#7  
"I" CUT AT WEST CORNER OF ADDISON THEATRE CENTRE PARKING LOT, SECOND ENTRANCE NORTH OF ADDISON RD. ELEV. 637.66

THE SEAL APPEARING ON THIS DOCUMENT WAS AUTHORIZED BY DAVID E. MEYERS, P.E. 81512

DATE	DESCRIPTION	REF. NO.
10/13/99	GRADE REVISED PER TDLR REVIEW	▲
7/23/99	REVISED GARAGE GRADES	▲
6/23/99	ISSUED FOR CONSTRUCTION	N/A
5/17/99	ISSUED FOR BID	N/A

**BLDG. "3B" SIDEWALK & FIRE LANE GRADING PLAN**

**ADDISON CIRCLE**  
PHASE II-B PUBLIC INFRASTRUCTURE  
TOWN OF ADDISON, TEXAS

HUIH - Zollars, Inc.  
3131 McKinney Ave., Suite 600, Dallas, TX 75204  
Phone: (214) 871-3311 / Fax: (214) 871-0757

DESIGN	DRAWN	APPR.	SCALE	DATE	PROJECT NO.	NO.
HZI	HZI	DEM	H: 1"=20'	MAR, 99	01-1822-50	GR2

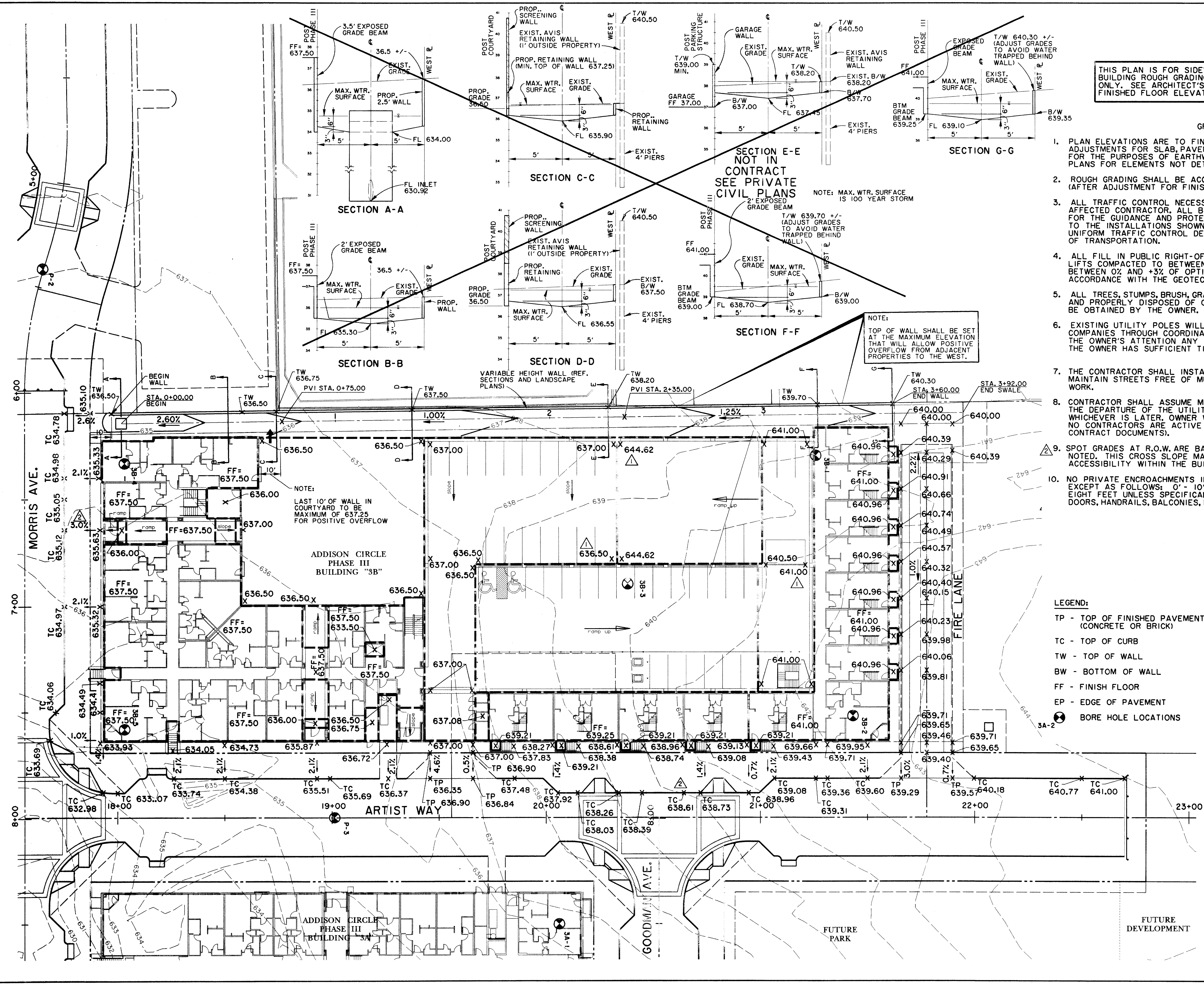

PROJECT: 01182250\dwg\AUC3GR02.DWG, 1:82  
 PLOT DATE: 03/13/2000  
 PLOT TIME: 10:00:00 AM  
 PLOT USER: DAVID E. MEYERS  
 PLOT DEVICE: HP-GL/2  
 PLOT SCALE: 1"=20'  
 PLOT SHEET: 1 OF 1  
 PLOT STATUS: OK  
 PLOT MESSAGE: