

RECORD DRAWING

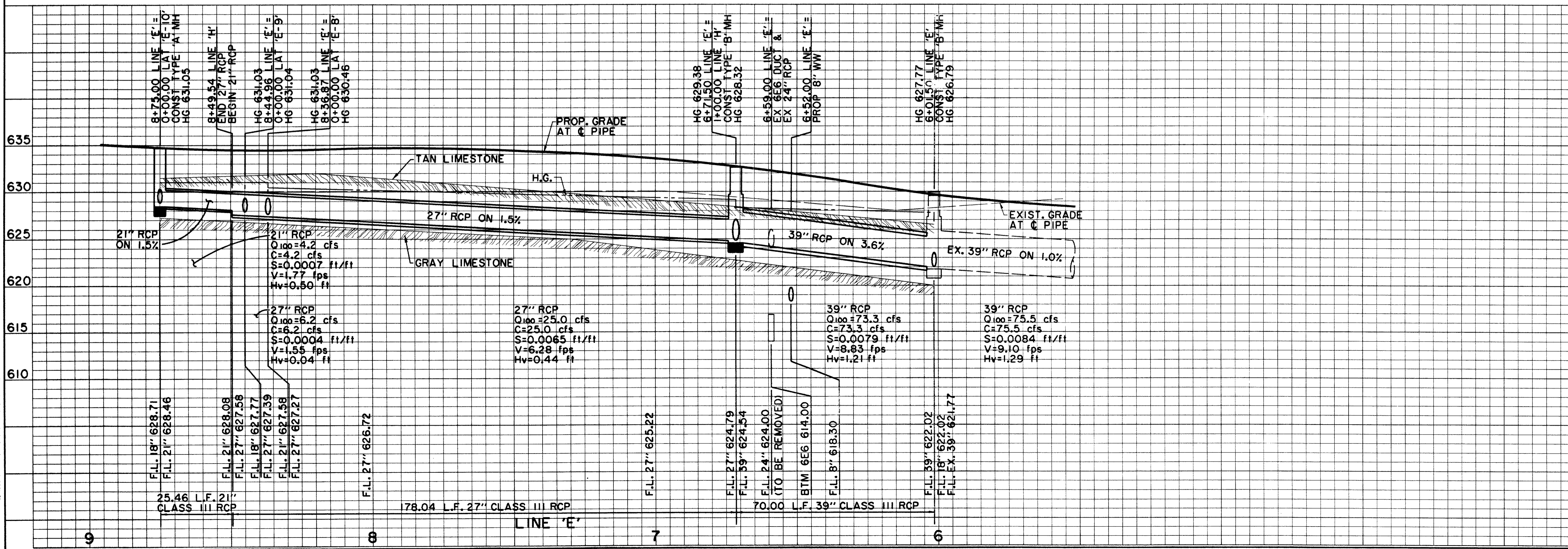
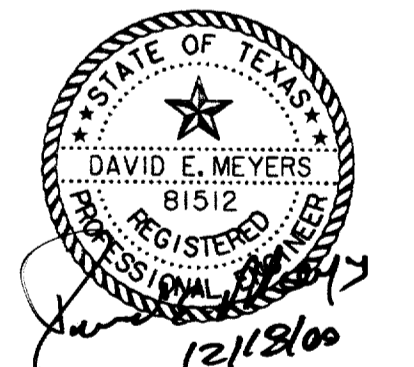

BENCHMARKS:						
635	BM#5 "I" CUT ON 8" INLET ON NORTH CURB LINE OF GOODMAN AVE. ±75' EAST OF PASCHAL PLACE. ELEV. 629.98	THE SEAL APPEARING ON THIS DOCUMENT WAS AUTHORIZED BY DAVID E. MEYERS, P.E. 81512  (2/12/00)				
630	BM#6 "I" CUT AT @ OF 8" INLET AT THE SOUTHWEST CORNER OF MORRIS AVE. AND WITT PLACE. ELEV. 627.29					
630	BM#7 "I" CUT AT WEST CORNER OF ADDISON THEATRE CENTRE PARKING LOT, SECOND ENTRANCE NORTH OF ADDISON RD. ELEV. 637.66					
DATE	DESCRIPTION	REF. NO.				
625						
620						
615						
610	6/23/99 ISSUED FOR CONSTRUCTION	N/A				
	5/17/99 ISSUED FOR BID	N/A				
STORM WATER PLAN & PROFILE LINE 'E' STA. 6+01.50 TO STA. 8+75.00						
ADDISON CIRCLE PHASE II-B PUBLIC INFRASTRUCTURE TOWN OF ADDISON, TEXAS						
Hult - Zottlers, Inc. 3131 McKinney Ave., Suite 600, Dallas, TX 75204 Phone (214) 871-3311/Fax (214) 871-0757						
DESIGN	DRAWN	APPR.	SCALE	DATE	PROJECT NO.	NO.
HZI	HZI	DEM	H: 1"=20' V: 1"=6'	MAR. 99	01-1822-50	SW5

P:\PROJECTS\182250\DWG\AUC30601.DWG
 Plot Date: 18/03/2000
 \\S02HALLS01\share\plottings\AUC30601.DWG
 HZI: hz1, inc.