

LEGEND

- 620 --- Existing Contour
- 620.0 • Existing Spot Elevation
- 20 --- Proposed Contour
- 20.0 • Proposed Spot Elevation
- Flow Arrow
- Existing Curb
- Proposed Curb
- XXXXXXXXXX Existing Storm Sewer Line
- ===== Proposed Storm Sewer Line
- Existing Water Line
- Proposed Water Line
- Existing Sanitary Sewer Line
- Proposed Sanitary Sewer Line
- Valley Gutter
- 8" CONC. PAVEMENT ON 6" LIME STABILIZED SUBGRADE

NOTE:
ALL ADA ACCESSIBLE ROUTES SHALL HAVE MAXIMUM 2% CROSS SLOPES AND MAXIMUM 5% LONGITUDINAL SLOPE.

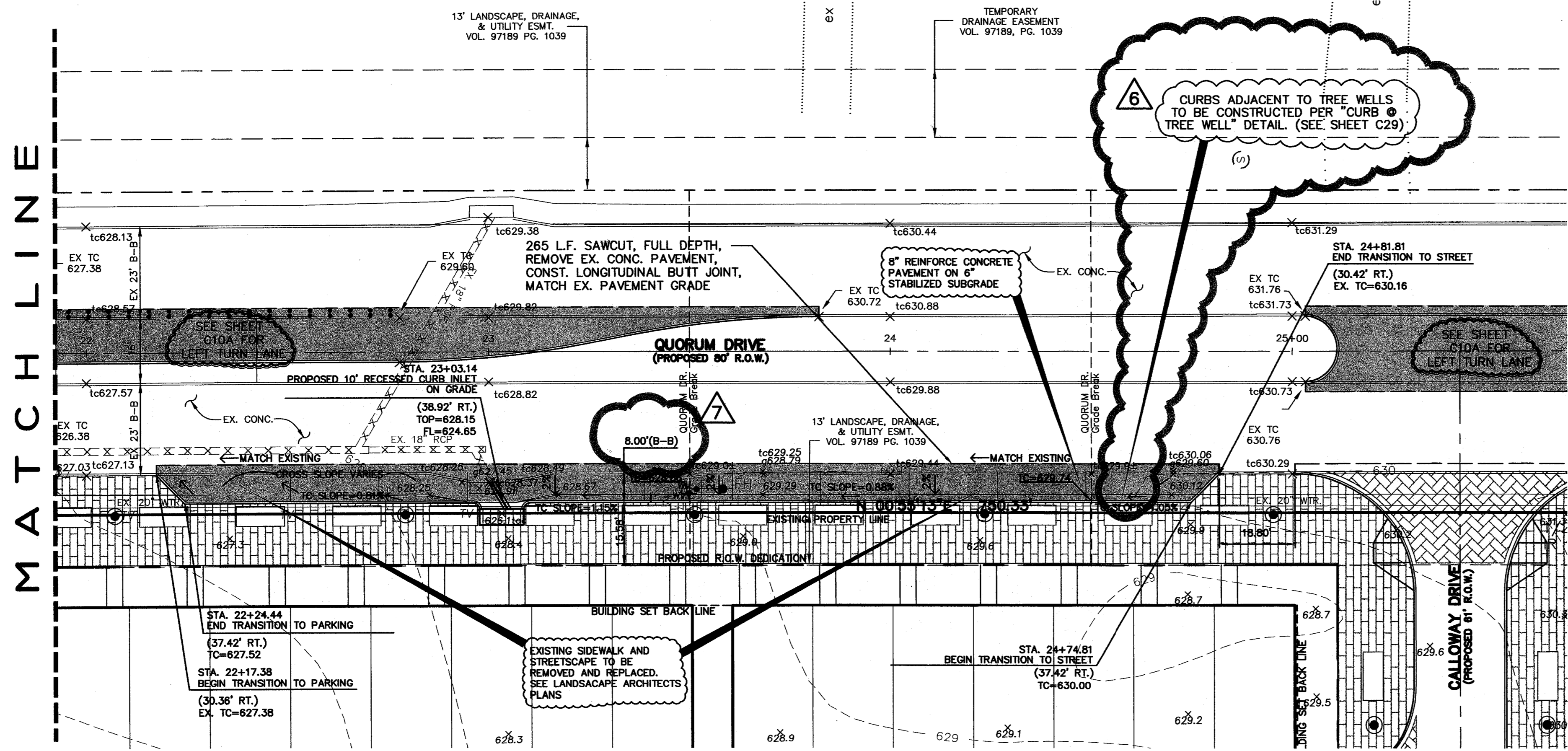

NOTE:
INSTALL BRICK PAVERS PER DETAIL ON SHEET C29.

BENCHMARK:
"D" CUT ON EAST SIDE OF 6" INLET NORTH SIDE OF MORRIS AVENUE, 200' +/- EAST OF THE CENTERLINE OF QUOROM DRIVE.
ELEVATION: 616.41

© Copyright 2003 Brockette/Davis/Drake, Inc. All Rights Reserved. This drawing is the property of Brockette/Davis/Drake, Inc. and is not to be reproduced, stored in a retrieval system, or transmitted in any form or by any means, electronic, mechanical, photocopying, recording, or by any information storage and retrieval system, without the prior written authorization of Brockette/Davis/Drake, Inc. is prohibited.

- △ WIDENED PARALLEL PARKING 11/19/04
- △ ADD CURB @ TREE WELL NOTE. 6/04/04

AS-BUILT
NOVEMBER 4, 2004

NOTE:
THESE PLANS HAVE BEEN REVISED TO CONFORM WITH CONSTRUCTION RECORDS PROVIDED BY CONTRACTOR.

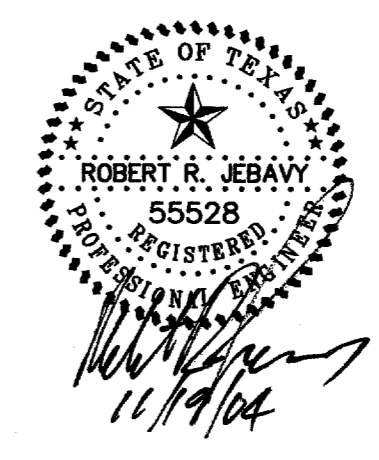

QUOROM DRIVE PARKING IMPROVEMENTS						
PARKVIEW AT ADDISON CIRCLE						
TOWN OF ADDISON, TEXAS						
DALLAS COUNTY						
BROCKETTE · DAVIS · DRAKE, inc.						
consulting engineers						
Civil & Structural Engineering-Surveying						
4144 North Central Expressway, Suite 1100, Dallas, Texas 75204						
(214) 824-3647, fax (214) 824-7064						
DESIGNED	DRAWN	DATE	SCALE	NOTES	FILE	NO.
RRJ	BDD	04/04	1"=20'	BDD	C03393	C10B