

LEGEND

---620---	Existing Contour
620.0	Existing Spot Elevation
---20---	Proposed Contour
(20.0)	Proposed Spot Elevation
→	Flow Arrow
---	Existing Curb
---	Proposed Curb
XXXXXXXXXX	Existing Storm Sewer Line
=====	Proposed Storm Sewer Line
---	Existing Water Line
---	Proposed Water Line
---	Existing Sanitary Sewer Line
---	Proposed Sanitary Sewer Line
---	Valley Gutter
■	8" CONC. PAVEMENT ON 6" LIME STABILIZED SUBGRADE

NOTE:
ALL ADA ACCESSIBLE ROUTES SHALL HAVE MAXIMUM 2% CROSS SLOPES AND MAXIMUM 5% LONGITUDINAL SLOPE.

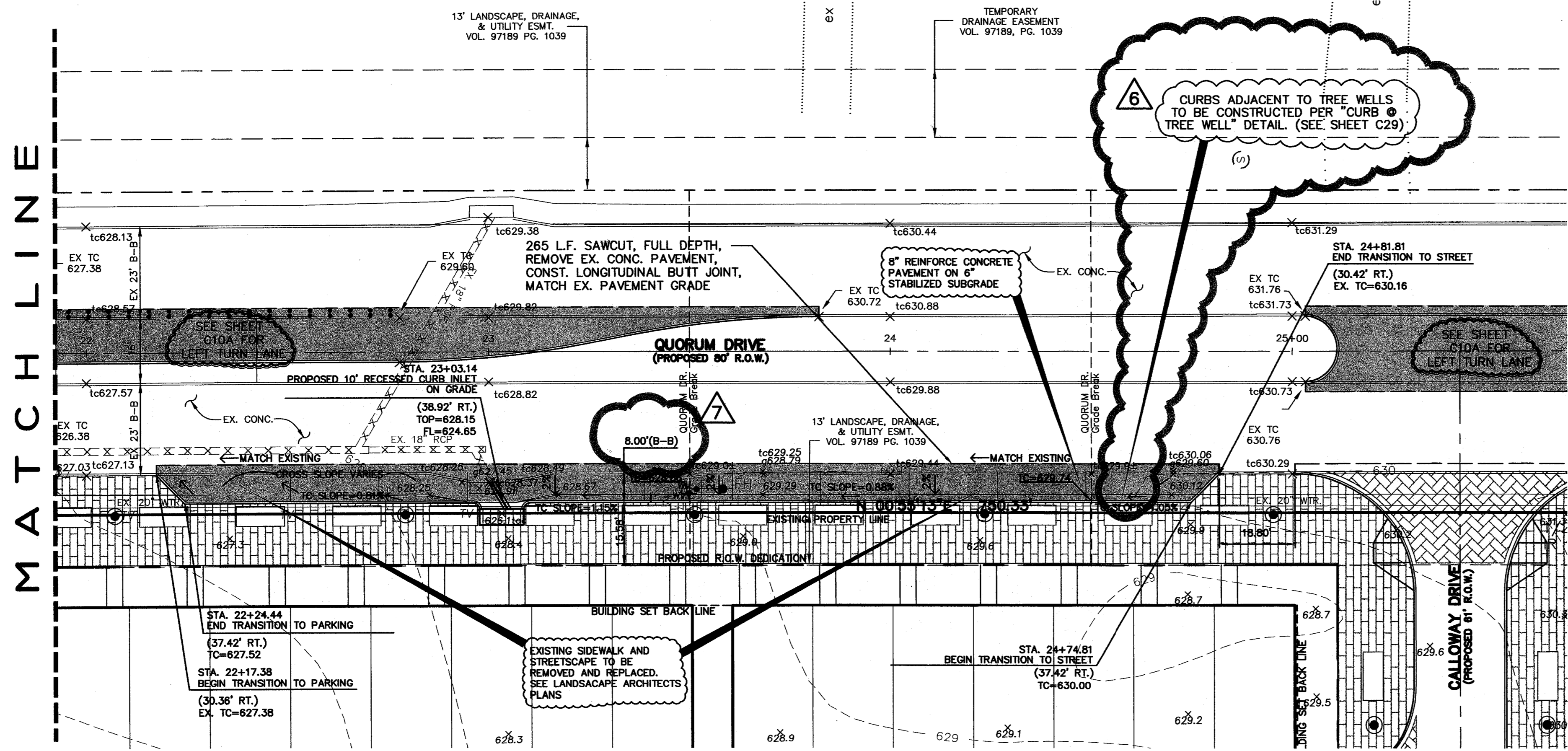

NOTE:
INSTALL BRICK PAVERS PER DETAIL ON SHEET C29.

BENCHMARK:
"D" CUT ON EAST SIDE OF 6" INLET NORTH SIDE OF MORRIS AVENUE, 200' +/- EAST OF THE CENTERLINE OF QUOROM DRIVE.
ELEVATION: 616.41

©Copyright 2003 Brockette/Davis/Drake, Inc. All Rights Reserved.
 This drawing is the property of Brockette/Davis/Drake, Inc. No part of this drawing may be reproduced or transmitted in any form or by any means, electronic, mechanical, photocopying, recording, or by any information storage and retrieval system, without the written authorization of Brockette/Davis/Drake, Inc. is prohibited.

- △ WIDENED PARALLEL PARKING 11/19/04
- △ ADD CURB @ TREE WELL NOTE. 6/04/04

AS-BUILT
NOVEMBER 4, 2004

NOTE:
THESE PLANS HAVE BEEN REVISED TO CONFORM WITH CONSTRUCTION RECORDS PROVIDED BY CONTRACTOR.

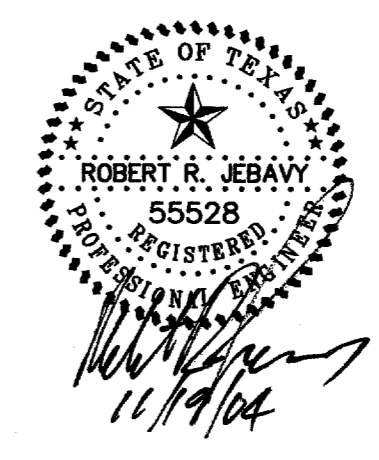

QUOROM DRIVE PARKING IMPROVEMENTS						
PARKVIEW AT ADDISON CIRCLE						
TOWN OF ADDISON, TEXAS						
DALLAS COUNTY						
BROCKETTE · DAVIS · DRAKE , inc. consulting engineers Civil & Structural Engineering-Surveying 4144 North Central Expressway, Suite 1100, Dallas, Texas 75204 (214)824-3647, fax (214) 824-7064						
DESIGNED	DRAWN	DATE	SCALE	NOTES	FILE	NO.
RRJ	BDD	04/04	1"=20'	BDD	C03393	C10B