

**CAUTION!!!**  
 CONTRACTOR SHALL VERIFY LOCATION OF UTILITIES PRIOR TO DIGGING.  
 TEXAS ONE CALL: 1-800-245-4545

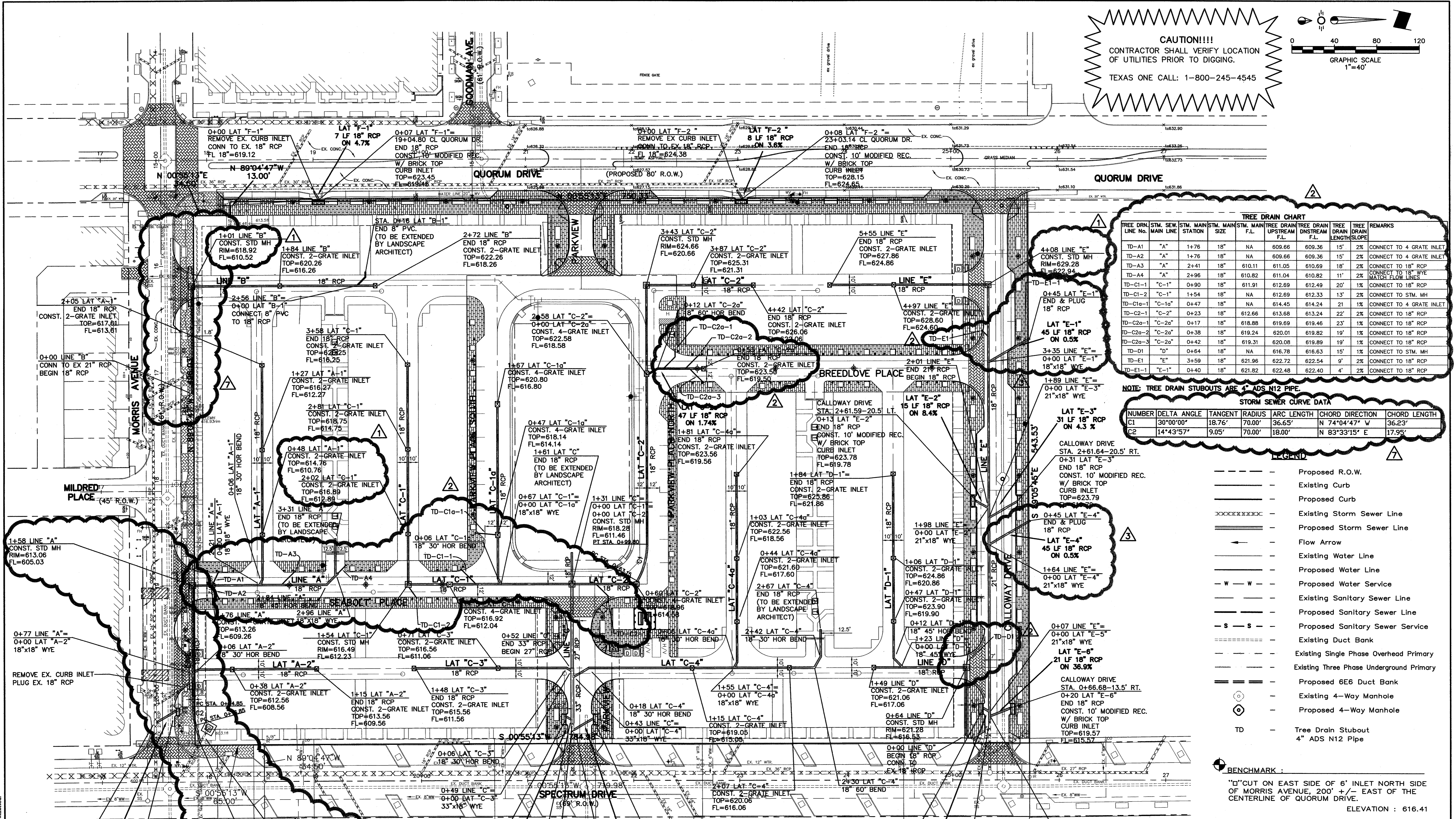

**TREE DRAIN CHART**

TREE DRAIN LINE No.	STM. MAIN LINE	STM. MAIN STATION	STM. MAIN SIZE	STM. MAIN F.L.	TREE DRAIN UPSTREAM F.L.	TREE DRAIN DRAIN LENGTH	TREE DRAIN SLOPE	REMARKS	
TD-A1	"A"	1+76	18"	NA	609.66	609.36	15'	2%	CONNECT TO 4 GRATE INLET
TD-A2	"A"	1+76	18"	NA	609.66	609.36	15'	2%	CONNECT TO 4 GRATE INLET
TD-A3	"A"	2+41	18"	610.11	611.05	610.69	18'	2%	CONNECT TO 18" RCP
TD-A4	"A"	2+96	18"	610.82	611.04	610.82	11'	2%	CONNECT TO 18" WYE
TD-C1-1	"C-1"	0+90	18"	611.91	612.69	612.49	20'	1%	CONNECT TO 18" RCP
TD-C1-2	"C-1"	1+54	18"	NA	612.69	612.33	13'	2%	CONNECT TO STM. MH
TD-C1a-1	"C-1a"	0+47	18"	NA	614.45	614.24	21'	1%	CONNECT TO 4 GRATE INLET
TD-C2-1	"C-2"	0+23	18"	612.66	613.68	613.24	22'	2%	CONNECT TO 18" RCP
TD-C2a-1	"C-2a"	0+17	18"	618.88	619.69	619.46	23'	1%	CONNECT TO 18" RCP
TD-C2a-2	"C-2a"	0+38	18"	619.24	620.01	619.82	19'	1%	CONNECT TO 18" RCP
TD-C2a-3	"C-2a"	0+42	18"	619.31	620.08	619.89	19'	1%	CONNECT TO 18" RCP
TD-D1	"D"	0+64	18"	NA	616.78	616.63	15'	1%	CONNECT TO STM. MH
TD-E1	"E"	3+59	18"	621.96	622.72	622.54	9'	2%	CONNECT TO 18" RCP
TD-E1-1	"E-1"	0+40	18"	621.82	622.48	622.40	4'	2%	CONNECT TO 18" RCP

NOTE: TREE DRAIN STUBOUTS ARE 4" ADS N12 PIPE.

**STORM SEWER CURVE DATA**

NUMBER	DELTA ANGLE	TANGENT	RADIUS	ARC LENGTH	CHORD	DIRECTION	CHORD LENGTH
C1	30°00'00"	18.76'	70.00'	36.65'	N 74°04'47" W		36.23'
C2	14°43'57"	9.05'	70.00'	18.00'	N 83°33'15" E		17.95'

- LEGEND**
- Proposed R.O.W.
  - Existing Curb
  - Proposed Curb
  - Existing Storm Sewer Line
  - ===== Proposed Storm Sewer Line
  - Flow Arrow
  - Existing Water Line
  - Proposed Water Line
  - w - w - Proposed Water Service
  - Existing Sanitary Sewer Line
  - Proposed Sanitary Sewer Line
  - s - s - Proposed Sanitary Sewer Service
  - Existing Duct Bank
  - Existing Three Phase Underground Primary
  - Proposed 6E6 Duct Bank
  - Existing 4-Way Manhole
  - Proposed 4-Way Manhole
  - TD - Tree Drain Stubout 4" ADS N12 Pipe

**BENCHMARK:**  
 "D" CUT ON EAST SIDE OF 6" INLET NORTH SIDE OF MORRIS AVENUE, 200' +/- EAST OF THE CENTERLINE OF QUORUM DRIVE.  
 ELEVATION: 616.41

**STORM SEWER PLAN**  
 PARKVIEW AT ADDISON CIRCLE  
 TOWN OF ADDISON, TEXAS  
 DALLAS COUNTY

**BROCKETTE · DAVIS · DRAKE, inc.**  
 consulting engineers  
 Civil & Structural Engineering · Surveying  
 4144 North Central Expressway, Suite 1100 Dallas, Texas 75204  
 (214)824-3647, fax (214) 824-7064

DESIGNED	DRAWN	DATE	SCALE	NOTES	FILE	NO.
RRJ	BDD	04/04	1"=40'	BDD	C03393	C12

**AS-BUILT**  
 NOVEMBER 4, 2004

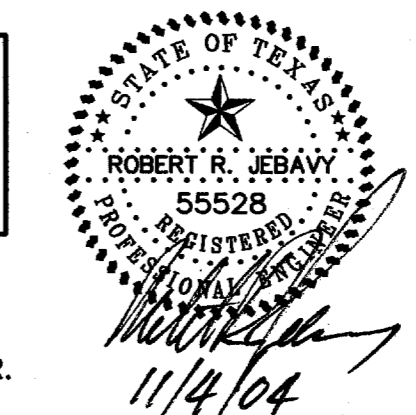

NOTE: THESE PLANS HAVE BEEN REVISED TO CONFORM WITH CONSTRUCTION RECORDS PROVIDED BY CONTRACTOR.

- ③ RELOCATED STM. LAT. E-1 & E-4 6/04/04
- ② ADD TREE DRAIN STUB OUTS 6/04/04
- ① GRADE REVISIONS 5/20/04
- ④ ADDED TELE. CONDUIT 6/23/04

© Copyright 2003 Brockette/Davis/Drake, Inc. All Rights Reserved. No part of this drawing may be reproduced, stored in a retrieval system, or used in any form without the express written authorization of Brockette/Davis/Drake, Inc. is prohibited.