

NOTE: INSTALL BRICK PAVERS PER DETAIL ON SHEET C29

NOTE: ALL DIMENSIONS ARE TO EDGE OF PAVEMENT OR BACK OF CURB UNLESS OTHERWISE NOTED.

BENCHMARK: "D" CUT ON EAST SIDE OF 6" INLET NORTH SIDE OF MORRIS AVENUE, 200' +/- EAST OF THE CENTERLINE OF QUORUM DRIVE. ELEVATION: 616.41

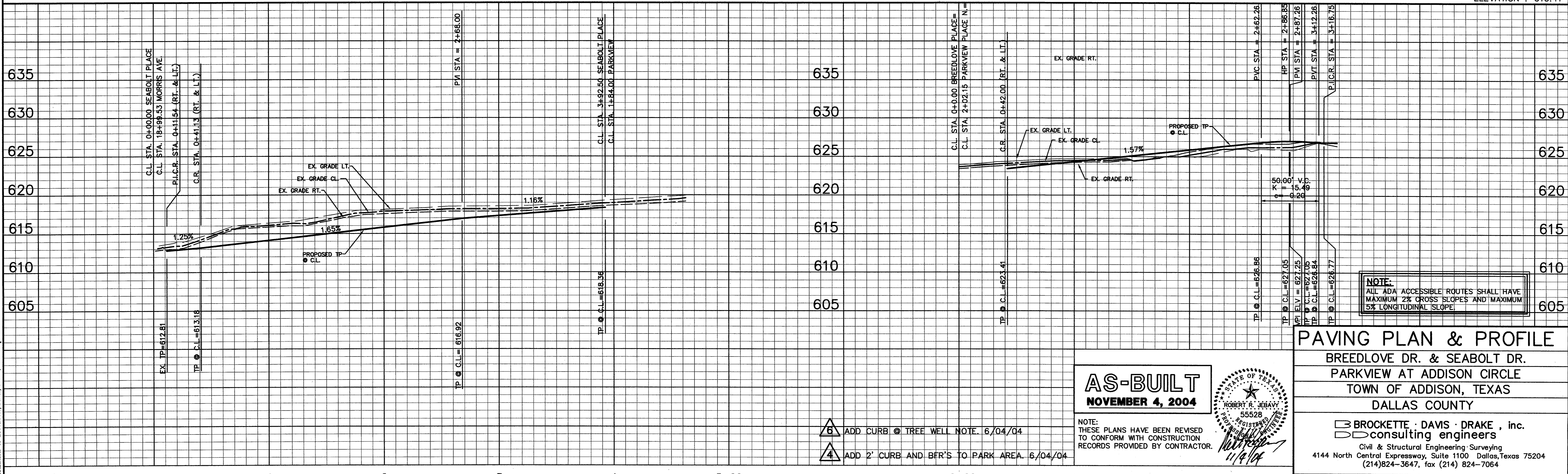

NOTE: ALL ADA ACCESSIBLE ROUTES SHALL HAVE MAXIMUM 2% CROSS SLOPES AND MAXIMUM 5% LONGITUDINAL SLOPE.

**AS-BUILT**  
NOVEMBER 4, 2004

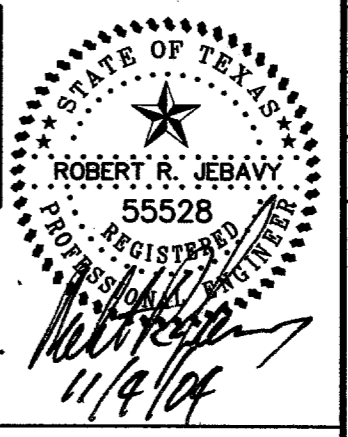

NOTE: THESE PLANS HAVE BEEN REVISED TO CONFORM WITH CONSTRUCTION RECORDS PROVIDED BY CONTRACTOR.

**PAVING PLAN & PROFILE**  
BREEDLOVE DR. & SEABOLT DR.  
PARKVIEW AT ADDISON CIRCLE  
TOWN OF ADDISON, TEXAS  
DALLAS COUNTY

**BROCKETTE · DAVIS · DRAKE, inc.**  
consulting engineers  
Civil & Structural Engineering - Surveying  
4144 North Central Expressway, Suite 1100 Dallas, Texas 75204  
(214) 824-3647, fax (214) 824-7064

DESIGNED	DRAWN	DATE	SCALE	NOTES	FILE	NO.
RRJ	BDD	04/04	H: 1"=40' V: 1"=6'	BDD	C03393	C7

© Copyright 2003 Brockette/Davis/Drake, Inc. All Rights Reserved. No part of this drawing may be reproduced, stored in a retrieval system, or used in any form without the express written authorization of Brockette/Davis/Drake, Inc. is prohibited.

C03393\PLANS CD\07-PAV1-PAV1