

PARKVIEW PLACE SOUTH
GRAPHIC SCALE 1"=40'

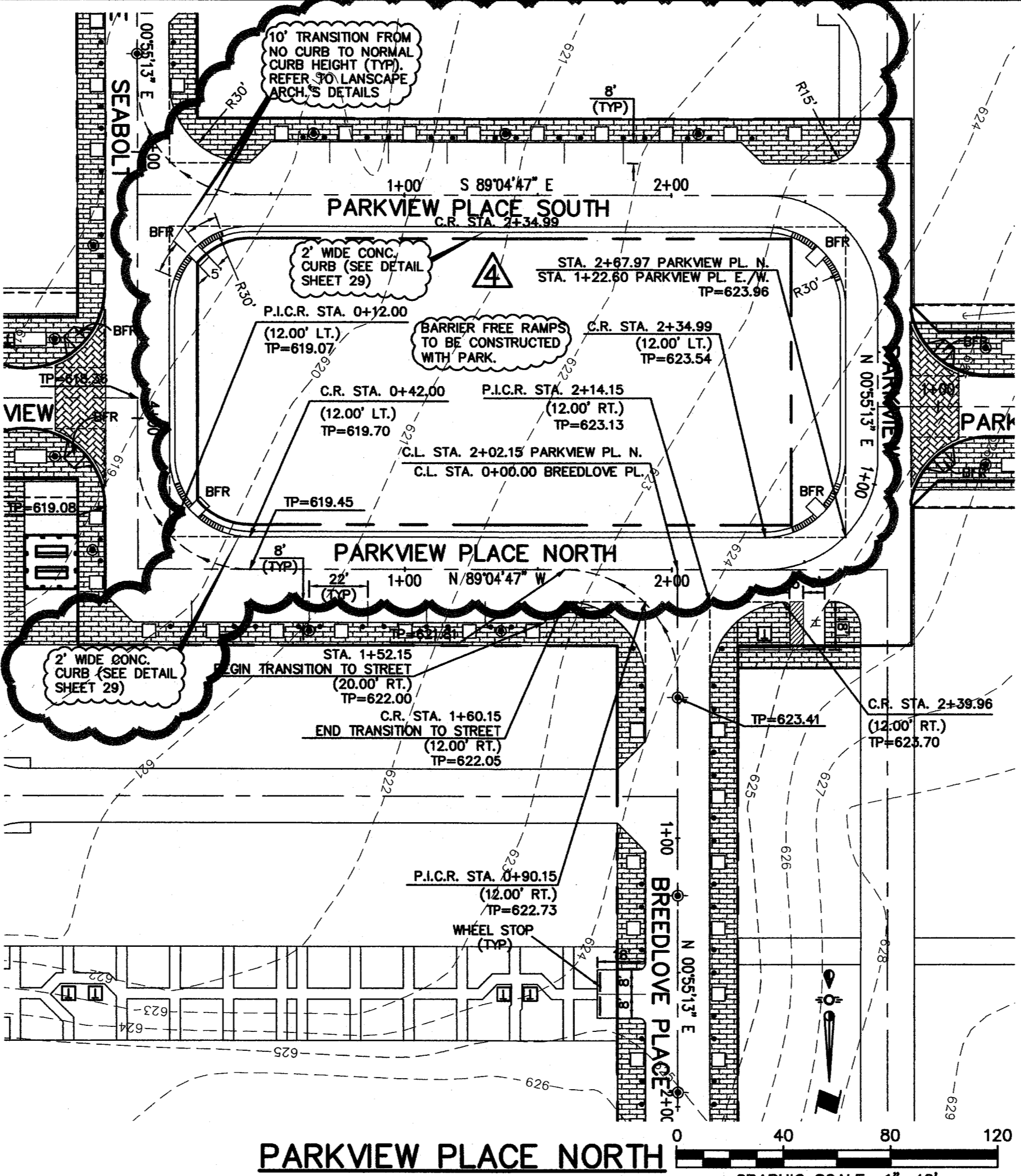

PARKVIEW PLACE NORTH
GRAPHIC SCALE 1"=40'

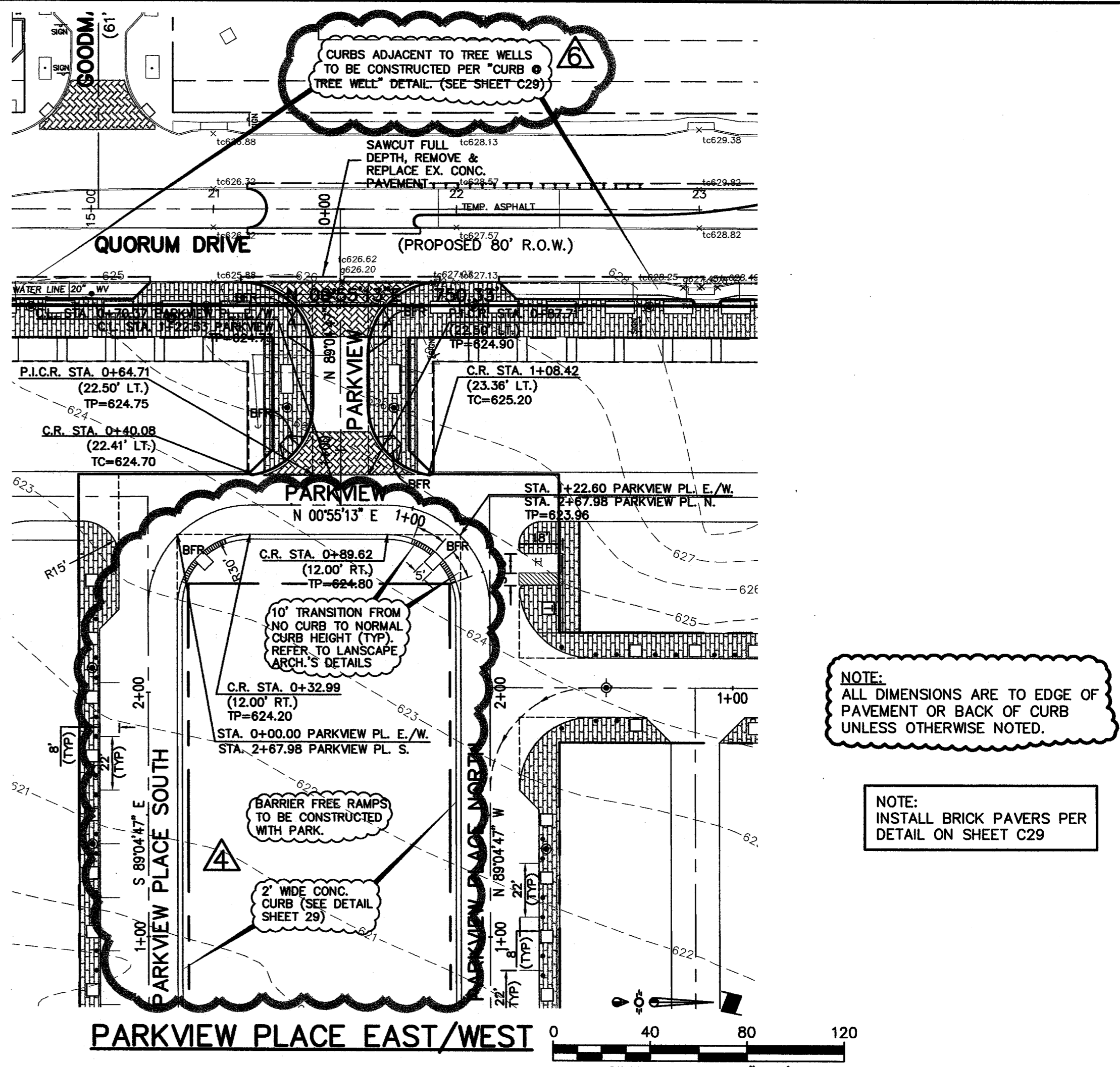

PARKVIEW PLACE EAST/WEST
GRAPHIC SCALE 1"=40'

NOTE:
ALL DIMENSIONS ARE TO EDGE OF PAVEMENT OR BACK OF CURB UNLESS OTHERWISE NOTED.

NOTE:
INSTALL BRICK PAVERS PER DETAIL ON SHEET C29

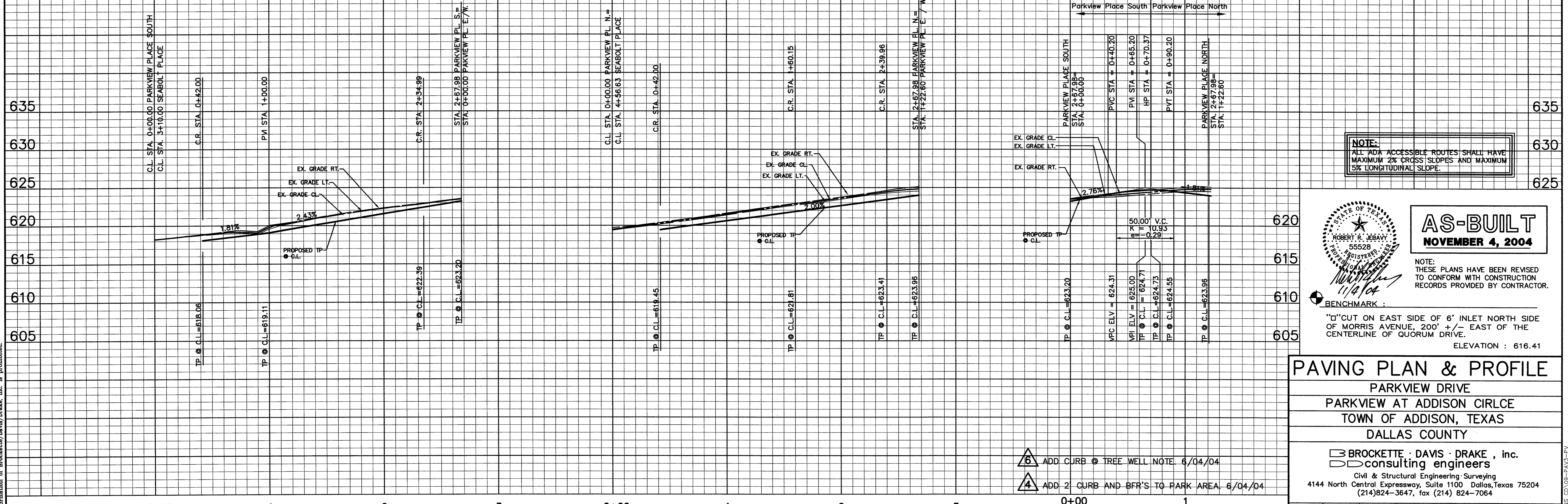

NOTE:
ALL ADA ACCESSIBLE ROUTES SHALL HAVE MAXIMUM 2% CROSS SLOPES AND MAXIMUM 5% LONGITUDINAL SLOPE.

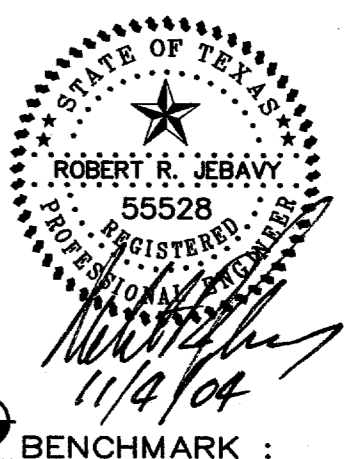

AS-BUILT
NOVEMBER 4, 2004

NOTE:
THESE PLANS HAVE BEEN REVISED TO CONFORM WITH CONSTRUCTION RECORDS PROVIDED BY CONTRACTOR.

BENCHMARK:
"D" CUT ON EAST SIDE OF 6" INLET NORTH SIDE OF MORRIS AVENUE, 200' +/- EAST OF THE CENTERLINE OF QUORUM DRIVE.
ELEVATION: 616.41

PAVING PLAN & PROFILE
PARKVIEW DRIVE
PARKVIEW AT ADDISON CIRCLE
TOWN OF ADDISON, TEXAS
DALLAS COUNTY

BROCKETTE · DAVIS · DRAKE, inc.
consulting engineers
Civil & Structural Engineering - Surveying
4144 North Central Expressway, Suite 1100 Dallas, Texas 75204
(214)824-3647, fax (214) 824-7064

- ⚠ ADD CURB @ TREE WELL NOTE 6/04/04
- ⚠ ADD 2 CURB AND BFR'S TO PARK AREA 6/04/04

DESIGNED	DRAWN	DATE	SCALE	NOTES	FILE	NO.
RRJ	BDD	04/04	H: 1"=40' V: 1"=6'	BDD	C03393	C9