

ADDISON CIRCLE OFFICE BUILDING

ADDISON TEXAS

15601 Dallas Hwy

PROGRESS DATA TRACK, Inc.
CONSULTING ENGINEER
3001 & Memorial, Suite 1000, Dallas, Texas 75225
214-343-1234

CHAMPION TOWERS RECORD SET
Drainage, WA, SAN-STB. (3)

HUITT-ZOLLARS, INC.
3131 McKinney Ave., Suite 600
Dallas, TX 75204 214-871-3311

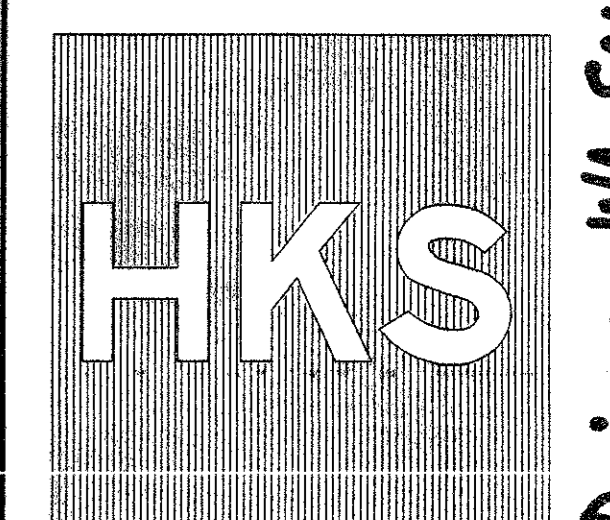

HKS Inc., Architects-Engineers-Planners
700 N. Pearl, Suite 1100, LB 307
Dallas, Texas 75201-7485 (214) 949-5999

Job No: 5494
ISSUED FOR CONSTRUCTION

15 OCT. 1997

RECORD DRAWING
12/4/98
SHIFTED INLET
LOCATION 1/16/98

Revisions:
Date:
Sheet Title:
DRAINAGE PLAN
Sheet No: B18-12
C6

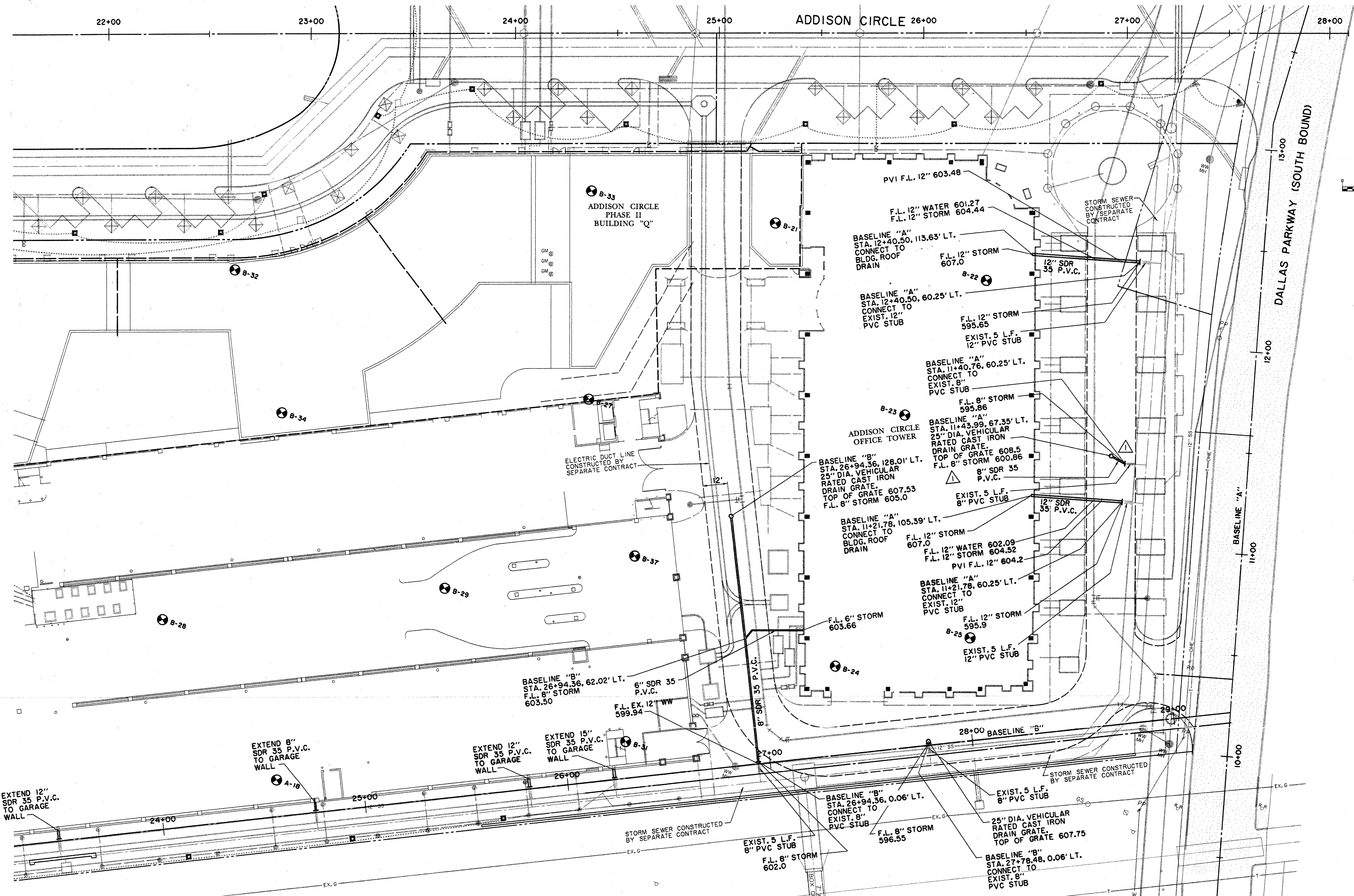
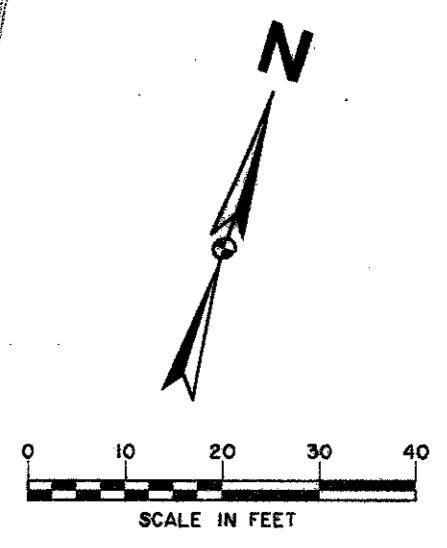

RECORD DRAWING:
THIS DRAWING HAS BEEN MODIFIED FROM THE ORIGINAL DESIGN DRAWINGS TO REFLECT THE FIELD CHANGES THAT OCCURRED DURING CONSTRUCTION WHICH WERE DOCUMENTED AND FURNISHED TO THE ENGINEER BY THE CONTRACTOR. BASED ON THIS INFORMATION AND THE ENGINEER'S OBSERVATION OF CERTAIN CONSTRUCTION ACTIVITIES, TO THE BEST OF THE ENGINEER'S KNOWLEDGE AND BELIEF, THE PROJECT IS CONSTRUCTED IN CONFORMANCE WITH THE PLANS AND SPECIFICATIONS AND WILL FUNCTION AS DESIGNED.

BENCHMARKS:
BM#5
"I" CUT AT NORTHWEST CORNER OF NORTH HDWL. OF 7'X7' BOX CULVERT UNDER RAILROAD, 150' WEST OF DALLAS PARKWAY SOUTHBOUND. ELEV. 610.49
BM#6
"I" CUT AT CENTER FRONT OF 18" REC. INLET, SECOND INLET NORTH OF RAILROAD TRACKS ON THE WEST SIDE OF DALLAS PARKWAY SOUTHBOUND. ELEV. 605.67

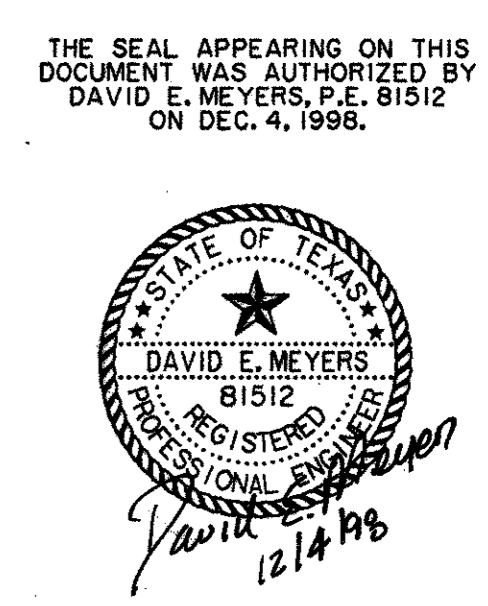

PLANNING AND DESIGN: HKS INC., ARCHITECTS-ENGINEERS-PLANNERS
700 N. PEARL, SUITE 1100, LB 307, DALLAS, TEXAS 75201-7485
(214) 949-5999
DATE: 12/4/98
BY: [Signature]

DATE: 20 JUN 97