

**Stone Cottage
Parking Lot Project**

Town of Addison

Talley Associates

Landscape Architecture
Planning
Urban Design

1925 San Jacinto, Suite 400
Dallas, Texas 75201
Tel: 214-971-7300
Fax: 214-971-7955

ZHISER / GROSSMAN STRUCTURAL LLC

Structural Engineering
1701 N. Market St. Suite #910
Dallas, Texas 75202
Tel: 469-227-9993
Fax: 469-227-3991

MEP SYSTEMS DESIGN AND ENGINEERING, INC.

918 Dragon Street
Dallas, Texas 75207
Tel: 214-915-0929
Fax: 214-915-0918

JAMES POLE LANDSCAPE IRRIGATION SPECIALIST

Landscape Irrigation Consulting, Design, Specifications
2615 Woodhaven
Denton, Texas 76201
Tel: 940-243-2264

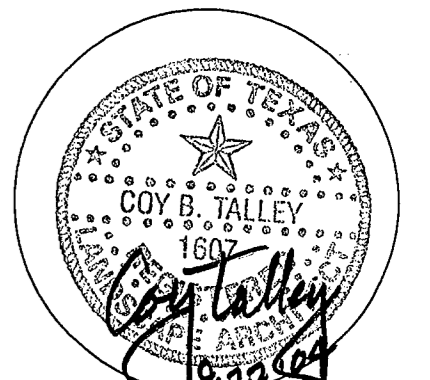

Project No: 4030

Drawn By: C/J/JP

Checked By: KB/CT

Date: SEPTEMBER 22, 2004

Revisions:

▲

▲

▲

▲

▲

▲

▲

▲

▲

▲

▲

▲

▲

▲

▲

Sheet Title:

L1.01

Sheet No.:

**LAYOUT AND
MATERIALS PLAN**

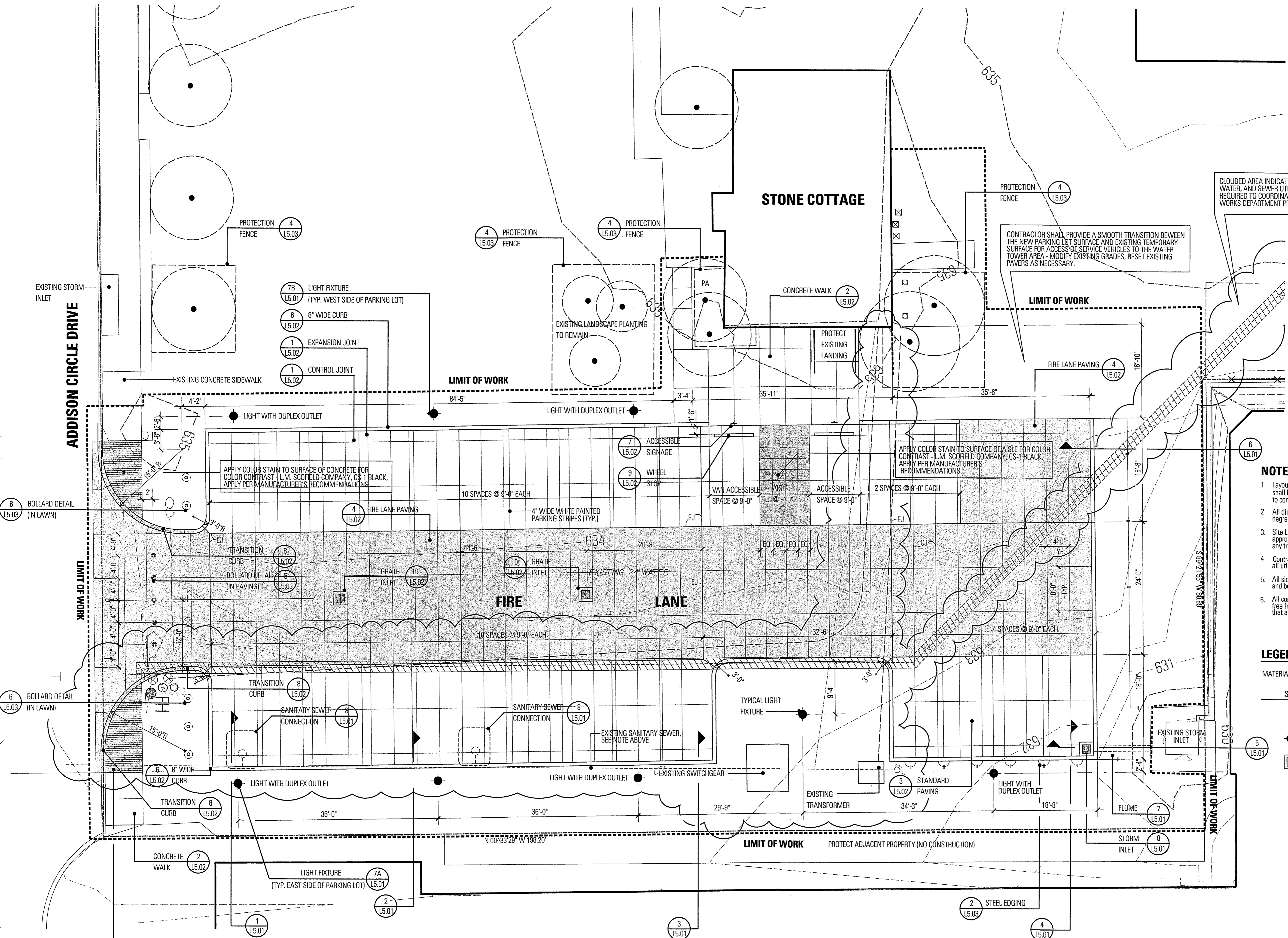

NOTES:

- Layout of parking lots, drives & sidewalks shall be by approved Landscape Architect prior to concrete pour.
- All dimension lines shall be considered 90 degrees unless otherwise noted.
- Site Lighting fixture locations are to be staked for approval by Landscape Architect prior to any trenching or concrete footings being placed.
- Contractor is to contact and locate all utilities prior to construction.
- All sidewalk curves shall have smooth transitions, and be free of tangent points.
- All concrete formwork shall be straight and free from bulges and/or changes in angle that are not shown on the drawings.

LEGEND

- MATERIAL KEY
- SPECIAL PAVEMENT
- DETAIL NUMBER
- SHEET NUMBER
- LIGHT FIXTURE - RE: #7, L5.01
- STORM INLETS - RE: #10, L5.02

