

N:\PROJECTS\2000\2000\ADDISON\ADDISON\PHASE II\PHASE II\STRIP\STRIP.DWG
 DATE: 12/16/99
 DESIGNED BY: JLM
 CHECKED BY: JLM
 APPROVED BY: JLM

STATE OF TEXAS
 ENGINEER
 DAVID E. MEYERS
 81512
 REGISTERED PROFESSIONAL ENGINEER
 1/19/90

FUTURE DEVELOPMENT
 FUTURE SPECTRUM DRIVE

MORRIS AVENUE

ADDISON CIRCLE PHASE II BUILDING "M"

TOWN OF ADDISON

FUTURE SPECTRUM DRIVE

SPECTRUM DRIVE

ADDISON CIRCLE
 TOWN OF ADDISON

ADDISON CIRCLE PHASE II BUILDING "Q"

THE ASHTON

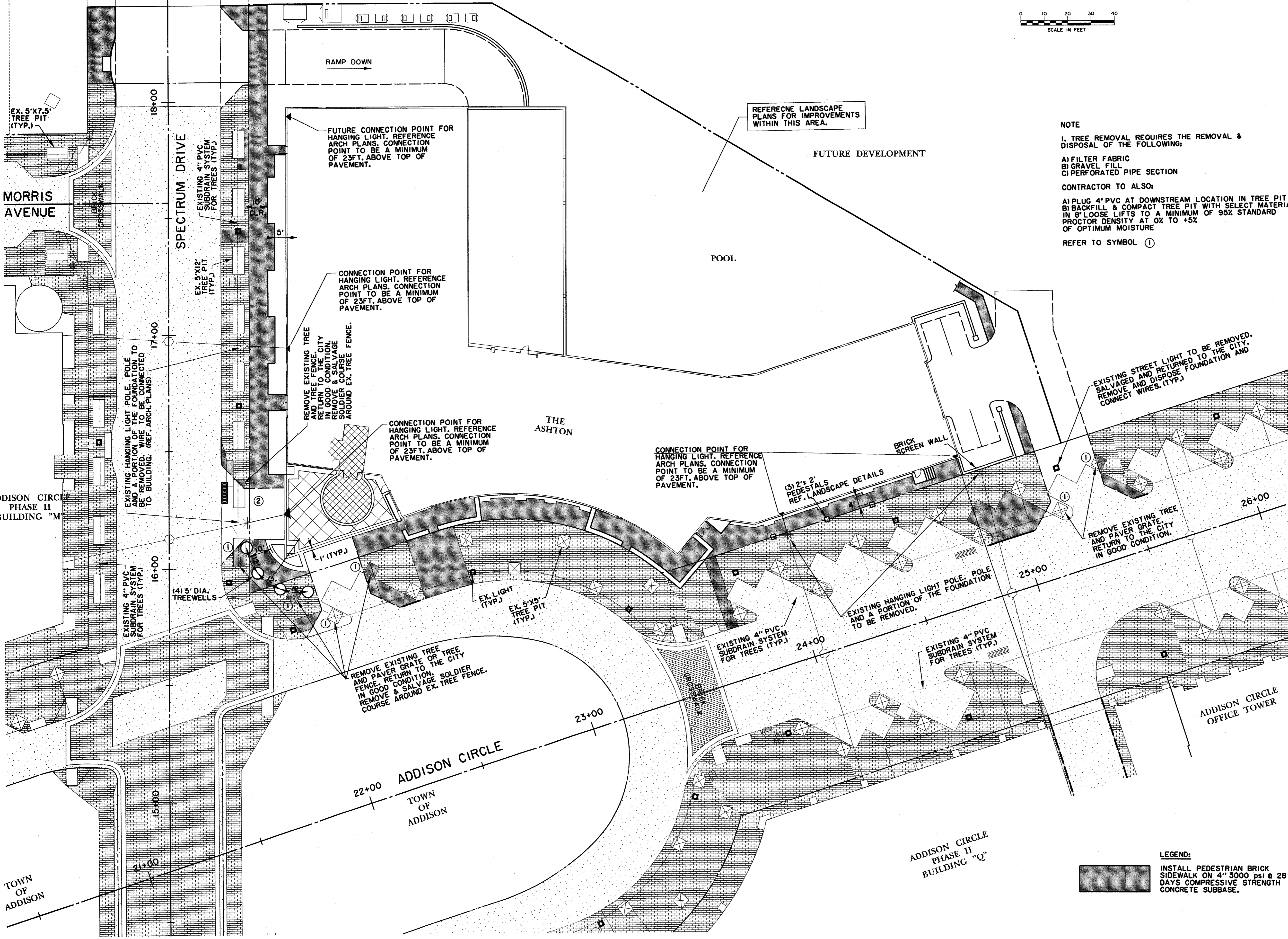
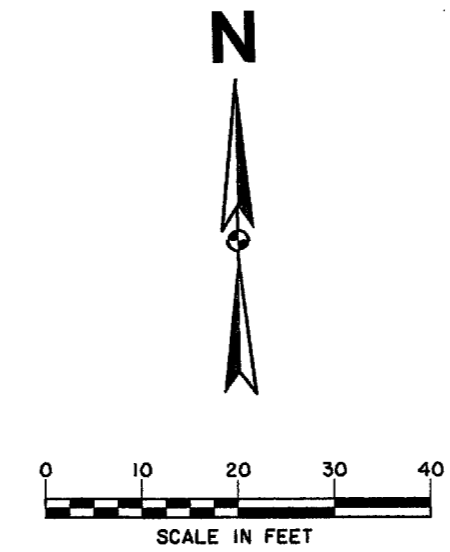

NOTE
 1. TREE REMOVAL REQUIRES THE REMOVAL & DISPOSAL OF THE FOLLOWING:
 A) FILTER FABRIC
 B) GRAVEL FILL
 C) PERFORATED PIPE SECTION
 CONTRACTOR TO ALSO:
 A) PLUG 4" PVC AT DOWNSTREAM LOCATION IN TREE PIT
 B) BACKFILL & COMPACT TREE PIT WITH SELECT MATERIAL IN 8" LOOSE LIFTS TO A MINIMUM OF 95% STANDARD PROCTOR DENSITY AT 0% TO +5% OF OPTIMUM MOISTURE
 REFER TO SYMBOL ①

NOTE
 1. TREE REMOVAL REQUIRES THE REMOVAL & DISPOSAL OF THE FOLLOWING:
 A) FILTER FABRIC
 B) GRAVEL FILL
 C) PERFORATED PIPE SECTION
 CONTRACTOR TO ALSO:
 A) REPLACE PERFORATED SECTION WITH SCH. 40 OR SDR 35 PVC NON-PERFORATED PIPE
 B) BACKFILL & COMPACT TREE PIT WITH SELECT MATERIAL IN 8" LOOSE LIFTS TO A MINIMUM OF 95% STANDARD PROCTOR DENSITY AT 0% TO +5% OF OPTIMUM MOISTURE
 REFER TO SYMBOL ②

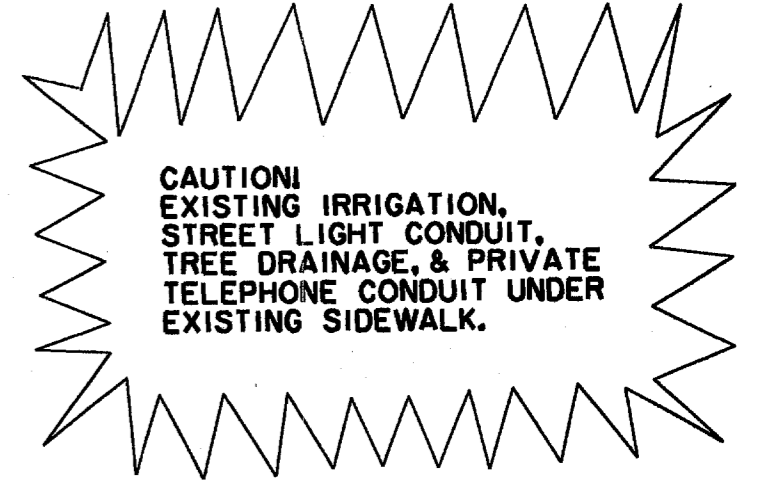

THE SEAL APPEARING ON THIS DOCUMENT WAS AUTHORIZED BY DAVID E. MEYERS, P.E. 81512

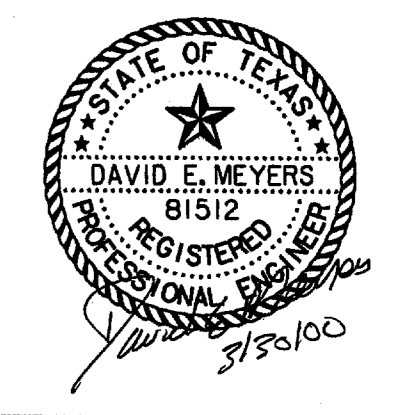

DATE	DESCRIPTION	REF. NO.
3/30/00	ISSUED FOR CONSTRUCTION	N/A
1/24/00	ISSUED FOR BID	N/A
12/16/99	CITY SUBMITTAL	N/A

STREETSCAPE PLAN

THE ASHTON PRIVATE

TOWN OF ADDISON, TEXAS

Hull - 2618ars, Inc.
 3131 McKinney Ave., Suite 600, Dallas, TX 75204
 Phone (214) 871-3311/Fax (214) 871-0757

DESIGN	DRAWN	APPR.	SCALE	DATE	PROJECT NO.	NO.
HZI	HZI	DEM	1"=20'	MAR. 00	01-2617-06	CIO

LEGEND:
 [Symbol] INSTALL PEDESTRIAN BRICK SIDEWALK ON 4" 3000 PSI @ 28 DAYS COMPRESSIVE STRENGTH CONCRETE SUBBASE.