

SECTION 02 SCALE: NONE

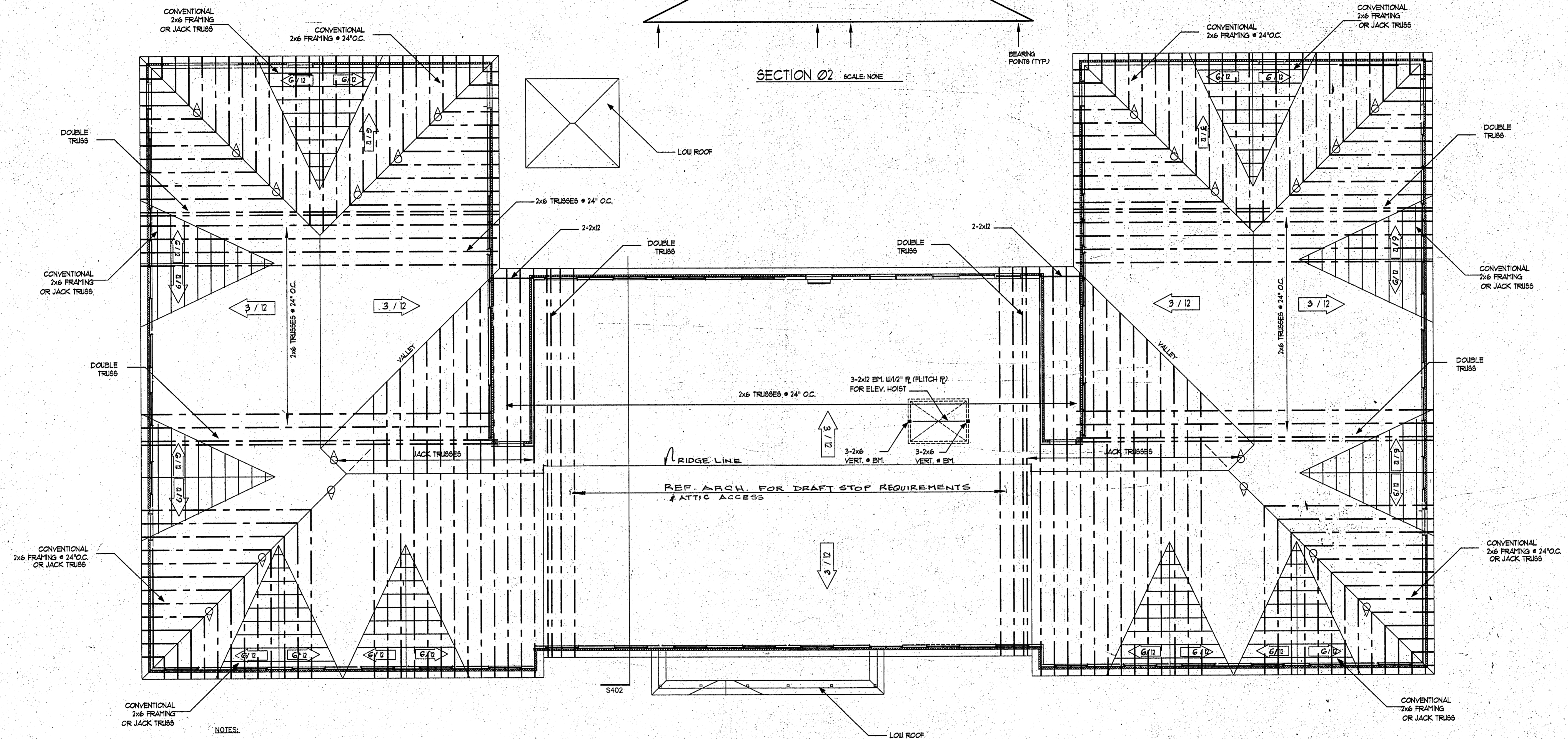

- NOTES:
1. ALL LUMBER TO BE #2 SOUTHERN PINE, 19% M.C.
  2. ALL RAFTERS TO BE 2x6'S AT 24" O.C. UNLESS OTHERWISE NOTED.
  3. ALL HIP, RIDGES, AND VALLEYS TO BE ONE MIL SIZE LARGER THAN THE RAFTERS THEY ARE SUPPORTING.
  4. PROVIDE COLLAR TIES AT 4'-0" O.C. ON ALL RIDGES.
  5. TRANSFER ALL LOAD BEARING POINTS TO FOUNDATION UNLESS OTHERWISE NOTED.
  6. BRACE HIP, RIDGES, AND VALLEYS AS SHOWN.
  7. BRACE OR PURLIN ALL RAFTERS TO LOAD BEARING WALLS OR BEAMS IF SPAN IS GREATER THAN MAX. ACCORDING TO 1994 U.B.C.
  8. ALL RAFTER SPLICES SHALL BE BRACED.
  9. PURLINS ARE TO BE SAME DEPTH OF RAFTERS THEY ARE SUPPORTING.
  10. ALL ROOFING TO BE 300# COMP. SHINGLES UNLESS NOTED OTHERWISE.
  11. SLOPE: 6:12 UNLESS NOTED OTHERWISE.
  12. REF. ARCH FOR T/O PLATE LINE ELEV.

ROOF BRACING SCHEDULE			
HT.	REQUIREMENTS	SECTION	
1 - 10 FT.	2x4 "T" BRACING		2x4
11 - 20 FT.	2x6/2x4 "T" BRACING		2x6
21 - 30 FT.	2x8/2x6 "T" BRACING		2x8

10/26/1998  
CHANGED ROOF SLOPES

9/19/98  
10/26/98

K.S. ATWAL & ASSOCIATES, INC.  
CONSULTING ENGINEERS, STRUCTURAL  
6804 E. PARKER ROAD, PARKER, TEXAS 75002  
PH (972) 442-0821 FAX (972) 442-5404

**1** ROOF FRAMING PLAN  
SCALE: 1/8" = 1'-0"  
ROOF.DWG