

PROJECT: **MAINSTAY SUITES OF ADDISON ADDITION**
BELTLINE ROAD
ADDISON, TEXAS

REVISIONS:	
DATE	REVISION
11/02/98	PUBLIC WORKS COMMENTS

SHEET TITLE
DETAIL SHEET

DATE: 09/11/98
 SCALE: 1" = 20'
 DRAWN BY: J.N.M.
 CHECKED BY: JDJR
 SHEET NO.
C6 OF 6
 JDJR FILE NO. 98-045

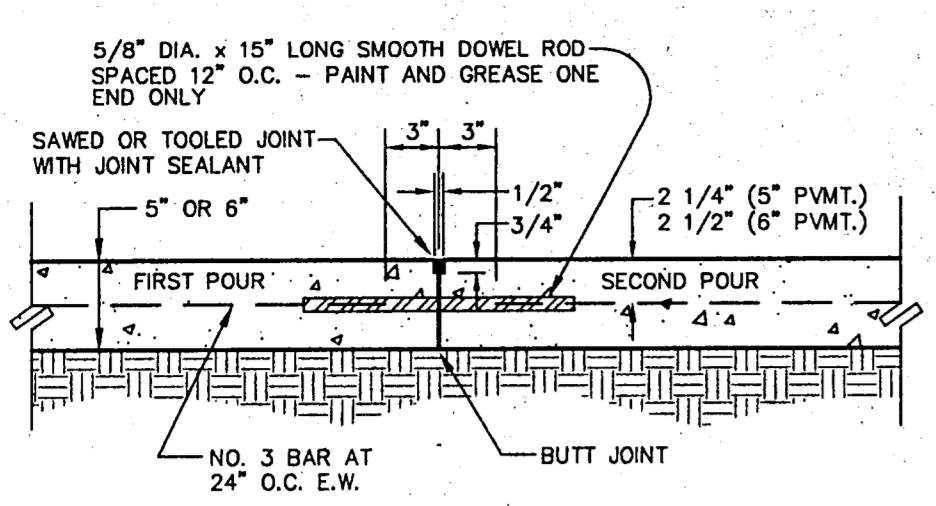

CONSTRUCTION JOINT DETAIL
 NOT TO SCALE

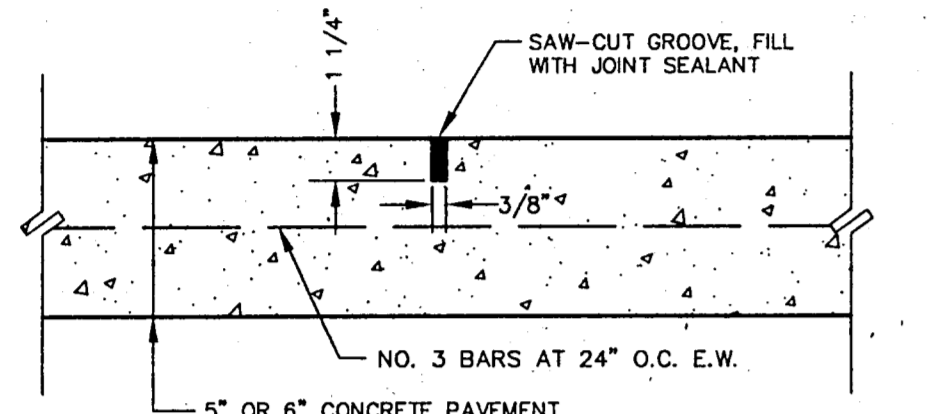

CONTRACTION JOINT DETAIL
 NOT TO SCALE

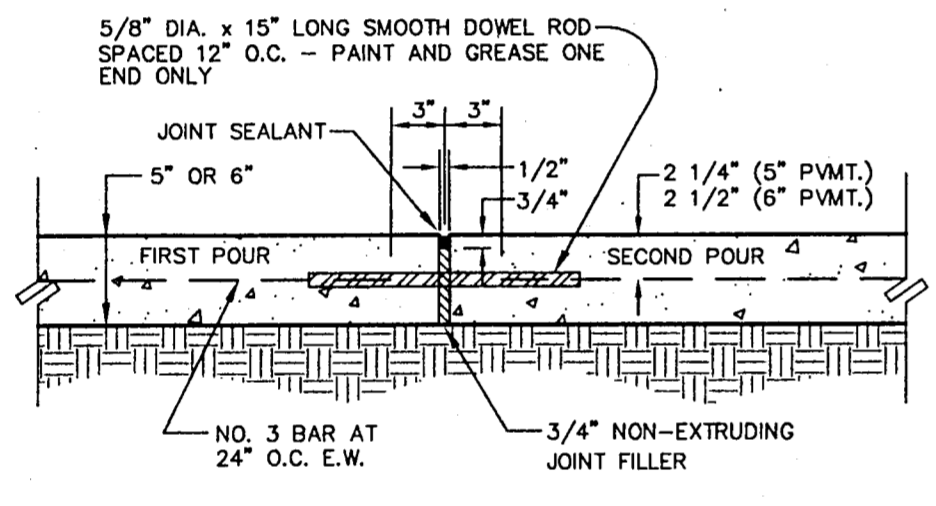

EXPANSION JOINT DETAIL
 NOT TO SCALE

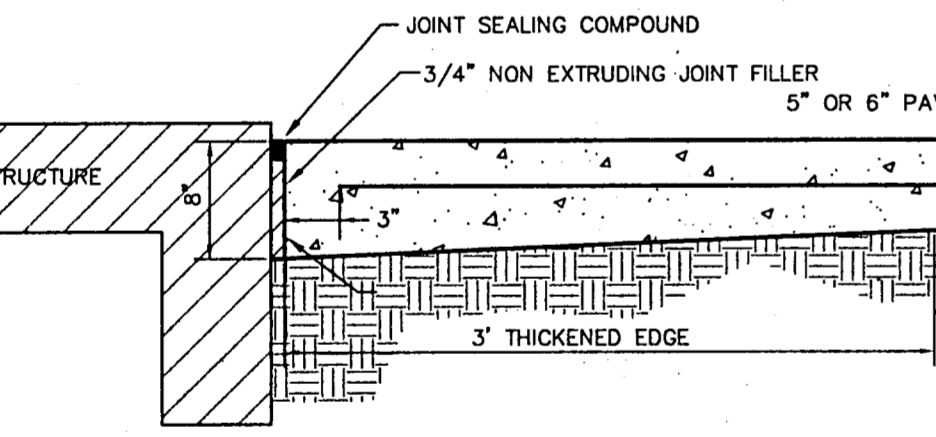

EXPANSION JOINT AT STRUCTURE DETAIL
 NOT TO SCALE

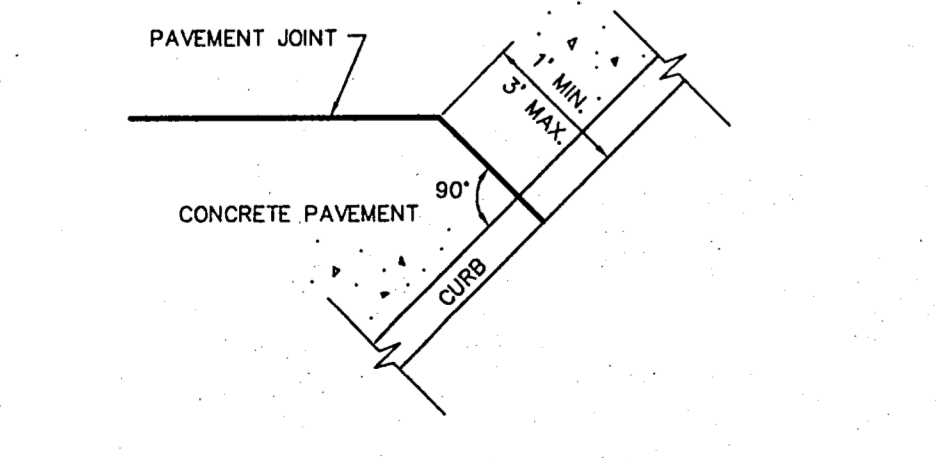

DETAIL OF PAVEMENT JOINT AT CURB
 NOT TO SCALE

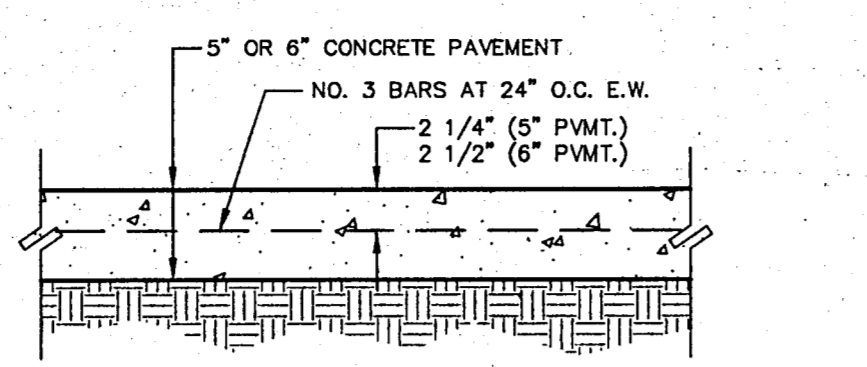

CONCRETE PAVEMENT SECTION DETAIL
 NOT TO SCALE

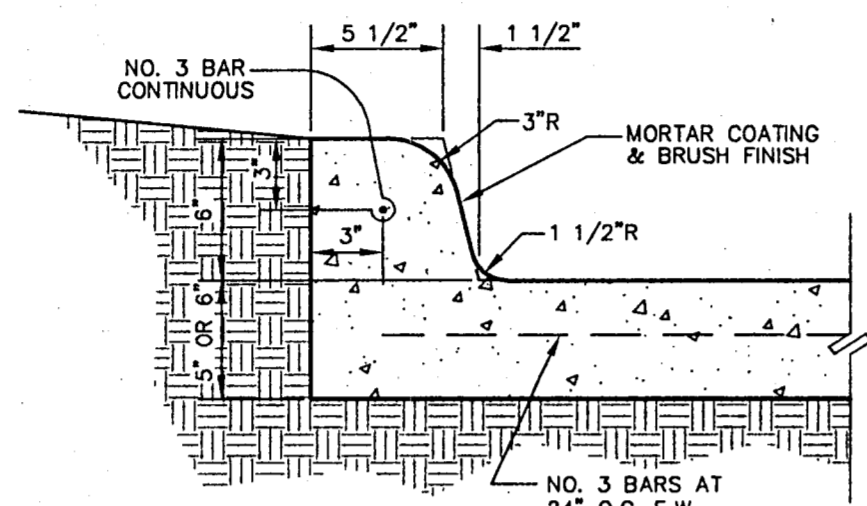

INTEGRAL CURB DETAIL
 NOT TO SCALE

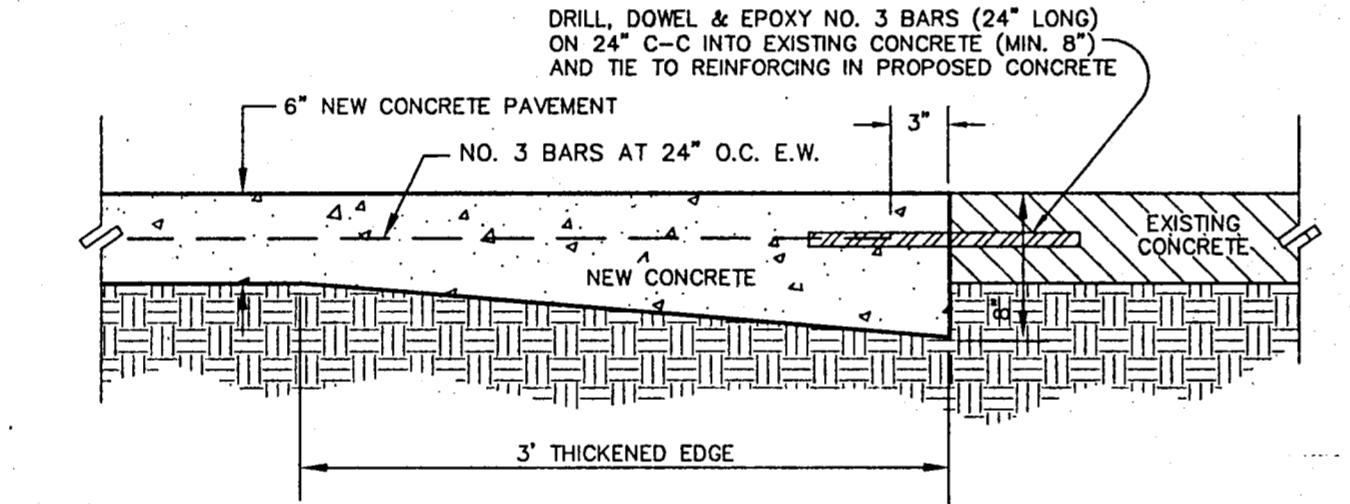

NEW CONCRETE TO EXISTING CONCRETE DETAIL
 NOT TO SCALE

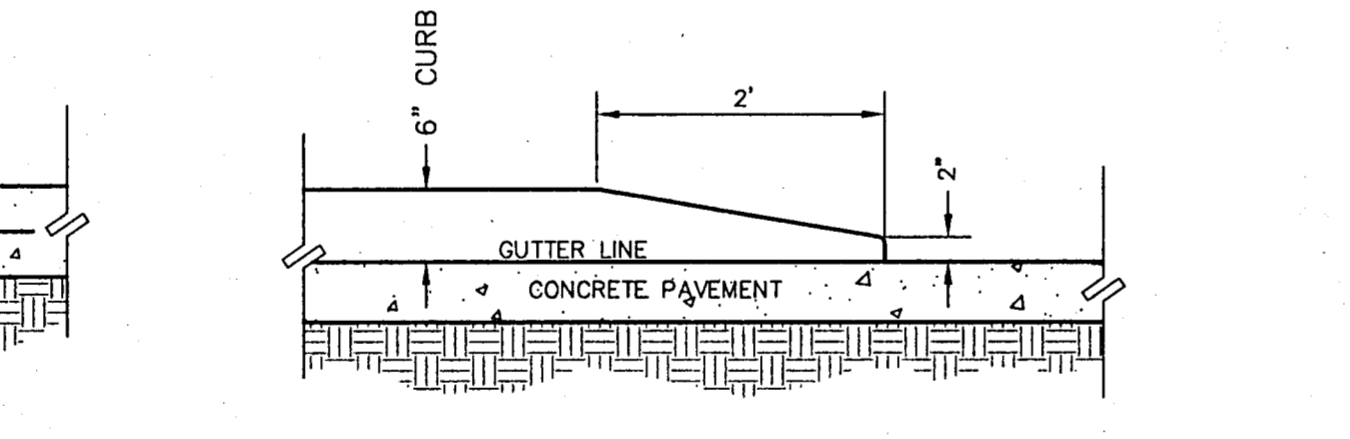

CURB TERMINAL DETAIL
 NOT TO SCALE

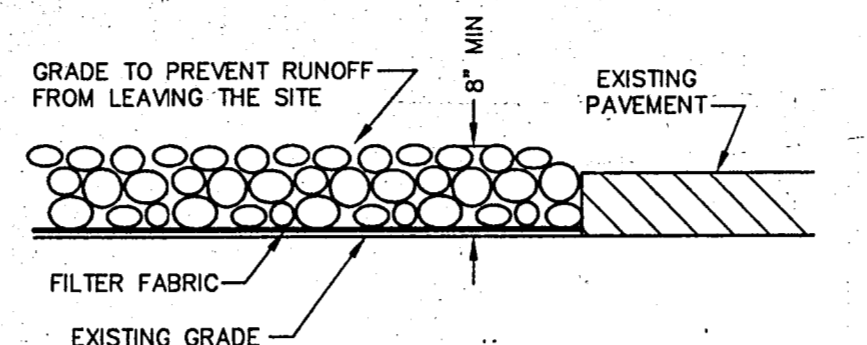

- NOTES:
- STONE SIZE - 3 TO 5 INCHES CRUSHED ROCK.
 - LENGTH - AS EFFECTIVE, BUT NOT LESS THAN 50', UNLESS DEPTH OF LOT IS LESS THAN 150' FROM THE EDGE OF PAVEMENT WHERE LENGTH MUST ONLY BE 30'.
 - THICKNESS SHALL NOT BE LESS THAN 8\".
 - WIDTH SHALL NOT BE LESS THAN FULL WIDTH OF ALL POINTS OF INGRESS OR EGRESS.
 - WASHING - WHEN NECESSARY, WHEELS SHALL BE CLEANED TO REMOVE SEDIMENT PRIOR TO ENTRANCE ONTO PUBLIC ROADWAY. WHEN WASHING IS REQUIRED, IT SHALL BE DONE ON AN AREA STABILIZED WITH CRUSHED STONE WHICH DRAINS INTO AN APPROVED TRAP OR SEDIMENT BASIN. ALL SEDIMENT SHALL BE PREVENTED FROM ENTERING ANY STORM DRAIN, DITCH OR WATERCOURSE USING APPROVED METHODS.
 - MAINTENANCE - THE ENTRANCE SHALL BE MAINTAINED IN CONDITION WHICH WILL PREVENT TRACKING OR FLOWING OF SEDIMENT ONTO PUBLIC ROADWAYS. THIS MAY REQUIRE PERIODIC TOP DRESSING WITH ADDITIONAL STONE AS CONDITIONS DEMAND, AND REPAIR AND/OR CLEANOUT OF ANY MEASURES USED TO TRAP SEDIMENT. ALL SEDIMENT SPILLED, DROPPED, WASHED OR TRACKED ONTO PUBLIC ROADWAY, MUST BE REMOVED IMMEDIATELY.
 - DRAINAGE - ENTRANCE MUST BE PROPERLY GRADED OR INCORPORATE A DRAINAGE SWALE TO PREVENT RUNOFF FROM LEAVING THE CONSTRUCTION SITE.

STABILIZED CONSTRUCTION ENTRANCE
 NOT TO SCALE

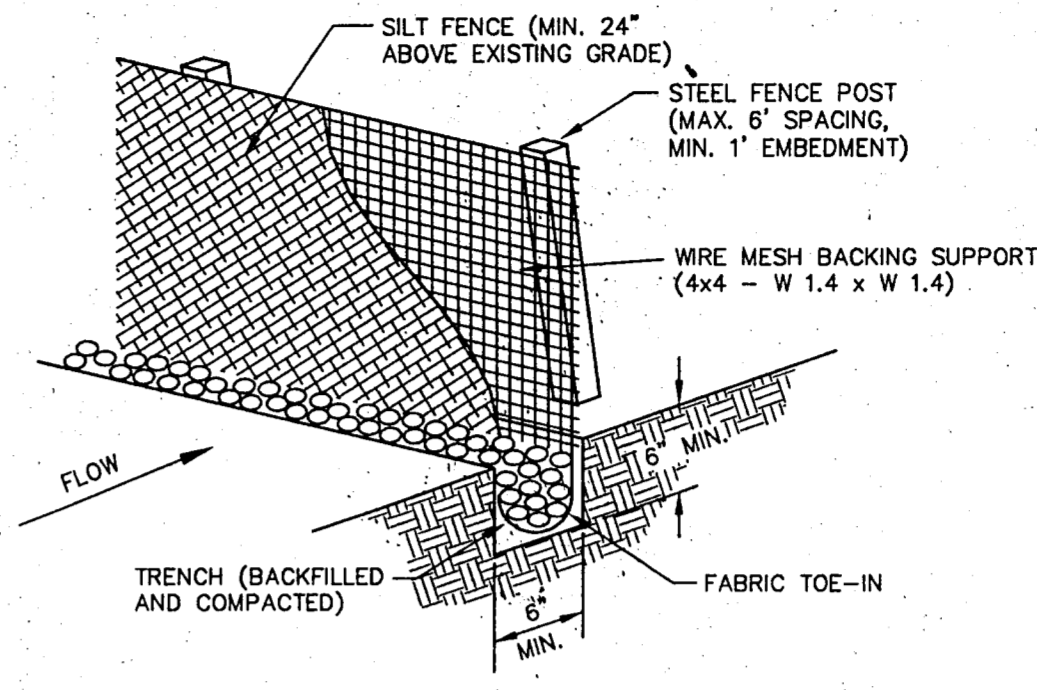

SILT FENCE DETAIL
 NOT TO SCALE

- SILT FENCE NOTES:
- STEEL POSTS WHICH SUPPORT THE SILT FENCE SHALL BE INSTALLED ON A SLIGHT ANGLE TOWARD THE ANTICIPATED RUNOFF SOURCE. POST MUST BE EMBEDDED A MINIMUM OF ONE FOOT.
 - THE TOE OF THE SILT FENCE SHALL BE TRENCHED IN WITH A SPADE OR MECHANICAL TRENCHER, SO THAT THE DOWN-SLOPE FACE OF THE TRENCH IS FLAT AND PERPENDICULAR TO THE LINE OF FLOW. WHERE TRENCH CANNOT BE TRENCHED IN (e.g. PAVEMENT), WEIGHT FABRIC FLAP WITH WASHED GRAVEL ON UPHILL SIDE TO PREVENT FLOW UNDER TRENCH.
 - THE TRENCH MUST BE A MIN. OF 6\"/>

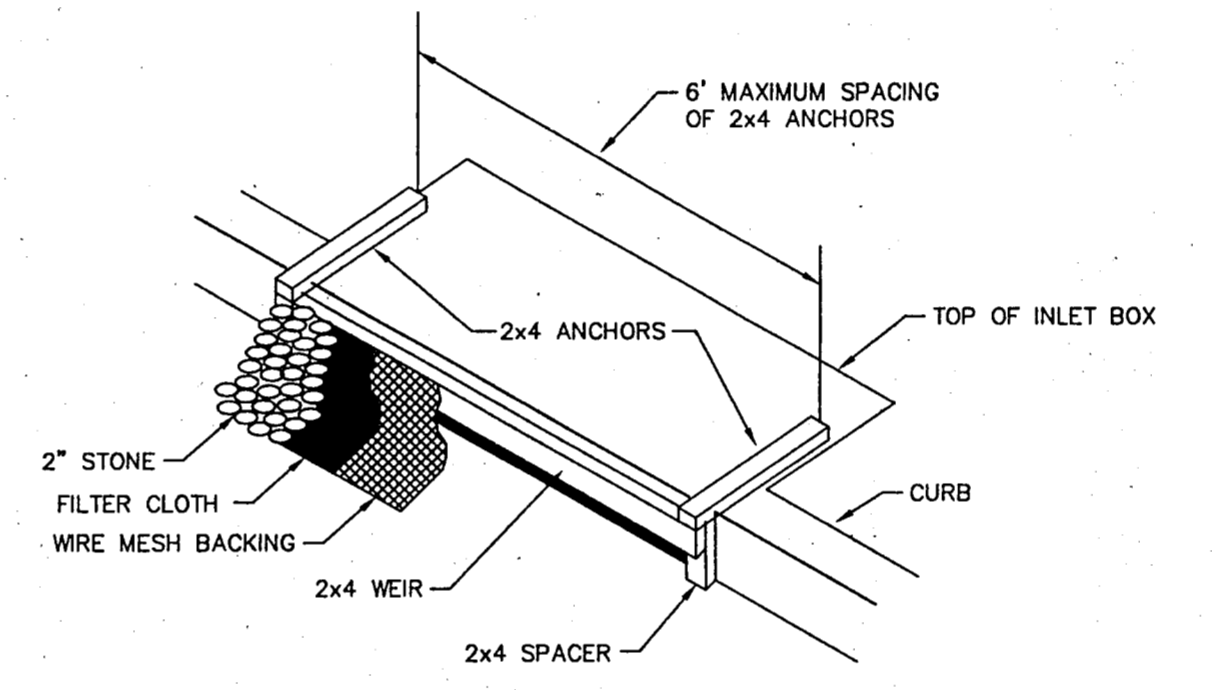

- NOTES:
- WOODEN FRAME IS TO BE CONSTRUCTED OF 2x4 CONSTRUCTION GRADE LUMBER.
 - WIRE MESH BACKING MUST BE OF SUFFICIENT STRENGTH TO SUPPORT FILTER FABRIC, AND STONE FOR CURB INLETS, WITH WATER FULLY IMPOUNDED AGAINST IT.
 - FILTER CLOTH MUST BE OF A TYPE APPROVED FOR THIS PURPOSE, RESISTANT TO SUNLIGHT WITH SIEVE SIZE, E05, 40-85, TO ALLOW SUFFICIENT PASSAGE OF WATER AND REMOVAL OF SEDIMENT.
 - STONE IS TO 2\"/>

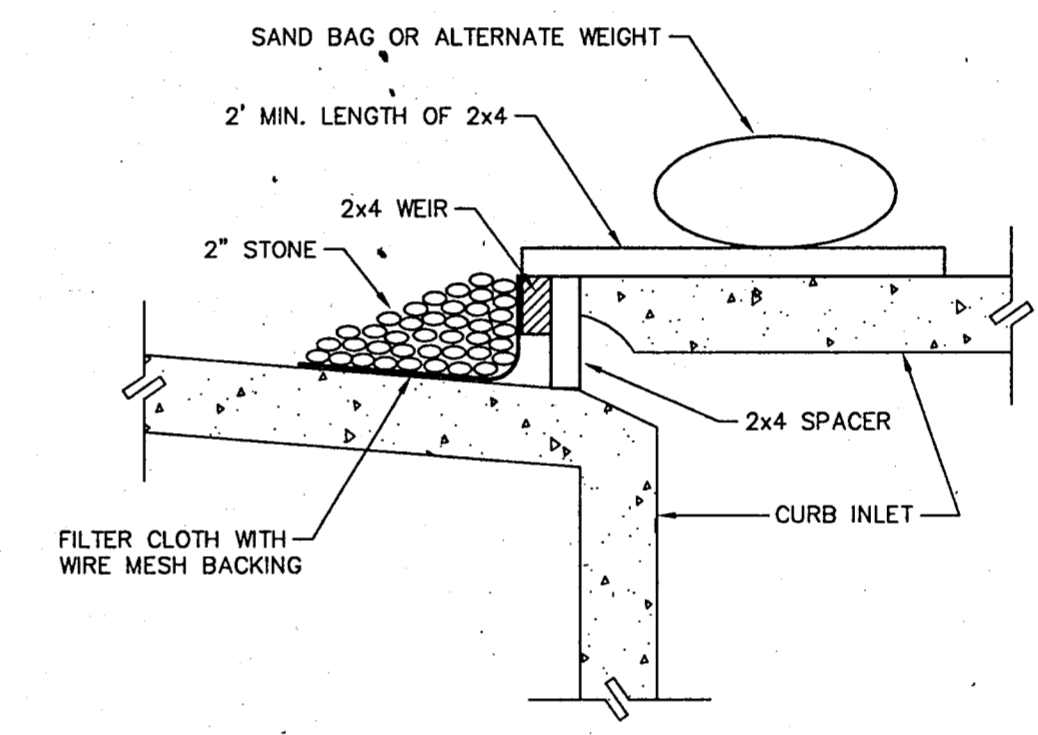

- FORM THE WIRE MESH AND FILTER CLOTH TO THE CONCRETE GUTTER AND AGAINST THE FACE OF CURB ON BOTH SIDES OF THE INLET. PLACE CLEAN STONE OVER THE FILTER CLOTH IN SUCH A MANNER AS TO PREVENT WATER FROM ENTERING THE INLET UNDER OR AROUND THE CLOTH.
- THIS TYPE OF INLET PROTECTION MUST BE INSPECTED FREQUENTLY AND THE FILTER CLOTH AND STONE REPLACED WHEN CLOGGED WITH SEDIMENT.
- ASSURE THAT STORM FLOW DOES NOT BYPASS INLET BY INSTALLING TEMPORARY EARTH OR ASPHALT DIKES DIRECTING FLOW INTO INLET.

CURB INLET PROTECTION DETAIL

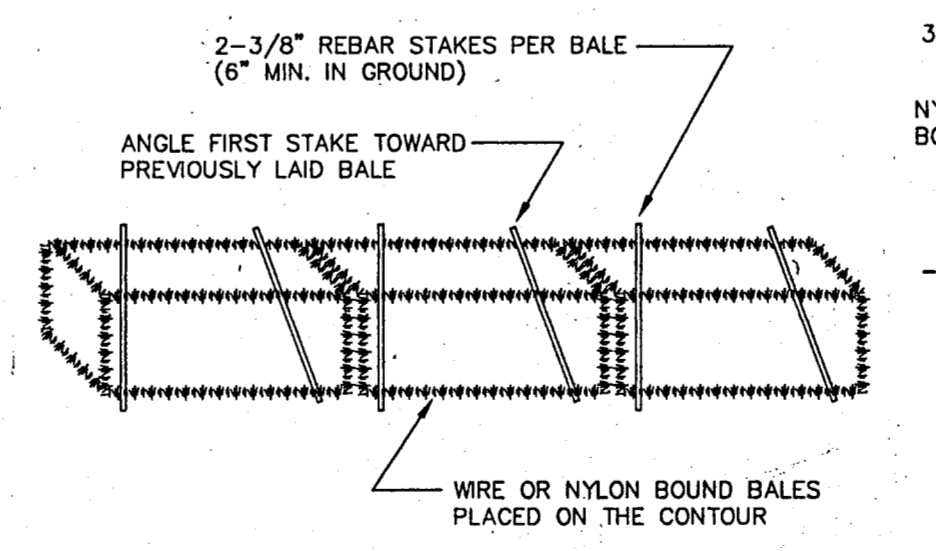

ANCHORING DETAIL

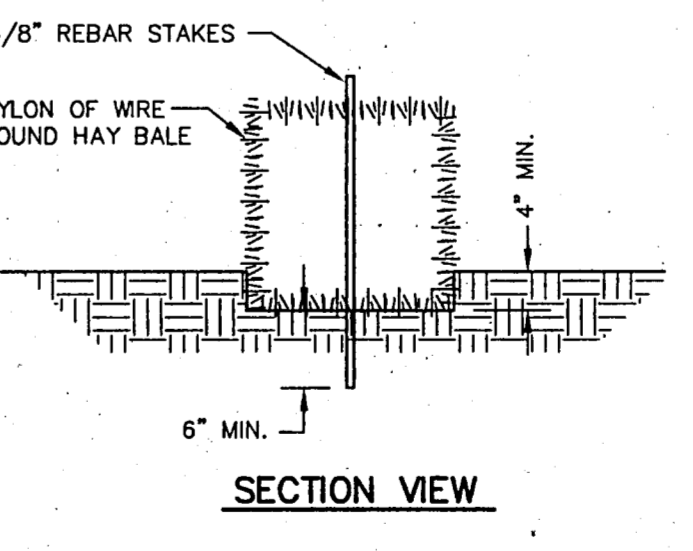

SECTION VIEW

- GENERAL NOTES:
- EACH BALE SHALL BE EMBEDDED IN THE SOIL A MINIMUM OF FOUR INCHES.
 - BALES SHALL BE SECURELY ANCHORED IN PLACE BY A 3/8\"/>

HAY BALE DIKE DETAILS