

SCALE 1" = 20'

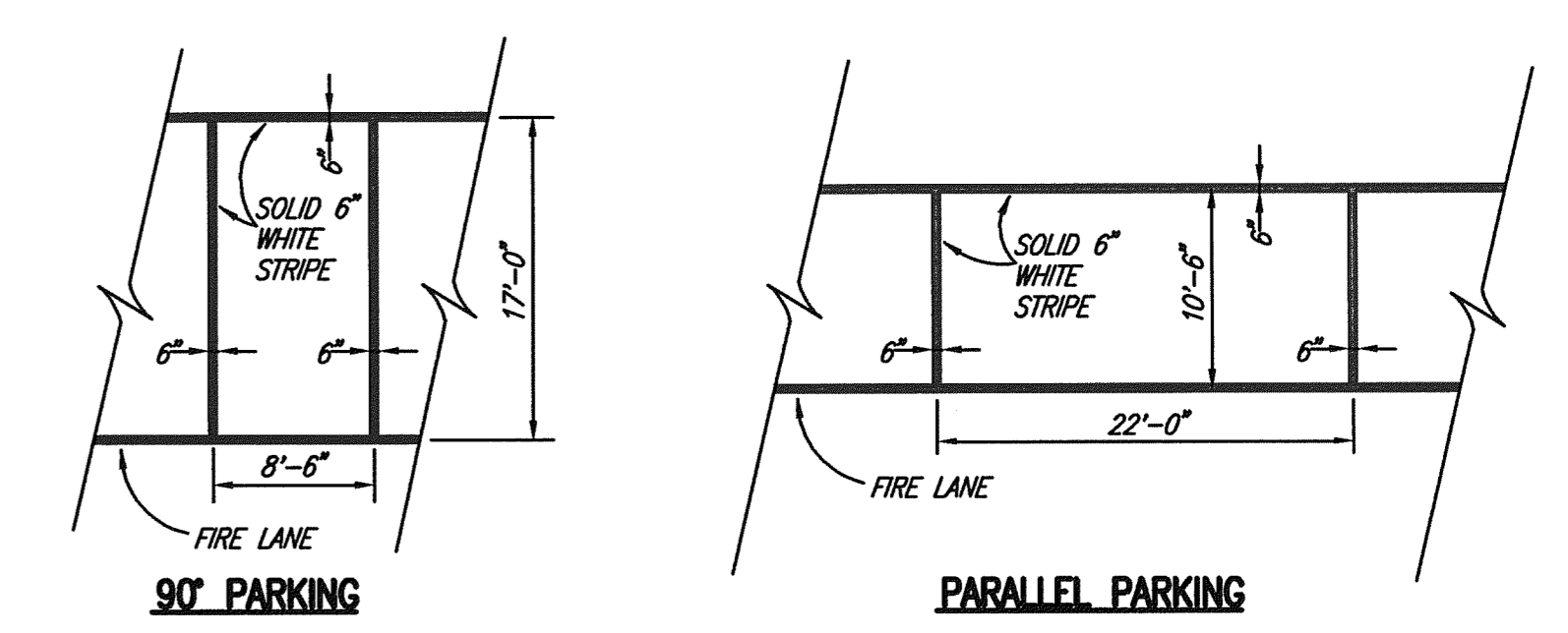

LEGEND

- EXISTING
- PROPOSED BOUNDARY
- PROPOSED CURB KELLER SPRINGS
- PROPOSED IMPROVEMENTS TO PARKING
- E** EXISTING NUMBER OF SPACES
- P** PROPOSED NUMBER OF SPACES

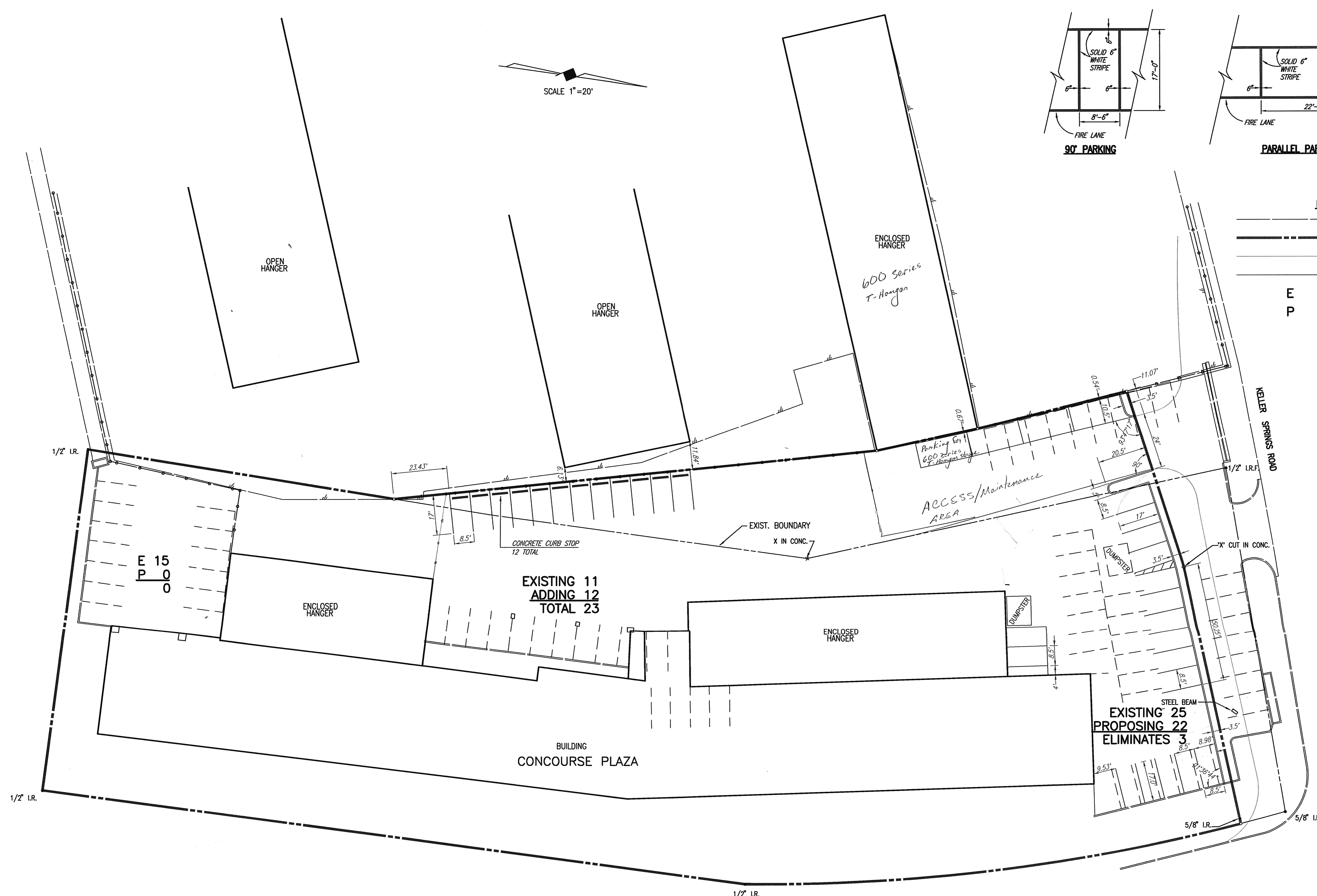

TOTAL EXISTING	36
TOTAL PROPOSED	45
ADDITIONAL SPACES	+9

J. W. Bullard
 DATE: 10/9/96

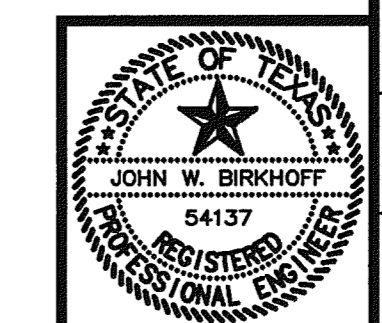

TOWN OF ADDISON, TEXAS
ADDISON AIRPORT - PARKING
AT KELLER SPRINGS RD. & ADDISON RD.

SHIMEK, JACOBS & FINKLEA, L.L.P.
 CONSULTING ENGINEERS
 Dallas, Texas

DESIGNED BY: J.W.B.	PROJECT: 96126	SHEET NO. 1
DRAWN BY: R.J.L.	DATE: AUG. 1996	OF 1 SHEETS