

KLW					
7/16/12	SOJOURN DR REVISIONS				
No.	Date	Revisions			

Kimley-Horn and Associates, Inc.
 1750 Geneva Court, Suite 200
 Dallas, Texas 75246
 Tel. No. (972) 336-3990
 Fax No. (972) 336-3778

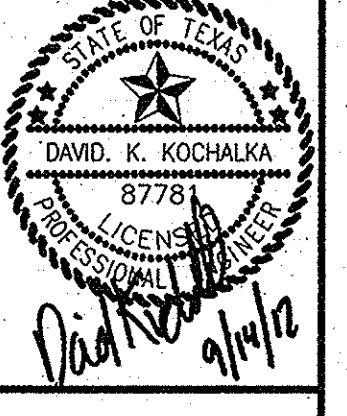

METHODIST PAVILION ONE
 TOWN OF ADDISON, DALLAS COUNTY, TEXAS

TRAFFIC CONTROL PLAN

Scale:	AS SHOWN
Designed by:	JCM
Drawn by:	JCM
Checked by:	DRK
Date:	08/23/2012
Project No.:	69306200

SHEET
C-16

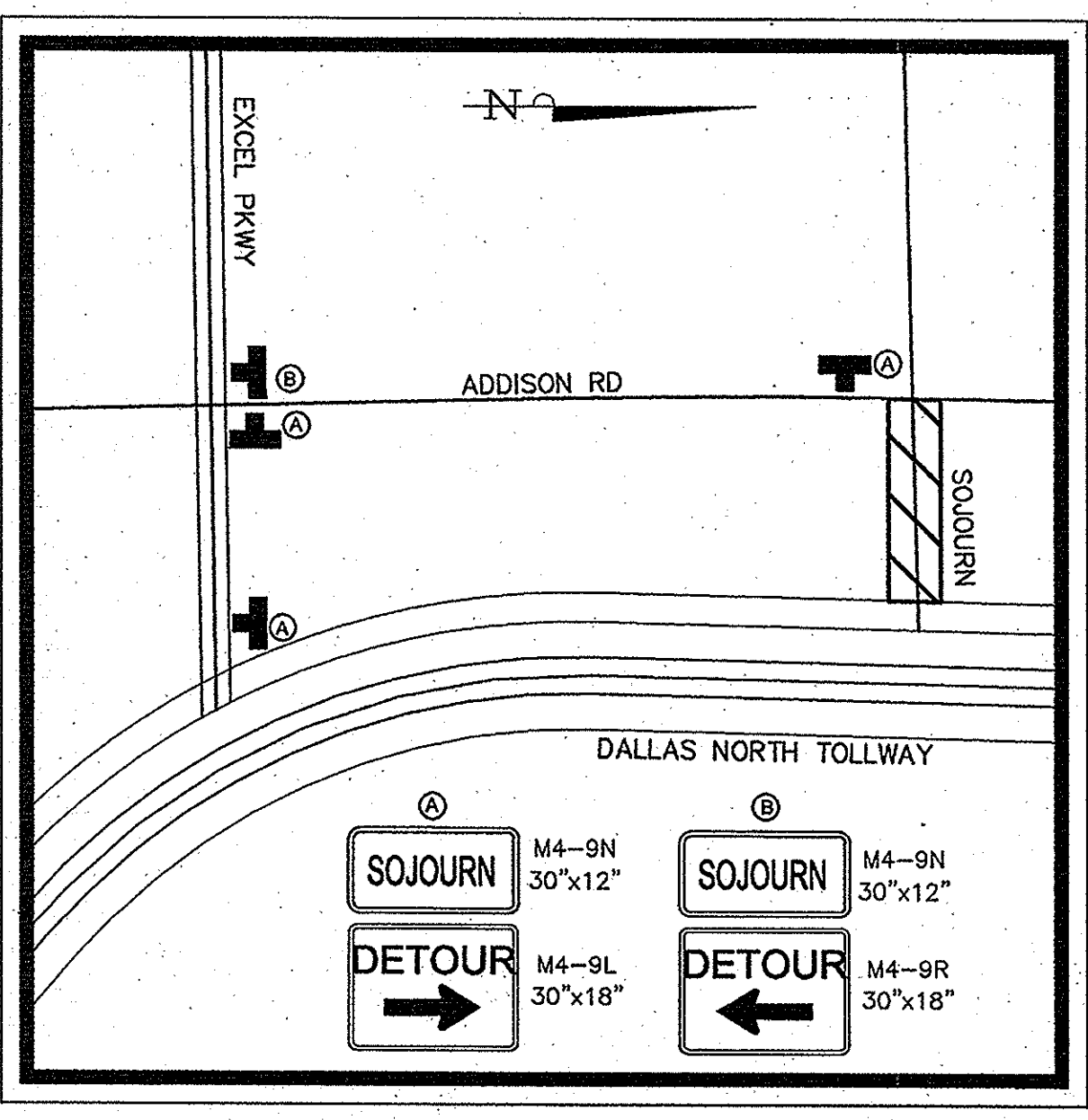
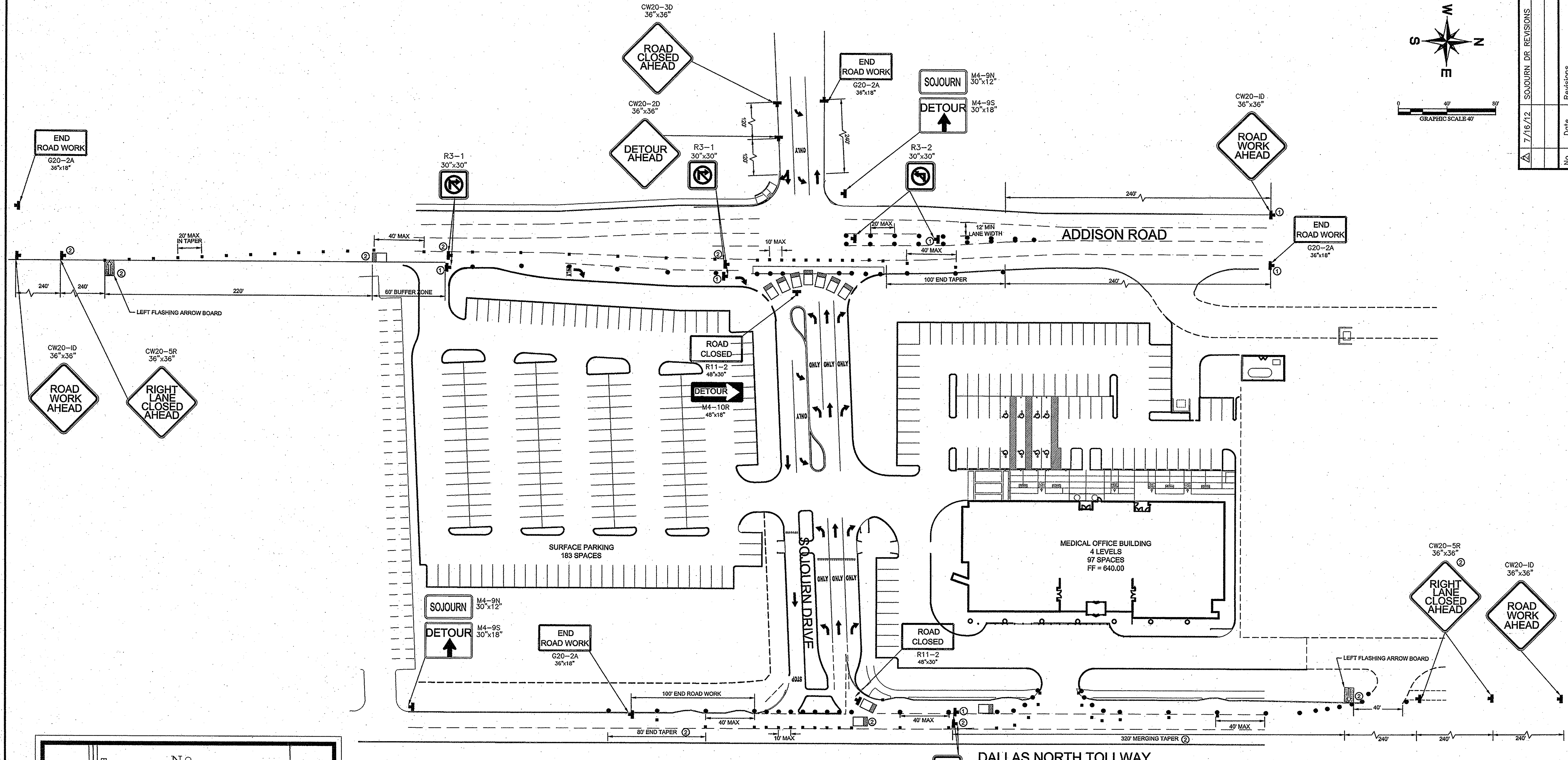
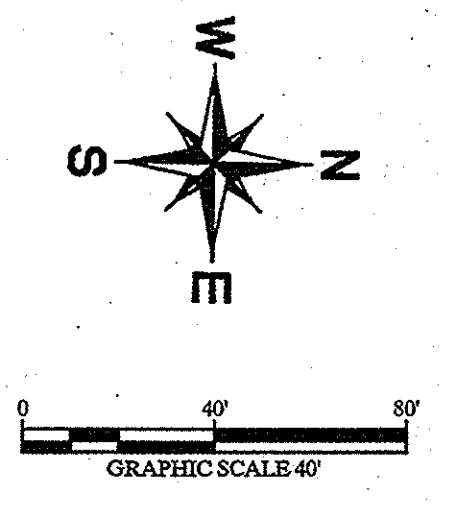

RECORD DRAWINGS
 (July 2013)
 INFORMATION PROVIDED BY:
 Rogers-O'Brien Construction Company

LEGEND

	TYPE 3 BARRICADE
	PHASE 1: CHANNELIZATION VERTICAL DRUM
	PHASE 2: CHANNELIZATION VERTICAL DRUM
	TRAFFIC CONTROL SIGN AND POST
	LEFT FLASHING ARROW BOARD
	WORK AREA DURING CONSTRUCTION
	PHASE 1: DEVICES IN PLACE FOR SOJOURN ROAD CLOSURE ONLY
	PHASE 2: DEVICES IN PLACE FOR SOJOURN ROAD CLOSURE AND LANE CLOSURES

- NOTES**
- ALL TRAFFIC CONTROL SHALL CONFORM TO THE LATEST VERSION OF THE TEXAS MANUAL ON UNIFORM TRAFFIC CONTROL DEVICES (TMUTCD), PART VI. FIELD MODIFICATIONS MAY BE MADE TO ADDRESS LOCAL CONDITIONS WITH THE APPROVAL OF THE ENGINEER.
 - DESIGN SPEED IS 40 MPH ON ADDISON ROAD AND SB DALLAS PARKWAY, AND 30 MPH ON SOJOURN ROAD. MINIMUM SIGN SPACING IS 240' ON ADDISON ROAD AND SB DALLAS PARKWAY, AND 120' ON SOJOURN ROAD.
 - CONTRACTOR IS RESPONSIBLE FOR INSTALLATION, MAINTENANCE, AND REMOVAL OF TRAFFIC CONTROL DEVICES. TRAFFIC CONTROL DEVICES SHOULD BE INSPECTED DAILY AND REPAIRED OR REPLACED AS NECESSARY. AFTER REMOVAL, CONTRACTOR IS RESPONSIBLE FOR RESTORATION OF MODIFICATIONS TO ROADWAY AND SIDEWALK SURFACES, ROADWAY MARKINGS, AND SIGNAGE DUE TO TRAFFIC CONTROL DEVICES OR CONSTRUCTION ACTIVITY.
 - DURING THE HOURS OF DARKNESS, ALL CHANNELIZATION SHALL HAVE A TYPE "C" STEADY BURN WARNING LIGHT OR EQUIVALENT REFLECTOR, AND ALL WARNING SIGNS SHALL HAVE A TYPE "A" LOW INTENSITY FLASHING WARNING LIGHT.
 - THE NORTHBOUND ADDISON ROAD LANE CLOSURE SHALL BE REMOVED EACH WEEKDAY BETWEEN THE HOURS OF 4PM AND 7PM, AND THE EXISTING TWO NORTHBOUND TRAVEL LANES RESTORED. THE SOUTHBOUND DALLAS PARKWAY LANE CLOSURE SHALL BE REMOVED EACH WEEKDAY BETWEEN THE HOURS OF 6AM AND 9AM, AND THE EXISTING TWO SOUTHBOUND TRAVEL LANES RESTORED. CHANNELIZATION DEVICES SHALL BE MOVED TO THE EDGE OF THE TRAVEL LANES AND THE SIGNAGE SHALL BE MODIFIED AS NOTED. IF THERE IS A DROP-OFF OUTSIDE THE EXISTING NORTHBOUND TRAVEL LANES, POST THE W8-8A "SHOULDER DROP OFF" SIGN AT THE SOUTH EDGE OF THE WORKWAY.
 - DEVICES NOT MARKED WITH A PHASE (SOJOURN CLOSURE ONLY OR SOJOURN CLOSURE AND LANE CLOSURE PHASE) SHALL BE IN PLACE AT ALL TIMES.

XREFS: 644, 645, 646, 647, 648, 649, 650, 651, 652, 653, 654, 655, 656, 657, 658, 659, 660, 661, 662, 663, 664, 665, 666, 667, 668, 669, 670, 671, 672, 673, 674, 675, 676, 677, 678, 679, 680, 681, 682, 683, 684, 685, 686, 687, 688, 689, 690, 691, 692, 693, 694, 695, 696, 697, 698, 699, 700, 701, 702, 703, 704, 705, 706, 707, 708, 709, 710, 711, 712, 713, 714, 715, 716, 717, 718, 719, 720, 721, 722, 723, 724, 725, 726, 727, 728, 729, 730, 731, 732, 733, 734, 735, 736, 737, 738, 739, 740, 741, 742, 743, 744, 745, 746, 747, 748, 749, 750, 751, 752, 753, 754, 755, 756, 757, 758, 759, 760, 761, 762, 763, 764, 765, 766, 767, 768, 769, 770, 771, 772, 773, 774, 775, 776, 777, 778, 779, 780, 781, 782, 783, 784, 785, 786, 787, 788, 789, 790, 791, 792, 793, 794, 795, 796, 797, 798, 799, 800, 801, 802, 803, 804, 805, 806, 807, 808, 809, 810, 811, 812, 813, 814, 815, 816, 817, 818, 819, 820, 821, 822, 823, 824, 825, 826, 827, 828, 829, 830, 831, 832, 833, 834, 835, 836, 837, 838, 839, 840, 841, 842, 843, 844, 845, 846, 847, 848, 849, 850, 851, 852, 853, 854, 855, 856, 857, 858, 859, 860, 861, 862, 863, 864, 865, 866, 867, 868, 869, 870, 871, 872, 873, 874, 875, 876, 877, 878, 879, 880, 881, 882, 883, 884, 885, 886, 887, 888, 889, 890, 891, 892, 893, 894, 895, 896, 897, 898, 899, 900, 901, 902, 903, 904, 905, 906, 907, 908, 909, 910, 911, 912, 913, 914, 915, 916, 917, 918, 919, 920, 921, 922, 923, 924, 925, 926, 927, 928, 929, 930, 931, 932, 933, 934, 935, 936, 937, 938, 939, 940, 941, 942, 943, 944, 945, 946, 947, 948, 949, 950, 951, 952, 953, 954, 955, 956, 957, 958, 959, 960, 961, 962, 963, 964, 965, 966, 967, 968, 969, 970, 971, 972, 973, 974, 975, 976, 977, 978, 979, 980, 981, 982, 983, 984, 985, 986, 987, 988, 989, 990, 991, 992, 993, 994, 995, 996, 997, 998, 999, 1000.