

- B.M.#19 "□" CUT IN CENTER OF INLET 150 FEET SOUTH OF BELT LINE RD., EAST OF INWOOD RD. ELEV. 630.59
- T.B.M. AR-1 "□" CUT IN TOP OF VAULT NORTHEAST CORNER OF ADDISON RD. AND BELT LINE RD. ELEV. 634.80
- T.B.M. AR-2 "□" CUT IN CENTER OF INLET EAST SIDE OF ADDISON RD., @ STA. 9+87, 52 FEET RT. ELEV. 628.79

These plans and related specifications were prepared for construction of this specific project only. Reuse of these documents is not permitted without written authorization of Shimek, Jacobs & Finklea, L.L.P.

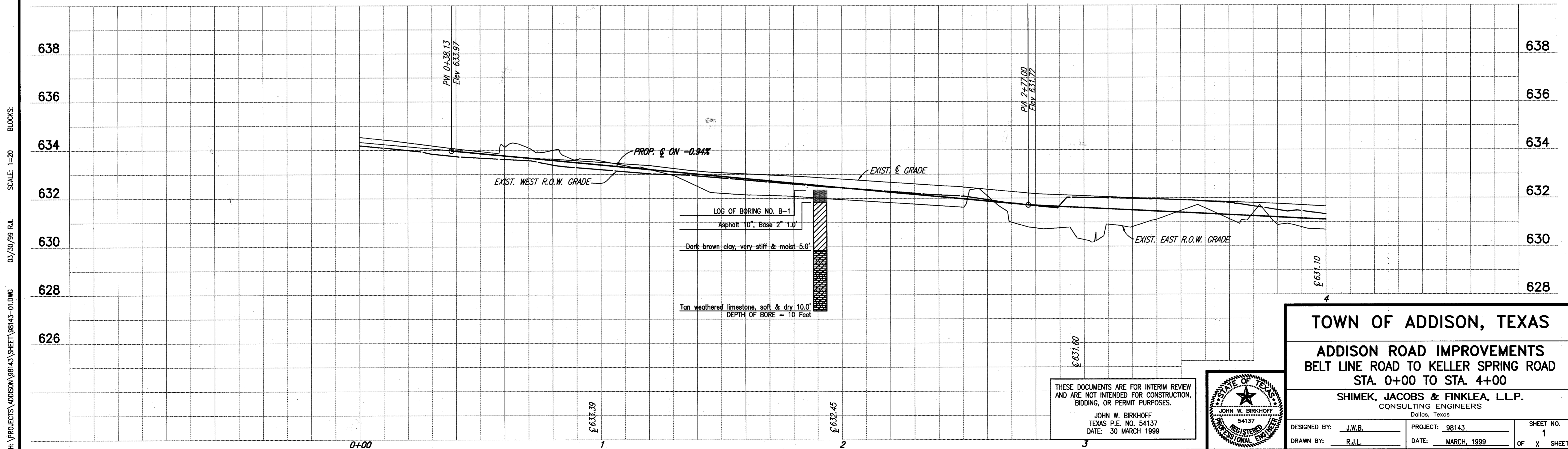

H:\PROJECTS\ADDISON\98143\SHEET\98143-01.DWG  
 03/30/99 R.L.  
 SCALE: 1"=20'  
 BLOCKS:

THESE DOCUMENTS ARE FOR INTERIM REVIEW AND ARE NOT INTENDED FOR CONSTRUCTION, BIDDING, OR PERMIT PURPOSES.  
 JOHN W. BIRKHOFF  
 TEXAS P.E. NO. 54137  
 DATE: 30 MARCH 1999

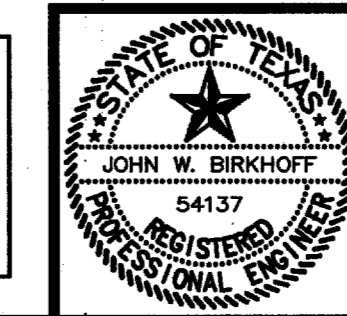

<b>TOWN OF ADDISON, TEXAS</b>		
<b>ADDISON ROAD IMPROVEMENTS</b>		
<b>BELT LINE ROAD TO KELLER SPRING ROAD</b>		
<b>STA. 0+00 TO STA. 4+00</b>		
<b>SHIMEK, JACOBS &amp; FINKLEA, L.L.P.</b>		
CONSULTING ENGINEERS Dallas, Texas		
DESIGNED BY: J.W.B.	PROJECT: 98143	SHEET NO. 1
DRAWN BY: R.J.L.	DATE: MARCH, 1999	OF X SHEETS

FF-25

MATCH LINE STA. 4+00

MATCH LINE STA. 9+00

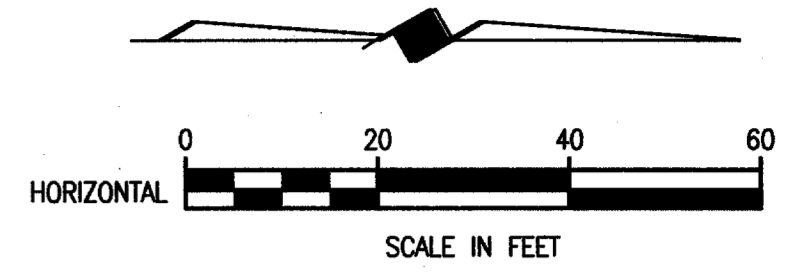

- B.M.#19 "□" CUT IN CENTER OF INLET 150 FEET SOUTH OF BELT LINE RD., EAST OF INWOOD RD. ELEV. 630.59
- T.B.M. AR-1 "□" CUT IN TOP OF VAULT NORTHEAST CORNER OF ADDISON RD. AND BELT LINE RD. ELEV. 634.80
- T.B.M. AR-2 "□" CUT IN CENTER OF INLET EAST SIDE OF ADDISON RD., @ STA. 9+87, 52 FEET RT. ELEV. 628.79

These plans and related specifications were prepared for construction of this specific project only. Reuse of these documents is not permitted without written authorization of Shimek, Jacobs & Finklea, L.L.P.

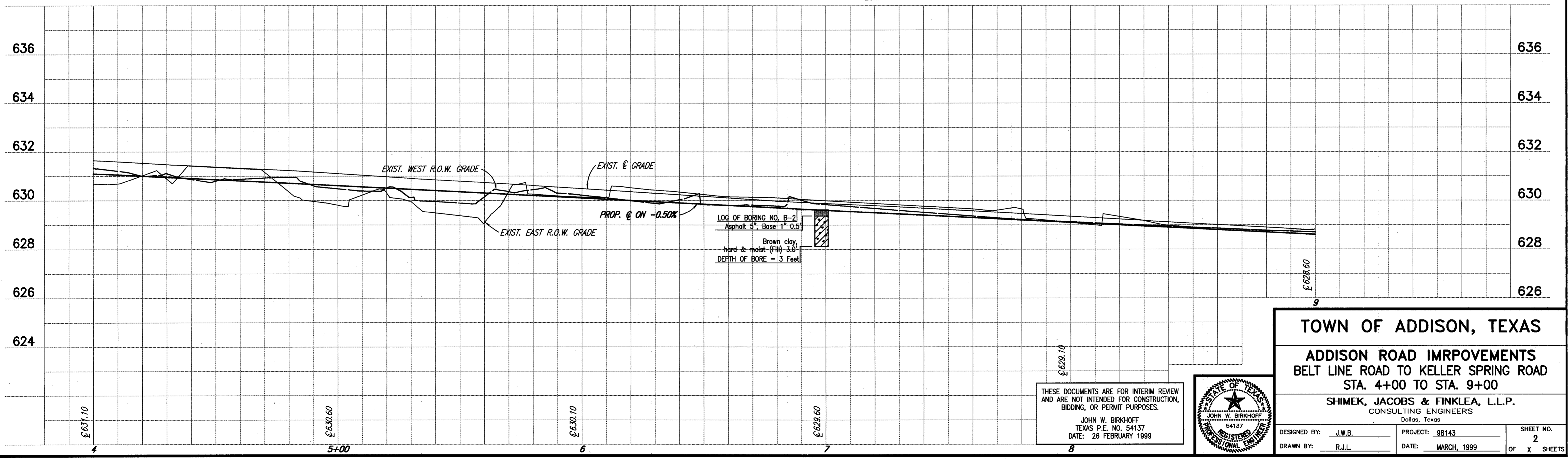
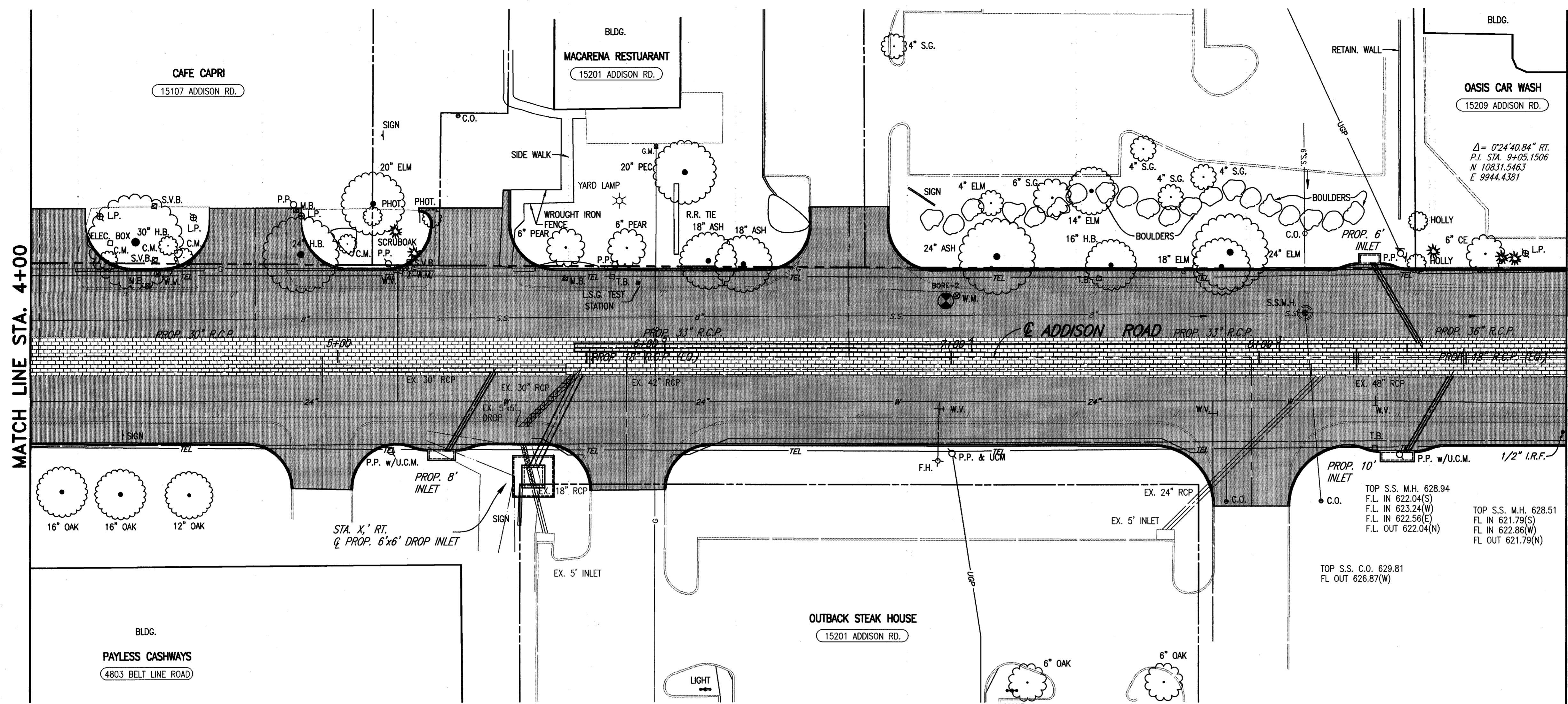

H:\PROJECTS\ADDISON\98143\SHEET\98143-02.DWG  
 03/30/99 RLL  
 SCALE: 1"=X  
 BLOCKS:

THESE DOCUMENTS ARE FOR INTERIM REVIEW AND ARE NOT INTENDED FOR CONSTRUCTION, BIDDING, OR PERMIT PURPOSES.  
 JOHN W. BIRKHOFF  
 TEXAS P.E. NO. 54137  
 DATE: 26 FEBRUARY 1999

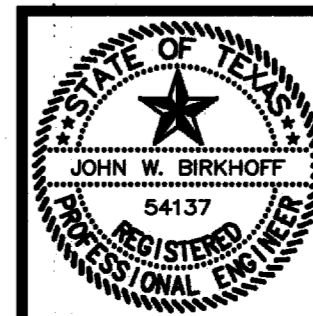

<b>TOWN OF ADDISON, TEXAS</b>		
<b>ADDISON ROAD IMPROVEMENTS</b>		
<b>BELT LINE ROAD TO KELLER SPRING ROAD</b>		
<b>STA. 4+00 TO STA. 9+00</b>		
<b>SHIMEK, JACOBS &amp; FINKLEA, L.L.P.</b>		
CONSULTING ENGINEERS Dallas, Texas		
DESIGNED BY: J.W.B.	PROJECT: 98143	SHEET NO. 2
DRAWN BY: R.J.L.	DATE: MARCH, 1999	OF X SHEETS

MATCH LINE STA. 9+00

MATCH LINE STA. 14+00

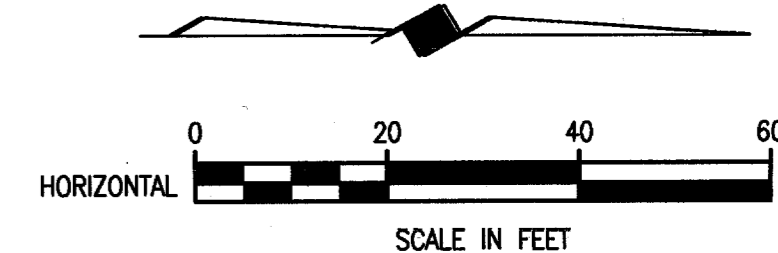

- B.M.#19 "□" CUT IN CENTER OF INLET 150 FEET SOUTH OF BELT LINE RD., EAST OF INWOOD RD. ELEV. 630.59
- T.B.M. AR-1 "□" CUT IN TOP OF VAULT NORTHEAST CORNER OF ADDISON RD. AND BELT LINE RD. ELEV. 634.80
- T.B.M. AR-2 "□" CUT IN CENTER OF INLET EAST SIDE OF ADDISON RD., @ STA. 9+87, 52 FEET RT. ELEV. 628.79
- T.B.M. AR-3 "□" CUT AT END OF RETAINING WALL, NORTH OF LINDBERGH DR., WEST SIDE OF ADDISON RD., @ STA. 18+76, 45 FEET LT. ELEV. 635.38

These plans and related specifications were prepared for construction of this specific project only. Reuse of these documents is not permitted without written authorization of Shimek, Jacobs & Finklea, L.L.P.

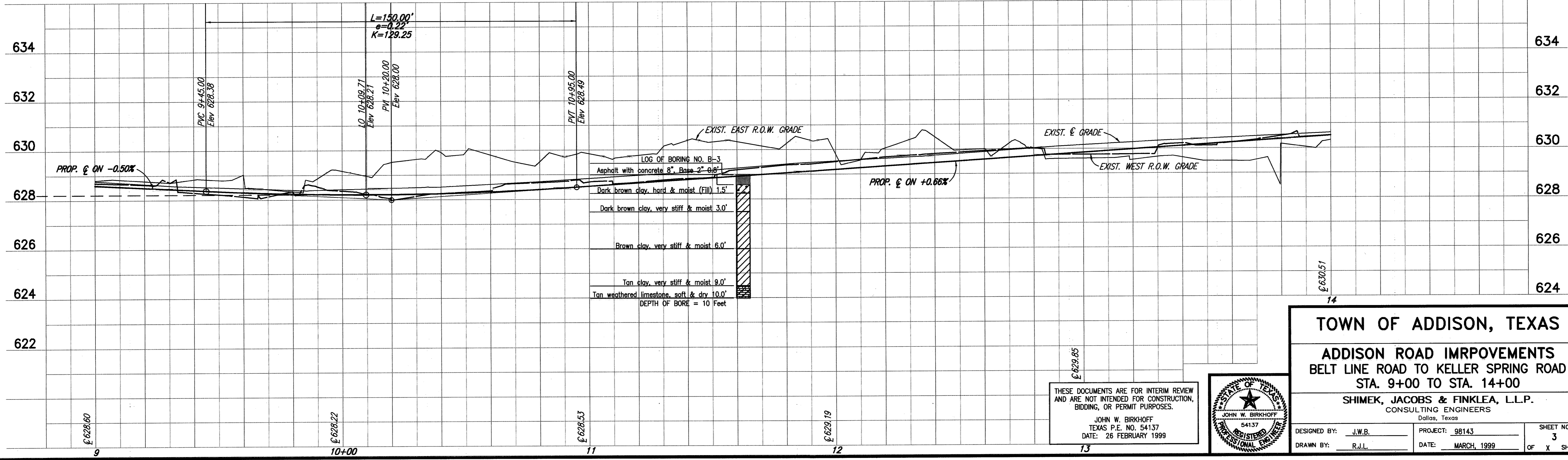
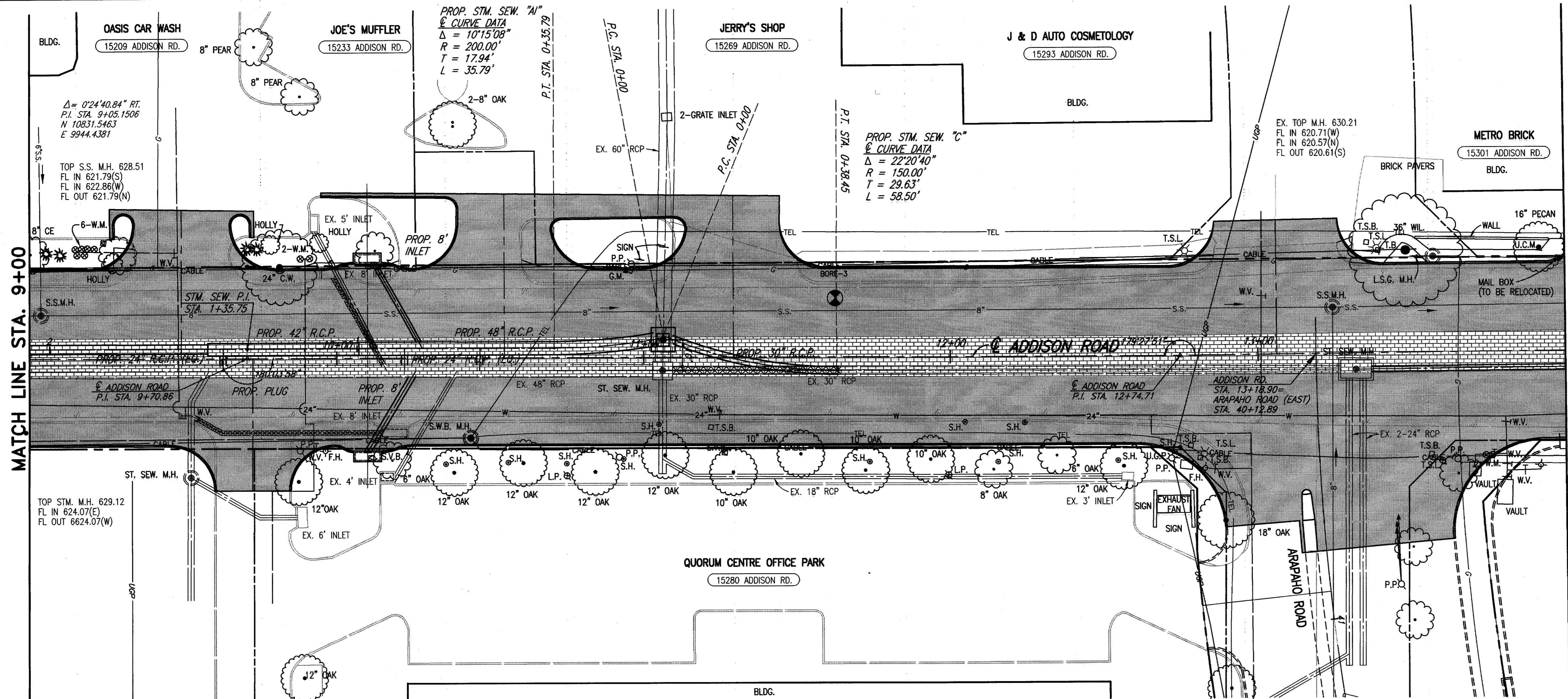

THESE DOCUMENTS ARE FOR INTERIM REVIEW AND ARE NOT INTENDED FOR CONSTRUCTION, BIDDING, OR PERMIT PURPOSES.  
 JOHN W. BIRKHOFF  
 TEXAS P.E. NO. 54137  
 DATE: 26 FEBRUARY 1999

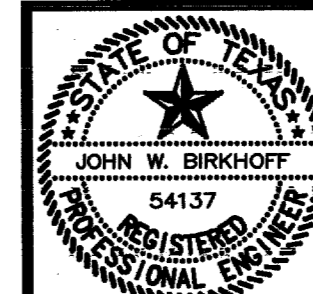

**TOWN OF ADDISON, TEXAS**

**ADDISON ROAD IMPROVEMENTS**  
 BELT LINE ROAD TO KELLER SPRING ROAD  
 STA. 9+00 TO STA. 14+00

**SHIMEK, JACOBS & FINKLEA, L.L.P.**  
 CONSULTING ENGINEERS  
 Dallas, Texas

DESIGNED BY: J.W.B.	PROJECT: 98143	SHEET NO. 3
DRAWN BY: R.J.L.	DATE: MARCH, 1999	OF X SHEETS

H:\PROJECTS\ADDISON\98143\SHEET\98143-03.DWG 03/30/99 R.L.L. BLOCKS: SCALE: 1"=X

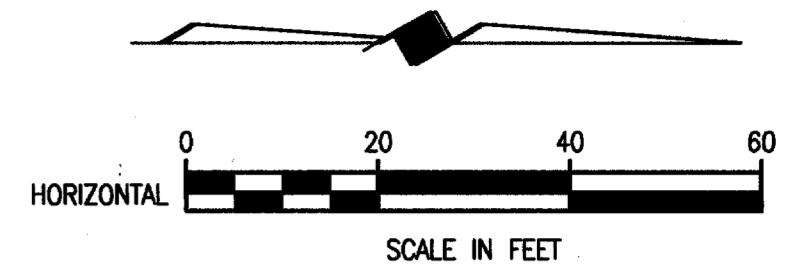
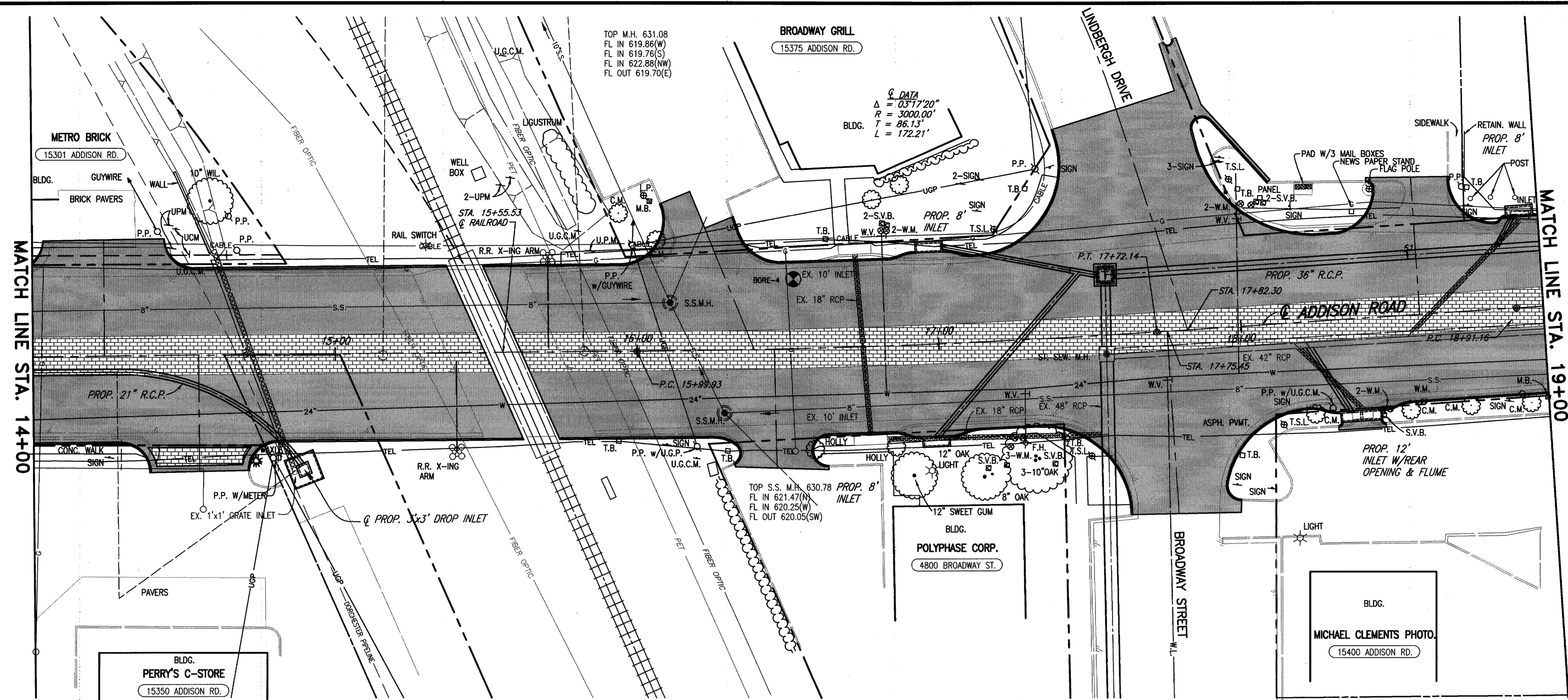

- B.M.#19 "□" CUT IN CENTER OF INLET 150 FEET SOUTH OF BELT LINE RD., EAST OF INWOOD RD. ELEV. 630.59
- T.B.M. AR-1 "□" CUT IN TOP OF VAULT NORTHEAST CORNER OF ADDISON RD. AND BELT LINE RD. ELEV. 634.80
- T.B.M. AR-2 "□" CUT IN CENTER OF INLET EAST SIDE OF ADDISON RD., @ STA. 9+87, 52 FEET RT. ELEV. 628.79
- T.B.M. AR-3 "□" CUT AT END OF RETAINING WALL, NORTH OF LINDBERGH DR., WEST SIDE OF ADDISON RD., @ STA. 18+76, 45 FEET LT. ELEV. 635.38

These plans and related specifications were prepared for construction of this specific project only. Reuse of these documents is not permitted without written authorization of Shimek, Jacobs & Finklea, L.L.P.

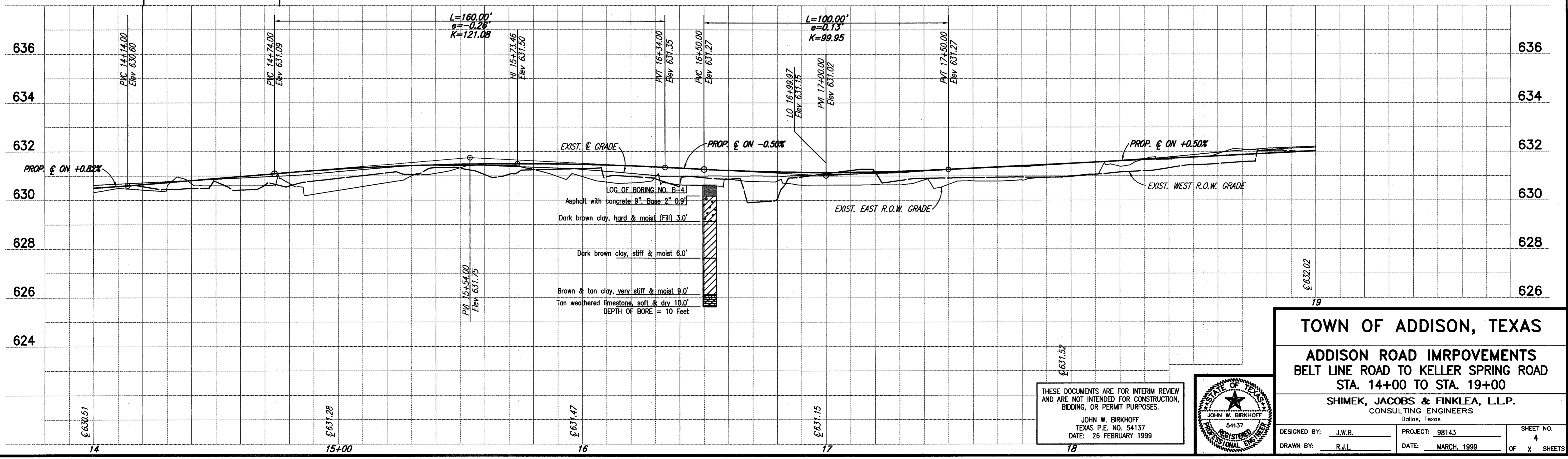

H:\PROJECTS\ADDISON\98143\1\SHEET\98143-04.DWG 03/30/99 R.L. SCALE: 1"=20' BLOCKS:

THESE DOCUMENTS ARE FOR INTERIM REVIEW AND ARE NOT INTENDED FOR CONSTRUCTION, BIDDING, OR PERMIT PURPOSES.  
 JOHN W. BIRKHOFF  
 TEXAS P.E. NO. 54137  
 DATE: 26 FEBRUARY 1999

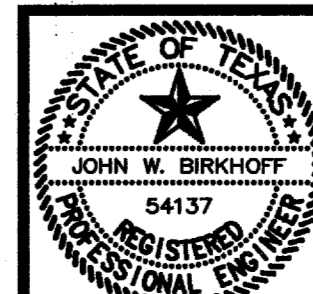

<b>TOWN OF ADDISON, TEXAS</b>		
<b>ADDISON ROAD IMPROVEMENTS</b>		
<b>BELT LINE ROAD TO KELLER SPRING ROAD</b>		
<b>STA. 14+00 TO STA. 19+00</b>		
<b>SHIMEK, JACOBS &amp; FINKLEA, L.L.P.</b>		
CONSULTING ENGINEERS Dallas, Texas		
DESIGNED BY: J.W.B.	PROJECT: 98143	SHEET NO. 4
DRAWN BY: R.J.L.	DATE: MARCH, 1999	OF X SHEETS

WHITE ROCK LODGE  
NO. 234  
15405 ADDISON RD.

ADDISON AIRPORT

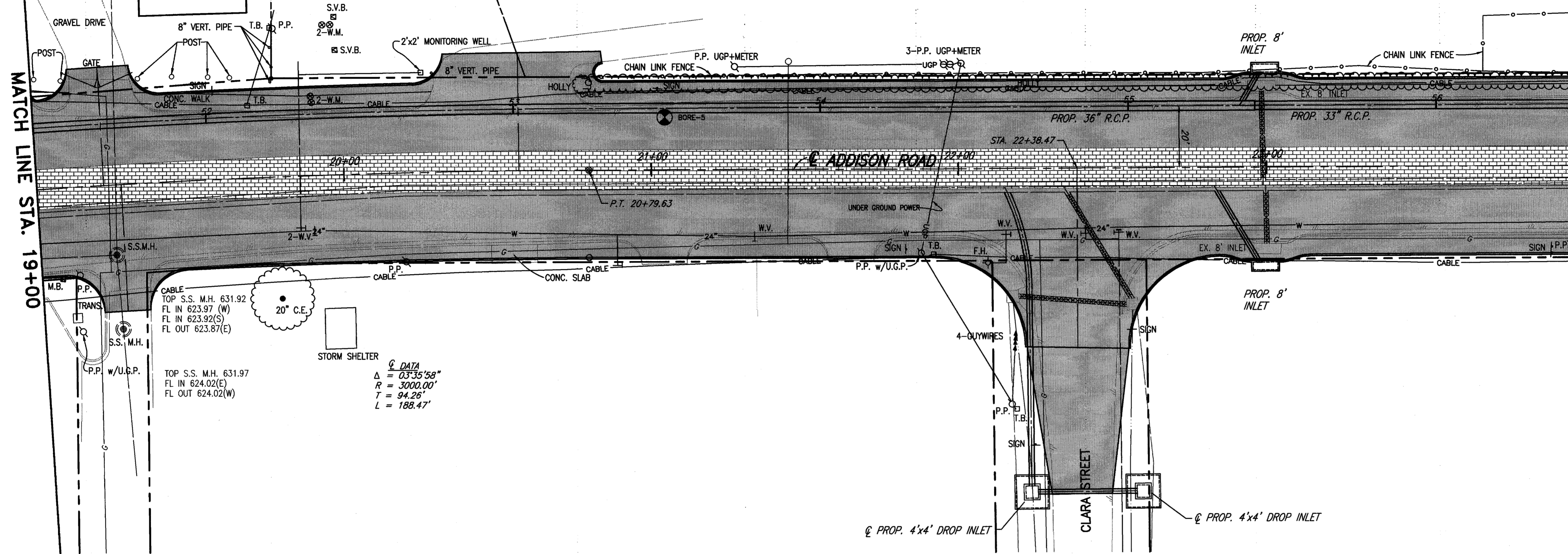
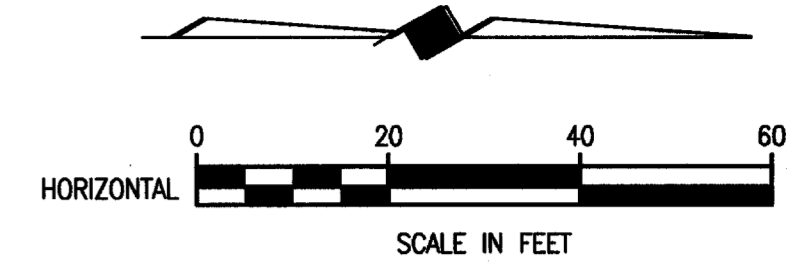

- B.M.#19 "□" CUT IN CENTER OF INLET 150 FEET SOUTH OF BELT LINE RD., EAST OF INWOOD RD. ELEV. 630.59
- T.B.M. AR-1 "□" CUT IN TOP OF VAULT NORTHEAST CORNER OF ADDISON RD. AND BELT LINE RD. ELEV. 634.80
- T.B.M. AR-2 "□" CUT IN CENTER OF INLET EAST SIDE OF ADDISON RD., @ STA. 9+87, 52 FEET RT. ELEV. 628.79
- T.B.M. AR-3 "□" CUT AT END OF RETAINING WALL, NORTH OF LINDBERGH DR., WEST SIDE OF ADDISON RD., @ STA. 18+76, 45 FEET LT. ELEV. 635.38
- T.B.M. AR-4 "□" CUT IN CENTER OF INLET SOUTH SIDE OF ADDISON CIRCLE, @ STA. 26+57, 276 FEET RT. CIRCLE ELEV. 636.26

These plans and related specifications were prepared for construction of this specific project only. Reuse of these documents is not permitted without written authorization of Shimek, Jacobs & Finklea, L.L.P.

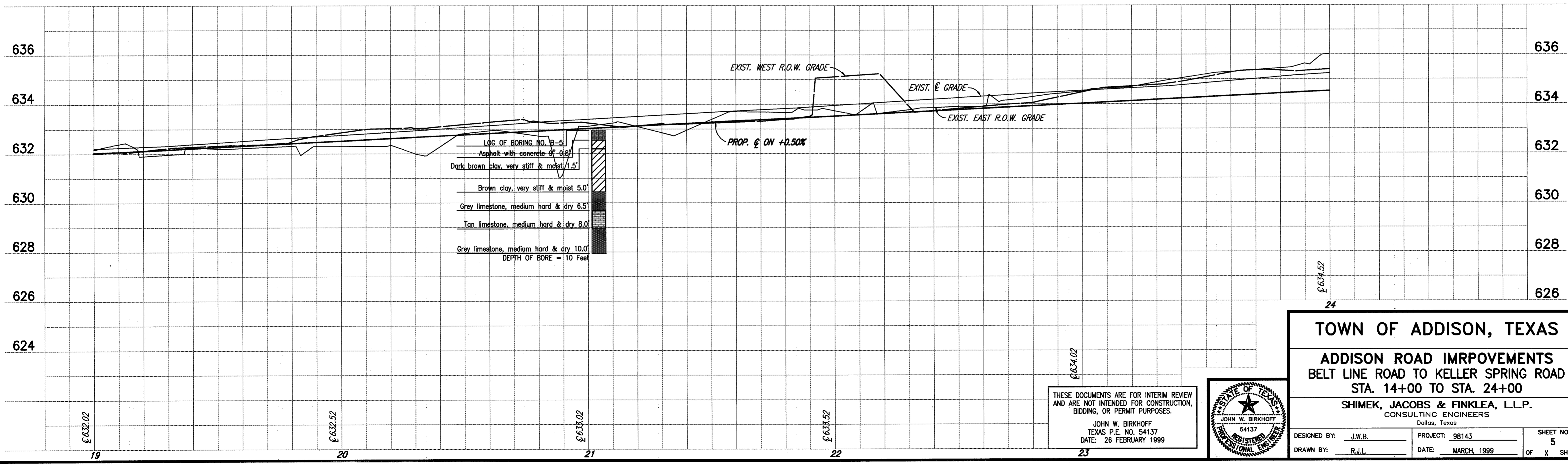

LOG OF BORING NO. B-5  
Asphalt with concrete 0.8'  
Dark brown clay, very stiff & moist 1.5'  
Brown clay, very stiff & moist 5.0'  
Grey limestone, medium hard & dry 6.5'  
Tan limestone, medium hard & dry 8.0'  
Grey limestone, medium hard & dry 10.0'  
DEPTH OF BORE = 10 Feet

**TOWN OF ADDISON, TEXAS**

**ADDISON ROAD IMPROVEMENTS**  
BELT LINE ROAD TO KELLER SPRING ROAD  
STA. 14+00 TO STA. 24+00

**SHIMEK, JACOBS & FINKLEA, L.L.P.**  
CONSULTING ENGINEERS  
Dallas, Texas

DESIGNED BY: J.W.B. PROJECT: 98143 SHEET NO. 5  
DRAWN BY: R.J.L. DATE: MARCH, 1999 OF X SHEETS

THESE DOCUMENTS ARE FOR INTERIM REVIEW AND ARE NOT INTENDED FOR CONSTRUCTION, BIDDING, OR PERMIT PURPOSES.

JOHN W. BIRKHOFF  
TEXAS P.E. NO. 54137  
DATE: 26 FEBRUARY 1999

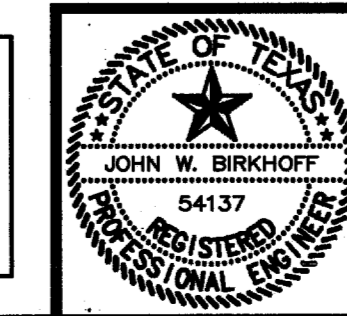

H:\PROJECTS\ADDISON\98143\SHEET\98143-05.DWG 03/30/99 R.L. SCALE: 1=20 BLOCKS:

MATCH LINE STA. 24+00

MATCH LINE STA. 29+00

ADDISON AIRPORT

ADDISON AIRPORT

FUEL DEPOT ADDRESS

PROPOSED ROAD  
P.I. STA. 27+19.8235  
N 12630.6984  
E 9711.1503

TOP S.S. M.H. 637.70  
FL IN 627.60 (W)  
FL IN 626.75 (N)  
FL OUT 626.70 (SE)

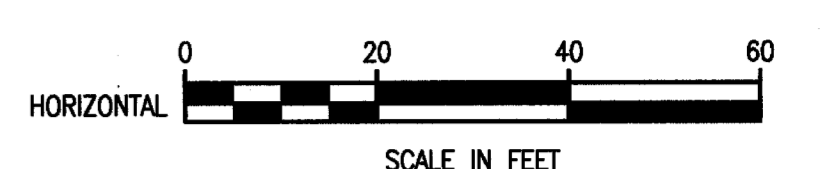

- B.M.#19 "C" CUT IN CENTER OF INLET 150 FEET SOUTH OF BELT LINE RD., EAST OF INWOOD RD. ELEV. 630.59
- T.B.M. AR-1 "C" CUT IN TOP OF VAULT NORTHEAST CORNER OF ADDISON RD. AND BELT LINE RD. ELEV. 634.80
- T.B.M. AR-2 "C" CUT IN CENTER OF INLET EAST SIDE OF ADDISON RD., @ STA. 9+87, 52 FEET RT. ELEV. 628.79
- T.B.M. AR-3 "C" CUT AT END OF RETAINING WALL, NORTH OF LINDBERGH DR., WEST SIDE OF ADDISON RD., @ STA. 18+76, 45 FEET LT. ELEV. 635.38
- T.B.M. AR-4 "C" CUT IN CENTER OF INLET SOUTH SIDE OF ADDISON RD., @ STA. 26+57, 276 FEET RT. ELEV. 636.26

These plans and related specifications were prepared for construction of this specific project only. Reuse of these documents is not permitted without written authorization of Shimek, Jacobs & Finklea, L.L.P.

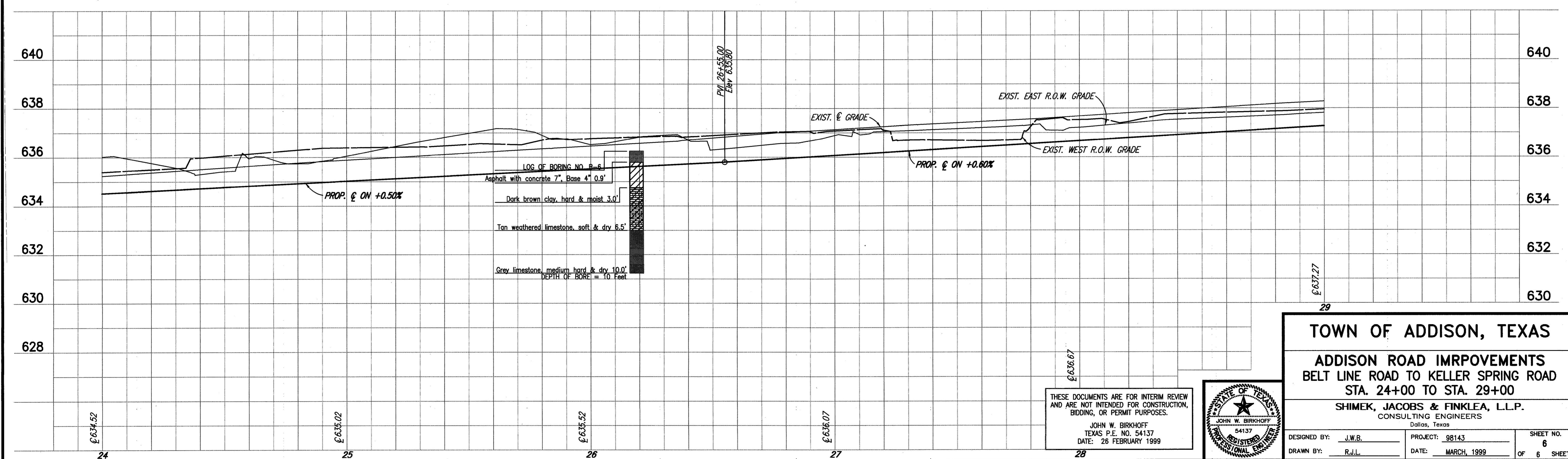

**TOWN OF ADDISON, TEXAS**

**ADDISON ROAD IMPROVEMENTS**  
BELT LINE ROAD TO KELLER SPRING ROAD  
STA. 24+00 TO STA. 29+00

**SHIMEK, JACOBS & FINKLEA, L.L.P.**  
CONSULTING ENGINEERS  
Dallas, Texas

DESIGNED BY: J.W.B. PROJECT: 98143 SHEET NO. 6  
DRAWN BY: R.J.L. DATE: MARCH, 1999 OF 6 SHEETS

THESE DOCUMENTS ARE FOR INTERIM REVIEW AND ARE NOT INTENDED FOR CONSTRUCTION, BIDDING, OR PERMIT PURPOSES.  
JOHN W. BIRKHOFF  
TEXAS P.E. NO. 54137  
DATE: 26 FEBRUARY 1999

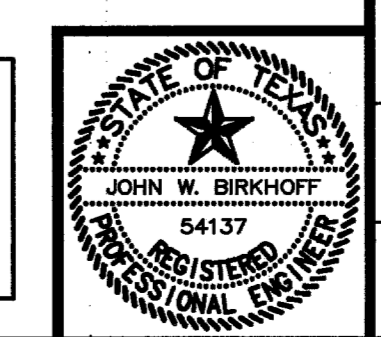

H:\PROJECTS\ADDISON\98143\SHEET\98143-06.DWG 03/30/99 R.L. SCALE: 1"=20' BLOCKS:

ADDISON AIRPORT

TOP S.S. M.H. 636.04

MATCH LINE STA. 29+00

MATCH LINE STA. 34+00

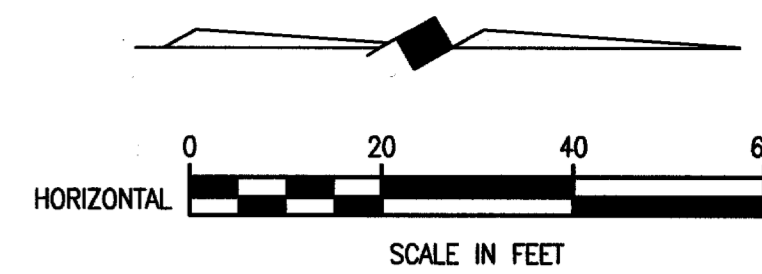

- T.B.M. AR-4 "□" CUT IN CENTER OF INLET SOUTH SIDE OF ADDISON CIRCLE, @ STA. 26+57, 276 FEET RT. ELEV. 636.26
- T.B.M. AR-6 "□" CUT IN BASE OF POWER TOWER SOUTHEAST CORNER OF ADDISON RD. & KELLER SPRING RD. ELEV. 638.07
- B.M.#4 "□" CUT IN CENTER OF INLET SOUTHWEST CORNER OF ADDISON RD. & RATLIFT LN. ELEV. 637.20

These plans and related specifications were prepared for construction of this specific project only. Reuse of these documents is not permitted without written authorization of Shimek, Jacobs & Finklea, L.L.P.

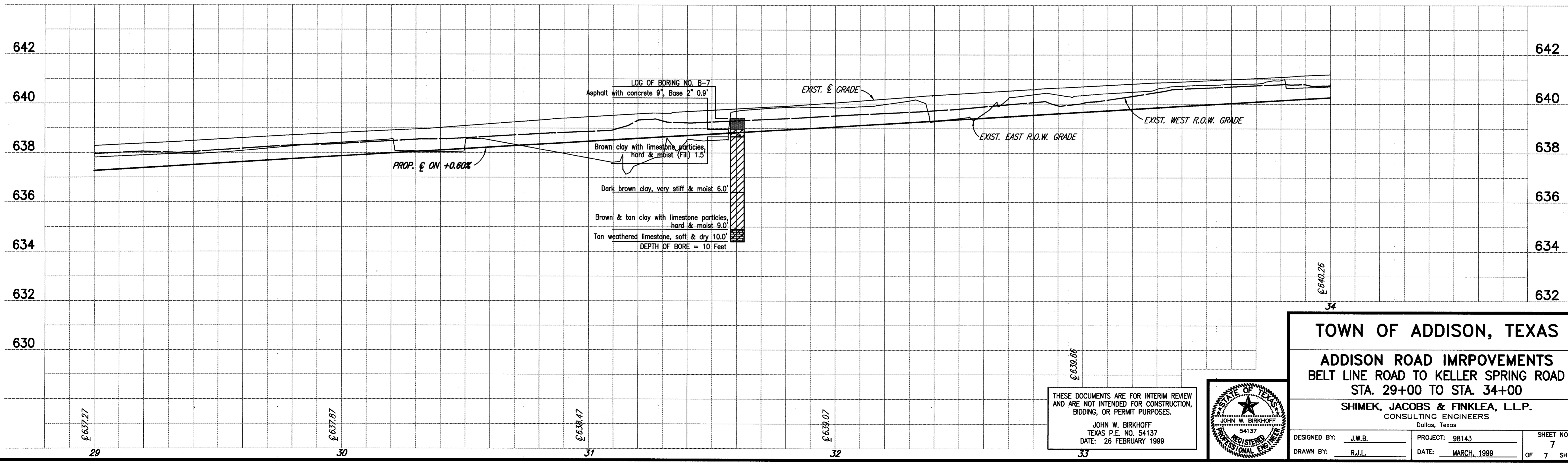
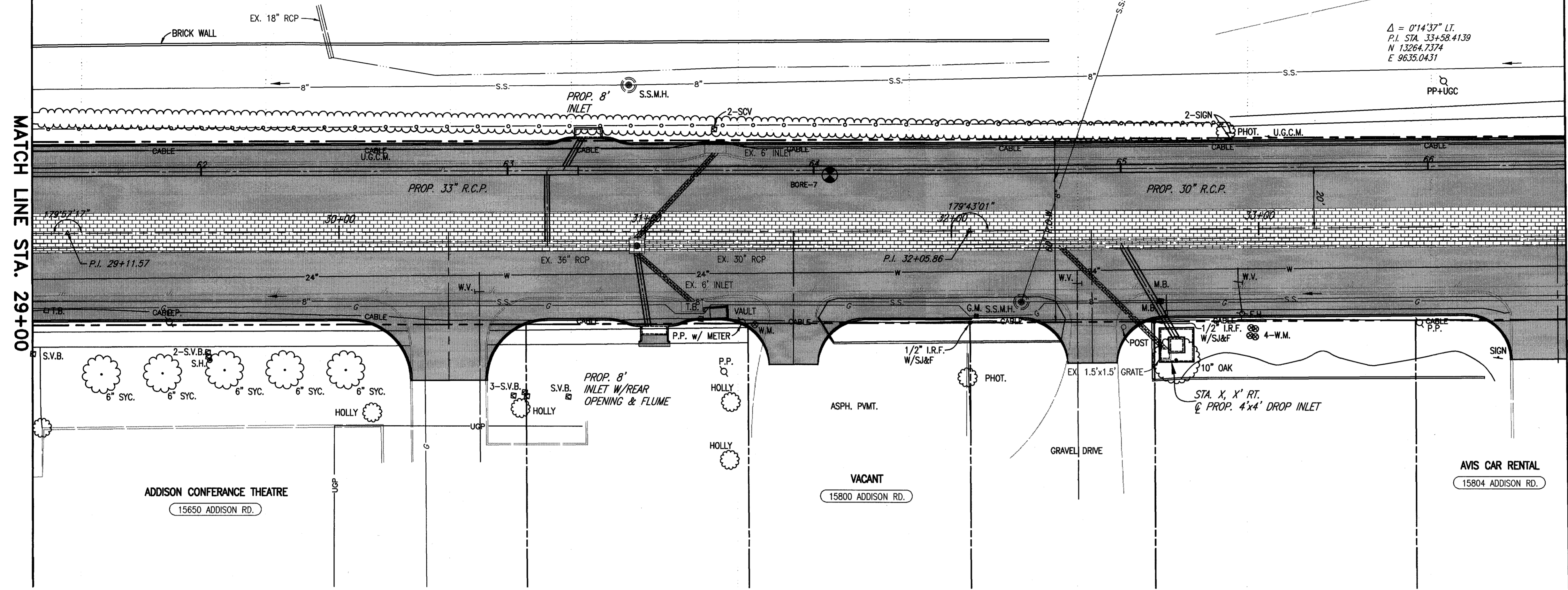

TOWN OF ADDISON, TEXAS

ADDISON ROAD IMPROVEMENTS  
BELT LINE ROAD TO KELLER SPRING ROAD  
STA. 29+00 TO STA. 34+00

SHIMEK, JACOBS & FINKLEA, L.L.P.  
CONSULTING ENGINEERS  
Dallas, Texas

DESIGNED BY: J.W.B. PROJECT: 98143 SHEET NO. 7  
DRAWN BY: R.J.L. DATE: MARCH, 1999 OF 7 SHEETS

THESE DOCUMENTS ARE FOR INTERIM REVIEW AND ARE NOT INTENDED FOR CONSTRUCTION, BIDDING, OR PERMIT PURPOSES.

JOHN W. BIRKHOFF  
TEXAS P.E. NO. 54137  
DATE: 26 FEBRUARY 1999

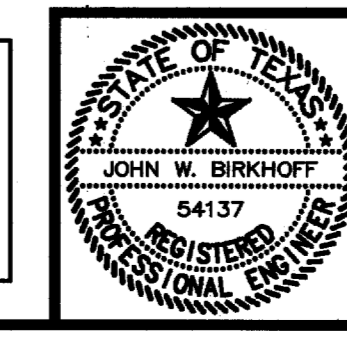

H:\PROJECTS\ADDISON\98143\SHEET\98143-07.DWG 03/30/99 RLL SCALE: 1"=20' BLOCKS:

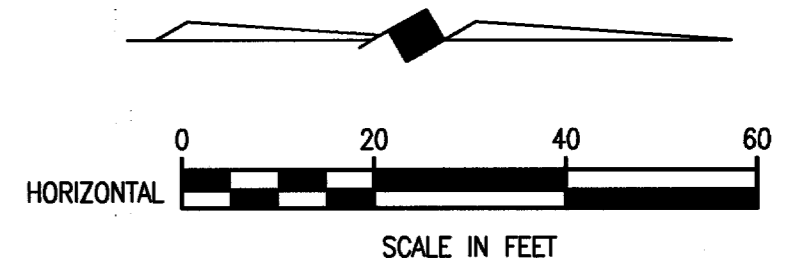
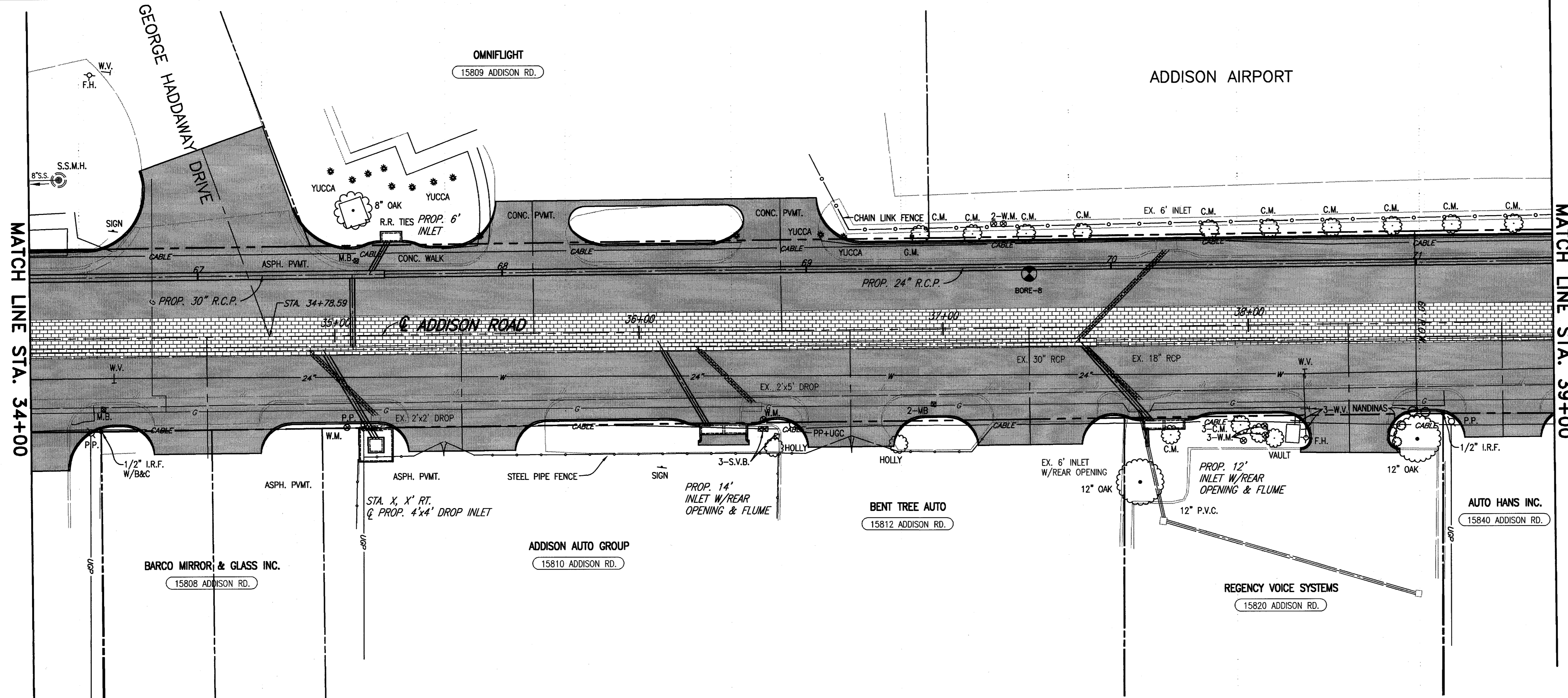

T.B.M. AR-4 "□" CUT IN CENTER OF INLET SOUTH SIDE OF ADDISON ROAD, STA. 28+57, 276 FEET RT. ELEV. 636.26

T.B.M. AR-6 "□" CUT IN BASE OF POWER TOWER SOUTHEAST CORNER OF ADDISON RD. & KELLER SPRING RD. ELEV. 638.07

B.M.#4 "□" CUT IN CENTER OF INLET SOUTHWEST CORNER OF ADDISON RD. & RATLIFT LN. ELEV. 637.20

These plans and related specifications were prepared for construction of this specific project only. Reuse of these documents is not permitted without written authorization of Shimek, Jacobs & Finklea, L.L.P.

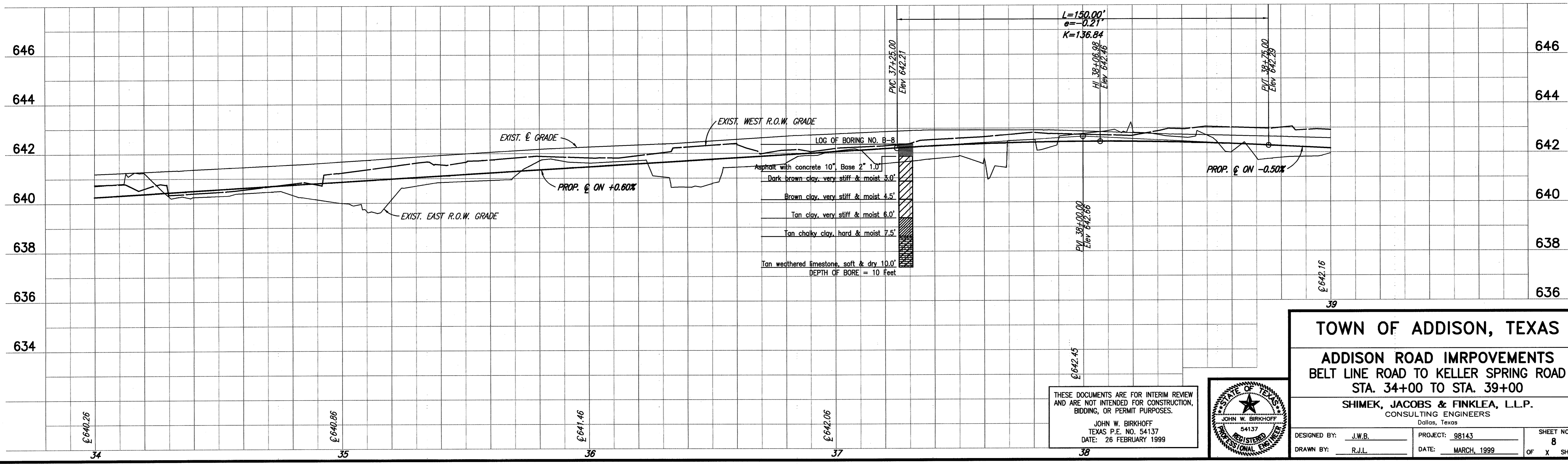

H:\PROJECTS\ADDISON\98143\SHEET\98143-08.DWG  
 03/30/99 R.L.  
 SCALE: 1"=20'  
 BLOCKS:

THESE DOCUMENTS ARE FOR INTERIM REVIEW AND ARE NOT INTENDED FOR CONSTRUCTION, BIDDING, OR PERMIT PURPOSES.

JOHN W. BIRKHOFF  
 TEXAS P.E. NO. 54137  
 DATE: 26 FEBRUARY 1999

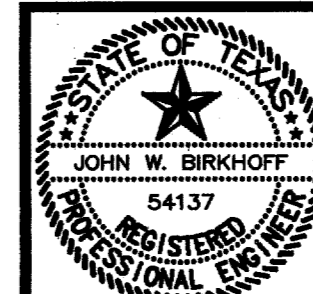

<b>TOWN OF ADDISON, TEXAS</b>		
<b>ADDISON ROAD IMPROVEMENTS</b>		
<b>BELT LINE ROAD TO KELLER SPRING ROAD</b>		
<b>STA. 34+00 TO STA. 39+00</b>		
<b>SHIMEK, JACOBS &amp; FINKLEA, L.L.P.</b>		
CONSULTING ENGINEERS Dallas, Texas		
DESIGNED BY: J.W.B.	PROJECT: 98143	SHEET NO. 8
DRAWN BY: R.J.L.	DATE: MARCH, 1999	OF X SHEETS



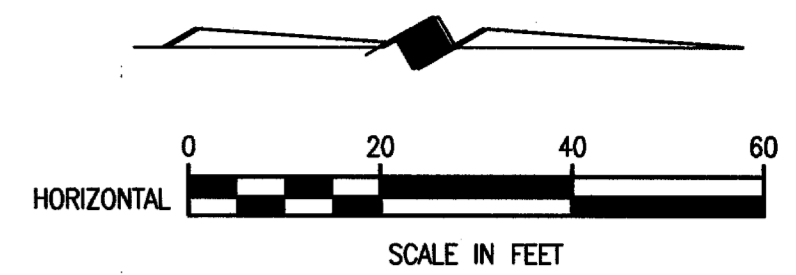
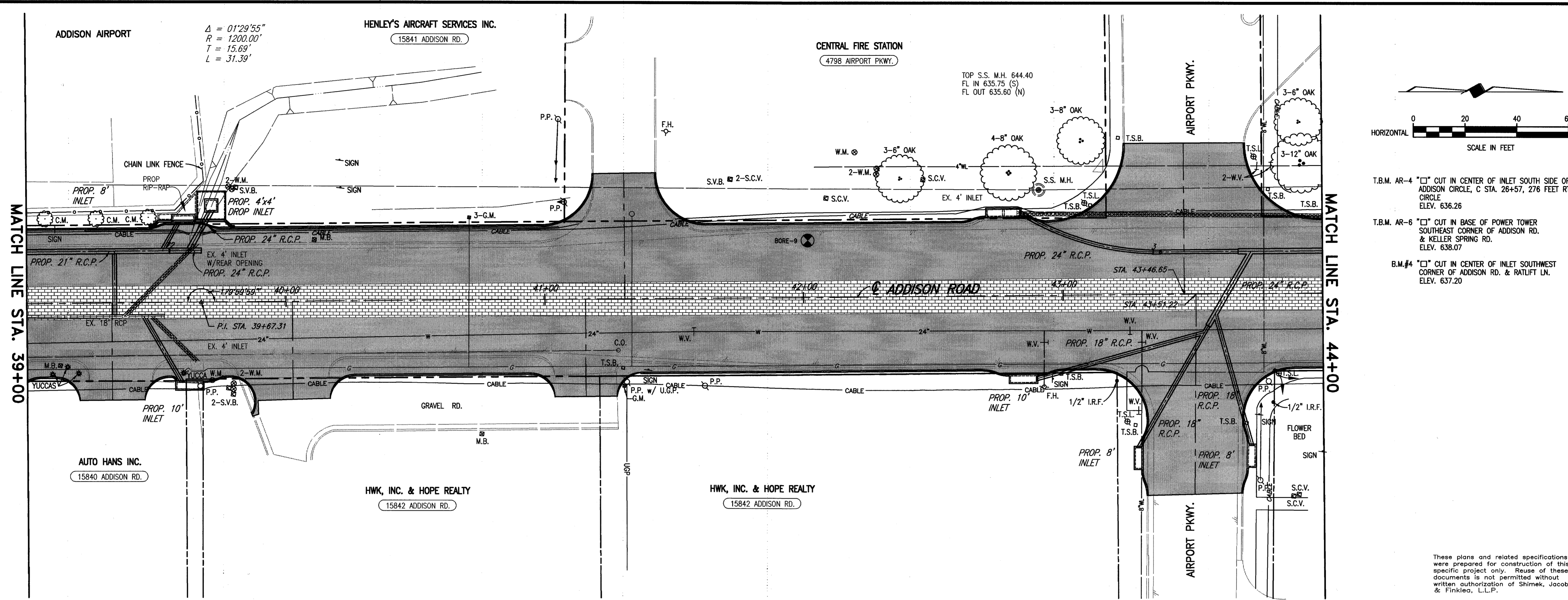

- T.B.M. AR-4 "□" CUT IN CENTER OF INLET SOUTH SIDE OF ADDISON CIRCLE, C STA. 26+57, 276 FEET RT. ELEV. 636.26
- T.B.M. AR-6 "□" CUT IN BASE OF POWER TOWER SOUTHEAST CORNER OF ADDISON RD. & KELLER SPRING RD. ELEV. 638.07
- B.M.#4 "□" CUT IN CENTER OF INLET SOUTHWEST CORNER OF ADDISON RD. & RATLIFT LN. ELEV. 637.20

These plans and related specifications were prepared for construction of this specific project only. Reuse of these documents is not permitted without written authorization of Shimek, Jacobs & Finklea, L.L.P.

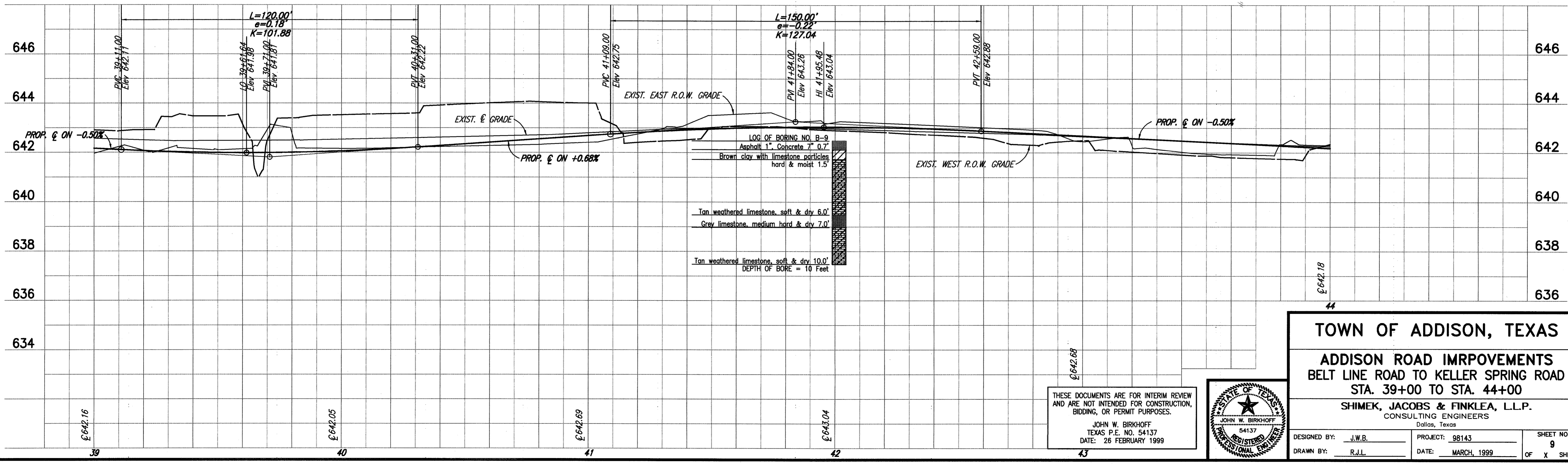

**TOWN OF ADDISON, TEXAS**

**ADDISON ROAD IMPROVEMENTS**  
 BELT LINE ROAD TO KELLER SPRING ROAD  
 STA. 39+00 TO STA. 44+00

**SHIMEK, JACOBS & FINKLEA, L.L.P.**  
 CONSULTING ENGINEERS  
 Dallas, Texas

DESIGNED BY: J.W.B. PROJECT: 98143 SHEET NO. 9  
 DRAWN BY: R.J.L. DATE: MARCH, 1999 OF X SHEETS

THESE DOCUMENTS ARE FOR INTERIM REVIEW AND ARE NOT INTENDED FOR CONSTRUCTION, BIDDING, OR PERMIT PURPOSES.

JOHN W. BIRKHOFF  
 TEXAS P.E. NO. 54137  
 DATE: 26 FEBRUARY 1999

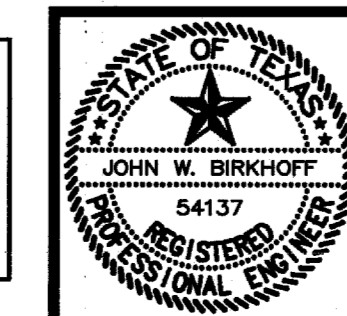

H:\PROJECTS\ADDISON\98143\SHEET\98143-09.DWG 03/30/99 R.J.L. SCALE: 1"=20' BLOCKS:

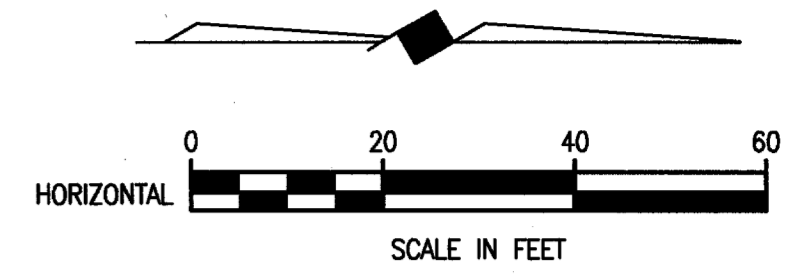
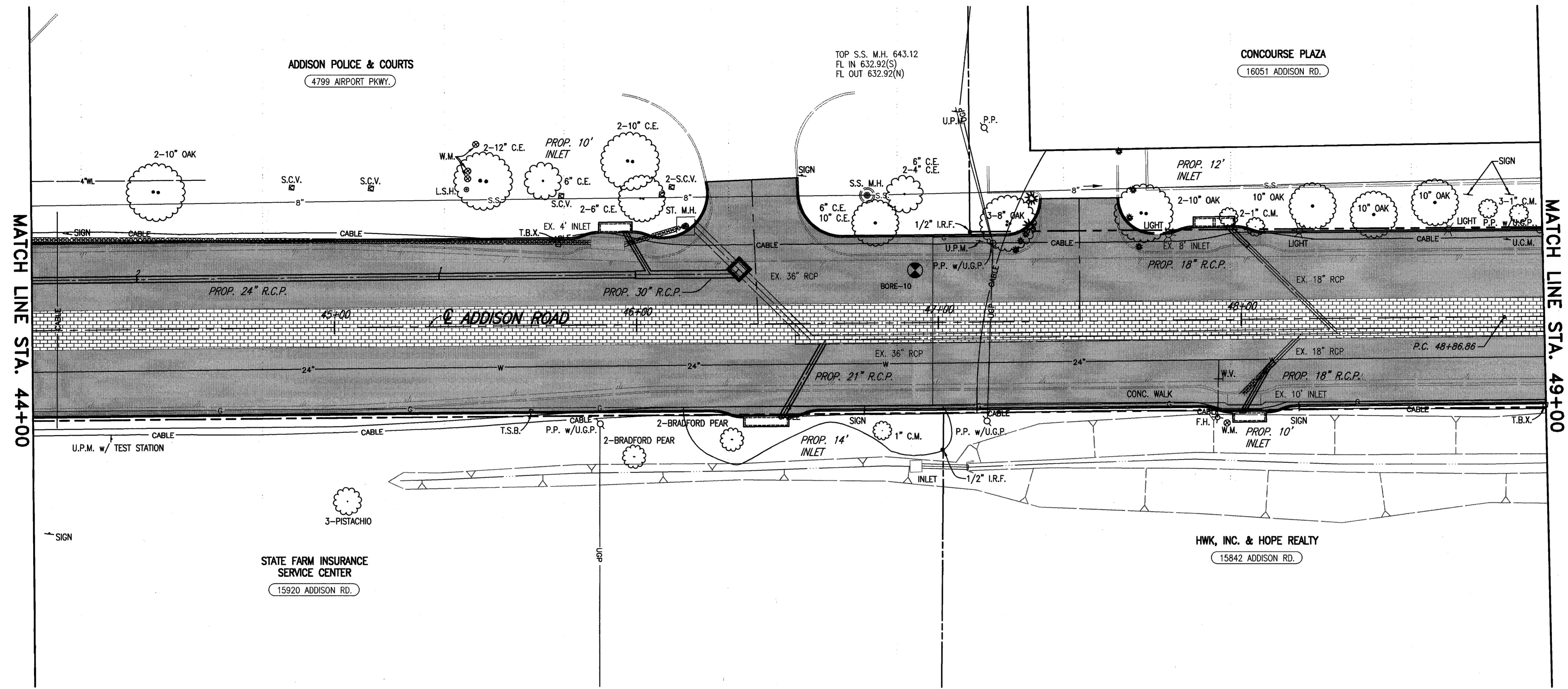

T.B.M. AR-6 "□" CUT IN BASE OF POWER TOWER  
SOUTHEAST CORNER OF ADDISON RD.  
& KELLER SPRING RD.  
ELEV. 638.07

B.M.#4 "□" CUT IN CENTER OF INLET SOUTHWEST  
CORNER OF ADDISON RD. & RATLIF LN.  
ELEV. 637.20

These plans and related specifications  
were prepared for construction of this  
specific project only. Reuse of these  
documents is not permitted without  
written authorization of Shimek, Jacobs  
& Finklea, L.L.P.

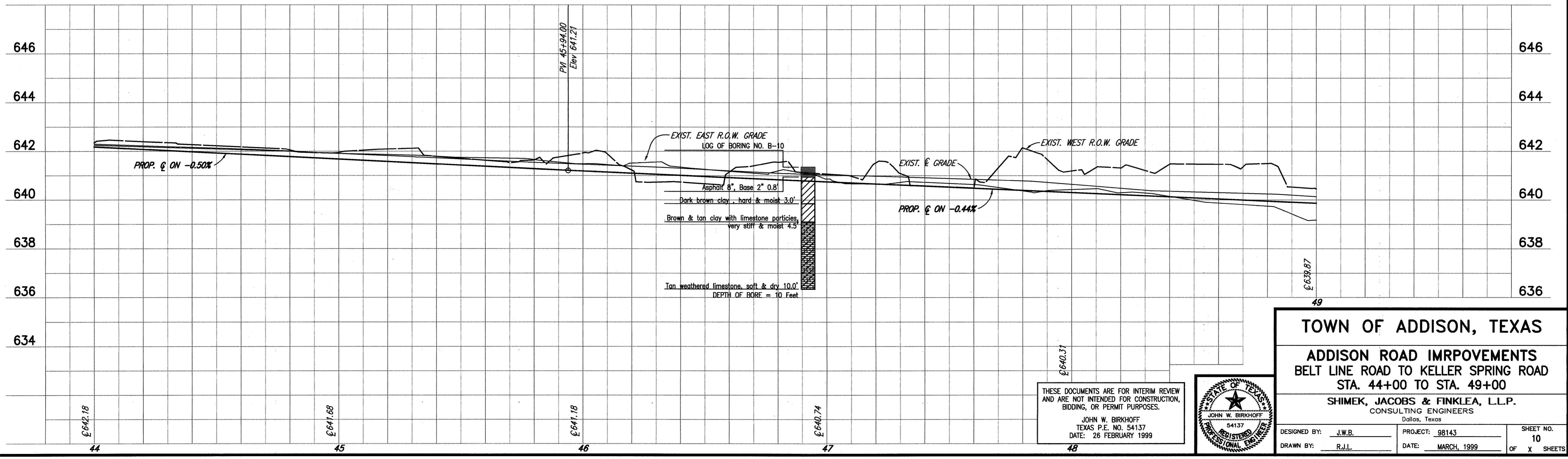

H:\PROJECTS\ADDISON\98143\98143\98143-10.DWG 03/20/99 R.L. SCALE: 1"=20' BLOCKS:

THESE DOCUMENTS ARE FOR INTERIM REVIEW  
AND ARE NOT INTENDED FOR CONSTRUCTION,  
BIDDING, OR PERMIT PURPOSES.

JOHN W. BIRKHOFF  
TEXAS P.E. NO. 54137  
DATE: 26 FEBRUARY 1999

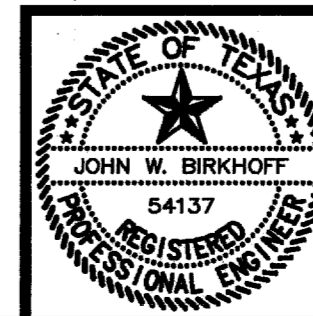

<b>TOWN OF ADDISON, TEXAS</b>		
<b>ADDISON ROAD IMPROVEMENTS</b>		
<b>BELT LINE ROAD TO KELLER SPRING ROAD</b>		
<b>STA. 44+00 TO STA. 49+00</b>		
<b>SHIMEK, JACOBS &amp; FINKLEA, L.L.P.</b>		
<small>CONSULTING ENGINEERS Dallas, Texas</small>		
DESIGNED BY: J.W.B.	PROJECT: 98143	SHEET NO. 10
DRAWN BY: R.J.L.	DATE: MARCH, 1999	OF X SHEETS

H:\PROJECTS\ADDISON\98143\SHEET\98143-11.DWG 03/30/99 R.L. SCALE: 1"=20' BLOCKS:

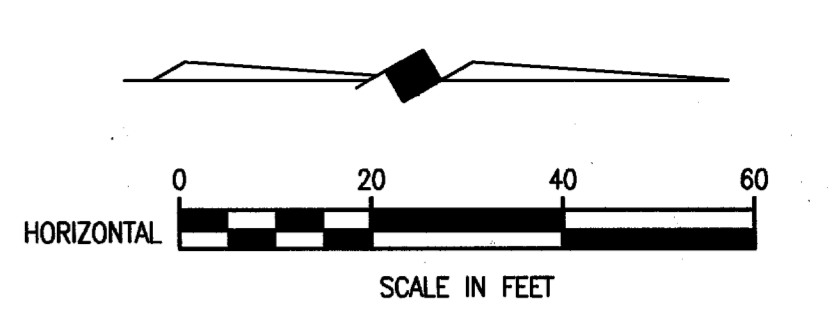
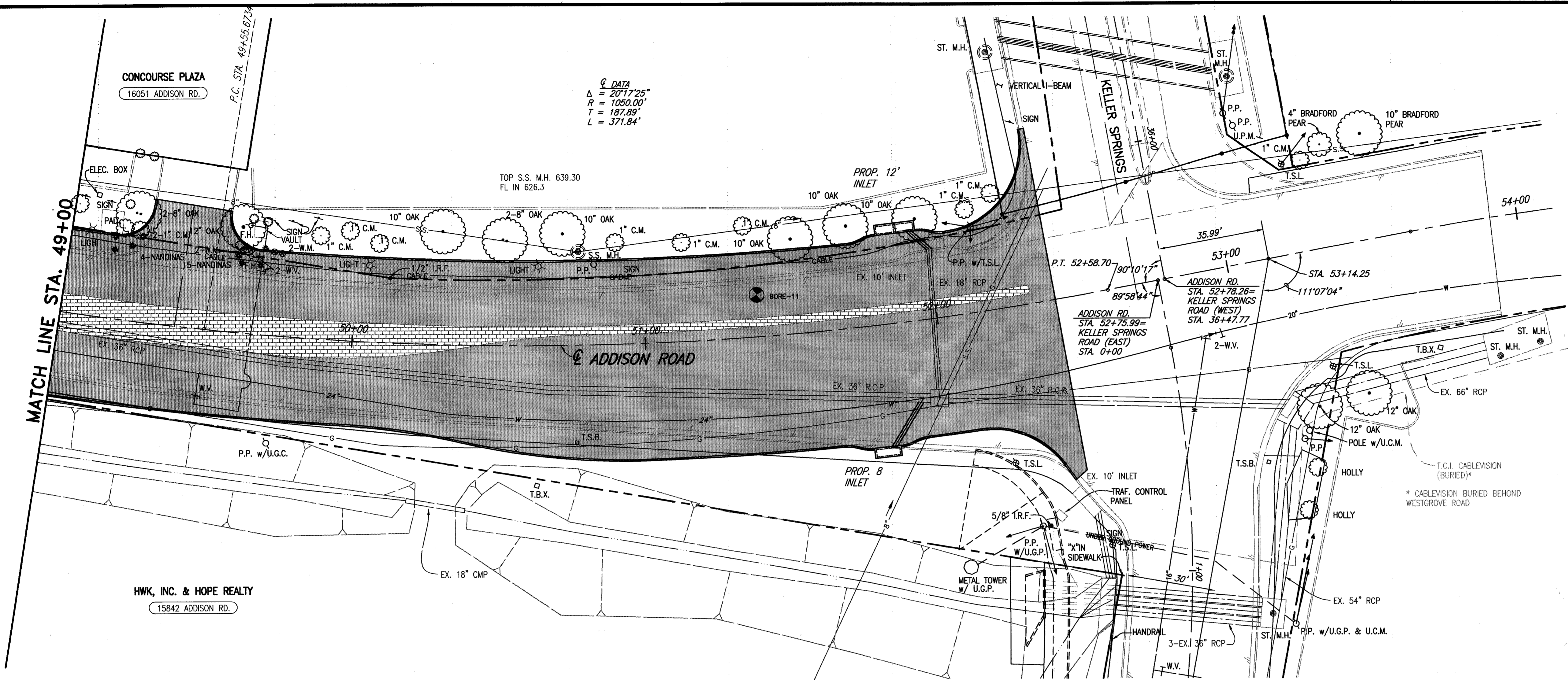

T.B.M. AR-6 "□" CUT IN BASE OF POWER TOWER SOUTHEAST CORNER OF ADDISON RD. & KELLER SPRING RD. ELEV. 638.07  
 B.M.#4 "□" CUT IN CENTER OF INLET SOUTHWEST CORNER OF ADDISON RD. & RATLIFF LN. ELEV. 637.20

These plans and related specifications were prepared for construction of this specific project only. Reuse of these documents is not permitted without written authorization of Shimek, Jacobs & Finklea, L.L.P.

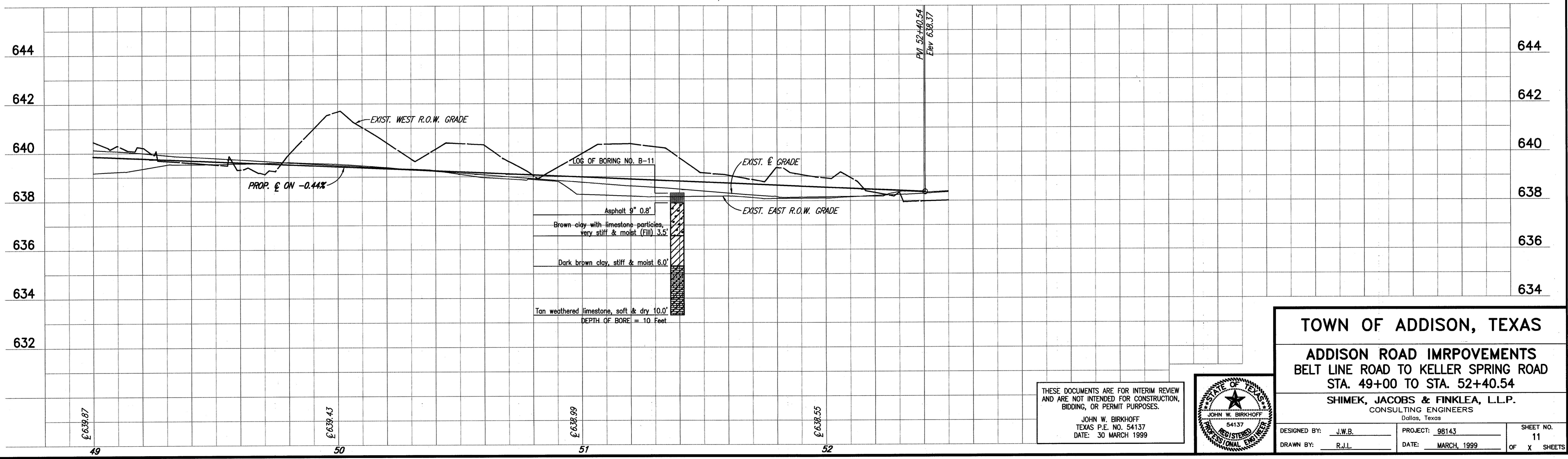

THESE DOCUMENTS ARE FOR INTERIM REVIEW AND ARE NOT INTENDED FOR CONSTRUCTION, BIDDING, OR PERMIT PURPOSES.  
 JOHN W. BIRKHOFF  
 TEXAS P.E. NO. 54137  
 DATE: 30 MARCH 1999

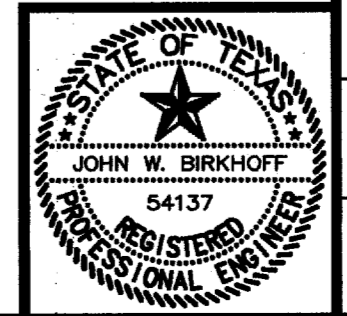

<b>TOWN OF ADDISON, TEXAS</b>		
<b>ADDISON ROAD IMPROVEMENTS</b>		
<b>BELT LINE ROAD TO KELLER SPRING ROAD</b>		
<b>STA. 49+00 TO STA. 52+40.54</b>		
<b>SHIMEK, JACOBS &amp; FINKLEA, L.L.P.</b>		
<small>CONSULTING ENGINEERS Dallas, Texas</small>		
DESIGNED BY: J.W.B.	PROJECT: 98143	SHEET NO. 11
DRAWN BY: R.J.L.	DATE: MARCH, 1999	OF X SHEETS