

REVIS: 5/6/10 - RLOWE
H:\Projects\Addison_2002\02\PHASE1\Sheet\Sheet-As-Built\2002\02\0208_PP.dwg
PLOT SCALE: 1:1.01
PLOT STYLE: 11x17.ctb
PLOTTED BY: RLOWE ON 5/14/2010

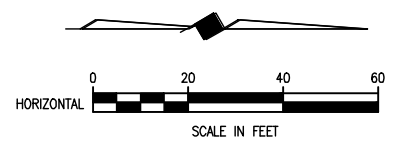

- B.M.#19 "C" CUT IN CENTER OF INLET 150 FEET SOUTH OF BELT LINE RD., EAST OF INWOOD RD. ELEV. 630.59
- T.B.M. AR-1 "C" CUT IN TOP OF VAULT NORTHEAST CORNER OF ADDISON RD. AND BELT LINE RD. ELEV. 634.80
- T.B.M. AR-2 "C" CUT IN CENTER OF INLET EAST SIDE OF ADDISON RD., @ STA. 9+87, 52 FEET RT. ELEV. 628.79
- T.B.M. AR-3 "C" CUT AT END OF RETAINING WALL, NORTH OF LINDBERGH DR., WEST SIDE OF ADDISON RD., @ STA. 18+76, 45 FEET LT. ELEV. 635.38

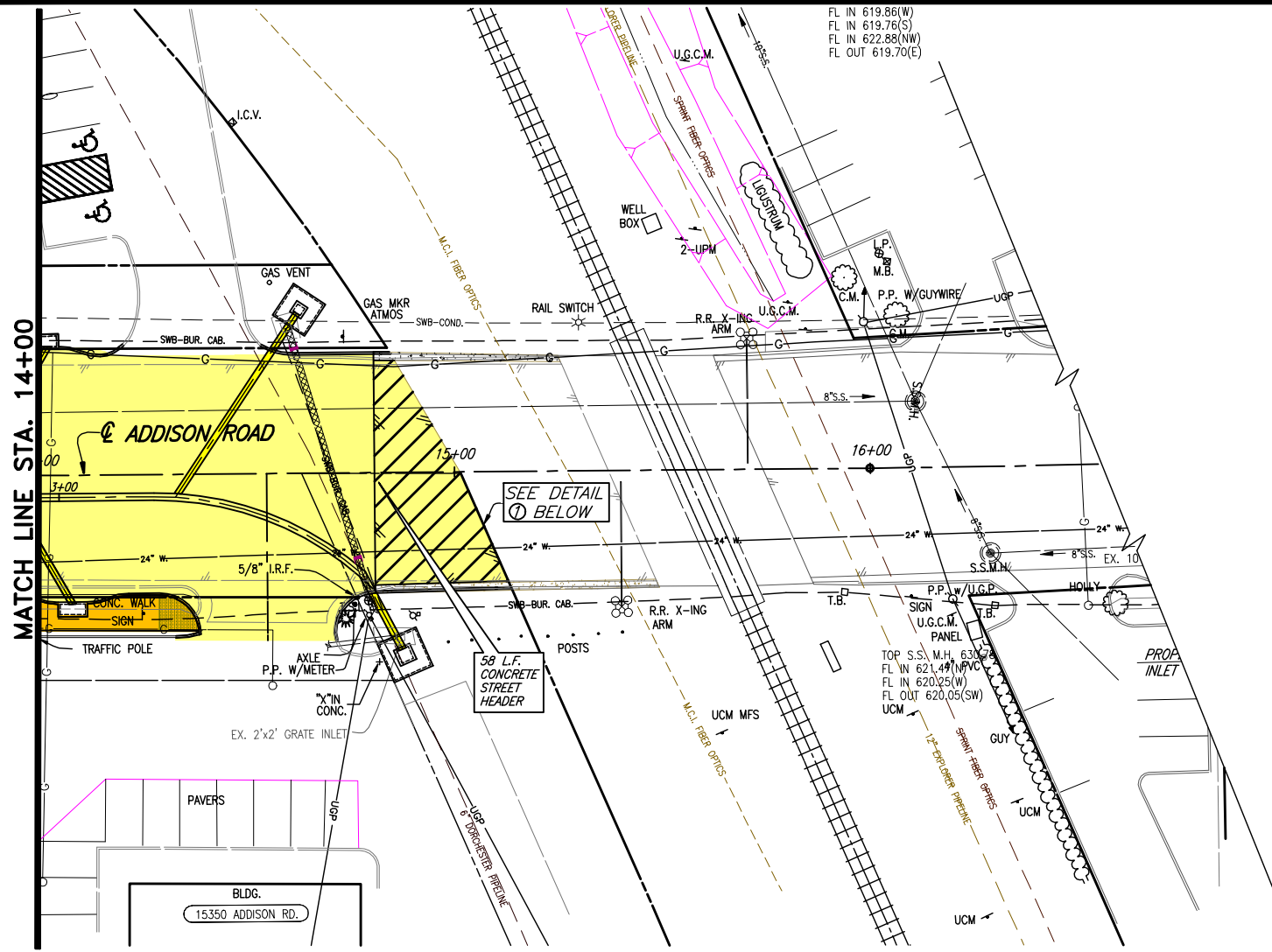
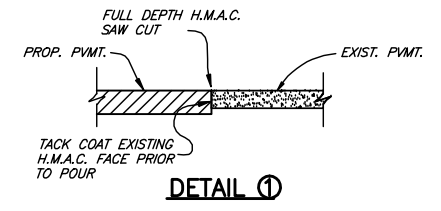
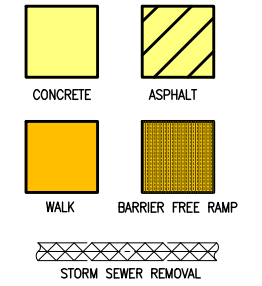

FOR SUMMARY OF ABBREVIATIONS SEE SHEET INDEX/GENERAL NOTES SHEET

These plans and related specifications were prepared for construction of this specific project only. Reuse of these documents is not permitted without written authorization of Birkhoff, Hendricks, & Conway, L.L.P.

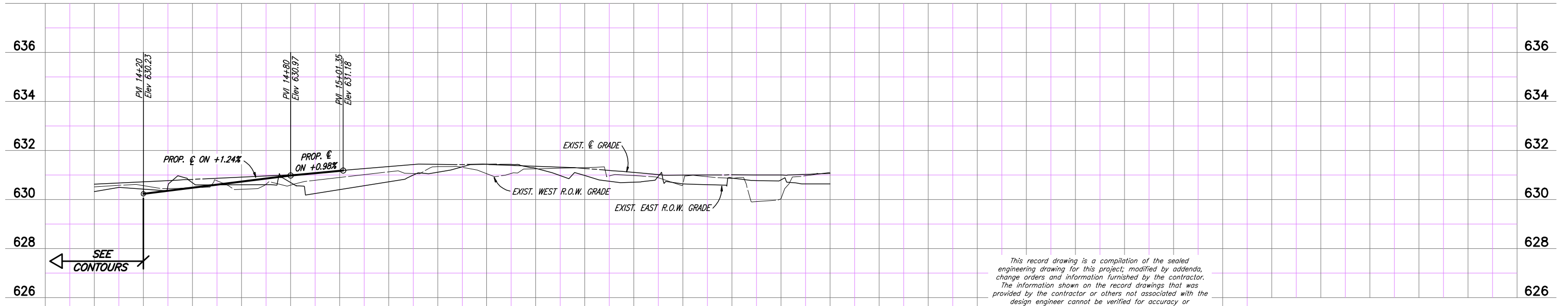

This record drawing is a compilation of the sealed engineering drawing for this project, modified by addenda, change orders and information furnished by the contractor. The information shown on the record drawings that was provided by the contractor or others not associated with the design engineer cannot be verified for accuracy or completeness. This original sealed drawings are on file at the offices of Birkhoff, Hendricks & Carter, L.L.P.
BY J.W.B. DATE 05/04/2010

THESE DOCUMENTS ARE FOR BIDDING, CONSTRUCTION, AND PERMIT PURPOSES.
John W. Birkhoff
DATE: 10/3/06

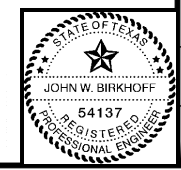

TOWN OF ADDISON, TEXAS		
ADDISON ROAD IMPROVEMENTS		
BELT LINE ROAD TO ARAPAHO ROAD PHASE I		
STA. 14+00 TO STA. 15+01.35		
BIRKHOFF, HENDRICKS & CONWAY L. L. P.		
CONSULTING ENGINEERS Dallas, Texas		
DESIGNED BY: <u>J.W.B.</u>	PROJECT: <u>2002-102</u>	SHEET NO. <u>8</u>
DRAWN BY: <u>R.J.L.</u>	DATE: <u>SEPTEMBER 2006</u>	OF <u>68</u> SHEETS